

**VESS OIL CORPORATION**  
 WILSON LEASE  
 NW. 1/4, SECTION 9, T25S, R9E  
 BUTLER COUNTY, KANSAS

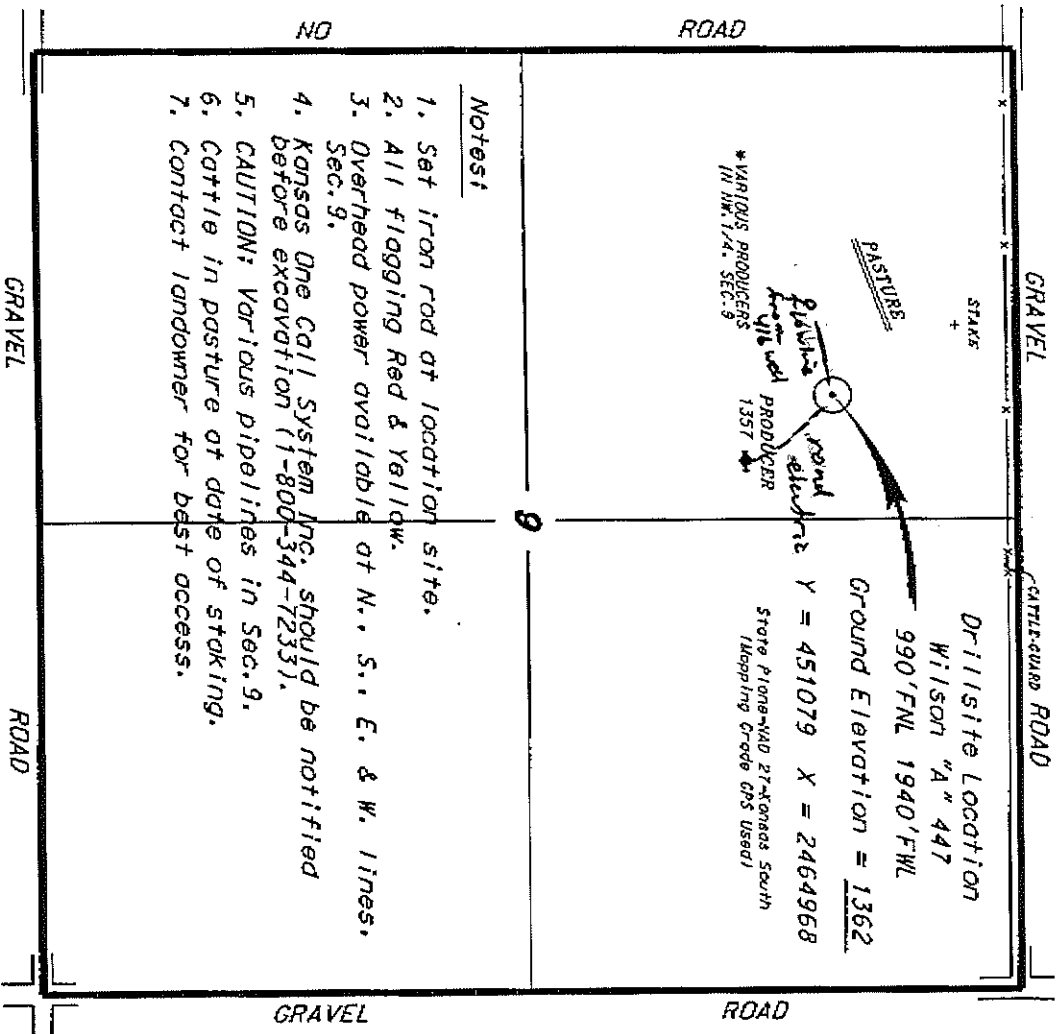

\*Ingress and egress to location as shown on this plat is per usage only and may not be legally opened for public use. Contact landowner, tenant and county road department for access.

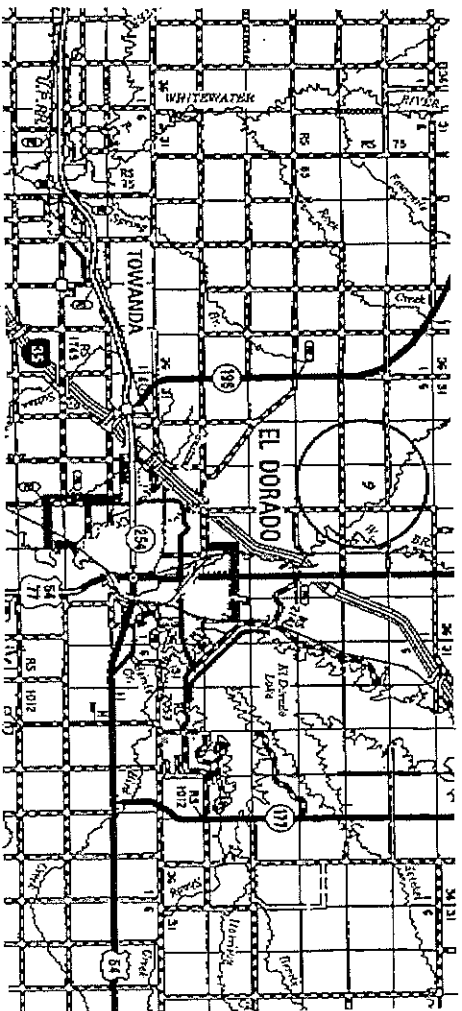

\* Controlling data is based upon the best maps and photographs available to us and upon a review of section of land containing the same.

\*\* SURVEYING SECTION LINES were established using the normal staked-out of corners of section lines. The bearings and distances were measured and the corners were set by the surveyor. The bearings and distances were measured and the corners were set by the surveyor. The bearings and distances were measured and the corners were set by the surveyor.

\*\*\* ELEVATIONS derived from National Geographic Vertical Datum.

CENTRAL KANSAS OILFIELD SERVICES, INC. (620)792-1977

DATE: March 18, 2013