

12

13

WOOLSEY OPERATING COMPANY
MICHEL #2-H
 SHL: 2,170' FNL, 620' FWL
 7-T34s-R11w
 EST BHL: 2,330' FNL, 1,090' WL
 18-T34s-R11w
 Barber Co, KS

Michel #2-H
Horizontal Drilling Unit

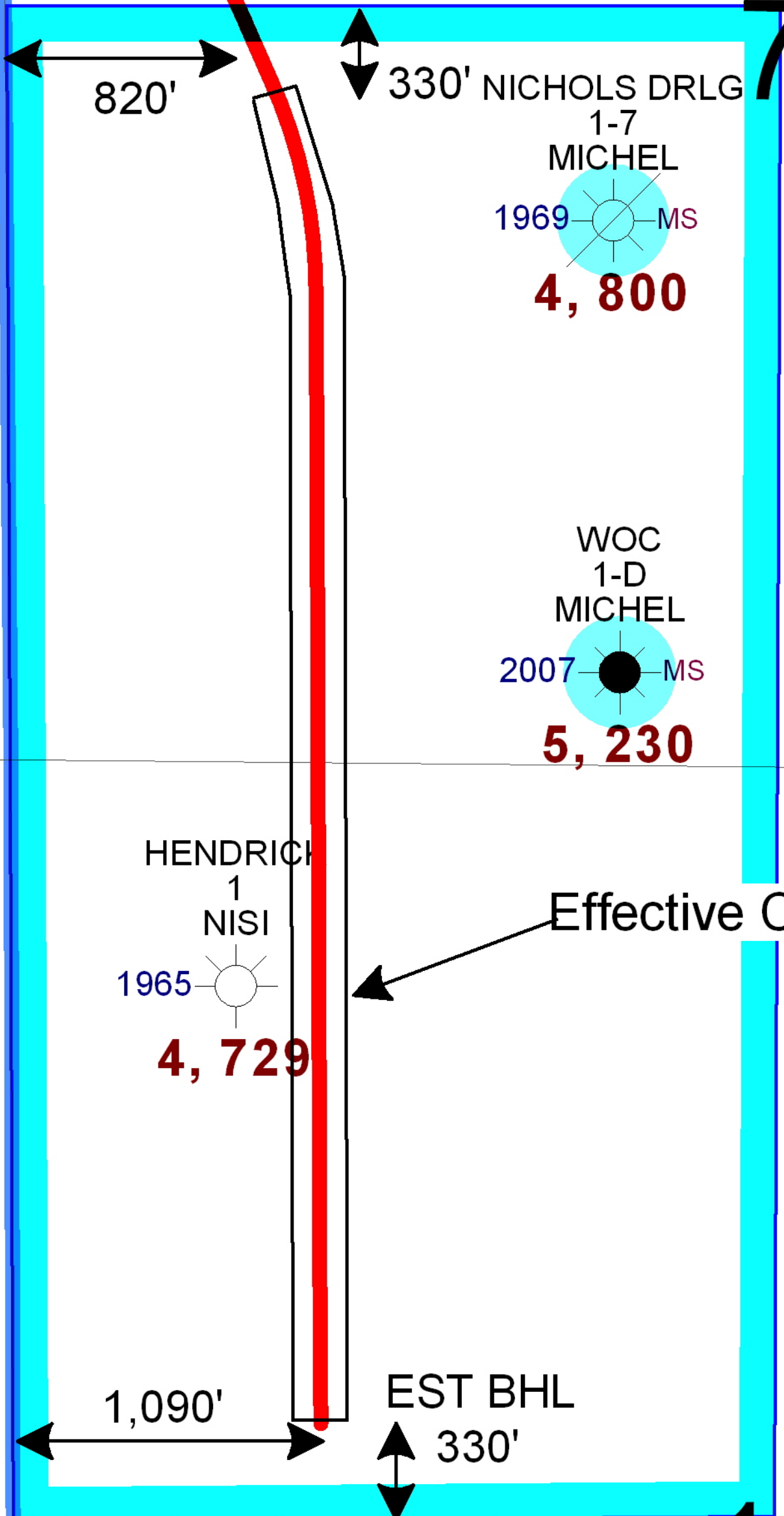

2001 MS
4,931

WOC
 1-C
 DIEL

2008 MS
5,240

K&E
 1
 SCHUPBACH
 1967
4,700

WOC
 1-B OWWO
 DIEL
 2007
4,720

WOODMAN
 1
 ZIMMERMAN
 1961 MS
4,733

WOC
 2-B
 DIEL
 2007 MS
5,215

NICHOLS DRLG
 1-13
 HUMPHREY
 1969 MS
4,820

WOC
 1
 HARBAUGH
 2006 MS, CK
5,240

CHIEFTAIN
 1-18
 DOUGLAS-KENT
 2011 MS
5,200

WOC
 10-X
 LOGAN
 2011 MS
5,220

HENDRICK
 1
 NISI
 1965
4,729

WOC
 1-D
 MICHEL
 2007 MS
5,230

1969 MS
4,800

WOC
 1-A
 MICHEL
 2006 MS
5,290

ZIMMERMAN
 1957 MS
4,733

WOC
 1-C
 MICHEL
 2006 MS
5,280

| | |
|-----------------------------|-------------------------|
| | |
| MICHEL #2-H | |
| KCC LOCATION EXHIBIT | |
| 7-T34s-R11w | |
| Barber County, KS | |
| ATTRIBUTE MAP | |
| | CS: CHASE |
| | CG: COUNCIL GROVE |
| | AD: ADMIRE |
| | WB: WABAUNSEE |
| | SH: SHAWNEE |
| | DG: DOUGLAS |
| | KC: LANSING-KANSAS CITY |
| | PL: PLEASANTON |
| | MA: MARMATON |
| | CK: CHEROKEE |
| | AT: ATOKA |
| | MW: MORROW |
| | CN: MISS. CONG. |
| | MS: MISSISSIPPI |
| | KH: KINDERHOOK |
| | MN: MISENER |
| | WF: WOODFORD SH. |
| | VI: VIOLA |
| | SP: SIMPSON |
| | AR: ARBUCKLE |
| | GW: GRANITE WASH |
| REMARKS | |
| CONFIDENTIAL | |
| By: DLP | |