



APPLICATION FOR COMMINGLING OF PRODUCTION (K.A.R. 82-3-123) OR FLUIDS (K.A.R. 82-3-123a) *Commingling ID # _____*

OPERATOR: License # _____ API No. 15 - _____
Name: _____ Spot Description: _____
Address 1: _____ - - - - - Sec. _____ Twp. _____ S. R. _____ East West
Address 2: _____ Feet from North / South Line of Section
City: _____ State: _____ Zip: _____ + _____ Feet from East / West Line of Section
Contact Person: _____ County: _____
Phone: (_____) _____ Lease Name: _____ Well #: _____

1. Name and upper and lower limit of each production interval to be commingled:
Formation: _____ (Perfs): _____
Formation: _____ (Perfs): _____
Formation: _____ (Perfs): _____
Formation: _____ (Perfs): _____
Formation: _____ (Perfs): _____

2. Estimated amount of fluid production to be commingled from each interval:
Formation: _____ BOPD: _____ MCFPD: _____ BWPD: _____
Formation: _____ BOPD: _____ MCFPD: _____ BWPD: _____
Formation: _____ BOPD: _____ MCFPD: _____ BWPD: _____
Formation: _____ BOPD: _____ MCFPD: _____ BWPD: _____
Formation: _____ BOPD: _____ MCFPD: _____ BWPD: _____

3. Plat map showing the location of the subject well, all other wells on the subject lease, and all wells on offsetting leases within a 1/2 mile radius of the subject well, and for each well the names and addresses of the lessee of record or operator.

4. Signed certificate showing service of the application and affidavit of publication as required in K.A.R. 82-3-135a.

For Commingling of PRODUCTION ONLY, include the following:

- 5. Wireline log of subject well. Previously Filed with ACO-1: Yes No
- 6. Complete Form ACO-1 (*Well Completion form*) for the subject well.

For Commingling of FLUIDS ONLY, include the following:

- 7. Well construction diagram of subject well.
- 8. Any available water chemistry data demonstrating the compatibility of the fluids to be commingled.

AFFIDAVIT: I am the affiant and hereby certify that to the best of my current information, knowledge and personal belief, this request for commingling is true and proper and I have no information or knowledge, which is inconsistent with the information supplied in this application.

Submitted Electronically

KCC Office Use Only
 Denied Approved
15-Day Periods Ends: _____
Approved By: _____ Date: _____

Protests may be filed by any party having a valid interest in the application. Protests must be in writing and comply with K.A.R. 82-3-135b and must be filed within 15 days of publication of the notice of application.

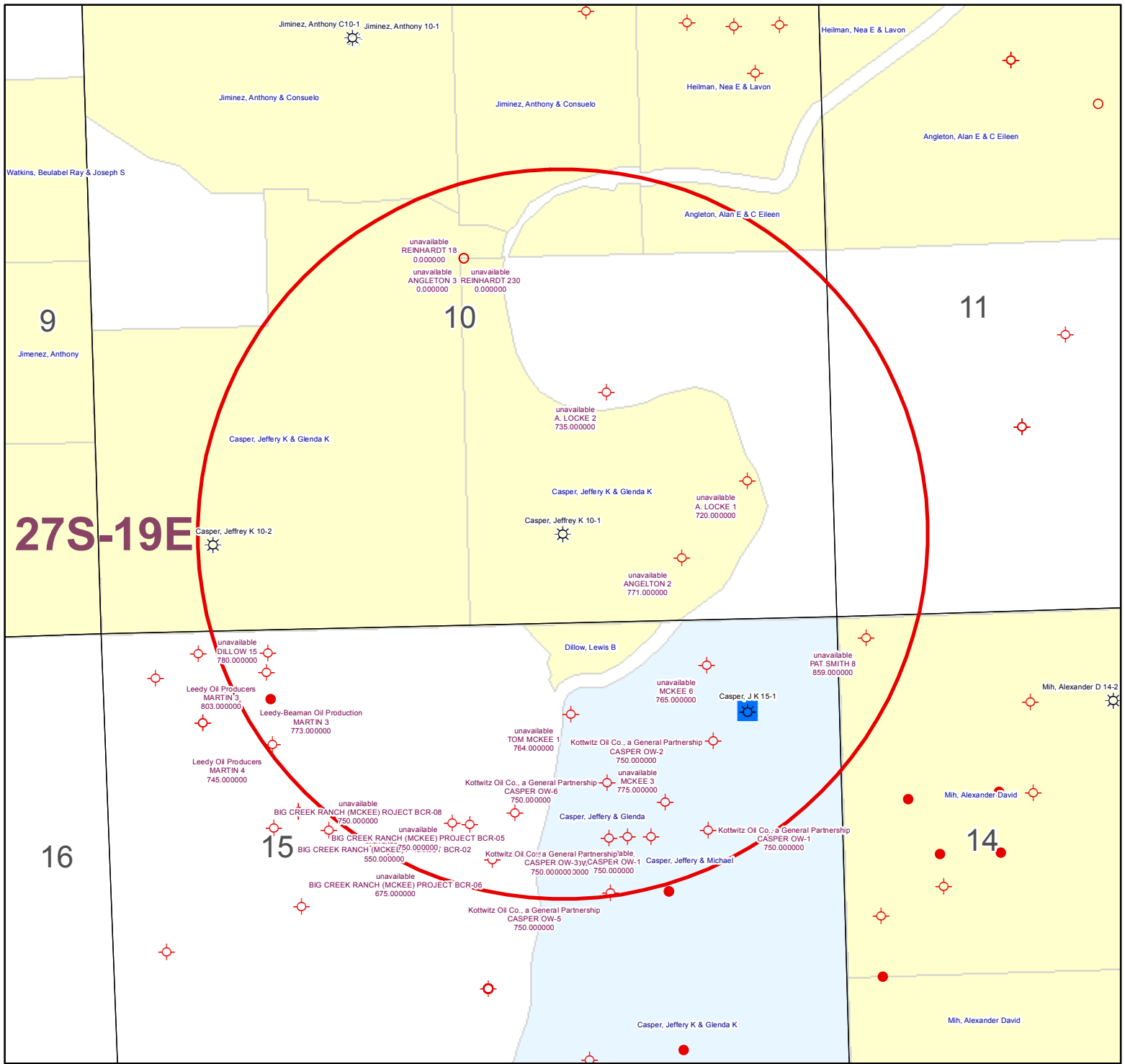

KGS STATUS	
	DA/PA
	EOR
	GAS
	INJ/SWD
	OIL
	OIL/GAS
	OTHER

Casper, Jeffrey K 10-1
 10-27S-19E
 1" = 1,000'

BEFORE THE STATE CORPORATION COMMISSION OF THE STATE OF KANSAS
NOTICE OF FILING APPLICATION

RE: In the Matter of **Postrock Midcontinent Production, LLC** Application for Commingling of Production in the **Casper, Jeffrey K 10-1** located in **Neosho County, Kansas**.

TO: All Oil & Gas Producers, Unleased Mineral Interest Owners, Landowners, and all persons whomever concerned.

You, and each of you, are hereby notified that **Postrock Midcontinent Production, LLC** has filed an application to commingle the **Weir, Fleming, Croweburg, Mulky, Summit and Bartlesville** producing formations at the **Casper, Jeffrey K 10-1**, located in the **NE SW SW SE, S10-T27S-R19E, Approximately 653 FSL & 1981 FEL, Neosho County, Kansas**.

Any persons who object to or protest this application shall be required to file their objections or protest with the Conservation Division of the State Corporation Commission of the State of Kansas within fifteen (15) days from the date of this publication. These protests shall be filed pursuant to Commission regulations and must state specific reasons why granting the application may cause waste, violate correlative rights or pollute the natural resources of the State of Kansas.

All persons interested or concerned shall take notice of the foregoing and shall govern themselves accordingly. All person and/or companies wishing to protest this application are required to file a written protest with the Conservation Division of the Kansas Oil and Gas Commission.

Upon the receipt of any protest, the Commission will convene a hearing and protestants will be expected to enter an appearance either through proper legal counsel or as individuals, appearing on their own behalf.

Postrock Midcontinent Production, LLC
210 Park Avenue, Suite 2750
Oklahoma City, Oklahoma 73102
(405) 660-7704

A COPY OF THE AFFIDAVIT OF PUBLICATION MUST ACCOMPANY ALL APPLICATIONS.

Affidavit of Publication

STATE OF KANSAS, NEOSHO COUNTY, ss:
Maggie Taylor, being first duly sworn, deposes and says: That *she* is *Classified Manager* of *THE CHANUTE TRIBUNE*, a daily newspaper printed in the State of Kansas, and published in and of general circulation in Neosho County, Kansas, with a general paid circulation on a daily basis in Neosho County, Kansas, and that said newspaper is not a trade, religious or fraternal publication.

Said newspaper is a daily published at least weekly 50 times a year: has been so published continuously and uninterruptedly in said county and state for a period of more than five years prior to the first publication of said notice; and has been admitted at the post office of Chanute, in said county as second class matter.

That the attached notice is a true copy thereof and was published in the regular and entire issue of said newspaper for consecutive one day, the first publication thereof being made as aforesaid on the 9th day of April 2013, with subsequent publications being made on the following dates:

_____, 2013 _____, 2013
_____, 2013 _____, 2013

Maggie Taylor

Subscribed and sworn to and before me this 9th day of April 2013

[Signature]

Notary Public

My commission expires: January 9, 2015
Printer's Fee \$ 70.36
Affidavit, Notary's Fee \$ 3.00
Additional Copies \$ _____
Total Publication Fees \$ 73.36

SHANNA L. GUIOT
Notary Public - State of Kansas
My Appt. Expires 1-9-15

AFFIDAVIT

STATE OF KANSAS \
- SS.
County of Sedgwick /

Mark Fletchall, of lawful age, being first duly sworn, deposeth and saith: That he is Record Clerk of The Wichita Eagle, a daily newspaper published in the City of Wichita, County of Sedgwick, State of Kansas, and having a general paid circulation on a daily basis in said County, which said newspaper has been continuously and uninterruptedly published in said County for more than one year prior to the first publication of the notice hereinafter mentioned, and which said newspaper has been entered as second class mail matter at the United States Post Office in Wichita, Kansas, and which said newspaper is not a trade, religious or fraternal publication and that a notice of a true copy is hereto attached was published in the regular and entire Morning issue of said The Wichita Eagle for 1 issues, that the first publication of said notice was

made as aforesaid on the 8th of

April A.D. 2013, with

subsequent publications being made on the following dates:

And affiant further says that he has personal knowledge of the statements above set forth and that they are true.

Mark Fletchall

Subscribed and sworn to before me this

8th day of April, 2013

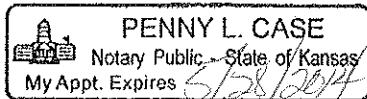

Penny L. Case
Notary Public Sedgwick County, Kansas

Printer's Fee : \$139.60

LEGAL PUBLICATION
PUBLISHED IN THE WICHITA EAGLE
APRIL 8, 2013 (3239851)
BEFORE THE STATE CORPORATION COMMISSION
OF THE STATE OF KANSAS
NOTICE OF FILING APPLICATION
RE: In the Matter of Postrock Midcontinent
Production, LLC Application for
Commingle of Production in the Casper,
Jeffrey K 10-1 located in Neosho County,
Kansas.
TO: All Oil & Gas Producers, Unleased Mineral
Interest Owners, Landowners, and all
persons whomsoever concerned.
You, and each of you, are hereby notified
that Postrock Midcontinent Production, LLC
has filed an application to commingle the
Welr, Fleming, Croweburg, Mulky, Summit
and Bartlesville producing formations at the
Casper, Jeffrey K 10-1, located in the NE
SW SW SE, S10-T27S-R19E, Approximately
653 FSL & 1981 FEL, Neosho County, Kansas.
Any persons who object to or protest
this application shall be required to file their
objections or protest with the Conservation
Division of the State Corporation Commission
of the State of Kansas within fifteen (15)
days from the date of this publication. These
protests shall be filed pursuant to Commission
regulations and must state specific reasons
why granting the application may cause waste,
violate correlative rights or pollute the natural
resources of the State of Kansas.
All persons interested or concerned shall
take notice of the foregoing and shall govern
themselves accordingly. All person and/or
companies wishing to protest this application
are required to file a written protest with the
Conservation Division of the Kansas Oil and
Gas Commission.
Upon the receipt of any protest, the
Commission will convene a hearing and
protestants will be expected to enter an
appearance either through proper legal
counsel or as individuals, appearing on their
own behalf.
Postrock Midcontinent Production, LLC
210 Park Avenue, Suite 2750
Oklahoma City, Oklahoma 73102
(405) 660-7704
**A COPY OF THE AFFIDAVIT OF PUBLICATION
MUST ACCOMPANY ALL APPLICATIONS**



Affidavit of Notice Served

Re: Application for Commingle of Production or Fluids (ACO-4)

Well Name / API: Casper, Jeffrey K 10-1 / 15-207-27040
Legal Location: 10-27S-19E

The undersigned hereby certifies that he / she is a duly authorized agent for the applicant, and that on the 15th day of April, 2013, a true and correct copy of the application referenced above was delivered or mailed to the following parties:

Operators	Mineral Owners
-Leedy Oil Producers 15-27S-19E, NE NE NW NW and NE SE NW NW -Leedy-Beaman Oil Production 15-27S-19E, NE NE NW NW Both the same address and INACTIVE 214 N. Highland Chanute, KS 66720	10-27S-19E, Tract in N2 SW Fred Stoldt 23430 Lyon RD Chanute, KS 66720
Kottwitz, Harold dba Kottwitz Oil Co. 15-27S-19E, NW NW SE NE, NE SW NE NE, NE NE SW NE, NW NE SW NE 3009 W. 30 th Street Lawrence, KS 66047	Tract E of Big Crk in SE/4 and 11-27S-19E, W2 SW George and Betty V. Greve 13010 230th Rd Erie, KS 66733
	Joan L and Edward Martin 15-27S-19E, Tract in W2 NW NE & N2 NW 523 Wisconsin Street Neodosha, KS 66757
	Big Creek Ranch, Inc. NE lying W of Big Creek & 52 W 923 Highland Chanute, KS 66720

Signed this 15th day of April, 2013.

Jane Curtright
Applicant or Duly Authorized Agent



Subscribed and sworn to before me this 15th day of April, 2013.

Jan Marie Ferguson
Notary Public My Commission Expires: 11 / 08 / 13

April 30, 2013

Clark Edwards
PostRock Midcontinent Production LLC
Oklahoma Tower
210 Park Ave, Ste 2750
Oklahoma City, OK 73102

RE: Approved Commingling CO041321
Casper, Jeffrey K. 10-1, Sec. 10-T27S-R19E, Neosho County
API No. 15-133-27040-00-00

Dear Mr. Edwards:

Your Application for Commingling (ACO-4) for the above described well, received by the KCC on April 15, 2013, has been reviewed and approved by the Kansas Corporation Commission (KCC) per K.A.R. 82-3-123. Notice was examined and found to be proper per K.A.R. 82-3-135a. No protest had been filed within the 15-day protest period.

Based upon the depth of the Bartlesville formation perforations, total oil production shall not exceed 100 BOPD and total gas production shall not exceed 50% of the absolute open flow (AOF).

File form ACO-1 upon re-completion of the well to commingle.

Commingling ID number CO041321 has been assigned to this approved application. Use this number for well completion reports (ACO-1) and other correspondence that may concern this approved commingling.

Sincerely,

Rick Hestermann
Production Department