



**APPLICATION FOR COMMINGLING OF PRODUCTION (K.A.R. 82-3-123) OR FLUIDS (K.A.R. 82-3-123a)** *Commingling ID # \_\_\_\_\_*

OPERATOR: License # \_\_\_\_\_ API No. 15 - \_\_\_\_\_  
Name: \_\_\_\_\_ Spot Description: \_\_\_\_\_  
Address 1: \_\_\_\_\_ - - - - - Sec. \_\_\_\_\_ Twp. \_\_\_\_\_ S. R. \_\_\_\_\_  East  West  
Address 2: \_\_\_\_\_ Feet from  North /  South Line of Section  
City: \_\_\_\_\_ State: \_\_\_\_\_ Zip: \_\_\_\_\_ + \_\_\_\_\_ Feet from  East /  West Line of Section  
Contact Person: \_\_\_\_\_ County: \_\_\_\_\_  
Phone: ( \_\_\_\_\_ ) \_\_\_\_\_ Lease Name: \_\_\_\_\_ Well #: \_\_\_\_\_

1. Name and upper and lower limit of each production interval to be commingled:  
Formation: \_\_\_\_\_ (Perfs): \_\_\_\_\_  
Formation: \_\_\_\_\_ (Perfs): \_\_\_\_\_  
Formation: \_\_\_\_\_ (Perfs): \_\_\_\_\_  
Formation: \_\_\_\_\_ (Perfs): \_\_\_\_\_  
Formation: \_\_\_\_\_ (Perfs): \_\_\_\_\_

2. Estimated amount of fluid production to be commingled from each interval:  
Formation: \_\_\_\_\_ BOPD: \_\_\_\_\_ MCFPD: \_\_\_\_\_ BWPD: \_\_\_\_\_  
Formation: \_\_\_\_\_ BOPD: \_\_\_\_\_ MCFPD: \_\_\_\_\_ BWPD: \_\_\_\_\_  
Formation: \_\_\_\_\_ BOPD: \_\_\_\_\_ MCFPD: \_\_\_\_\_ BWPD: \_\_\_\_\_  
Formation: \_\_\_\_\_ BOPD: \_\_\_\_\_ MCFPD: \_\_\_\_\_ BWPD: \_\_\_\_\_  
Formation: \_\_\_\_\_ BOPD: \_\_\_\_\_ MCFPD: \_\_\_\_\_ BWPD: \_\_\_\_\_

3. Plat map showing the location of the subject well, all other wells on the subject lease, and all wells on offsetting leases within a 1/2 mile radius of the subject well, and for each well the names and addresses of the lessee of record or operator.

4. Signed certificate showing service of the application and affidavit of publication as required in K.A.R. 82-3-135a.

**For Commingling of PRODUCTION ONLY, include the following:**

- 5. Wireline log of subject well. Previously Filed with ACO-1:  Yes  No
- 6. Complete Form ACO-1 (*Well Completion form*) for the subject well.

**For Commingling of FLUIDS ONLY, include the following:**

- 7. Well construction diagram of subject well.
- 8. Any available water chemistry data demonstrating the compatibility of the fluids to be commingled.

**AFFIDAVIT:** I am the affiant and hereby certify that to the best of my current information, knowledge and personal belief, this request for commingling is true and proper and I have no information or knowledge, which is inconsistent with the information supplied in this application.

**Submitted Electronically**

**KCC Office Use Only**  
 Denied  Approved  
15-Day Periods Ends: \_\_\_\_\_  
Approved By: \_\_\_\_\_ Date: \_\_\_\_\_

*Protests may be filed by any party having a valid interest in the application. Protests must be in writing and comply with K.A.R. 82-3-135b and must be filed within 15 days of publication of the notice of application.*

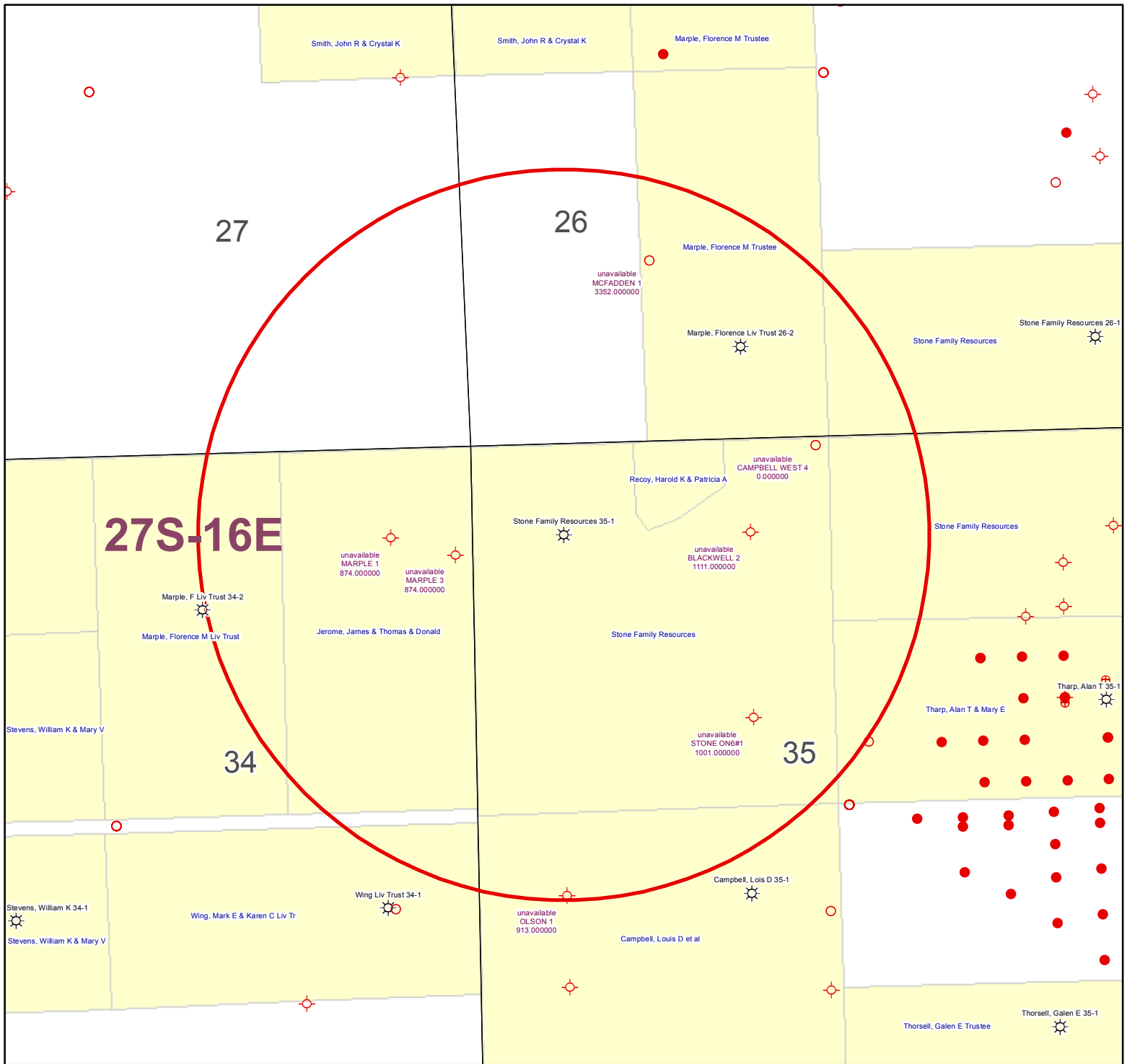

Stone Family Resources 35-1  
 35-27S-16E  
 1" = 1,000'

**KGS STATUS**

- ⊕ DA/PA
- ⊙ EOR
- ☀ GAS
- △ INJ/SWD
- OIL
- ★ OIL/GAS
- OTHER



**AFFIDAVIT**

STATE OF KANSAS \
- SS.
County of Sedgwick /

Mark Fletchall, of lawful age, being first duly sworn, deposeth and saith: That he is Record Clerk of The Wichita Eagle, a daily newspaper published in the City of Wichita, County of Sedgwick, State of Kansas, and having a general paid circulation on a daily basis in said County, which said newspaper has been continuously and uninterruptedly published in said County for more than one year prior to the first publication of the notice hereinafter mentioned, and which said newspaper has been entered as second class mail matter at the United States Post Office in Wichita, Kansas, and which said newspaper is not a trade, religious or fraternal publication and that a notice of a true copy is hereto attached was published in the regular and entire Morning issue of said The Wichita Eagle for 1 issues, that the first publication of said notice was

made as aforesaid on the 8th of

April A.D. 2013, with

subsequent publications being made on the following dates:

And affiant further says that he has personal knowledge of the statements above set forth and that they are true.

*Mark Fletchall*

Subscribed and sworn to before me this

8th day of April, 2013

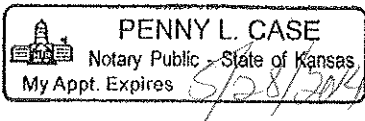

*Penny L. Case*

Notary Public Sedgwick County, Kansas

Printer's Fee : \$142.00

**LEGAL PUBLICATION**

PUBLISHED IN THE WICHITA EAGLE
APRIL 08, 2013 (3239858)
BEFORE THE STATE CORPORATION COMMISSION
OF THE STATE OF KANSAS

**NOTICE OF FILING APPLICATION**

RE: In the Matter of Postrock Midcontinent Production, LLC Application for Commingling of Production in the Stone Family Resources 35-1 located in Wilson County, Kansas.

TO: All Oil & Gas Producers, Unleased Mineral Interest Owners, Landowners, and all persons whomsoever concerned.

You, and each of you, are hereby notified that Postrock Midcontinent Production, LLC has filed an application to commingle the Riverton, Tebo, Fleming, Croweburg, Bevier, Mulky, Summit and Bartlesville producing formations at the Stone Family Resources 35-1, located in the NW NW, S35-T275-R16E, Approximately 660 FNL & 660 FWL, Wilson County, Kansas.

Any persons who object to or protest this application shall be required to file their objections or protest with the Conservation Division of the State Corporation Commission of the State of Kansas within fifteen (15) days from the date of this publication. These protests shall be filed pursuant to Commission regulations and must state specific reasons why granting the application may cause waste, violate correlative rights or pollute the natural resources of the State of Kansas.

All persons interested or concerned shall take notice of the foregoing and shall govern themselves accordingly. All person and/or companies wishing to protest this application are required to file a written protest with the Conservation Division of the Kansas Oil and Gas Commission.

Upon the receipt of any protest, the Commission will convene a hearing and protestants will be expected to enter an appearance either through proper legal counsel or as individuals, appearing on their own behalf.

Postrock Midcontinent Production, LLC
210 Park Avenue, Suite 2750
Oklahoma City, Oklahoma 73102
(405) 660-7704

**LEGAL NOTICE**

Published in The Neodesha Derrick on April 11, 2013

**BEFORE THE STATE CORPORATION COMMISSION  
OF THE STATE OF KANSAS  
NOTICE OF FILING APPLICATION**

**RE:** In the Matter of Postrock Midcontinent Production, LLC  
Application for Commingling of Production in the Stone Family  
Resources 35-1 located in Wilson County, Kansas.

**TO:** All Oil & Gas Producers, Unleased Mineral Interest Owners,  
Landowners, and all persons whomever concerned.

You, and each of you, are hereby notified that Postrock Midcontinent Production, LLC has filed an application to commingle the Riverton, Tebo, Fleming, Croweburg, Bevier, Mulky, Summit and Bartlesville producing formations at the Stone Family Resources 35-1, located in the NW NW, S35-T27S-R16E, Approximately 660 FNL & 660 FWL, Wilson County, Kansas.

Any persons who object to or protest this application shall be required to file their objections or protest with the Conservation Division of the State Corporation Commission of the State of Kansas within fifteen (15) days from the date of this publication. These protests shall be filed pursuant to Commission regulations and must state specific reasons why granting the application may cause waste, violate correlative rights or pollute the natural resources of the State of Kansas.

All persons interested or concerned shall take notice of the foregoing and shall govern themselves accordingly. All person and/or companies wishing to protest this application are required to file a written protest with the Conservation Division of the Kansas Oil and Gas Commission.

Upon the receipt of any protest, the Commission will convene a hearing and protestants will be expected to enter an appearance either through proper legal counsel or as individuals, appearing on their own behalf.

Postrock Midcontinent Production, LLC  
210 Park Avenue, Suite 2750  
Oklahoma City, Oklahoma 73102  
(405) 660-7704

**AFFIDAVIT OF PUBLICATION**

STATE OF KANSAS }  
WILSON COUNTY } ss.

Jeanne Harper being first duly sworn, deposes and says: That she is editor of

**The Neodesha Derrick**

a newspaper printed in the State of Kansas, and published in and of general circulation in Wilson County, Kansas, with a general paid circulation on a monthly basis, and that said newspaper is not a trade, religious or fraternal publication.

Said newspaper is a weekly published at least 50 times a year; has been published continuously and uninterruptedly in said county and state for a period of more than one year prior to the first publication of said notice; and has been admitted at the post office of Neodesha in said county, as second class matter.

That the attached notice is a true copy thereof and was published in the regular and entire issue of said newspaper for one consecutive weeks, the first publication thereof being made aforesaid on the 11<sup>th</sup> day of April, 2013, with subsequent publications being made on the following dates:

\_\_\_\_\_, 20\_\_\_\_, 20\_\_\_\_

Jeanne Harper

Notary's Fee \$ 58.50  
Subscribed and sworn to before me this 11<sup>th</sup> day of

April, 2013

Rhonda J. Hatcher  
Notary Public

**RHONDA J. HATCHER**  
Notary Public - State of Kansas  
My Commission expires 5-5-13  
Appt. Expires 5-5-13

Approved: \_\_\_\_\_

Judge: \_\_\_\_\_



**Affidavit of Notice Served**

**Re:** Application for Commingle of Production or Fluids (ACO-4)

Well Name/API: Stone Family Resources 35-1 / 15-205-27110  
Legal Location: 35-27S-16E

The undersigned hereby certifies that he / she is a duly authorized agent for the applicant, and that on the 19<sup>th</sup> day of April, 2013, a true and correct copy of the application referenced above was delivered or mailed to the following parties:

Michael D. Olson Trust 18676 2000 Rd Buffalo, KS 66717 <b>27-27S-16E, W/2 SE</b>	Dwight C. Olson Revocable Living Trust 20106 Scott Rd Buffalo, KS 66717 <b>26-27S-16E, W/2 SW AND</b> Dwight C. Olson Revocable Living Trust, Evelyn L. Olson Revocable Living Trust 20106 Scott Rd Buffalo, KS 66717 <b>27-27S-16E, E/2 SE</b>
<b>No Current Operators available.          Listed here are unleased mineral owners.</b>	

Signed this 19<sup>th</sup> day of April, 2013.

Jane Cunniff  
Applicant or Duly Authorized Agent

Subscribed and sworn to before me this 19<sup>th</sup> day of April, 2013.

Jani Marie Ferguson My Commission Expires: 11 / 08 / 13  
Notary Public



Conservation Division  
Finney State Office Building  
130 S. Market, Rm. 2078  
Wichita, KS 67202-3802



Phone: 316-337-6200  
Fax: 316-337-6211  
<http://kcc.ks.gov/>

Mark Sievers, Chairman  
Thomas E. Wright, Commissioner  
Shari Feist Albrecht, Commissioner

Sam Brownback, Governor

May 6, 2013

Clark Edwards  
PostRock Midcontinent Production LLC  
Oklahoma Tower  
210 Park Ave, Ste 2750  
Oklahoma City, OK 73102

RE: Approved Commingling CO041327  
Stone Family Resources 35-1, Sec. 35-T27S-R16E, Wilson County  
API No. 15-205-27110-00-00

Dear Mr. Edwards:

Your Application for Commingling (ACO-4) for the above described well, received by the KCC on April 19, 2013, has been reviewed and approved by the Kansas Corporation Commission (KCC) per K.A.R. 82-3-123. Notice was examined and found to be proper per K.A.R. 82-3-135a. No protest had been filed within the 15-day protest period.

Based upon the depth of the Riverton formation perforations, total oil production shall not exceed 100 BOPD and total gas production shall not exceed 50% of the absolute open flow (AOF).

**File form ACO-1 upon re-completion of the well to commingle.**

Commingling ID number CO041327 has been assigned to this approved application. Use this number for well completion reports (ACO-1) and other correspondence that may concern this approved commingling.

Sincerely,

Rick Hestermann  
Production Department