

# ADVANTAGE ELEVATIONS

OIL FIELD SURVEYORS

BOX 8604 - PRATT, KS 67124  
(620) 672-6491

318134

INVOICE NO.

Indian Oil Co., Inc.  
OPERATOR

#1  
NO.

Jeanne  
FARM

Barber  
COUNTY

12 35s 13w  
S T R

1320 FNL & 2310 FWL  
LOCATION

ELEVATION: 1463'

Indian Oil Co., Inc.  
P.O. Box 209  
Medicine Lodge, Kansas  
67104-0209

tank battery  
 lease road

AUTHORIZED BY: Anthony Farrar

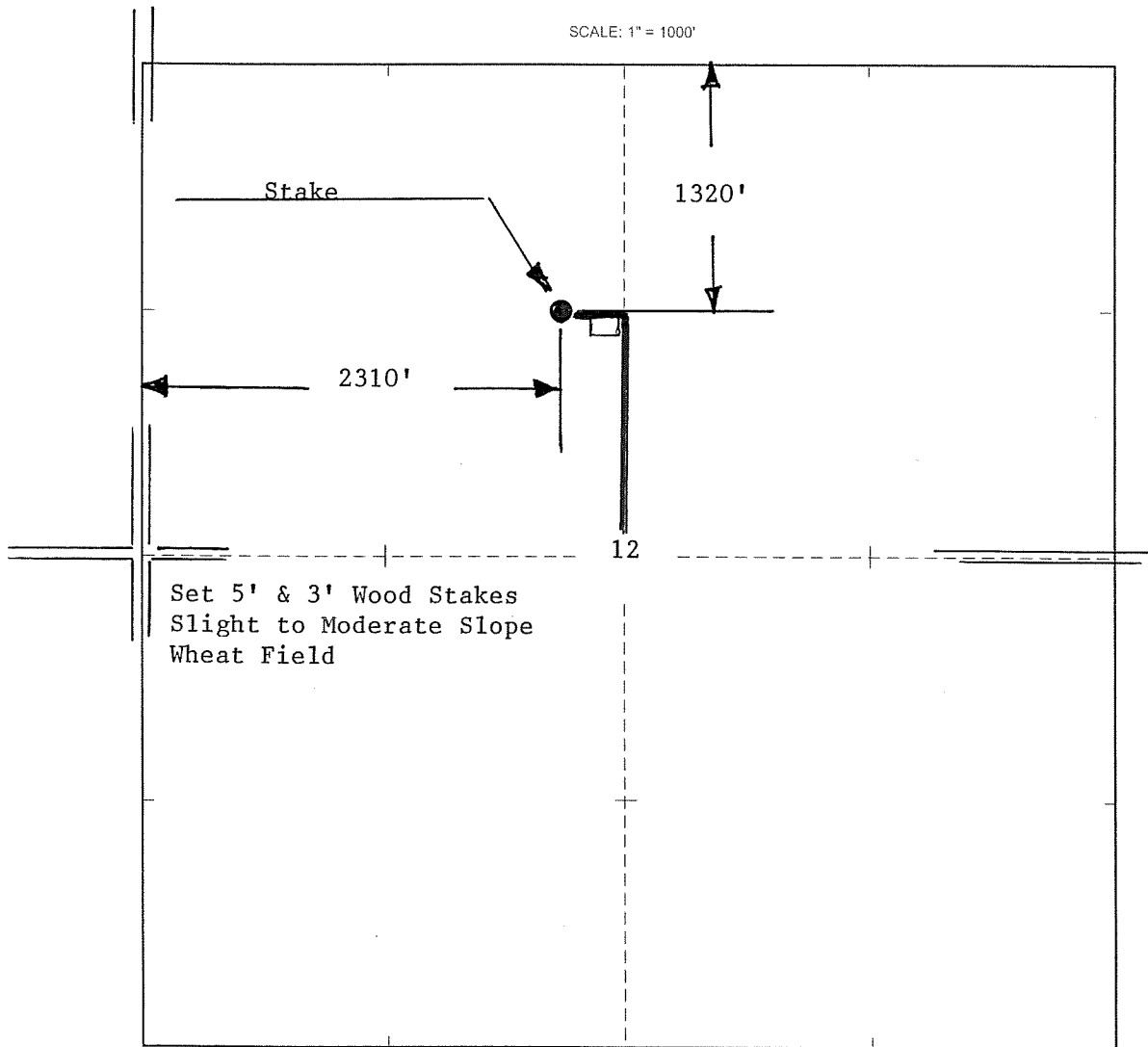

DATE STAKED: March 18, 2013