

If the intended well is in a prorated or spaced field, please fully complete this side of the form. If the intended well is in a prorated or spaced field complete the plat below showing that the well will be properly located in relationship to other wells producing from the common source of supply. Please show all the wells and within 1 mile of the boundaries of the proposed acreage attribution unit for gas wells and within 1/2 mile of the boundaries of the proposed acreage attribution unit for oil wells.

API No. 15 - _____
 Operator: F.G. Holl Company, L.L.C.
 Lease: BINFORD / CAMPBELL
 Well Number: 1-31
 Field: Ash Creek
 Number of Acres attributable to well: 10
 QTR / QTR / QTR of acreage: N/2 N/2 NW

Location of Well: County: Barton
 _____ 400 feet from N / S Line of Section
 _____ 1160 feet from E / W Line of Section
 Sec. 31 Twp. 20 S. R. 15 East West

Is Section: Regular or Irregular

If Section is Irregular, locate well from nearest corner boundary.

Section corner used: NE NW SE SW

PLAT

(Show location of the well and shade acreage for prorated or spaced wells.)
 (Show footage to the nearest lease or unit boundary line.)

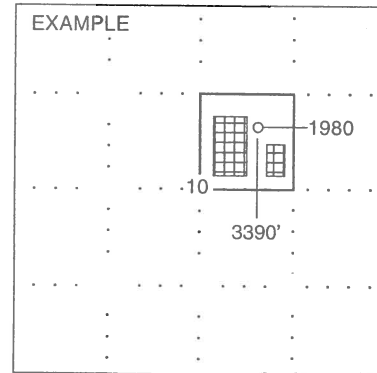
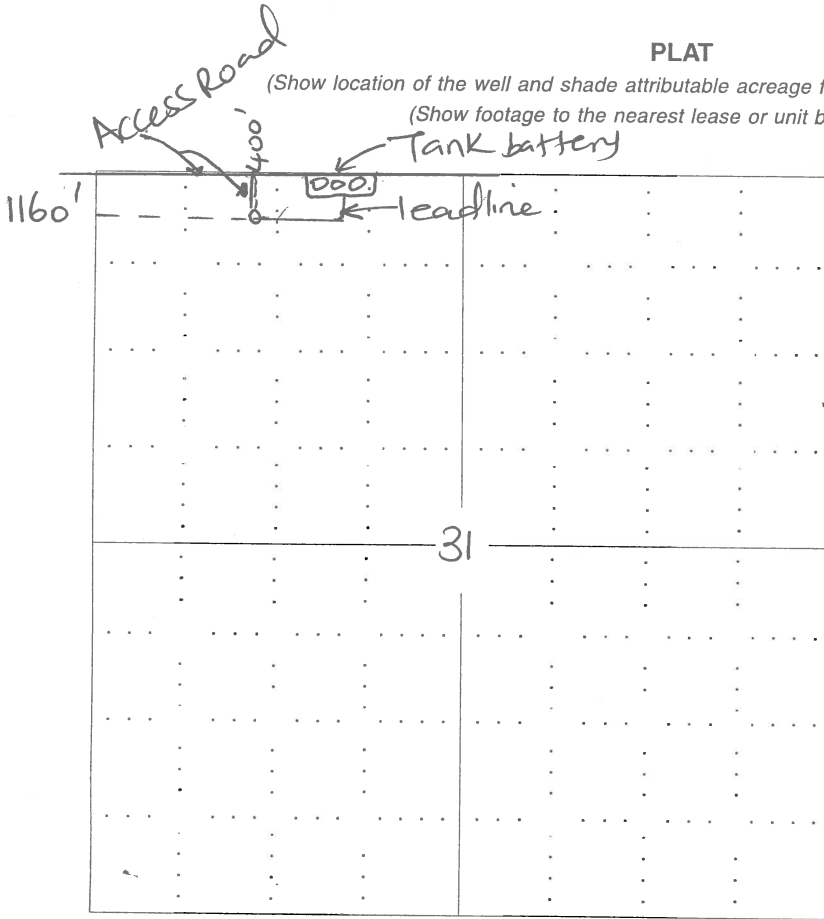

SEWARD CO.

NOTE: In all cases locate the spot of the proposed drilling locaton.



Controlling data is based upon the best maps and photographs available to us and upon a regular section of land containing 640 acres.
 Approximate section lines were determined using the normal standard of care of oilfield surveyors practicing in the state of Kansas. The section corners, which establish the precise section lines, were not necessarily located, and the exact location of the well in the section is not guaranteed. Therefore, the operator assuming this service and accepting this plat and all other services relating hereon agree to hold Central Kansas Oilfield Services, Inc., its officers and employees harmless from all losses, costs and expenses and civil penalties incurred with any liability from incidental or consequential damages.
 Elevations derived from National Geospatial Vertical Datum.

Date April 5, 2013