

**Proposed Plan of Construction**  
 Enterprises A-3  
 Sec 21 T30S-R32W  
 Haskell County, KS

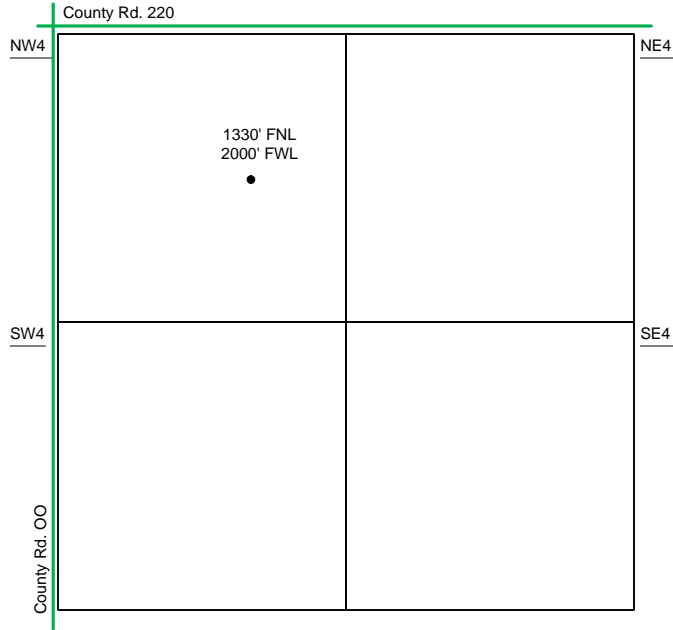

Sec 21 – T30S – R32W

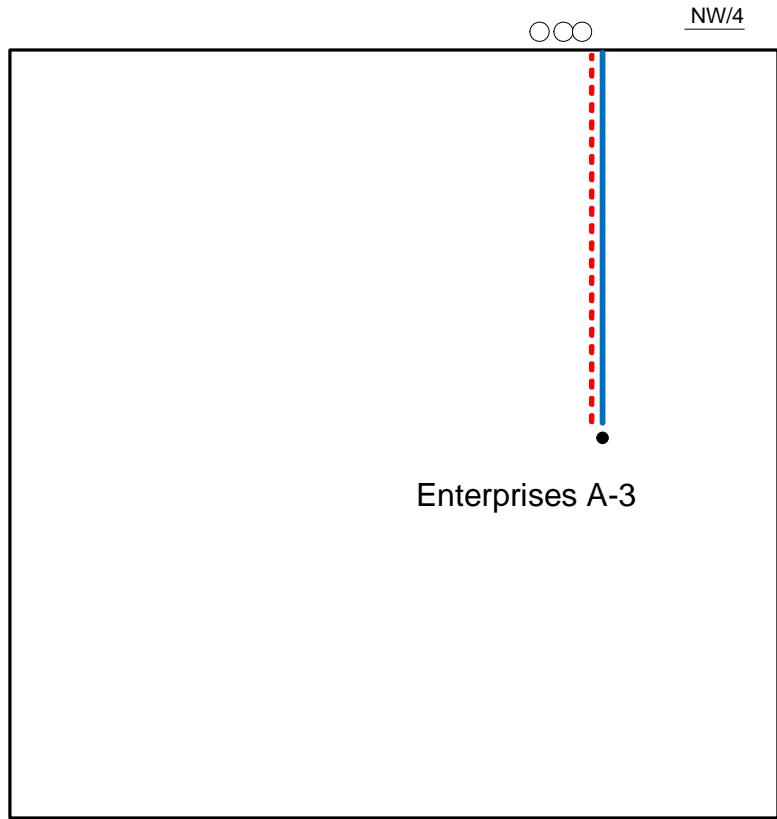

The Tank Battery for the Enterprises A-3 is located in the SE of the SW adjacent quarter.

- Well Location
- Proposed Lease Roads
- - - Proposed Pipeline
- Proposed Tank Battery
- Proposed Power Lines
- - - Existing Pipeline

Proposed Details of  
 NW/4 Sec 21 -T30S -R32W

Note-Drawing **Not** to Scale

