



For KCC Use ONLY

API # 15 - \_\_\_\_\_

### IN ALL CASES PLOT THE INTENDED WELL ON THE PLAT BELOW

In all cases, please fully complete this side of the form. Include items 1 through 5 at the bottom of this page.

Operator: \_\_\_\_\_

Lease: \_\_\_\_\_

Well Number: \_\_\_\_\_

Field: \_\_\_\_\_

Number of Acres attributable to well: \_\_\_\_\_

QTR/QTR/QTR/QTR of acreage: \_\_\_\_\_ - \_\_\_\_\_ - \_\_\_\_\_ - \_\_\_\_\_

Location of Well: County: \_\_\_\_\_

\_\_\_\_\_ feet from  N /  S Line of Section

\_\_\_\_\_ feet from  E /  W Line of Section

Sec. \_\_\_\_\_ Twp. \_\_\_\_\_ S. R. \_\_\_\_\_  E  W

Is Section:  Regular or  Irregular

**If Section is Irregular, locate well from nearest corner boundary.**

Section corner used:  NE  NW  SE  SW

### PLAT

Show location of the well. Show footage to the nearest lease or unit boundary line. Show the predicted locations of lease roads, tank batteries, pipelines and electrical lines, as required by the Kansas Surface Owner Notice Act (House Bill 2032). You may attach a separate plat if desired.

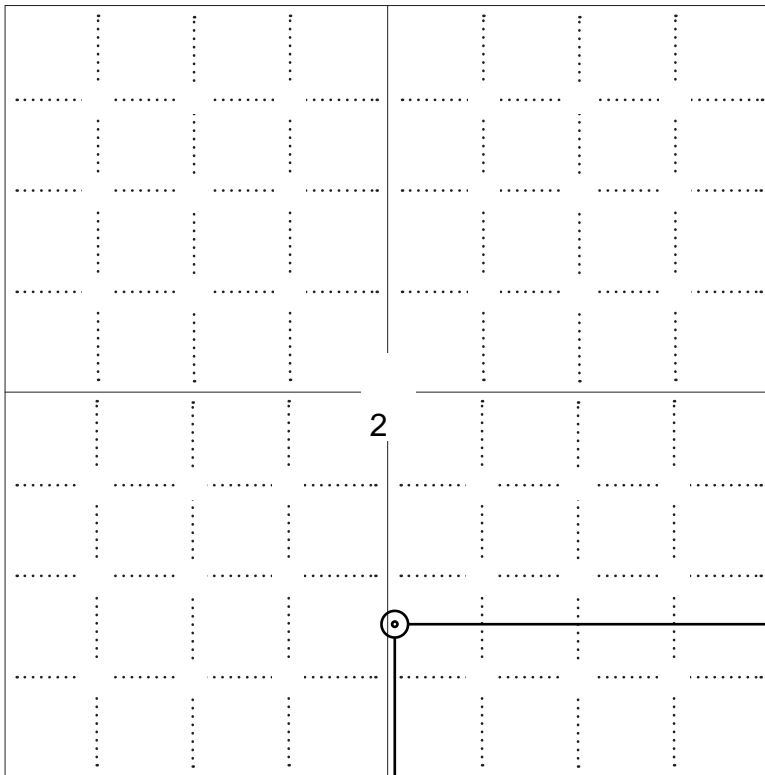

### LEGEND

- Well Location
- Tank Battery Location
- Pipeline Location
- Electric Line Location
- Lease Road Location

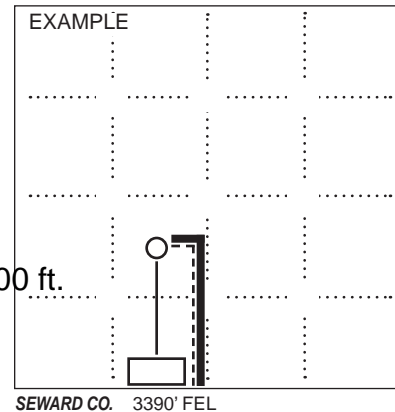

**NOTE: In all cases locate the spot of the proposed drilling location.**

1050 ft.

#### In plotting the proposed location of the well, you must show:

1. The manner in which you are using the depicted plat by identifying section lines, i.e. 1 section, 1 section with 8 surrounding sections, 4 sections, etc.
2. The distance of the proposed drilling location from the south / north and east / west outside section lines.
3. The distance to the nearest lease or unit boundary line (in footage).
4. If proposed location is located within a prorated or spaced field a certificate of acreage attribution plat must be attached: (C0-7 for oil wells; CG-8 for gas wells).
5. The predicted locations of lease roads, tank batteries, pipelines, and electrical lines.

**APPLICATION FOR SURFACE PIT**

*Submit in Duplicate*

Operator Name: _____		License Number: _____	
Operator Address: _____			
Contact Person: _____		Phone Number: _____	
Lease Name & Well No.: _____		Pit Location (QQQQ): _____-_____-_____-_____	
Type of Pit: <input type="checkbox"/> Emergency Pit <input type="checkbox"/> Burn Pit <input type="checkbox"/> Settling Pit <input type="checkbox"/> Drilling Pit <input type="checkbox"/> Workover Pit <input type="checkbox"/> Haul-Off Pit <i>(If WP Supply API No. or Year Drilled)</i>		Pit is: <input type="checkbox"/> Proposed <input type="checkbox"/> Existing If Existing, date constructed: _____ Pit capacity: _____ (bbls)	
Is the pit located in a Sensitive Ground Water Area? <input type="checkbox"/> Yes <input type="checkbox"/> No		Chloride concentration: _____ mg/l <i>(For Emergency Pits and Settling Pits only)</i>	
Is the bottom below ground level? <input type="checkbox"/> Yes <input type="checkbox"/> No		Artificial Liner? <input type="checkbox"/> Yes <input type="checkbox"/> No	
How is the pit lined if a plastic liner is not used? _____			
Pit dimensions (all but working pits): _____ Length (feet)    _____ Width (feet) <input type="checkbox"/> N/A: Steel Pits Depth from ground level to deepest point: _____ (feet) <input type="checkbox"/> No Pit			
If the pit is lined give a brief description of the liner material, thickness and installation procedure.		Describe procedures for periodic maintenance and determining liner integrity, including any special monitoring.	
Distance to nearest water well within one-mile of pit: _____ feet    Depth of water well _____ feet		Depth to shallowest fresh water _____ feet. Source of information: <input type="checkbox"/> measured <input type="checkbox"/> well owner <input type="checkbox"/> electric log <input type="checkbox"/> KDWR	
<b>Emergency, Settling and Burn Pits ONLY:</b> Producing Formation: _____ Number of producing wells on lease: _____ Barrels of fluid produced daily: _____ Does the slope from the tank battery allow all spilled fluids to flow into the pit? <input type="checkbox"/> Yes <input type="checkbox"/> No		<b>Drilling, Workover and Haul-Off Pits ONLY:</b> Type of material utilized in drilling/workover: _____ Number of working pits to be utilized: _____ Abandonment procedure: _____ Drill pits must be closed within 365 days of spud date.	
Submitted Electronically			

**KCC OFFICE USE ONLY**

Liner     Steel Pit     RFAC     RFAS

Date Received: \_\_\_\_\_ Permit Number: \_\_\_\_\_ Permit Date: \_\_\_\_\_ Lease Inspection:     Yes     No



### CERTIFICATION OF COMPLIANCE WITH THE KANSAS SURFACE OWNER NOTIFICATION ACT

*This form must be submitted with all Forms C-1 (Notice of Intent to Drill); CB-1 (Cathodic Protection Borehole Intent); T-1 (Request for Change of Operator Transfer of Injection or Surface Pit Permit); and CP-1 (Well Plugging Application). Any such form submitted without an accompanying Form KSONA-1 will be returned.*

Select the corresponding form being filed:  C-1 (Intent)  CB-1 (Cathodic Protection Borehole Intent)  T-1 (Transfer)  CP-1 (Plugging Application)

OPERATOR: License # \_\_\_\_\_  
Name: \_\_\_\_\_  
Address 1: \_\_\_\_\_  
Address 2: \_\_\_\_\_  
City: \_\_\_\_\_ State: \_\_\_\_\_ Zip: \_\_\_\_\_ + \_\_\_\_\_  
Contact Person: \_\_\_\_\_  
Phone: ( \_\_\_\_\_ ) \_\_\_\_\_ Fax: ( \_\_\_\_\_ ) \_\_\_\_\_  
Email Address: \_\_\_\_\_

Well Location:  
\_\_\_\_ - \_\_\_\_ - \_\_\_\_ - \_\_\_\_ Sec. \_\_\_\_ Twp. \_\_\_\_ S. R. \_\_\_\_  East  West  
County: \_\_\_\_\_  
Lease Name: \_\_\_\_\_ Well #: \_\_\_\_\_

*If filing a Form T-1 for multiple wells on a lease, enter the legal description of the lease below:*

**Surface Owner Information:**

Name: \_\_\_\_\_  
Address 1: \_\_\_\_\_  
Address 2: \_\_\_\_\_  
City: \_\_\_\_\_ State: \_\_\_\_\_ Zip: \_\_\_\_\_ + \_\_\_\_\_

*When filing a Form T-1 involving multiple surface owners, attach an additional sheet listing all of the information to the left for each surface owner. Surface owner information can be found in the records of the register of deeds for the county, and in the real estate property tax records of the county treasurer.*

*If this form is being submitted with a Form C-1 (Intent) or CB-1 (Cathodic Protection Borehole Intent), you must supply the surface owners and the KCC with a plat showing the predicted locations of lease roads, tank batteries, pipelines, and electrical lines. The locations shown on the plat are preliminary non-binding estimates. The locations may be entered on the Form C-1 plat, Form CB-1 plat, or a separate plat may be submitted.*

**Select one of the following:**

- I certify that, pursuant to the Kansas Surface Owner Notice Act (House Bill 2032), I have provided the following to the surface owner(s) of the land upon which the subject well is or will be located: 1) a copy of the Form C-1, Form CB-1, Form T-1, or Form CP-1 that I am filing in connection with this form; 2) if the form being filed is a Form C-1 or Form CB-1, the plat(s) required by this form; and 3) my operator name, address, phone number, fax, and email address.
- I have not provided this information to the surface owner(s). I acknowledge that, because I have not provided this information, the KCC will be required to send this information to the surface owner(s). To mitigate the additional cost of the KCC performing this task, I acknowledge that I am being charged a \$30.00 handling fee, payable to the KCC, which is enclosed with this form.

*If choosing the second option, submit payment of the \$30.00 handling fee with this form. If the fee is not received with this form, the KSONA-1 form and the associated Form C-1, Form CB-1, Form T-1, or Form CP-1 will be returned.*

I Submitted Electronically

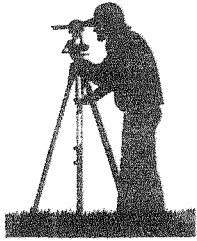

# Fall & Associates

Stake and Elevation Service

718 W. 5<sup>th</sup> Street

P.O. Box 404

Concordia, KS. 66901

1-800-536-2821

Date 3-30-13

Invoice Number 0329132

Murfin Drilling

1-2

Kathka Farms

Operator

Number

Farm Name

Decatur-KS

2

2s

29w

1050'FSL 2600'FEL

County-State

S

T

R

Location

Elevation 2722 Gr.

Murfin Drilling  
250 N. Water  
Suite 300  
Wichita, KS. 67202

Ordered By: Shauna

Scale 1"=1000'

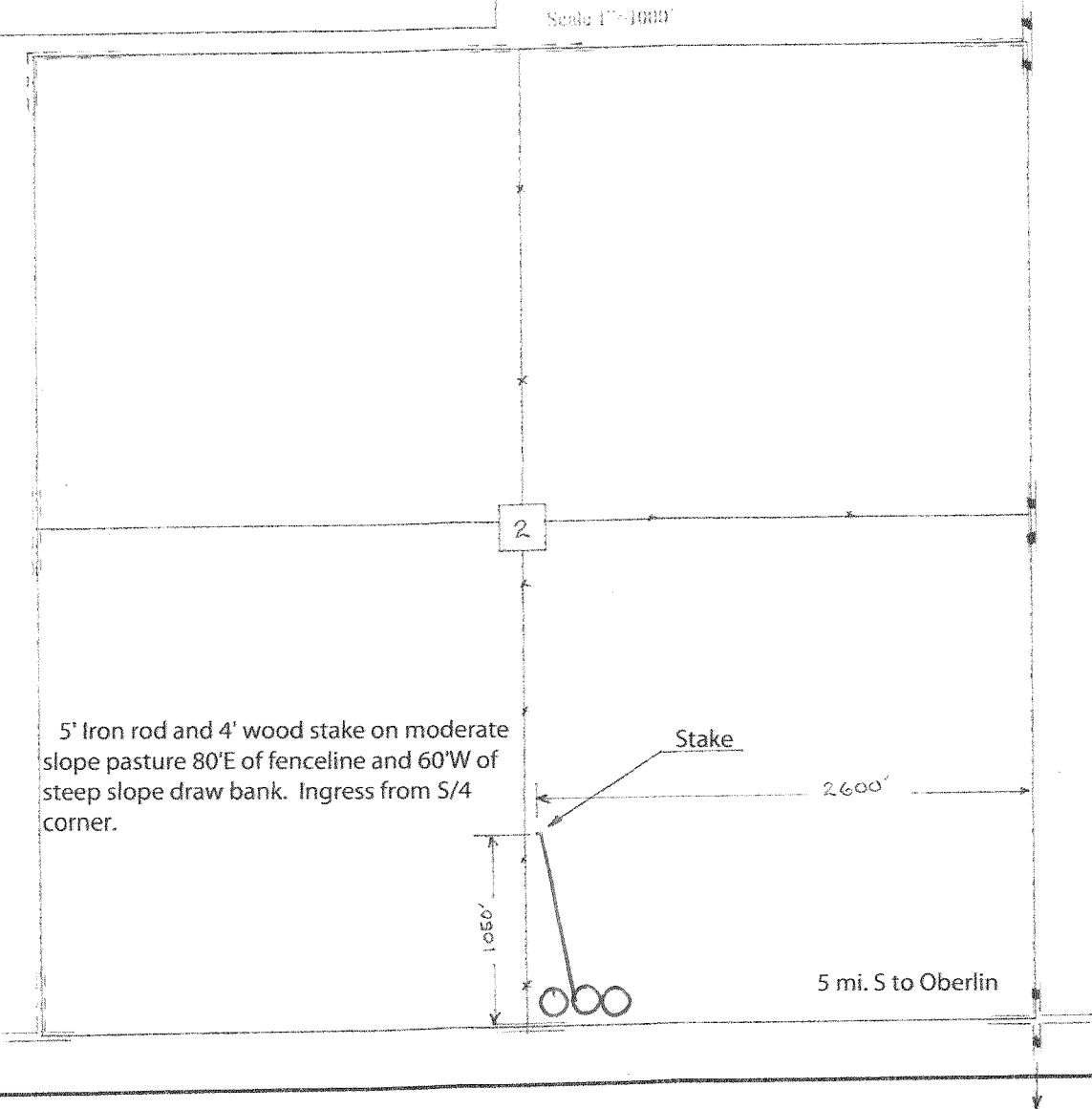

5' Iron rod and 4' wood stake on moderate slope pasture 80'E of fenceline and 60'W of steep slope draw bank. Ingress from S/4 corner.

Stake

2600'

1650'

5 mi. S to Oberlin



63U (Rev. 1993)

OIL AND GAS LEASE

AGREEMENT, Made and entered into the 11<sup>th</sup> day of February, 2011

by and between Kathka Farms LLC, a Kansas Limited Liability Corporation

whose mailing address is 2507 Logan Circle, Colorado Springs, CO 80907 hereinafter called Lessor (whether one or more),

and Murfin Drilling Company, Inc. Telephone 1-800-621-3018  
250 N. Water, Suite 300 Wichita, KS 67202 hereinafter called Lessee:

Lessor, in consideration of One and More Dollars (\$ 1.00 & More ) in hand paid,

receipt of which is here acknowledged and of the royalties herein provided and of the agreements of the lessee herein contained, hereby grants, leases and lets exclusively unto lessee for the purpose of investigating, exploring by geophysical and other means, prospecting drilling, mining and operating for and producing oil, liquid hydrocarbons, all gases, and their respective constituent products, injecting gas, water, other fluids, and air into subsurface strata, laying pipe lines, storing oil, building tanks, power stations, telephone lines, and other structures and things thereon to produce, save, take care of, treat, manufacture, process, store and transport said oil, liquid hydrocarbons, gases and their respective constituent products and other products manufactured therefrom, and housing and otherwise caring for its employees, the following described land, together with any reversionary rights and after-acquired interest, therein situated in County of Decatur State of Kansas Described as follows to wit:

Township 2 South Range 29 West of the 6<sup>th</sup> P.M.  
Section 2: W/2; SE/4  
Section 14: NW/4; E/2

In Section XXX Township XXX Range XXX and containing 960.00 acres, more or less and all accretions thereto

Subject to the provisions herein contained, this lease shall remain in force for a term of Three(3) years from this date (called "primary term"), and as long thereafter as oil, liquid hydrocarbons, gas or other respective constituent products, or any of them, is produced from said land or land with which said land is pooled.

In consideration of the premises the said lessee covenants and agrees:

1st. To deliver to the credit of lessor, free of cost, in the pipe line to which lessee may connect wells on said land, the equal one-eighth (1/8) part of all oil produced and saved from the leased premises.

2nd. To pay lessor for gas of whatsoever nature or kind produced and sold, or used off the premises, or used in the manufacture of any products therefrom, one-eighth (1/8), at the market price at the well, (but, as to gas sold by lessee, in no event more than one-eighth (1/8) of the proceeds received by lessee from such sales), for the gas sold, used off the premises, or in the manufacture of products therefrom, said payments to be made monthly. Where gas from a well producing gas only is not sold or used, lessee may pay or tender as royalty One Dollar (\$1.00) per year per net mineral acre retained hereunder, and if such payment or tender is made it will be considered that gas is being produced within the meaning of the preceding paragraph.

This lease may be maintained during the primary term hereof without further payment or drilling operations. If the lessee shall commence to drill a well within the term of this lease or any extension thereof, the lessee shall have the right to drill such well to completion with reasonable diligence and dispatch, and if oil or gas, or either of them, be found in paying quantities, this lease shall continue and be in force with full effect as if such well had been completed within the term of years first mentioned.

If said lessor owns a lessor's interest in the above described land and undivided fee simple estate therein, then the royalties herein provided for shall be paid the said lessor only in the proportion which lessor's interest bears to the whole and undivided fee.

Lessee shall have the right to use, free of cost, gas, oil and water produced on said land for lessee's operation thereon, except water from the wells of lessor.

When requested by lessor, lessee shall bury lessee's pipe lines below plow depth.

No well shall be drilled nearer than 200 feet to the house or barn now on said premises without written consent of lessor.

Lessee shall pay for damages caused by lessee's operations to growing crops on said land.

Lessee shall have the right at any time to remove all machinery and fixtures placed on said premises, including the right to draw and remove casing.

If the estate of either party hereto is assigned, and the privilege of assigning in whole or in part is expressly allowed, the covenants hereof shall extend to their heirs, executors, administrators, successors or assigns, but no change in the ownership of the land or assignment of rentals or royalties shall be binding on the lessee until after the lessee has been furnished with a written transfer or assignment or a true copy hereof. In case lessee assigns this lease, in whole or in part, lessee shall be relieved of all obligations with respect to the assigned portion or portions arising subsequent to the date of assignment.

Lessee may at any time execute and deliver to lessor or place of record a release or releases covering any portion or portions of the above described premises and thereby surrender this lease as to such portion or portions and be relieved of all obligations as to the acreage surrendered.

All express or implied covenants of this lease shall be subject to all Federal and State Laws, Executive Orders, Rules or Regulations, and this lease shall not be terminated, in whole or in part, nor lessee held liable in damages, for failure to comply therewith, if compliance is prevented by, or if such failure is the result of, any such Law, Order, Rule or Regulation.

Lessor hereby warrants and agrees to defend the title to the lands herein described, and agrees that the lessee shall have the right at any time to redeem for lessor, by payment any mortgages, taxes or other liens on the above described lands, in the event of default of payment by lessor, and be subrogated to the rights of the holder thereof, and the undersigned lessors, for themselves and their heirs, successors and assigns, hereby surrender and release all right of dower and homestead in the premises described herein, in so far as said right of dower and homestead may in any way affect the purposes for which this lease is made, as recited herein.

Lessee, at its option, is hereby given the right and power to pool or combine the acreage covered by this lease or any portion thereof with other land; lease or leases in the immediate vicinity thereof, when in lessee's judgment it is necessary or advisable to do so in order to properly develop and operate said lease premises so as to promote the conservation of oil, gas or other minerals in and under and that may be produced from said premises, such pooling to be of tracts contiguous to one another and to be into a unit or units not exceeding 40 acres each in the event of an oil well, or into a unit or units not exceeding 640 acres each in the event of a gas well. Lessee shall execute in writing and record in the conveyance records of the county in which the land herein leased is situated an instrument identifying and describing the pooled acreage. The entire acreage so pooled into a tract or unit shall be treated, for all purposes except the payment of royalties on production from the pooled unit, as if it were included in this lease. If production is found on the pooled acreage, it shall be treated as if production is had from this lease, whether the well or wells be located on the premises covered by this lease or not. In lieu of the royalties elsewhere herein specified, lessor shall receive on production from a unit so pooled only such portion of the royalty stipulated herein as the amount of his acreage placed in the unit or his royalty interest therein on an acreage basis bears to the total acreage so pooled in the particular unit involved.

\*See rider attached hereto and made a part hereof;

IN WITNESS WHEREOF, the undersigned execute this instrument as of the day and year first above written.

Witnesses:  
Kathka Farms LLC, a Kansas Limited Liability Corporation

x: Marilyn P. Brandhorst  
By: Marilyn P. Brandhorst, Co-President

Maribeth Rex  
By: Maribeth Rex, Co-President

State of Colorado  
County of El Paso

ACKNOWLEDGMENT FOR CORPORATION

ss,

Be it remembered that on this 11<sup>th</sup> day of February, 2011, before me, the undersigned, a Notary Public, duly commissioned, in and for the county and state aforesaid, came Marilyn P. Brandhorst, co-president of Kathka Fars LLC, a Kansas Limited Liability Corporation a corporation of the State of Kansas personally known to me to be such officer, and to be the same person who executed as such officer the foregoing instrument of writing in behalf of said corporation, and she duly acknowledged the execution of the same for herself and for said corporation for the uses and purposes therein set forth

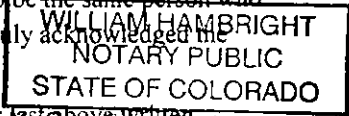

IN WITNESS WHEREOF, I have hereunto set my hand and official seal on the day and year last above written. My commission expires: 03/31/2012

William Hambright  
Notary Public

State of Nevada  
County of Washoe

ACKNOWLEDGMENT FOR CORPORATION

ss,

Be it remembered that on this 16<sup>th</sup> day of February, 2011, before me, the undersigned, a Notary Public, duly commissioned, in and for the county and state aforesaid, came Maribeth Rex, co-president of Kathka Farms LLC, a Kansas Limited Liability Corporation a corporation of the State of Nevada personally known to me to be such officer, and to be the same person who executed as such officer the foregoing instrument of writing in behalf of said corporation, and she duly acknowledged the execution of the same for herself and for said corporation for the uses and purposes therein set forth.

IN WITNESS WHEREOF, I have hereunto set my hand and official seal on the day and year last above written. My commission expires: 08/16/2014

Johnie Sue Bussard  
Notary Public

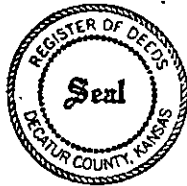
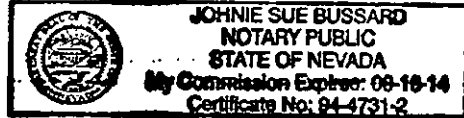

STATE OF KANSAS, DECATUR COUNTY, SS:  
THIS INSTRUMENT WAS FILED FOR RECORD ON  
THE 23rd DAY OF March, 2011,  
AT 10:20 O'CLOCK A.M AND RECORDED IN  
BOOK B22 PAGE 74 FEE \$ 16.00

Kari L. Ketterl  
REGISTER OF DEEDS-DECATUR COUNTY  
KARI L KETTERL

Judy B Gaumer  
by JUDY B GAUMER, Deputy

**RIDER**

1. When preparing development locations, the topsoil shall be segregated to be replaced on the surface upon completion of drilling activities. Any terraces driven over or altered for drilling or tank locations shall be restored to original height and contour as nearly as is practicable.
2. In the event of drilling operations on said land, Lessee or assigns agree to bury pipe lines below plow depth. Lessee or assigns agree to backfill all slush pits, level the location and restore the surface as nearly as is practicable. Lessee or assigns agrees to pay for all damages of any nature arising from its operations on the above land.
3. It is understood and agreed that upon the termination of production on the Lease, all equipment of Lessee shall be removed within six (6) months and all sites shall be restored to their original condition as nearly as is practicable.
4. Upon the completion of any drilling operations or any seismographic testing the Lessee shall leave no waste material, litter or other debris on said premises and shall restore said premises as nearly as practicable to the condition the premises were in prior to Lessee's operations.
5. A sufficient dike shall be placed around tank batteries. Also tank batteries and pumping equipment units shall be fenced to restrain cattle in pastures or on ground that Lessor grazes cattle. Lessor shall not be held liable for any damage to Lessee's equipment caused by Lessor's livestock. It is further understood and agreed that Lessee shall consult with Lessor in regard to the location of tank batteries.
6. If the lands covered hereby are irrigated by the use of a self-propelled overhead sprinkler system, presently in operation or installed hereafter, the Lessee, prior to conducting operations hereon, shall consult with the Lessor in regard to said drilling operations. Said operations shall be conducted in such a manner as will least disturb or interfere with Lessor's irrigation system or the surface contours of the leased premises. Should any alterations to the surface contours be caused by its operations, Lessee, or his assigns, shall restore said surface contours to their former condition as nearly as is practicable. In the event of production and continued use of the surface, Lessee, or his assigns, will restore or prepare the surface and situate and install all equipment needed in connection therewith, so that Lessee's use thereof will not interfere with the passage of said overhead sprinkler irrigation systems. Lessee shall consult with Lessor in regard to the route of ingress and egress on said premises for the purpose of drilling and production.
7. If any part of the leased premises are subject to or enrolled in the Conservation Reserve Program, Lessee shall reseed to grass all acres thereof affected by Lessee's operations and hold Lessor harmless from penalties or liquidated damages assessed under the Conservation Reserve Program as a result of Lessee's operations.
8. If at the end of the primary term, this lease is not otherwise continued in force under the provisions hereof, this lease shall expire, unless Lessee on or before the end of the primary term shall pay or tender to Lessor, the sum equal to the original per acre bonus paid to lessor under the initial primary term of said lease multiplied by the number of net mineral acres owned by Lessor in the land above described and then subject to this lease the primary term shall be extended for an additional three (3) years from the end of the primary term hereof.

**Kathka Farms LLC, a Kansas Limited Liability Corporation**

X:   
Marilyn P. Brandhorst, Co-President

X:   
Maribeth Rex, Co-President



Conservation Division  
Finney State Office Building  
130 S. Market, Rm. 2078  
Wichita, KS 67202-3802



Phone: 316-337-6200  
Fax: 316-337-6211  
<http://kcc.ks.gov/>

Mark Sievers, Chairman  
Thomas E. Wright, Commissioner  
Shari Feist Albrecht, Commissioner

Sam Brownback, Governor

May 07, 2013

Shauna Gunzelman  
Murfin Drilling Co., Inc.  
250 N WATER STE 300  
WICHITA, KS 67202-1216

Re: Drilling Pit Application  
Kathka Farms 1-2  
SE/4 Sec.02-02S-29W  
Decatur County, Kansas

Dear Shauna Gunzelman:

District staff has inspected the above referenced location and has determined that the reserve pit shall be constructed **without slots**, the bottom shall be flat and reasonably level, and the free fluids must be removed. The fluids are to be removed from the reserve pit as soon as practical after drilling operations have ceased. KEEP PITS away from draw/drainage.

**If production casing is set all completion fluids shall be removed from the working pits daily. NO completion fluids or non-exempt wastes shall be placed in the reserve pit.**

The fluids should be taken to an authorized disposal well. Please call the District Office at (785) 625-0550 when the fluids have been removed. Please file form CDP-5 (August 2008), Exploration and Production Waste Transfer, through KOLAR within 30 days of fluid removal.

**A copy of this letter should be posted in the doghouse along with the approved Intent to Drill.** If you have any questions or concerns please feel free to contact the District Office at (785) 625-0550.