



APPLICATION FOR COMMINGLING OF PRODUCTION (K.A.R. 82-3-123) OR FLUIDS (K.A.R. 82-3-123a) *Commingling ID # _____*

OPERATOR: License # _____ API No. 15 - _____
Name: _____ Spot Description: _____
Address 1: _____ - - - - - Sec. _____ Twp. _____ S. R. _____ East West
Address 2: _____ Feet from North / South Line of Section
City: _____ State: _____ Zip: _____ + _____ Feet from East / West Line of Section
Contact Person: _____ County: _____
Phone: (_____) _____ Lease Name: _____ Well #: _____

1. Name and upper and lower limit of each production interval to be commingled:
Formation: _____ (Perfs): _____
Formation: _____ (Perfs): _____
Formation: _____ (Perfs): _____
Formation: _____ (Perfs): _____
Formation: _____ (Perfs): _____

2. Estimated amount of fluid production to be commingled from each interval:
Formation: _____ BOPD: _____ MCFPD: _____ BWPD: _____
Formation: _____ BOPD: _____ MCFPD: _____ BWPD: _____
Formation: _____ BOPD: _____ MCFPD: _____ BWPD: _____
Formation: _____ BOPD: _____ MCFPD: _____ BWPD: _____
Formation: _____ BOPD: _____ MCFPD: _____ BWPD: _____

3. Plat map showing the location of the subject well, all other wells on the subject lease, and all wells on offsetting leases within a 1/2 mile radius of the subject well, and for each well the names and addresses of the lessee of record or operator.

4. Signed certificate showing service of the application and affidavit of publication as required in K.A.R. 82-3-135a.

For Commingling of PRODUCTION ONLY, include the following:

- 5. Wireline log of subject well. Previously Filed with ACO-1: Yes No
- 6. Complete Form ACO-1 (*Well Completion form*) for the subject well.

For Commingling of FLUIDS ONLY, include the following:

- 7. Well construction diagram of subject well.
- 8. Any available water chemistry data demonstrating the compatibility of the fluids to be commingled.

AFFIDAVIT: I am the affiant and hereby certify that to the best of my current information, knowledge and personal belief, this request for commingling is true and proper and I have no information or knowledge, which is inconsistent with the information supplied in this application.

Submitted Electronically

KCC Office Use Only
 Denied Approved
15-Day Periods Ends: _____
Approved By: _____ Date: _____

Protests may be filed by any party having a valid interest in the application. Protests must be in writing and comply with K.A.R. 82-3-135b and must be filed within 15 days of publication of the notice of application.

R 22 W

T 16 S

T 17 S

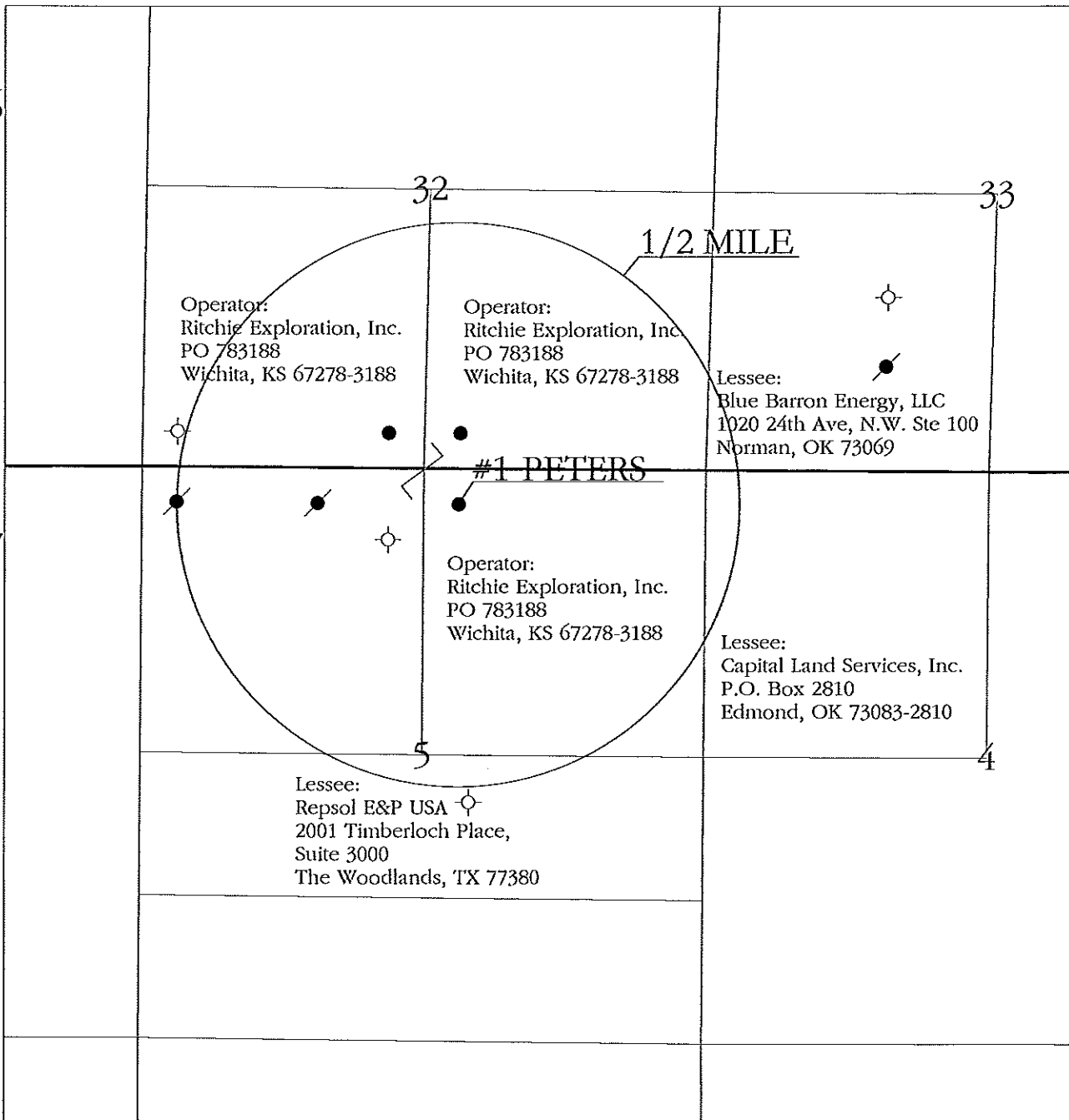

Legend

- Oil Well
- / Abandoned Oil Well
- ⊕ Dry and Abandoned Well

 RITCHIE EXPLORATION, INC. Wichita, Kansas		Application for Commingling of Production or Fluids
Applicant Well: #1 Peters All Wells on Offsetting Leases within 1/2 Mile Radius Name and Address of Lessee of Record or Operator On Offsetting Leases Ness County, Kansas		
Prepared By: Justin Clegg	Scale: 1 : 18,000	Date: April 16, 2013

APPLICATION FOR COMMINGLING OF PRODUCTION OR FLUIDS

**Operator, Lessee or Unleased Mineral Owner
within a ½ mile radius of Ritchie Exploration, Inc.'s**

**#1 Peters
330' FNL & 2310' FEL
Section 5-17S-22W
Ness Co., KS**

Township 16 South, Range 22 West

Sec. 32:	SW/4	Ritchie Exploration, Inc. P.O. Box 783188 Wichita, KS 67278-3188	Operator: #1 Musselman
	SE/4	Ritchie Exploration, Inc.	Operator: #2 Klitzke 5B-32D
Sec. 33:	SW/4	Blue Baron Energy, LLC 1020 24 th Ave. N.W., Ste. 100 Norman, OK 73069	Lessee

Township 17 South, Range 22 West

Sec. 4:	NW/4	Capital Land Services, Inc. P.O. Box 2810 Edmond, OK 73083-2810	Lessee
Sec. 5:	NW/4	Ritchie Exploration, Inc.	Operator: #2 Klitzke 5B-32D
	NE/4	Ritchie Exploration, Inc.	Operator: #1 Peters
	N/2S/2	Repsol E&P USA 2001 Timberloch Place, Suite 3000 The Woodlands, TX 77380	Lessee

AFFIDAVIT

STATE OF KANSAS)
 - SS.
County of Sedgwick)

John Niernberger, of lawful age, being first duly sworn, deposeth and saith: That he is Production Manager of Ritchie Exploration, County of Sedgwick, State of Kansas, and that notice was given to all lessee of record or operator within ½ mile radius of the Peters #1 well located in the County of Ness (see attached plat map). This notice included a letter and a copy of the Commingle Application (ACO-4). All notices were mailed on April 16, 2013.

made as aforesaid on the 8th of
May A.D. 2013

And affiant further says that he has personal knowledge of the statements above set forth and that they are true.

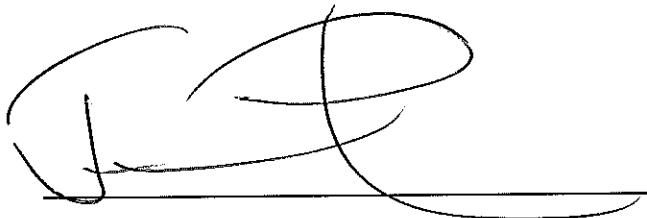

Subscribed and sworn to before me this

8th day of May 2013

KAREN HOPPER
NOTARY PUBLIC-STATE OF KANSAS
MY APPT. EXPIRES 3-8-15

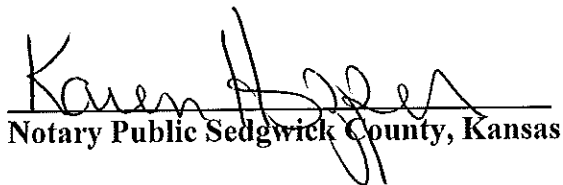

Notary Public Sedgwick County, Kansas

AFFIDAVIT

STATE OF KANSAS \
- SS.
County of Sedgwick /

Mark Fletchall, of lawful age, being first duly sworn, depose and saith: That he is Record Clerk of The Wichita Eagle, a daily newspaper published in the City of Wichita, County of Sedgwick, State of Kansas, and having a general paid circulation on a daily basis in said County, which said newspaper has been continuously and uninterruptedly published in said County for more than one year prior to the first publication of the notice hereinafter mentioned, and which said newspaper has been entered as second class mail matter at the United States Post Office in Wichita, Kansas, and which said newspaper is not a trade, religious or fraternal publication and that a notice of a true copy is hereto attached was published in the regular and entire Morning issue of said The Wichita Eagle for 1 issues - weeks, that the first publication of said notice was

made as aforesaid on the 20th of

April A.D. 2013, with

subsequent publications being made on the following dates:

And affiant further says that he has personal knowledge of the statements above set forth and that they are true.

Mark Fletchall

Subscribed and sworn to before me this

8th of May, 2013

PENNY L. CASE
Notary Public - State of Kansas
My Appt. Expires 5/28/2015

Penny L Case
Notary Public Sedgwick County, Kansas

Printers Fee: \$72.00

230 Legal Notices

LEGAL NOTICE

You, and each of you, are hereby notified that Ritchie Exploration, Inc. has filed an application to commence the commingling of production from the Fort Scott, Cherokee, Conglomerate, and Mississippian sources of supply for the #1 Peters well located approx. NW NW NE of Section 5-17S-22W, Ness County, Kansas. Any persons who object to or protest this application shall be required to file their objections or protests with the Conservation Division of the State Corporation Commission of the State of Kansas within fifteen (15) days from the date of the publication. These protests shall be filed pursuant to Commission regulations and must state specific reasons why the grant of the application may cause waste, violate correlative rights or pollute the natural resources of the state of Kansas. If no protests are received, this application may be granted through a summary proceeding. If valid protests are received, this matter will be set for hearing. All persons interested or concerned shall take notice of the foregoing and shall govern themselves accordingly.

Ritchie Exploration, Inc.
P.O. Box 783188
Wichita, KS 67278-3188
(316) 691-9500

First published in the Ness County News on Thursday, April 25, 2013 -1t

LEGAL NOTICE

You, and each of you, are hereby notified that Ritchie Exploration, Inc. has filed an application to commence the commingling of production from the Fort Scott, Cherokee, Conglomerate, and Mississippian sources of supply for the #1 Peters well located approx. NW NW NE of Section 5-17S-22W, Ness County, Kansas.

Any persons who object to or protest this application shall be required to file their objections or protests with the Conservation Division of the State Corporation Commission of the State of Kansas within fifteen (15) days from the date of the publication. These protests shall be filed pursuant to Commission regulations and must state specific reasons why the grant of the application may cause waste, violate correlative rights or pollute the natural resources of the state of Kansas.

If no protests are received, this application may be granted through a summary proceeding. If valid protests are received, this matter will be set for hearing.

All persons interested or concerned shall take notice of the foregoing and shall govern themselves accordingly.

RITCHIE EXPLORATION, INC.
P.O. Box 783188
Wichita, KS 67278-3188
(316) 691-9500

STATE OF KANSAS, COUNTY OF NESS, ss:

Jerry Clarke, being first duly sworn, Deposes and says: that he is Publisher of The Ness County News, a weekly newspaper, published and printed in Ness City, State of Kansas, and published in and of general circulation in Ness County, Kansas, with a general paid circulation on a weekly basis in Ness County, Kansas, and that said newspaper is not a trade, religious or fraternal publication.

Said newspaper is a weekly published at least 50 times a year; has been so published continuously and uninterruptedly in said county and state for a period of more than five years prior to the first publication of said notice; and has been admitted at the post office of Ness City, in said County as second class mail matter.

That the attached notice is a true copy thereof and was published in the regular and entire issue of said newspaper for 1 consecutive weeks, the first publication thereof being made as aforesaid on the 25th day of April, 2013, with subsequent publications being made on the following dates:

_____, 20____, _____, 20____
_____, 20____, _____, 20____
_____, 20____, _____, 20____

Jerry Clarke, Jerry Clarke, editor

Subscribed and sworn to before me this 25th day of April, 2013

NOTARY PUBLIC - State of Kansas
AMANDA HAWKINS
My Appt Exp. 07/21/2013

Amanda Hawkins
Amanda Hawkins, Notary Public.

Publication Fee _____ \$ 33.75
Additional Copies @ _____ \$ _____
Total Publication Fees _____ \$ 33.75

Filed this _____ day of _____, 20____.

Attached Proof Of Publication approved this _____ day of _____, 20____

District Magistrate Judge

Filed this _____ day of _____, 20____.

Clerk of the District Court.

Attached Proof Of Publication approved this _____ day of _____, 20____

Judge Twenty-fourth Judicial District.

KANSAS CORPORATION COMMISSION
OIL & GAS CONSERVATION DIVISION

Form ACO-1
June 2009
Form Must Be Typed
Form must be Signed
All blanks must be Filled

WELL COMPLETION FORM
WELL HISTORY - DESCRIPTION OF WELL & LEASE

OPERATOR: License # 4767
Name: Ritchie Exploration, Inc.
Address 1: P.O. Box 783188
Address 2: _____
City: Wichita State: KS Zip: 67278 + 3188
Contact Person: John Niernberger
Phone: (316) 691-9500
CONTRACTOR: License # _____
Name: _____
Wellsite Geologist: _____
Purchaser: NCRA

Designate Type of Completion:
 New Well Re-Entry Workover
 Oil WSW SWD SIOW
 Gas D&A ENHR SIGW
 OG GSW Temp. Abd.
 CM (Coal Bed Methane)
 Cathodic Other (Core, Expl., etc.): _____

If Workover/Re-entry: Old Well Info as follows:
Operator: Ritchie Exploration
Well Name: Peters
Original Comp. Date: 9/6/85 Original Total Depth: 4407'
 Deepening Re-perf. Conv. to ENHR Conv. to SWD
 Conv. to GSW
 Plug Back: _____ Plug Back Total Depth _____
 Commingled Permit #: _____
 Dual Completion Permit #: _____
 SWD Permit #: _____
 ENHR Permit #: _____
 GSW Permit #: _____

<u>1/25/11</u>	<u>1/25/11</u>	<u>2/14/11</u>
Spud Date or Recompletion Date	Date Reached TD	Completion Date or Recompletion Date

API No. 15 - 135-22,885
Spot Description: _____
NW NW NE Sec. 5 Twp. 17 S. R. 22 East West
330 Feet from North / South Line of Section
2,310 Feet from East / West Line of Section
Footages Calculated from Nearest Outside Section Corner:
 NE NW SE SW
County: Ness
Lease Name: Peters Well #: 1
Field Name: Weeks North
Producing Formation: Fort Scott, Cherokee, Conglomerate, Mississippian
Elevation: Ground: 2384' Kelly Bushing: 2389'
Total Depth: 4407' Plug Back Total Depth: _____
Amount of Surface Pipe Set and Cemented at: 219 Feet
Multiple Stage Cementing Collar Used? Yes No
If yes, show depth set: _____ Feet
If Alternate II completion, cement circulated from: _____
feet depth to: _____ w/ _____ sx cmt.

Drilling Fluid Management Plan
(Data must be collected from the Reserve Pit)
Chloride content: _____ ppm Fluid volume: _____ bbls
Dewatering method used: _____
Location of fluid disposal if hauled offsite: _____
Operator Name: _____
Lease Name: _____ License #: _____
Quarter _____ Sec. _____ Twp. _____ S. R. _____ East West
County: _____ Permit #: _____

INSTRUCTIONS: An original and two copies of this form shall be filed with the Kansas Corporation Commission, 130 S. Market - Room 2078, Wichita, Kansas 67202, within 120 days of the spud date, recompletion, workover or conversion of a well. Rule 82-3-130, 82-3-106 and 82-3-107 apply. Information of side two of this form will be held confidential for a period of 12 months if requested in writing and submitted with the form (see rule 82-3-107 for confidentiality in excess of 12 months). One copy of all wireline logs and geologist well report shall be attached with this form. ALL CEMENTING TICKETS MUST BE ATTACHED. Submit CP-4 form with all plugged wells. Submit CP-111 form with all temporarily abandoned wells.

AFFIDAVIT
I am the affiant and I hereby certify that all requirements of the statutes, rules and regulations promulgated to regulate the oil and gas industry have been fully complied with and the statements herein are complete and correct to the best of my knowledge.
Signature: _____
Title: Production Manager Date: 4/1/11

KCC Office Use ONLY

Letter of Confidentiality Received
Date: _____
 Confidential Release Date: _____
 Wireline Log Received
 Geologist Report Received
 UIC Distribution
ALT I II III Approved by: _____ Date: _____

Operator Name: Ritchie Exploration, Inc. Lease Name: Peters Well #: 1
 Sec. 5 Twp. 17 S. R. 22 East West County: Ness

INSTRUCTIONS: Show important tops and base of formations penetrated. Detail all cores. Report all final copies of drill stems tests giving interval tested, time tool open and closed, flowing and shut-in pressures, whether shut-in pressure reached static level, hydrostatic pressures, bottom hole temperature, fluid recovery, and flow rates if gas to surface test, along with final chart(s). Attach extra sheet if more space is needed. Attach complete copy of all Electric Wire-line Logs surveyed. Attach final geological well site report.

Drill Stem Tests Taken <input checked="" type="checkbox"/> Yes <input type="checkbox"/> No <i>(Attach Additional Sheets)</i> Samples Sent to Geological Survey <input checked="" type="checkbox"/> Yes <input type="checkbox"/> No Cores Taken <input type="checkbox"/> Yes <input checked="" type="checkbox"/> No Electric Log Run <input checked="" type="checkbox"/> Yes <input type="checkbox"/> No Electric Log Submitted Electronically <input type="checkbox"/> Yes <input checked="" type="checkbox"/> No <i>(if no, Submit Copy)</i> List All E. Logs Run: RA Guard Log,	<input checked="" type="checkbox"/> Log Formation (Top), Depth and Datum <input type="checkbox"/> Sample Name Top Datum SEE ATTACHED
--	--

CASING RECORD <input checked="" type="checkbox"/> New <input type="checkbox"/> Used							
Report all strings set-conductor, surface, intermediate, production, etc.							
Purpose of String	Size Hole Drilled	Size Casing Set (In O.D.)	Weight Lbs. / Ft.	Setting Depth	Type of Cement	# Sacks Used	Type and Percent Additives
surface	12-1/4	8 5/8	23	219	common	150	
production	7 7/8	5.50	14	4394	60/40 poz	120	

ADDITIONAL CEMENTING / SQUEEZE RECORD				
Purpose:	Depth Top Bottom	Type of Cement	# Sacks Used	Type and Percent Additives
<input type="checkbox"/> Perforate				
<input type="checkbox"/> Protect Casing				
<input type="checkbox"/> Plug Back TD				
<input type="checkbox"/> Plug Off Zone				

Shots Per Foot	PERFORATION RECORD - Bridge Plugs Set/Type Specify Footage of Each Interval Perforated	Acid, Fracture, Shot, Cement Squeeze Record (Amount and Kind of Material Used)	Depth
	4394' - 4407' (Miss OH) (CIBP @ 4385' set 09-03-85) (**drilled out 02-04-11)	500 gals 7.5% MCA (08-29-85), *** 500 gals 15% NE/DSFE (02-07-11)	
4	4304' - 4307' (Cherokee) (09-03-85), 4307' - 4309.5' (12-30-85)	*** 750 gals 7.5% Pentall-200 Acid+7.5% Acetic (01-31-11)	
4	4370' - 4375' (Conglomerate) (12-27-85)	1200 gal 7.5%+additives (12-28-85)	
2	4286' - 4289' (Fort Scott) (12-31-85)	600 gal 28% NE (01-02-86)	

TUBING RECORD: Size: <u>2 7/8"</u> Set At: <u>4397'</u> Packer At:		Liner Run: <input type="checkbox"/> Yes <input checked="" type="checkbox"/> No
Date of First, Resumed Production, SWD or ENHR.		Producing Method: <input type="checkbox"/> Flowing <input checked="" type="checkbox"/> Pumping <input type="checkbox"/> Gas Lift <input type="checkbox"/> Other (Explain) _____
Estimated Production Per 24 Hours	Oil Bbls. <u>6.68</u> Gas Mcf	Water Bbls. <u>3.34</u> Gas-Oil Ratio Gravity

DISPOSITION OF GAS: <input type="checkbox"/> Vented <input type="checkbox"/> Sold <input type="checkbox"/> Used on Lease <i>(if vented, Submit ACO-18.)</i>	METHOD OF COMPLETION: <input type="checkbox"/> Open Hole <input checked="" type="checkbox"/> Perf. <input type="checkbox"/> Dually Comp. <input checked="" type="checkbox"/> Commingled <i>(Submit ACO-5) (Submit ACO-4)</i> <input type="checkbox"/> Other (Specify) _____	PRODUCTION INTERVAL: _____ _____
---	--	--



#1 Peters
 330' FNL & 2310' FEL or NW NW-NE
 Section 5-17S-22W
 Ness County, Kansas
 API# 15-135-22,885
 Elevation: 2384' GL: 2389' KB

DRILLING REPORT

Sample Tops		Ref. Well	Log Tops		Ref. Well
Anhydrite	1694'	+695 -2	Anhydrite	1693'	+694 -3
B/Anhydrite	1729'	+660 -2	B/Anhydrite	1725'	+664 -2
Heebner	3781'	-1392 -1	Heebner	3779'	-1390 +1
Toronto	3801'	-1412 -1	Toronto	3800'	-1411 flat
Lansing	3818'	-1429 flat	Lansing	3816'	-1427 +2
B/KC	4098'	-1709 -2	B/KC	4088'	-1699 +8
Pawnee	4200'	-1811 -4	Pawnee	4188'	-1799 +8
Ft. Scott	4281'	-1892 +13	Ft. Scott	4282'	-1893 +12
Cherokee Shale	4300'	-1911 +10	Cherokee Shale	4299'	-1910 +11
Cherokee Sand	4304'	-1915 +9	Cherokee Sand	4304'	-1915 +9
Basal Sand	4378'	-1986 +10	Basal Sand	4367'	-1978 +25
Mississippian	4396'	-2007 +20	Mississippian	4394'	-2005 +19
RTD	4400'	-2011	LTD	4401'	-2012

May 23, 2013

John Niernberger
Ritchie Exploration, Inc.
P.O. Box 783188
Wichita, KS 67278-3188

RE: Approved Commingling CO051303
Peters 1, Sec.5-T17S-R22W, Ness County
API No. 15-135-22885-00-01

Dear Mr. Niernberger:

Your Application for Commingling (ACO-4) for the above described well has been reviewed and approved by the Kansas Corporation Commission (KCC) per K.A.R. 82-3-123. Notice was examined and found to be proper per K.A.R. 82-3-135a. No protest had been filed within the 15-day protest period. This application, which was received by the KCC on May 8, 2013, concerns approval to simultaneously produce from the following sources of supply through the same tubing string in the same wellbore:

Source of Supply	Estimated Current Production			Perf Depth
	BOPD	MCFPD	BWPD	
Fort Scott	0.26	0.00	0.00	4286-4289
Cherokee	1.42	0.00	0.00	4304-4309
Conglomerate	0.49	0.00	0.00	4370-4375
Mississippian	4.51	0.00	3.34	4394-4407
Total Estimated Current Production	6.68	0.00	3.34	

Based upon the depth of the Mississippian formation perforations, total oil production shall not exceed 200 BOPD and total gas production shall not exceed 50% of the absolute open flow (AOF).

Commingling ID number CO051303 has been assigned to this approved application. Use this number for well completion reports (ACO-1) and other correspondence that may concern this approved commingling.

Sincerely,

Rick Hestermann
Production Department