

For KCC Use ONLY

API # 15 - _____

IN ALL CASES PLOT THE INTENDED WELL ON THE PLAT BELOW

In all cases, please fully complete this side of the form. Include items 1 through 5 at the bottom of this page.

Operator: _____

Lease: _____

Well Number: _____

Field: _____

Number of Acres attributable to well: _____

QTR/QTR/QTR/QTR of acreage: _____ - _____ - _____ - _____

Location of Well: County: _____

_____ feet from N / S Line of Section

_____ feet from E / W Line of Section

Sec. _____ Twp. _____ S. R. _____ E W

Is Section: Regular or Irregular

If Section is Irregular, locate well from nearest corner boundary.

Section corner used: NE NW SE SW

PLAT

Show location of the well. Show footage to the nearest lease or unit boundary line. Show the predicted locations of lease roads, tank batteries, pipelines and electrical lines, as required by the Kansas Surface Owner Notice Act (House Bill 2032). You may attach a separate plat if desired.

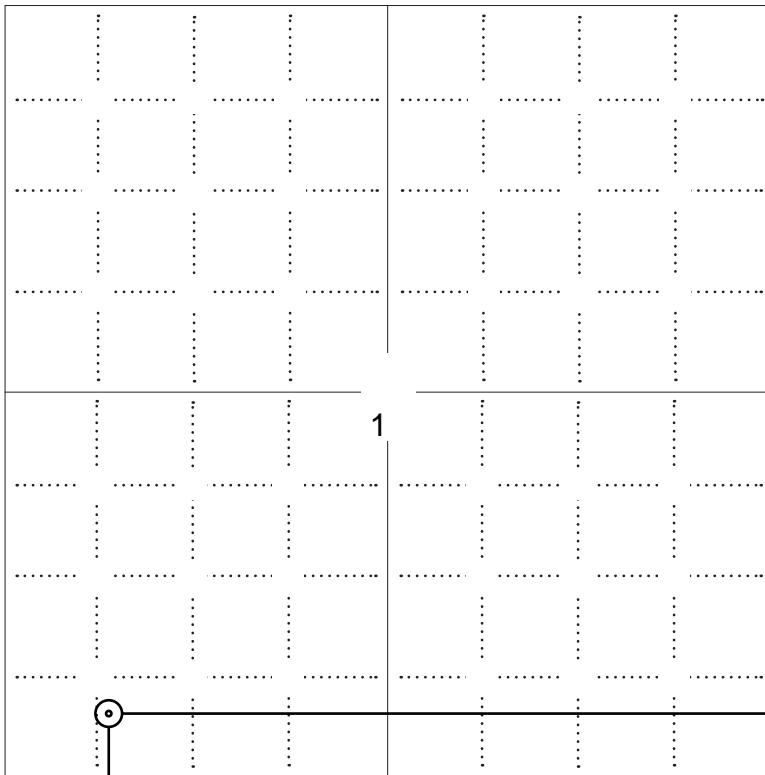

LEGEND

- Well Location
- Tank Battery Location
- Pipeline Location
- Electric Line Location
- Lease Road Location

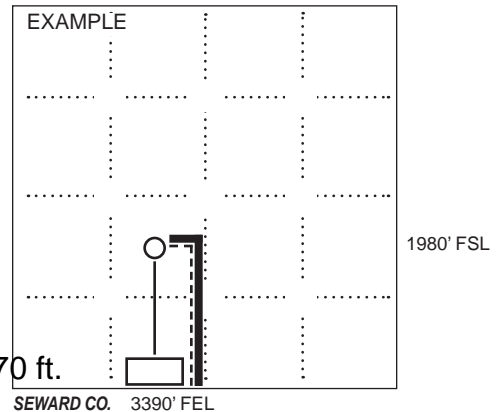

NOTE: In all cases locate the spot of the proposed drilling location.

440 ft.

In plotting the proposed location of the well, you must show:

1. The manner in which you are using the depicted plat by identifying section lines, i.e. 1 section, 1 section with 8 surrounding sections, 4 sections, etc.
2. The distance of the proposed drilling location from the south / north and east / west outside section lines.
3. The distance to the nearest lease or unit boundary line (in footage).
4. If proposed location is located within a prorated or spaced field a certificate of acreage attribution plat must be attached: (C0-7 for oil wells; CG-8 for gas wells).
5. The predicted locations of lease roads, tank batteries, pipelines, and electrical lines.

APPLICATION FOR SURFACE PIT

Submit in Duplicate

Operator Name: _____		License Number: _____	
Operator Address: _____			
Contact Person: _____		Phone Number: _____	
Lease Name & Well No.: _____		Pit Location (QQQQ): _____-_____-_____-_____	
Type of Pit: <input type="checkbox"/> Emergency Pit <input type="checkbox"/> Burn Pit <input type="checkbox"/> Settling Pit <input type="checkbox"/> Drilling Pit <input type="checkbox"/> Workover Pit <input type="checkbox"/> Haul-Off Pit <i>(If WP Supply API No. or Year Drilled)</i>		Pit is: <input type="checkbox"/> Proposed <input type="checkbox"/> Existing If Existing, date constructed: _____ Pit capacity: _____ (bbls)	
Is the pit located in a Sensitive Ground Water Area? <input type="checkbox"/> Yes <input type="checkbox"/> No		Chloride concentration: _____ mg/l <i>(For Emergency Pits and Settling Pits only)</i>	
Is the bottom below ground level? <input type="checkbox"/> Yes <input type="checkbox"/> No		Artificial Liner? <input type="checkbox"/> Yes <input type="checkbox"/> No	
How is the pit lined if a plastic liner is not used? _____			
Pit dimensions (all but working pits): _____ Length (feet) _____ Width (feet) <input type="checkbox"/> N/A: Steel Pits Depth from ground level to deepest point: _____ (feet) <input type="checkbox"/> No Pit			
If the pit is lined give a brief description of the liner material, thickness and installation procedure.		Describe procedures for periodic maintenance and determining liner integrity, including any special monitoring.	
Distance to nearest water well within one-mile of pit: _____ feet Depth of water well _____ feet		Depth to shallowest fresh water _____ feet. Source of information: <input type="checkbox"/> measured <input type="checkbox"/> well owner <input type="checkbox"/> electric log <input type="checkbox"/> KDWR	
Emergency, Settling and Burn Pits ONLY: Producing Formation: _____ Number of producing wells on lease: _____ Barrels of fluid produced daily: _____ Does the slope from the tank battery allow all spilled fluids to flow into the pit? <input type="checkbox"/> Yes <input type="checkbox"/> No		Drilling, Workover and Haul-Off Pits ONLY: Type of material utilized in drilling/workover: _____ Number of working pits to be utilized: _____ Abandonment procedure: _____ Drill pits must be closed within 365 days of spud date.	
Submitted Electronically			

KCC OFFICE USE ONLY

Liner Steel Pit RFAC RFAS

Date Received: _____ Permit Number: _____ Permit Date: _____ Lease Inspection: Yes No



CERTIFICATION OF COMPLIANCE WITH THE KANSAS SURFACE OWNER NOTIFICATION ACT

This form must be submitted with all Forms C-1 (Notice of Intent to Drill); CB-1 (Cathodic Protection Borehole Intent); T-1 (Request for Change of Operator Transfer of Injection or Surface Pit Permit); and CP-1 (Well Plugging Application). Any such form submitted without an accompanying Form KSONA-1 will be returned.

Select the corresponding form being filed: C-1 (Intent) CB-1 (Cathodic Protection Borehole Intent) T-1 (Transfer) CP-1 (Plugging Application)

OPERATOR: License # _____
Name: _____
Address 1: _____
Address 2: _____
City: _____ State: _____ Zip: _____ + _____
Contact Person: _____
Phone: (_____) _____ Fax: (_____) _____
Email Address: _____

Well Location:
____ - ____ - ____ - ____ Sec. ____ Twp. ____ S. R. ____ East West
County: _____
Lease Name: _____ Well #: _____

If filing a Form T-1 for multiple wells on a lease, enter the legal description of the lease below:

Surface Owner Information:

Name: _____
Address 1: _____
Address 2: _____
City: _____ State: _____ Zip: _____ + _____

When filing a Form T-1 involving multiple surface owners, attach an additional sheet listing all of the information to the left for each surface owner. Surface owner information can be found in the records of the register of deeds for the county, and in the real estate property tax records of the county treasurer.

If this form is being submitted with a Form C-1 (Intent) or CB-1 (Cathodic Protection Borehole Intent), you must supply the surface owners and the KCC with a plat showing the predicted locations of lease roads, tank batteries, pipelines, and electrical lines. The locations shown on the plat are preliminary non-binding estimates. The locations may be entered on the Form C-1 plat, Form CB-1 plat, or a separate plat may be submitted.

Select one of the following:

- I certify that, pursuant to the Kansas Surface Owner Notice Act (House Bill 2032), I have provided the following to the surface owner(s) of the land upon which the subject well is or will be located: 1) a copy of the Form C-1, Form CB-1, Form T-1, or Form CP-1 that I am filing in connection with this form; 2) if the form being filed is a Form C-1 or Form CB-1, the plat(s) required by this form; and 3) my operator name, address, phone number, fax, and email address.
- I have not provided this information to the surface owner(s). I acknowledge that, because I have not provided this information, the KCC will be required to send this information to the surface owner(s). To mitigate the additional cost of the KCC performing this task, I acknowledge that I am being charged a \$30.00 handling fee, payable to the KCC, which is enclosed with this form.

If choosing the second option, submit payment of the \$30.00 handling fee with this form. If the fee is not received with this form, the KSONA-1 form and the associated Form C-1, Form CB-1, Form T-1, or Form CP-1 will be returned.

I Submitted Electronically

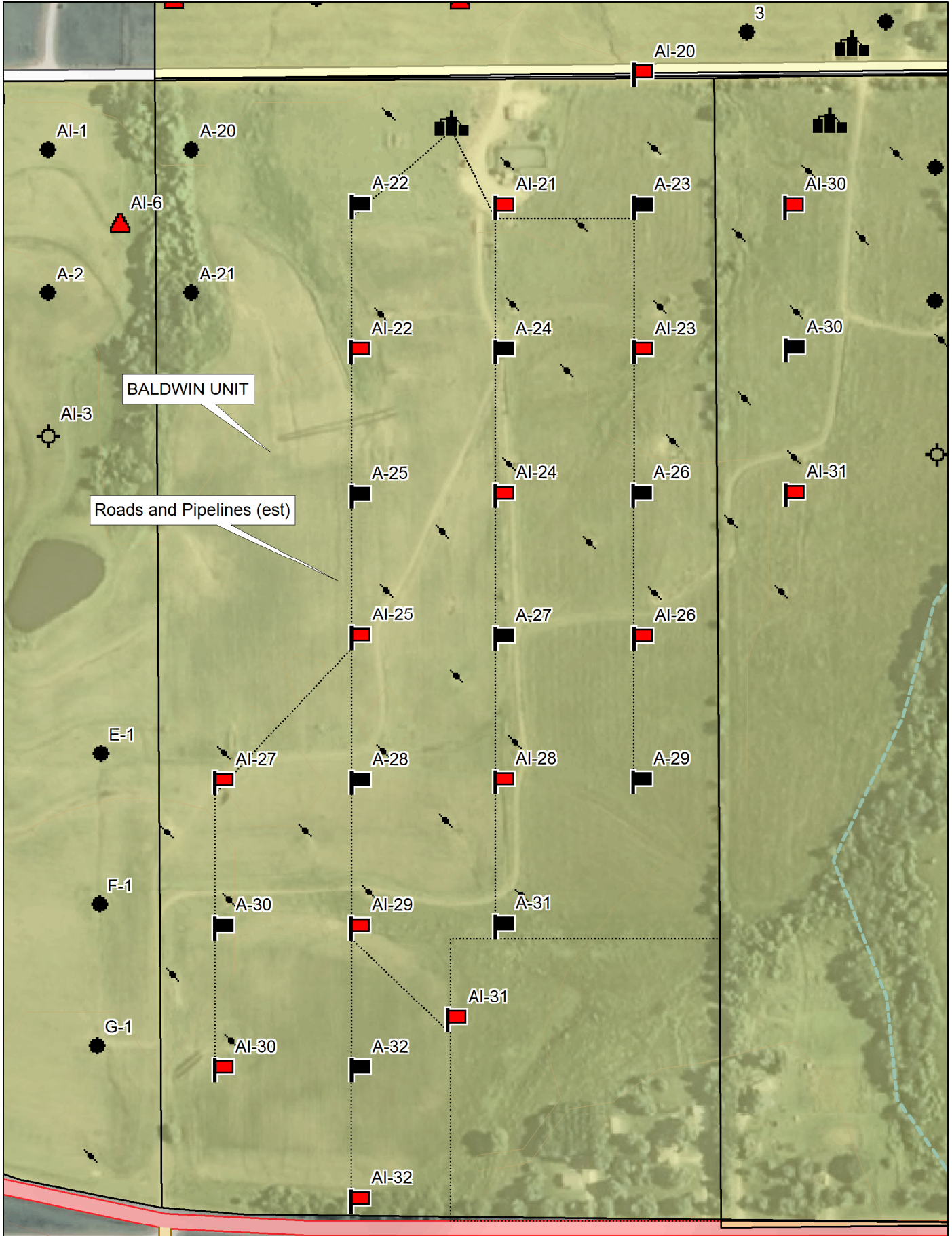

**NOTICE TO OPERATORS FILING INTENT TO DRILL
FOR DISPOSAL OR ENHANCED RECOVERY
INJECTION WELLS, (CLASS II INJECTION WELL)**

The attached approved Notice of Intent to Drill indicates the proposed well is to be used for injection. An approved "Intent to Drill" does not approve injection authority as a Class II Injection Well in Kansas.

Before any well is used for injection purposes, the operator must file an application for injection authority in accordance with K.A.R. 82-3-401 and provide notice in accordance with K.A.R. 82-3-402. The Conservation Division must issue a written permit granting the application before commencement of injection.

The Conservation Division requirements and restrictions associated with Class II Injection are identified in K.A.R. 82-3-400 et seq of our regulations. Associated regulations governing drilling, completion and injection applications may be found in K.A.R. 82-3-135, Table I, Table II, in the Cedar Hills Sandstone Moratorium, (Docket #156,397-C), and the Eastern Kansas Surface Casing Order, (Docket #133,891-C).

If you have questions regarding the approval of injection authority, an injection application may be filed as a "Design Approval" before actual drilling and completion of the well occurs. If you have any questions or concerns regarding Class II injection wells or regulations, call the Underground Injection Control Department at 316-337-6200.

Failure to obtain commission approval before beginning injection is punishable by a penalty, shut-in of the well or both.



Scan of WWC5 Form

WATER WELL RECORD
KSA 82a-1201-1215

Kansas State Dept. Of Health
(Water Well Contractors)
Forbes-Bldg. 740
Topeka, Kansas 66620

95.14530 38.7C852

SE SW SW

1 Location of well:	County: <u>Douglas</u>	Township name:	Fraction: <u>SW-SW</u>	Section number: <u>1</u>	Town number: <u>T155</u>	Range number: <u>R20E</u>
Distance and direction from nearest town or city: <u>East of Baldwin about 4 miles.</u>			3 Owner of well: <u>Clyde Bell</u> Address: <u>Baldwin RR 3</u>			

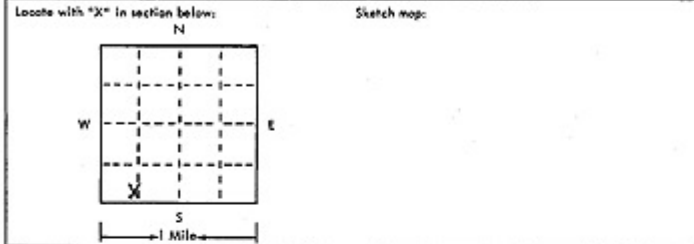

4 Well depth: _____ ft. Date of completion 8-3-75
Well diameter _____ in.

5 Cable tool Rotary Driven Dug
 Hollow rod Jetted Bored Reverse rotary

6 Use: Domestic Public supply Industry
 Irrigation Air conditioning Commercial
 Test well

7 Casing: Material PLASTIC Height: above/below
Threaded Welded Surface _____ in.
Diam. _____ in. Weight _____ lbs./ft.
_____ in. to _____ ft. depth Drive shoe? Yes No
_____ in. to _____ ft. depth

2	Type and color of material	From	To
	<u>Old Well cleaned if out</u>		
	<u>drill down to 91 ft.</u>		
	<u>old well was 82 ft.</u>		
	<u>Brought cases above ground</u>		
	<u>cemented down to 18 ft from 3rd top</u>		
	<u>put in underground dis.</u>		
	<u>put old pump back in.</u>		
	<u>owner will take care</u>		
	<u>of the rest.</u>		

8 Screen:
Manufacturer _____
Type _____ Dia. _____
Slot/ gauze _____ Length _____
Set between _____ ft. and _____ ft.
Fittings:
Gravel pack Yes No Size range of material _____

9 Static water level:
15 ft. below land surface Date 8-3-75

10 Pumping level below land surfaces:
_____ ft. after _____ hrs. pumping _____ g.p.m.
_____ ft. after _____ hrs. pumping _____ g.p.m.
Estimated maximum yield _____ g.p.m.

11 Water sample submitted:
 Yes No Date _____

12 Well head completion:
 Pileless adapter Inches above grade

13 Well grouted? Yes No
 Neat cement Bentonite _____
Depth: From _____ ft. to _____ ft.

14 Nearest source of possible contamination:
ft. _____ Direction _____ Type _____
Well disinfected upon completion? Yes No

15 Pump: Not installed
Manufacturer's name _____
Model number _____ HP _____ Volts _____
Length of drop pipe _____ ft. capacity _____ g.m.p.
Types:
 Submersible Turbine
 Jet Reciprocating
 Centrifugal Other

16 Remarks: elevation ~1040'
Topography: ~1064'
 Hill Slope Upland Valley

17 Water well contractor's certification:
This well was drilled under my jurisdiction and this report is true to the best of my knowledge and belief.
Kenneth Schrey
Business name _____ License No. _____
Address RR 3 Baldwin Kansas
Signed Kenneth Schrey Date 8-4-75
Authorized representative

Forward the white blue and pink copies to the Kansas State Dept. Of Health Form WWC-6

Kansas Geological Survey
Comments to webadmin@kgs.ku.edu
URL=http://www.kgs.ku.edu/Magellan/WaterWell/index.html
Display Programs Updated July 29, 2004
Data added continuously.



ALTAVISTA ENERGY, INC
OIL DEVELOPMENT, LEASING & OPERATING

P. O. Box 128
WELLSVILLE, KS 66092
(785) 883-4057

May 15, 2013

Delbert Sheldon
1518 N 300th Rd
Baldwin City, KS 66006

RE: Oil and Water Injection Well Drilling by Altavista Energy, Inc.

Mr. Sheldon,

Altavista Energy, Inc. is the current owner and operator of the Baldwin Unit Oil Lease, which includes your property. Per our conversation on May 15th, we are going to be drilling a couple new wells on the lease that are within 660 feet of the water well that services your rental property along 56 highway. This does not inherently pose any concern from an environmental or contamination standpoint, but we are required in cases such as this to notify the water well owner of our drilling activity. This letter serves as your notification.

As I'm sure you are aware, there are numerous oil and injection wells in your area. The wells we intend to drill that are within 660 feet of your water well are no different in design than any of the existing wells, and likely will be better-constructed given the modern well completion techniques we utilize. If you have any questions or concerns, feel free to contact me and we can discuss. Or you may contact the Kansas Corporation Commission.

Regards,

Phil Frick
Land and Compliance
Altavista Energy, Inc.
785-883-4057
dephil@dpeweb.com

May 22, 2013

Phil Frick
Altavista Energy, Inc.
4595 K-33 Highway
PO BOX 128
WELLSVILLE, KS 66092

Re: Drilling Pit Application
API 15-045-21985-00-00
Baldwin Unit AI-31
SW/4 Sec.01-15S-20E
Douglas County, Kansas

Dear Phil Frick:

District staff has inspected the above referenced location and has determined that the reserve pit shall be constructed **without slots**, the bottom shall be flat and reasonably level, and the free fluids must be removed. The fluids are to be removed from the reserve pit as soon as practical after drilling operations have ceased.

If production casing is set all completion fluids shall be removed from the working pits daily. NO completion fluids or non-exempt wastes shall be placed in the reserve pit.

The fluids should be taken to an authorized disposal well. Please call the District Office at (620) 432-2300 when the fluids have been removed. Please file form CDP-5 (August 2008), Exploration and Production Waste Transfer, through KOLAR within 30 days of fluid removal.

A copy of this letter should be posted in the doghouse along with the approved Intent to Drill. If you have any questions or concerns please feel free to contact the District Office at (620) 432-2300.