

**Proposed Plan of Construction**  
 Branstetter Chester Unit #410  
 Sec 31 T27S-R33W  
 Haskell County, KS

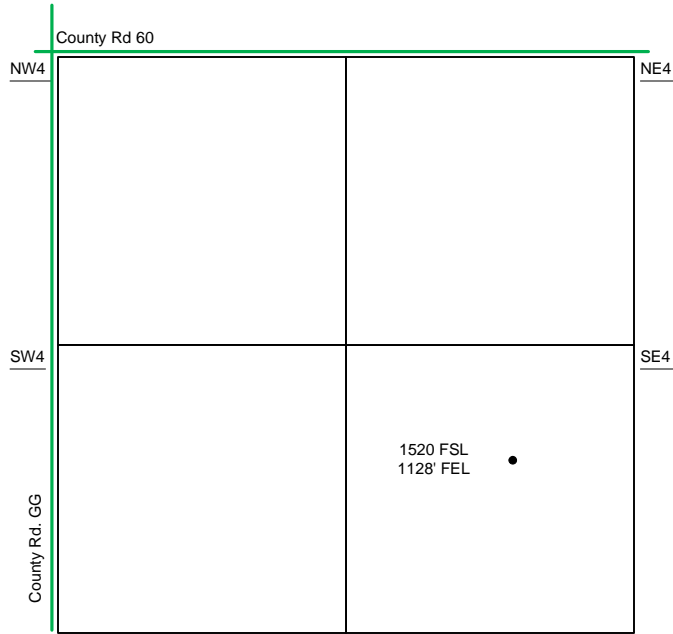

Sec 31 – T27S – R33W

SE/4

The Tank Battery for the Branstetter Chester Unit #410 is located in the NW of the SW quarter.

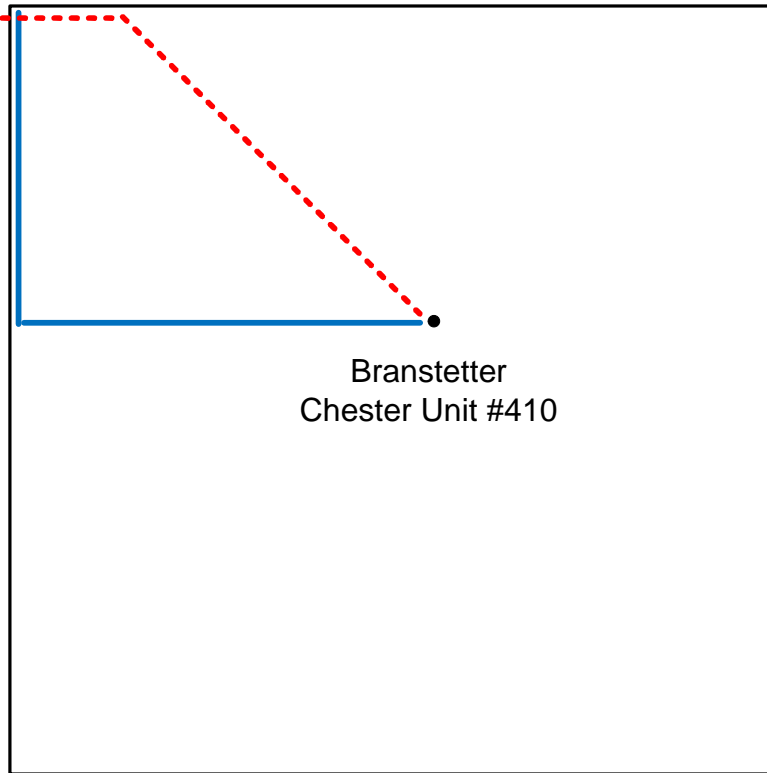

- Well Location
- Proposed Lease Roads
- - - Proposed Pipeline
- Proposed Tank Battery
- Proposed Power Lines
- - - Existing Pipeline

Proposed Details of  
SE/4 Sec 31 -T27S -R33W

Note-Drawing **Not** to Scale

Proposed Site Diagram  
 Branstetter Chester  
 Unit #410  
 May 2, 2013

