

For KCC Use ONLY

API # 15 - _____

IN ALL CASES PLOT THE INTENDED WELL ON THE PLAT BELOW

In all cases, please fully complete this side of the form. Include items 1 through 5 at the bottom of this page.

Operator: _____

Lease: _____

Well Number: _____

Field: _____

Number of Acres attributable to well: _____

QTR/QTR/QTR/QTR of acreage: _____ - _____ - _____ - _____

Location of Well: County: _____

_____ feet from N / S Line of Section

_____ feet from E / W Line of Section

Sec. _____ Twp. _____ S. R. _____ E W

Is Section: Regular or Irregular

If Section is Irregular, locate well from nearest corner boundary.

Section corner used: NE NW SE SW

PLAT

Show location of the well. Show footage to the nearest lease or unit boundary line. Show the predicted locations of lease roads, tank batteries, pipelines and electrical lines, as required by the Kansas Surface Owner Notice Act (House Bill 2032). You may attach a separate plat if desired.

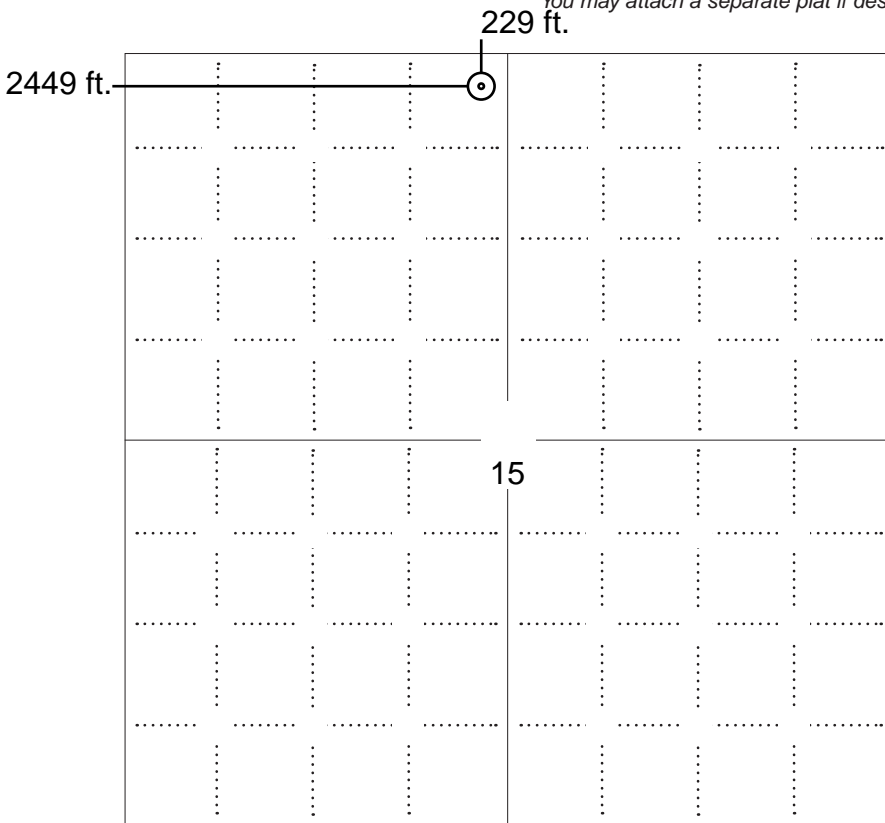

LEGEND

- Well Location
- Tank Battery Location
- Pipeline Location
- Electric Line Location
- Lease Road Location



NOTE: In all cases locate the spot of the proposed drilling locaton.

In plotting the proposed location of the well, you must show:

1. The manner in which you are using the depicted plat by identifying section lines, i.e. 1 section, 1 section with 8 surrounding sections, 4 sections, etc.
2. The distance of the proposed drilling location from the south / north and east / west outside section lines.
3. The distance to the nearest lease or unit boundary line (in footage).
4. If proposed location is located within a prorated or spaced field a certificate of acreage attribution plat must be attached: (C0-7 for oil wells; CG-8 for gas wells).
5. The predicted locations of lease roads, tank batteries, pipelines, and electrical lines.



APPLICATION FOR SURFACE PIT

Submit in Duplicate

Operator Name:		License Number:	
Operator Address:			
Contact Person:		Phone Number:	
Lease Name & Well No.:		Pit Location (QQQQ): ____ - ____ - ____ - ____	
Type of Pit: <input type="checkbox"/> Emergency Pit <input type="checkbox"/> Burn Pit <input type="checkbox"/> Settling Pit <input type="checkbox"/> Drilling Pit <input type="checkbox"/> Workover Pit <input type="checkbox"/> Haul-Off Pit <i>(If WP Supply API No. or Year Drilled)</i>		Pit is: <input type="checkbox"/> Proposed <input type="checkbox"/> Existing If Existing, date constructed: _____ Pit capacity: _____ (bbls)	
Is the pit located in a Sensitive Ground Water Area? <input type="checkbox"/> Yes <input type="checkbox"/> No		Chloride concentration: _____ mg/l <i>(For Emergency Pits and Settling Pits only)</i>	
Is the bottom below ground level? <input type="checkbox"/> Yes <input type="checkbox"/> No		Artificial Liner? <input type="checkbox"/> Yes <input type="checkbox"/> No	
How is the pit lined if a plastic liner is not used?		_____	
Pit dimensions (all but working pits): _____ Length (feet) _____ Width (feet) <input type="checkbox"/> N/A: Steel Pits Depth from ground level to deepest point: _____ (feet) <input type="checkbox"/> No Pit			
If the pit is lined give a brief description of the liner material, thickness and installation procedure.		Describe procedures for periodic maintenance and determining liner integrity, including any special monitoring.	
Distance to nearest water well within one-mile of pit: _____ feet Depth of water well _____ feet		Depth to shallowest fresh water _____ feet. Source of information: <input type="checkbox"/> measured <input type="checkbox"/> well owner <input type="checkbox"/> electric log <input type="checkbox"/> KDWR	
Emergency, Settling and Burn Pits ONLY: Producing Formation: _____ Number of producing wells on lease: _____ Barrels of fluid produced daily: _____ Does the slope from the tank battery allow all spilled fluids to flow into the pit? <input type="checkbox"/> Yes <input type="checkbox"/> No		Drilling, Workover and Haul-Off Pits ONLY: Type of material utilized in drilling/workover: _____ Number of working pits to be utilized: _____ Abandonment procedure: _____ _____ Drill pits must be closed within 365 days of spud date.	
Submitted Electronically			

KCC OFFICE USE ONLY

Liner Steel Pit RFAC RFAS

Date Received: _____ Permit Number: _____ Permit Date: _____ Lease Inspection: Yes No



CERTIFICATION OF COMPLIANCE WITH THE KANSAS SURFACE OWNER NOTIFICATION ACT

This form must be submitted with all Forms C-1 (Notice of Intent to Drill); CB-1 (Cathodic Protection Borehole Intent); T-1 (Request for Change of Operator Transfer of Injection or Surface Pit Permit); and CP-1 (Well Plugging Application). Any such form submitted without an accompanying Form KSONA-1 will be returned.

Select the corresponding form being filed: C-1 (Intent) CB-1 (Cathodic Protection Borehole Intent) T-1 (Transfer) CP-1 (Plugging Application)

OPERATOR: License # _____
Name: _____
Address 1: _____
Address 2: _____
City: _____ State: _____ Zip: _____ + _____
Contact Person: _____
Phone: (_____) _____ Fax: (_____) _____
Email Address: _____

Well Location:
____ - ____ - ____ - ____ Sec. ____ Twp. ____ S. R. ____ East West
County: _____
Lease Name: _____ Well #: _____

If filing a Form T-1 for multiple wells on a lease, enter the legal description of the lease below:

Surface Owner Information:

Name: _____
Address 1: _____
Address 2: _____
City: _____ State: _____ Zip: _____ + _____

When filing a Form T-1 involving multiple surface owners, attach an additional sheet listing all of the information to the left for each surface owner. Surface owner information can be found in the records of the register of deeds for the county, and in the real estate property tax records of the county treasurer.

If this form is being submitted with a Form C-1 (Intent) or CB-1 (Cathodic Protection Borehole Intent), you must supply the surface owners and the KCC with a plat showing the predicted locations of lease roads, tank batteries, pipelines, and electrical lines. The locations shown on the plat are preliminary non-binding estimates. The locations may be entered on the Form C-1 plat, Form CB-1 plat, or a separate plat may be submitted.

Select one of the following:

- I certify that, pursuant to the Kansas Surface Owner Notice Act (House Bill 2032), I have provided the following to the surface owner(s) of the land upon which the subject well is or will be located: 1) a copy of the Form C-1, Form CB-1, Form T-1, or Form CP-1 that I am filing in connection with this form; 2) if the form being filed is a Form C-1 or Form CB-1, the plat(s) required by this form; and 3) my operator name, address, phone number, fax, and email address.
- I have not provided this information to the surface owner(s). I acknowledge that, because I have not provided this information, the KCC will be required to send this information to the surface owner(s). To mitigate the additional cost of the KCC performing this task, I acknowledge that I am being charged a \$30.00 handling fee, payable to the KCC, which is enclosed with this form.

If choosing the second option, submit payment of the \$30.00 handling fee with this form. If the fee is not received with this form, the KSONA-1 form and the associated Form C-1, Form CB-1, Form T-1, or Form CP-1 will be returned.

Submitted Electronically

For KCC Use ONLY

API # 15 - _____

IN ALL CASES PLOT THE INTENDED WELL ON THE PLAT BELOW

In all cases, please fully complete this side of the form. Include items 1 through 5 at the bottom of this page.

Operator: ARES Energy, LTD
 Lease: McCandless
 Well Number: 15-3
 Field: Leiss Northwest

Number of Acres attributable to well: _____
 QTR/QTR/QTR/QTR of acreage: NE - NE - NE - NW

Location of Well: County: Stafford
 229 feet from N / S Line of Section
 2,449 feet from E / W Line of Section
 Sec. 15 Twp. 25 S. R. 13 E W

Is Section: Regular or Irregular

If Section is Irregular, locate well from nearest corner boundary.
 Section corner used: NE NW SE SW

PLAT

Show location of the well. Show footage to the nearest lease or unit boundary line. Show the predicted locations of lease roads, tank batteries, pipelines and electrical lines, as required by the Kansas Surface Owner Notice Act (House Bill 2032).
 You may attach a separate plat if desired.

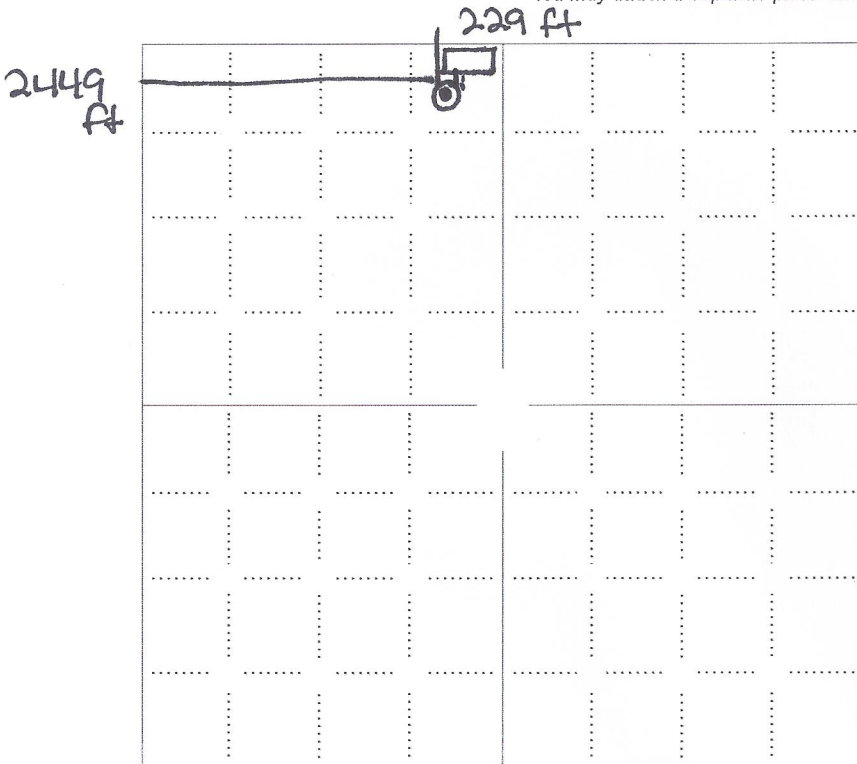

LEGEND

- Well Location
- Tank Battery Location
- Pipeline Location
- Electric Line Location
- Lease Road Location

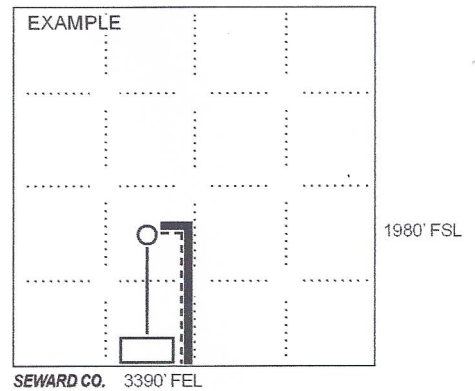

NOTE: In all cases locate the spot of the proposed drilling location.

In plotting the proposed location of the well, you must show:

1. The manner in which you are using the depicted plat by identifying section lines, i.e. 1 section, 1 section with 8 surrounding sections, 4 sections, etc.
2. The distance of the proposed drilling location from the south / north and east / west outside section lines.
3. The distance to the nearest lease or unit boundary line (in footage).
4. If proposed location is located within a prorated or spaced field a certificate of acreage attribution plat must be attached: (C0-7 for oil wells; CG-8 for gas wells).
5. The predicted locations of lease roads, tank batteries, pipelines, and electrical lines.

229 FWL ? 2449 FWL
Jim

THE STATE CORPORATION COMMISSION
OF THE STATE OF KANSAS

Before Commissioners: Mark Sievers, Chairman
Thomas E. Wright
Shari Feist Albrecht

In the matter of the application of Ares) Docket No. 14-CONS-001-CWLE
Energy, LTD for a location exception and)
assignment of an allowable to the McCandless) CONSERVATION DIVISION
15-3 well in Section 15, Township 25 South,)
Range 13 West, in Stafford County, Kansas.) License No.: 33770

ORDER

Now, the above captioned matter comes on for consideration and determination by the State Corporation Commission of the State of Kansas ("Commission" or "KCC").

1. An application was filed on July 1, 2013, by ARES Energy, Ltd. ("ARES" or "operator") for a well location exception for its McCandless 15-3 well in Stafford County, Kansas.

2. ARES is a foreign corporation authorized to do business in the State of Kansas. Pursuant to K.S.A. 55-155, ARES holds KCC oil and gas operator's license number 33770.

3. The application in this docket was filed pursuant to the rules and regulations of the State Corporation Commission and the Kansas Statutes, thus fulfilling all regulatory and statutory requirements.

4. Notice was published at least fifteen (15) days prior to the granting of this application in *The Wichita Eagle* newspaper and *The Stafford Courier* newspaper, stating that this matter would be granted without a hearing if no protests were received within fifteen (15) days from publication.

5. On July 23, 2013, Staff received an Objection for the McCandless 15-3 well from the Law Office of Bauer & Pike, LLC.

6. This matter was set for hearing on October 15, 2013.

7. Due to parties discussing a settlement on the matter, the hearing was continued until November 15, 2013.

8. On October 25, 2013, Staff received a Withdrawal of Objection from the Law Office of Bauer & Pike, LLC.

9. The Applicants McCandless 15-3 well is located as follows:

229 feet from the North line and 2,449 feet from the West line of Section 15, Township 25 South, Range 13 West, Stafford County, Kansas.

10. According to K.A.R. 82-3-108, wells cannot be drilled closer than 330 feet from any lease or unit boundary. The applicants McCandless 15-3 well will be 191 feet from the nearest lease or unit boundary. Exceptions may be granted to the regulation to prevent waste or to protect correlative rights.

11. The acreage to be attributed to said well is described as follows:

NW/4 of Section 15, Township 25 South, Range 13 West, containing 160 acres, more or less.

12. The Commission finds that an exception to the well location restrictions under K.S.R. 82-3-108 should be granted to prevent waste and to protect correlative rights.

13. The application should be granted in accordance with the above findings.

IT IS, THEREFORE, BY THE COMMISSION ORDERED:

A. That the application of ARES Energy, LTD for a well location exception for its McCandless 15-3 well is granted.

B. Any party affected by this Order may file with the Commission a petition for reconsideration pursuant to K.S.A. 77-529(a). Such petition shall be filed within fifteen (15) days after service of this Order and must state the specific grounds upon which relief is requested. This petition for reconsideration shall be filed with the Executive Director of the Conservation Division, Finney State Office Building, 130 S. Market, Room 2078, Wichita, Kansas 67202-3802.

C. The Commission retains jurisdiction of the subject matter and the parties for the purpose of entering such further Order or Orders as from time-to-time it may deem proper.

BY THE COMMISSION IT IS SO ORDERED.
Sievers, Chmn.; Wright, Com.; Albrecht, Com.

Date: NOV 05 2013

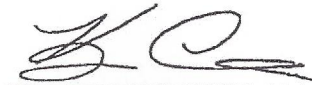

Kim Christiansen
Executive Director

Date Mailed: 11-06-2013

JM

I CERTIFY THE ORIGINAL
COPY IS ON FILE WITH
The State Conservation Commission

NOV 05 2013



CERTIFICATE OF SERVICE

I hereby certify that on 11-06-2013, I caused a true and correct copy of the foregoing "Order" to be served by placing the same in the United States mail, postage prepaid, to the following parties:

Jeff Kennedy
Martin, Pringle, Oliver, Wallace & Bauer, L.L.P.
100 North Broadway, Ste 500
Wichita, KS 67202
Attorney for Applicant

And by hand delivery:

Steve Bond, Production Supervisor
Jim Hemmen, Production

John McCannon
Litigation Counsel
Kansas Corporation Commission

November 25, 2013

Henry N. Clanton
ARES Energy, LTD
405 N. MARIENFELD, STE 250
MIDLAND, TX 79701

Re: Drilling Pit Application
McCandless 15-3
NW/4 Sec.15-25S-13W
Stafford County, Kansas

Dear Henry N. Clanton:

District staff has inspected the above referenced location and has determined that an unsealed condition will present a pollution threat to water resources.

District staff has recommended that the reserve pit be lined with bentonite or native clay, constructed **without slots**, the bottom shall be flat and reasonably level and the free fluids must be removed. The fluids are to be removed from the reserve pit as soon as the Hutchinson Salt section has been drilled through and displacement of the fluids into the reserve pit has occurred. The fluids should be removed again after drilling operations have ceased.

If production casing is set all completion fluids shall be removed from the working pits daily. NO completion fluids or non-exempt wastes shall be placed in the reserve pit.

The fluids should be taken to an authorized disposal well. Please call the District Office at (620) 225-8888 when the fluids have been removed. Please file form CDP-5 (August 2008), Exploration and Production Waste Transfer, through KOLAR within 30 days of fluid removal.

A copy of this letter should be posted in the doghouse along with the approved Intent to Drill. If you have any questions or concerns please feel free to contact the District Office at (620) 225-8888.