

For KCC Use ONLY

API # 15 - _____

IN ALL CASES PLOT THE INTENDED WELL ON THE PLAT BELOW

In all cases, please fully complete this side of the form. Include items 1 through 5 at the bottom of this page.

Operator: _____

Lease: _____

Well Number: _____

Field: _____

Number of Acres attributable to well: _____

QTR/QTR/QTR/QTR of acreage: _____ - _____ - _____ - _____

Location of Well: County: _____

_____ feet from N / S Line of Section

_____ feet from E / W Line of Section

Sec. _____ Twp. _____ S. R. _____ E W

Is Section: Regular or Irregular

If Section is Irregular, locate well from nearest corner boundary.

Section corner used: NE NW SE SW

PLAT

Show location of the well. Show footage to the nearest lease or unit boundary line. Show the predicted locations of lease roads, tank batteries, pipelines and electrical lines, as required by the Kansas Surface Owner Notice Act (House Bill 2032). You may attach a separate plat if desired.

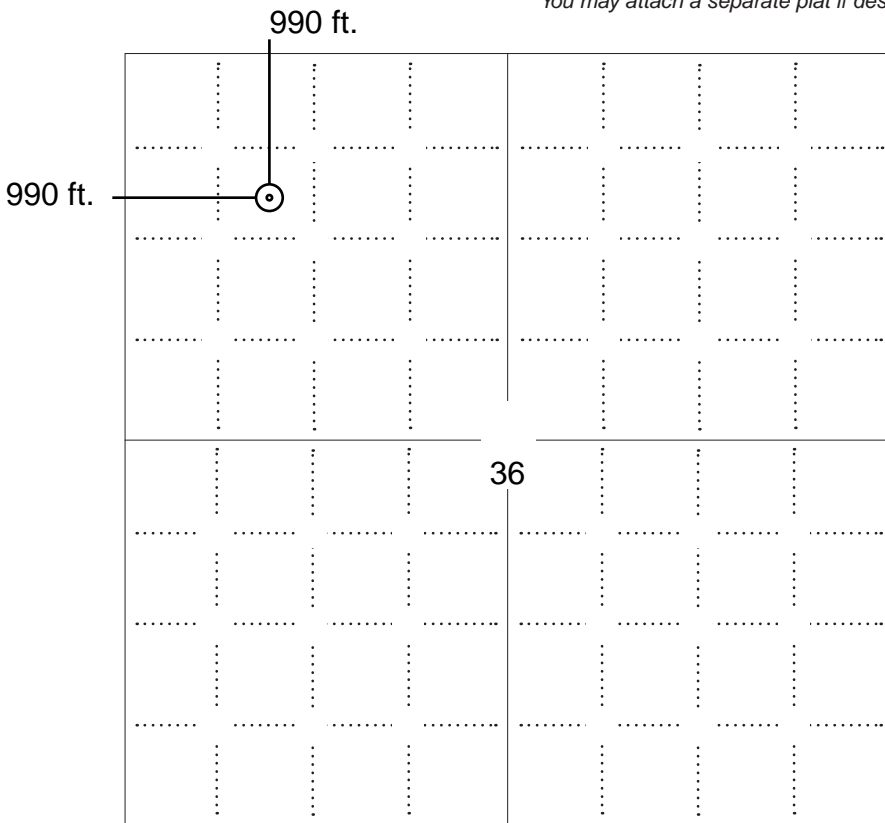

LEGEND

- Well Location
- Tank Battery Location
- Pipeline Location
- Electric Line Location
- Lease Road Location



NOTE: In all cases locate the spot of the proposed drilling locaton.

In plotting the proposed location of the well, you must show:

1. The manner in which you are using the depicted plat by identifying section lines, i.e. 1 section, 1 section with 8 surrounding sections, 4 sections, etc.
2. The distance of the proposed drilling location from the south / north and east / west outside section lines.
3. The distance to the nearest lease or unit boundary line (in footage).
4. If proposed location is located within a prorated or spaced field a certificate of acreage attribution plat must be attached: (C0-7 for oil wells; CG-8 for gas wells).
5. The predicted locations of lease roads, tank batteries, pipelines, and electrical lines.

APPLICATION FOR SURFACE PIT

Submit in Duplicate

Operator Name: _____		License Number: _____	
Operator Address: _____			
Contact Person: _____		Phone Number: _____	
Lease Name & Well No.: _____		Pit Location (QQQQ): _____-_____-_____-_____	
Type of Pit: <input type="checkbox"/> Emergency Pit <input type="checkbox"/> Burn Pit <input type="checkbox"/> Settling Pit <input type="checkbox"/> Drilling Pit <input type="checkbox"/> Workover Pit <input type="checkbox"/> Haul-Off Pit <i>(If WP Supply API No. or Year Drilled)</i>		Pit is: <input type="checkbox"/> Proposed <input type="checkbox"/> Existing If Existing, date constructed: _____ Pit capacity: _____ (bbls)	
Is the pit located in a Sensitive Ground Water Area? <input type="checkbox"/> Yes <input type="checkbox"/> No		Chloride concentration: _____ mg/l <i>(For Emergency Pits and Settling Pits only)</i>	
Is the bottom below ground level? <input type="checkbox"/> Yes <input type="checkbox"/> No		Artificial Liner? <input type="checkbox"/> Yes <input type="checkbox"/> No	
How is the pit lined if a plastic liner is not used? _____			
Pit dimensions (all but working pits): _____ Length (feet) _____ Width (feet) <input type="checkbox"/> N/A: Steel Pits Depth from ground level to deepest point: _____ (feet) <input type="checkbox"/> No Pit			
If the pit is lined give a brief description of the liner material, thickness and installation procedure.		Describe procedures for periodic maintenance and determining liner integrity, including any special monitoring.	
Distance to nearest water well within one-mile of pit: _____ feet Depth of water well _____ feet		Depth to shallowest fresh water _____ feet. Source of information: <input type="checkbox"/> measured <input type="checkbox"/> well owner <input type="checkbox"/> electric log <input type="checkbox"/> KDWR	
Emergency, Settling and Burn Pits ONLY: Producing Formation: _____ Number of producing wells on lease: _____ Barrels of fluid produced daily: _____ Does the slope from the tank battery allow all spilled fluids to flow into the pit? <input type="checkbox"/> Yes <input type="checkbox"/> No		Drilling, Workover and Haul-Off Pits ONLY: Type of material utilized in drilling/workover: _____ Number of working pits to be utilized: _____ Abandonment procedure: _____ Drill pits must be closed within 365 days of spud date.	
Submitted Electronically			

KCC OFFICE USE ONLY

Liner Steel Pit RFAC RFAS

Date Received: _____ Permit Number: _____ Permit Date: _____ Lease Inspection: Yes No



Form Must Be Typed
Form must be Signed
All blanks must be Filled

CERTIFICATION OF COMPLIANCE WITH THE KANSAS SURFACE OWNER NOTIFICATION ACT

This form must be submitted with all Forms C-1 (Notice of Intent to Drill); CB-1 (Cathodic Protection Borehole Intent); T-1 (Request for Change of Operator Transfer of Injection or Surface Pit Permit); and CP-1 (Well Plugging Application). Any such form submitted without an accompanying Form KSONA-1 will be returned.

Select the corresponding form being filed: C-1 (Intent) CB-1 (Cathodic Protection Borehole Intent) T-1 (Transfer) CP-1 (Plugging Application)

OPERATOR: License # _____
Name: _____
Address 1: _____
Address 2: _____
City: _____ State: _____ Zip: _____ + _____
Contact Person: _____
Phone: (_____) _____ Fax: (_____) _____
Email Address: _____

Well Location:
____ - ____ - ____ - ____ Sec. ____ Twp. ____ S. R. ____ East West
County: _____
Lease Name: _____ Well #: _____

If filing a Form T-1 for multiple wells on a lease, enter the legal description of the lease below:

Surface Owner Information:

Name: _____
Address 1: _____
Address 2: _____
City: _____ State: _____ Zip: _____ + _____

When filing a Form T-1 involving multiple surface owners, attach an additional sheet listing all of the information to the left for each surface owner. Surface owner information can be found in the records of the register of deeds for the county, and in the real estate property tax records of the county treasurer.

If this form is being submitted with a Form C-1 (Intent) or CB-1 (Cathodic Protection Borehole Intent), you must supply the surface owners and the KCC with a plat showing the predicted locations of lease roads, tank batteries, pipelines, and electrical lines. The locations shown on the plat are preliminary non-binding estimates. The locations may be entered on the Form C-1 plat, Form CB-1 plat, or a separate plat may be submitted.

Select one of the following:

- I certify that, pursuant to the Kansas Surface Owner Notice Act (House Bill 2032), I have provided the following to the surface owner(s) of the land upon which the subject well is or will be located: 1) a copy of the Form C-1, Form CB-1, Form T-1, or Form CP-1 that I am filing in connection with this form; 2) if the form being filed is a Form C-1 or Form CB-1, the plat(s) required by this form; and 3) my operator name, address, phone number, fax, and email address.
- I have not provided this information to the surface owner(s). I acknowledge that, because I have not provided this information, the KCC will be required to send this information to the surface owner(s). To mitigate the additional cost of the KCC performing this task, I acknowledge that I am being charged a \$30.00 handling fee, payable to the KCC, which is enclosed with this form.

If choosing the second option, submit payment of the \$30.00 handling fee with this form. If the fee is not received with this form, the KSONA-1 form and the associated Form C-1, Form CB-1, Form T-1, or Form CP-1 will be returned.

I Submitted Electronically

For KCC Use ONLY

API # 15 - _____

IN ALL CASES PLOT THE INTENDED WELL ON THE PLAT BELOW

In all cases, please fully complete this side of the form. Include items 1 through 5 at the bottom of this page.

Operator: Bandy, Terry P dba Te-Pe Oil & Gas

Lease: Hannaford

Well Number: 2

Field: Fairplay

Number of Acres attributable to well: _____

QTR/QTR/QTR/QTR of acreage: _____ - SE - NW - NW

Location of Well: County: Marion

990 feet from N / S Line of Section

990 feet from E / W Line of Section

Sec. 36 Twp. 21 S. R. 4 E W

Is Section: Regular or Irregular

If Section is Irregular, locate well from nearest corner boundary.

Section corner used: NE NW SE SW

PLAT

Show location of the well. Show footage to the nearest lease or unit boundary line. Show the predicted locations of lease roads, tank batteries, pipelines and electrical lines, as required by the Kansas Surface Owner Notice Act (House Bill 2032). You may attach a separate plat if desired.

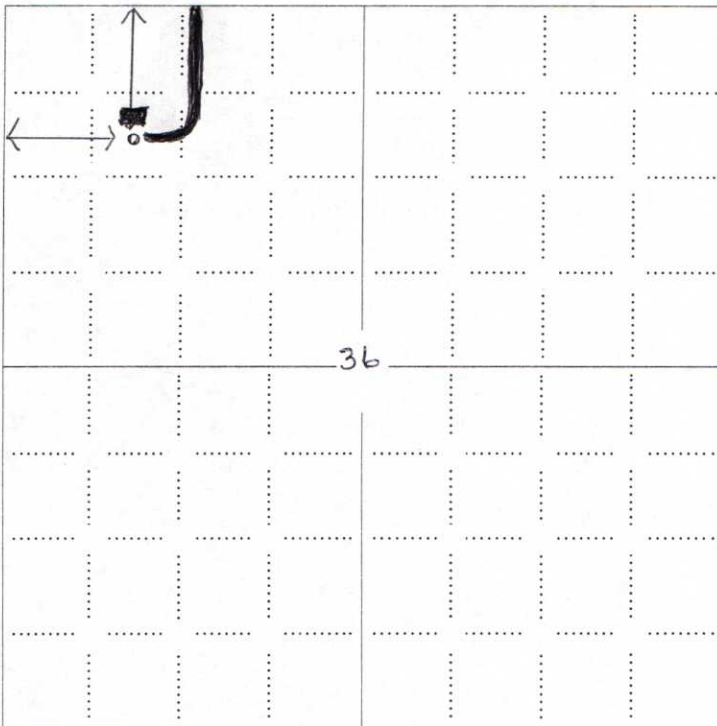

LEGEND

- Well Location
- Tank Battery Location
- Pipeline Location
- Electric Line Location
- Lease Road Location

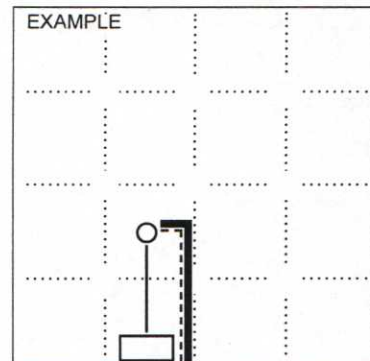

NOTE: In all cases locate the spot of the proposed drilling locaton.

In plotting the proposed location of the well, you must show:

1. The manner in which you are using the depicted plat by identifying section lines, i.e. 1 section, 1 section with 8 surrounding sections, 4 sections, etc.
2. The distance of the proposed drilling location from the south / north and east / west outside section lines.
3. The distance to the nearest lease or unit boundary line (in footage).
4. If proposed location is located within a prorated or spaced field a certificate of acreage attribution plat must be attached: (CO-7 for oil wells; CG-8 for gas wells).
5. The predicted locations of lease roads, tank batteries, pipelines, and electrical lines.

15-15-19296-0000

Give All Information Completely
Make Required Affidavit
Mail or Deliver Report to:
Conservation Division
State Corporation Commission
211 No. Broadway
Wichita, Kansas

WELL PLUGGING RECORD

NORTH

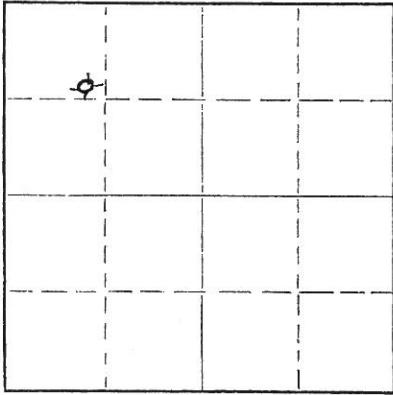

Locate well correctly on above Section Plat

Marion County, Sec. 36 Twp. 21 S Rge. 4 (E) (W)
Location as "NE/CNW/SW" or footage from lines SE NW NW
Lease Owner E. H. Adair Oil Co., et al,
Lease Name Slocombe Well No. 3.
Office Address 1005 E. Second St., Wichita 7, Kansas.
Character of Well (completed as Oil, Gas or Dry Hole) a dry-hole.
Date well completed 1-24 19 58
Application for plugging filed 1-24 19 58
Application for plugging approved 1-24 19 58
Plugging commenced 1-24 19 58
Plugging completed 1-25 19 58
Reason for abandonment of well or producing formation a dry-hole.

If a producing well is abandoned, date of last production 19
Was permission obtained from the Conservation Division or its agents before plugging was commenced? Yes.

Name of Conservation Agent who supervised plugging of this well Donald Peterson, El Dorado, Kansas
Producing formation Depth to top Bottom Total Depth of Well 2800 Feet
Show depth and thickness of all water, oil and gas formations.

OIL, GAS OR WATER RECORDS

CASING RECORD

FORMATION	CONTENT	FROM	TO	SIZE	PUT IN	PULLED OUT
(COPY OF DRILLERS' LOG ATTACHED HERETO)						

Describe in detail the manner in which the well was plugged, indicating where the mud fluid was placed and the method or methods used in introducing it into the hole. If cement or other plugs were used, state the character of same and depth placed, from feet to feet for each plug set.

Filled hole to 155 ft. with mud. Set solid bridge at 150 ft., cemented with 12 sax. through drill-pipe. Filled hole to 15 ft., set plug and capped with 5 sax. cement.

RECEIVED
FEB 13 1958
CONSERVATION DIVISION
WICHITA, KANSAS

(If additional description is necessary, use BACK of this sheet)
Name of Plugging Contractor E. H. ADAIR OIL CO.
Address 1005 EAST SECOND ST., WICHITA 7, KANSAS.

STATE OF KANSAS, COUNTY OF SEDGWICK, ss.
I, K. W. JOHNSON (employee of owner) or (owner or operator) of the above-described well, being first duly sworn on oath, says: That I have knowledge of the facts, statements, and matters herein contained and the log of the above-described well as filed and that the same are true and correct. So help me God.

(Signature) K. W. Johnson
1005 E. Second St., Wichita 7, Ks. K. W. Johnson
(Address)

SUBSCRIBED AND SWORN TO before me this 7th day of February, 19 58

My commission expires Sept. 15, 1961.

L. Hill

Notary Public.

PLUGGING
FILED SEC 36 T. 21 R. 4E
BOOK PAGE 79 LINE 38

15-115-19296-0000

E. H. ADAIR OIL COMPANY
1005 East Second Street
Wichita 7, Kansas

E. H. Adair Oil Company &
Lee Phillips Oil Company
Slocombe No. 3
SE-NW-NW
36-21-4E.
Marion County, Kansas
Elevation: 1425 K-B.

Comm: 1-19-58
Comp: 1-24-58
Contractor:
E. H. Adair- Rig #1
8-5/8 @ 165 ft. w/135 sx.
Pro: D. & A.

FIGURES INDICATE BOTTOMS OF FORMATIONS

Lime & Shale	620	Lime	2176
Shale & Shells	1100	Shaley Lime	2196
Lime & Shale	1700	Limey Shale	2210
Shale	1721	Lime	2229
Lime	1734	Shale	2239
Shale	1775	Lime	2261
Lime	1853	Black Shale	2263
Sandy Lime	1863	Lime	2265
Lime	2006	Cherty Conglomerate	2270
Shale	2013	Shaley Chert	2285
Lime	2043	Chert, slight show	2305
Limey Shale	2050	of oil.	
Porous Lime	2054	Chert	2371
Lime	2074	Limestone	2397
Black Shale	2078	Shale	2491
Lime	2099	Brown Shale	2502
Black Shale	2102	Cherty Dolomite	2617
Lime	2126	Green Shale	2621
Shale	2173	Sand	2626
		T.D.	2626

TOPS

LANSING LIMESTONE	1775 (-350)
BASE KANSAS CITY LIME	2126 (-701)
PENNSYLVANIAN BASAL CONGLOMERATE	2265 (-840)
DETRITAL MISSISSIPPI	2270 (-845)
MISSISSIPPI CHERT	2285 (-860)
MISSISSIPPI LIMESTONE	2371 (-946)
KINDERHOOK SHALE	2397 (-972)
CHATTANOOGA SHALE	2491 (-1066)
VIOLA DOLOMITE	2502 (-1077)
SIMPSON SHALE	2617 (-1192)
SIMPSON SAND	2621 (-1196)
T. D.	2626

Certified correct:

K. W. Johnson
K. W. Johnson
Geologist.

RECEIVED
STATE CORPORATION COMMISSION

FEB 13 1958

CONSERVATION DIVISION
Wichita, Kansas

PLUGGING
36-21-4E
BOOK PAGE 79 LINE 38

TE-PE OIL & GAS
P.O. BOX 522
CANTON, KANSAS 67428
620-628-4428
FAX 620-628-4429

June 11, 2013

KCC
Cons. Div.

RE: Intent to Drill

Hannaford #2 OWWO

We are hereby requesting an exception to table 1 cementing to use alternate II cementing rules as this well was earlier completed as D & A with 165' of surface casing set and cemented. Te-Pe Oil & Gas intends to cement the 5-1/2" X 7-7/8" annulus from a minimum of 250' back to the top of the surface casing or ground level.

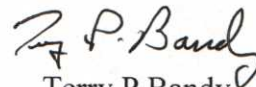
Terry P Bandy
Operator

Mark Sievers, Chairman
Thomas E. Wright, Commissioner
Shari Feist Albrecht, Commissioner

Sam Brownback, Governor

June 12, 2013

Terry Bandy
Te-Pe Oil & Gas
PO Box 522
Canton, KS 67428-0522

RE: Table I Exception
Hannaford #2, SE-NW-NW Sec.36-T21S-R4E, Marion County, Kansas

Dear Mr. Bandy:

The Kansas Corporation Commission (KCC) has received your request, dated June 11, 2013, for an exception to the Table 1 minimum surface pipe requirement of 200 feet for the proposed well. From your request, the KCC understands that you are requesting to utilize the existing 165 feet of surface casing in this well bore and Alternate II cementing rules.

After review of this matter by technical staff it was determined that:

1. Bedrock at this location is the Permian Chase Group and is located at or near surface.
2. There are no water wells of record within one mile of this location.

Based on this information, an exception is granted for the Table 1 Minimum Surface Casing Requirements with the following stipulations:

1. Upon completion of the well, the production or long string casing nearest the formation wall shall be immediately cemented from a depth of at least 250 feet back to the surface. Notify the KCC District #2 office prior to spudding the well and one day before cementing the longstring so they may have the opportunity to witness the procedure.
2. In the event the well is dry and no additional production pipe has been cemented in place, plugging will be performed according to KCC rules and KCC District #2 requirements.

Sincerely Yours,



Barry Metz
Acting Director

cc: Steve Bond ^{SB}
Jeff Klock - Dist #2 *via e-mail*

**NOTICE TO OPERATORS FILING INTENT TO DRILL
FOR DISPOSAL OR ENHANCED RECOVERY
INJECTION WELLS, (CLASS II INJECTION WELL)**

The attached approved Notice of Intent to Drill indicates the proposed well is to be used for injection. An approved "Intent to Drill" does not approve injection authority as a Class II Injection Well in Kansas.

Before any well is used for injection purposes, the operator must file an application for injection authority in accordance with K.A.R. 82-3-401 and provide notice in accordance with K.A.R. 82-3-402. The Conservation Division must issue a written permit granting the application before commencement of injection.

The Conservation Division requirements and restrictions associated with Class II Injection are identified in K.A.R. 82-3-400 et seq of our regulations. Associated regulations governing drilling, completion and injection applications may be found in K.A.R. 82-3-135, Table I, Table II, in the Cedar Hills Sandstone Moratorium, (Docket #156,397-C), and the Eastern Kansas Surface Casing Order, (Docket #133,891-C).

If you have questions regarding the approval of injection authority, an injection application may be filed as a "Design Approval" before actual drilling and completion of the well occurs. If you have any questions or concerns regarding Class II injection wells or regulations, call the Underground Injection Control Department at 316-337-6200.

Failure to obtain commission approval before beginning injection is punishable by a penalty, shut-in of the well or both.

Te-Pe Oil & Gas
P.O. Box 522
Canton, Kansas 67428

June 11, 2013

KCC

RE: Intent to Drill
Hannaford #2

Correction to well number. Please change the well number to Hannaford #3 OWWO.
We thought this might be easier to keep track of.

Terry Bandy