



**APPLICATION FOR COMMINGLING OF PRODUCTION (K.A.R. 82-3-123) OR FLUIDS (K.A.R. 82-3-123a)** *Commingling ID # \_\_\_\_\_*

OPERATOR: License # \_\_\_\_\_ API No. 15 - \_\_\_\_\_  
Name: \_\_\_\_\_ Spot Description: \_\_\_\_\_  
Address 1: \_\_\_\_\_ Sec. \_\_\_\_\_ Twp. \_\_\_\_\_ S. R. \_\_\_\_\_  East  West  
Address 2: \_\_\_\_\_ Feet from  North /  South Line of Section  
City: \_\_\_\_\_ State: \_\_\_\_\_ Zip: \_\_\_\_\_ + \_\_\_\_\_ Feet from  East /  West Line of Section  
Contact Person: \_\_\_\_\_ County: \_\_\_\_\_  
Phone: ( \_\_\_\_\_ ) \_\_\_\_\_ Lease Name: \_\_\_\_\_ Well #: \_\_\_\_\_

1. Name and upper and lower limit of each production interval to be commingled:  
Formation: \_\_\_\_\_ (Perfs): \_\_\_\_\_  
Formation: \_\_\_\_\_ (Perfs): \_\_\_\_\_  
Formation: \_\_\_\_\_ (Perfs): \_\_\_\_\_  
Formation: \_\_\_\_\_ (Perfs): \_\_\_\_\_  
Formation: \_\_\_\_\_ (Perfs): \_\_\_\_\_

2. Estimated amount of fluid production to be commingled from each interval:  
Formation: \_\_\_\_\_ BOPD: \_\_\_\_\_ MCFPD: \_\_\_\_\_ BWPD: \_\_\_\_\_  
Formation: \_\_\_\_\_ BOPD: \_\_\_\_\_ MCFPD: \_\_\_\_\_ BWPD: \_\_\_\_\_  
Formation: \_\_\_\_\_ BOPD: \_\_\_\_\_ MCFPD: \_\_\_\_\_ BWPD: \_\_\_\_\_  
Formation: \_\_\_\_\_ BOPD: \_\_\_\_\_ MCFPD: \_\_\_\_\_ BWPD: \_\_\_\_\_  
Formation: \_\_\_\_\_ BOPD: \_\_\_\_\_ MCFPD: \_\_\_\_\_ BWPD: \_\_\_\_\_

3. Plat map showing the location of the subject well, all other wells on the subject lease, and all wells on offsetting leases within a 1/2 mile radius of the subject well, and for each well the names and addresses of the lessee of record or operator.

4. Signed certificate showing service of the application and affidavit of publication as required in K.A.R. 82-3-135a.

**For Commingling of PRODUCTION ONLY, include the following:**

- 5. Wireline log of subject well. Previously Filed with ACO-1:  Yes  No
- 6. Complete Form ACO-1 (*Well Completion form*) for the subject well.

**For Commingling of FLUIDS ONLY, include the following:**

- 7. Well construction diagram of subject well.
- 8. Any available water chemistry data demonstrating the compatibility of the fluids to be commingled.

**AFFIDAVIT:** I am the affiant and hereby certify that to the best of my current information, knowledge and personal belief, this request for commingling is true and proper and I have no information or knowledge, which is inconsistent with the information supplied in this application.

**Submitted Electronically**

**KCC Office Use Only**  
 Denied  Approved  
15-Day Periods Ends: \_\_\_\_\_  
Approved By: \_\_\_\_\_ Date: \_\_\_\_\_

*Protests may be filed by any party having a valid interest in the application. Protests must be in writing and comply with K.A.R. 82-3-135b and must be filed within 15 days of publication of the notice of application.*

R 32 W

R 31 W

T  
13  
S

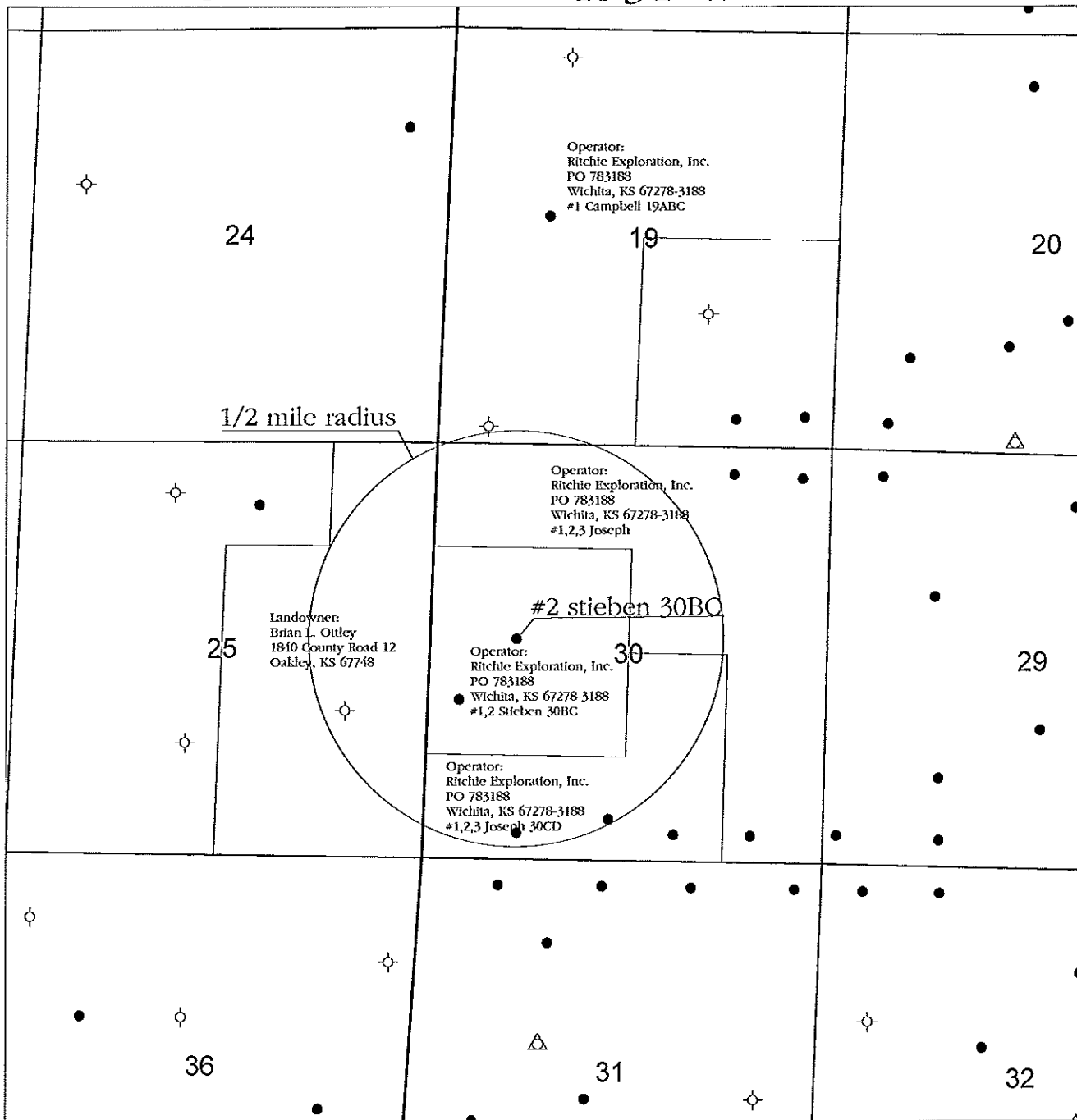

- Legend**
- Oil Well
  - Dry and Abandoned Well
  - △ Service Well



**RITCHIE**  
EXPLORATION, INC.  
Wichita, Kansas

Application for  
Commingling of  
Production or Fluids

Applicant Well: #2 Stieben 30BC  
All Wells on Offsetting Leases within 1/2 Mile Radius  
Name and Address of Lessee of Record or Operator on  
Offsetting Leases

---

Gove County, KS

Prepared By: Justin Clegg	Scale: 1 : 24,000	Date: May 22, 2013
------------------------------	----------------------	-----------------------

**APPLICATION FOR COMMINGLING OF PRODUCTION OR FLUIDS**

**Operator, Lessee or Unleased Mineral Owner  
within a ½ mile radius of Ritchie Exploration, Inc.'s**

**#2 Stieben 30BC  
2480' FNL & 1100' FWL  
Section 30-13S-31W  
Gove Co., KS**

**Township 13 South, Range 31 West**  
*Gove Co., KS*

Sec. 19:	W/2; NE/4	Ritchie Exploration, Inc. P.O. Box 783188 Wichita, KS 67278-3188	Operator: #1 Campbell 19ABC
Sec. 30:	N/2NW/4, NE/4, E/2SE/4	Ritchie Exploration, Inc.	Operator: #1 Joseph, #2 Joseph, #3 Joseph
	S/2NW/4, N/2SW/4	Ritchie Exploration, Inc.	Operator: #1 Stieben 30BC, #2 Stieben 30BC
	S/2SW/4, W/2SE/4	Ritchie Exploration, Inc.	Operator: #1 Joseph 30CD, #2 Joseph 30CD, #3 Joseph 30CD

**Township 13 South, Range 32 West**  
*Logan Co., KS*

Sec. 25:	E/2, less the NW/4NE/4	Brian L. Ottley 1840 CR 12 Oakley, KS 67748	Landowner
----------	---------------------------	---------------------------------------------------	-----------

**AFFIDAVIT**

STATE OF KANSAS            )  
                                          - SS.  
County of Sedgwick         )

John Niernberger, of lawful age, being first duly sworn, deposeth and saith: That he is Production Manager of Ritchie Exploration, County of Sedgwick, State of Kansas, and that notice was given to all lessee of record or operator within ½ mile radius of the Stieben 30BC #2 well located in the County of Gove (see attached plat map). This notice included a letter and a copy of the Commingle Application (ACO-4). All notices were mailed on May 28, 2013.

made as aforesaid on the 28<sup>th</sup> of

**May A.D. 2013**

\_\_\_\_\_

And affiant further says that he has personal knowledge of the statements above set forth and that they are true.

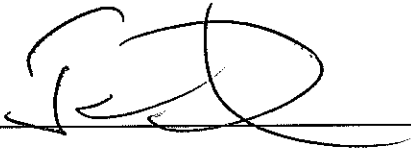
  
\_\_\_\_\_

Subscribed and sworn to before me this

**28<sup>th</sup> day of May 2013**

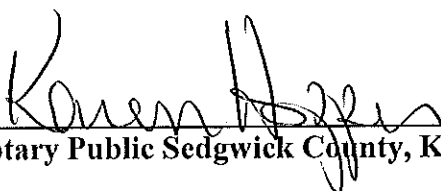
  
\_\_\_\_\_  
Notary Public Sedgwick County, Kansas

KAREN HOPPER  
NOTARY PUBLIC-STATE OF KANSAS  
MY APPT. EXPIRES 3-8-15

**AFFIDAVIT OF PUBLICATION**

State of Kansas,  
Gove County, ss:

Roxanne Broeckelman,  
being first duly sworn, deposes and  
says: That she is  
co-publisher of

**Gove County Advocate**, a weekly  
newspaper printed in the State of  
Kansas, and published in and of  
general circulation in Gove County,  
Kansas, with a general paid  
circulation on a weekly basis in  
Gove County, Kansas, and that said  
newspaper is not a trade, religious  
or fraternal publication.

Said newspaper is a weekly  
published at least 50 times a year;  
and has been so published  
continuously and uninterruptedly in  
said county and state for a period of  
more than five years prior to the first  
publication of said notice; and has  
been admitted at the post office in  
Quinter in said county as periodical  
class mail matter.

That the attached notice is a true  
copy thereof and was published in  
the regular and entire issue of said  
newspaper for one  
consecutive week(s), the first  
publication thereof being made as  
aforesaid on the 5th day  
of June, 2013,  
with subsequent publications being  
made on the following dates:

\_\_\_\_\_, \_\_\_\_\_  
\_\_\_\_\_, \_\_\_\_\_  
\_\_\_\_\_, \_\_\_\_\_  
\_\_\_\_\_, \_\_\_\_\_  
\_\_\_\_\_, \_\_\_\_\_  
\_\_\_\_\_, \_\_\_\_\_

Printer's Fee .....\$ 18.70  
Additional Copies .... \$ \_\_\_\_\_  
Affidavit Fees .....\$ 2.00  
Total Publication Fees . \$ 20.70

*Roxanne Broeckelman*

Subscribed and sworn to before me  
this 5th day of  
June, 2013

*Linda L. Zerr*  
Notary Public

My commission expires:  
January 8, 2017

**LEGAL ADVERTISING**  
(Published in the Gove County Advocate,  
Quinter, KS, Wed., June 5, 2013 - 1t)  
**LEGAL NOTICE**  
You, and each of you, are hereby notified  
that Ritchie Exploration, Inc. has filed an appli-  
cation to commence the commingling of pro-  
duction from the Lansing-Kansas City, Fort  
Scott, Johnson, and Myrick sources of supply  
for the #2 Stieben 30BC well located approx.  
E/2 W/2 W/2 of Section 30-13S-31W, Gove  
County, Kansas.  
Any persons who object to or protest this  
application shall be required to file their objec-  
tions or protests with the Conservation Division  
of the State Corporation Commission of the  
State of Kansas within fifteen (15) days from  
the date of the publication. These protests shall  
be filed pursuant to Commission regulations  
and must state specific reasons why the grant  
of the application may cause waste, violate cor-  
relative rights or pollute the natural resources of  
the State of Kansas.  
If no protests are received, this application  
may be granted through a summary proceed-  
ing. If valid protests are received, this matter  
will be set for hearing.  
All persons interested or concerned shall  
take notice of the foregoing and shall govern  
themselves accordingly.  
**RITCHIE EXPLORATION, INC.**  
P.O. Box 783188  
Wichita, KS 67278-3188  
(316) 691-9500

**LINDA L. ZERR**  
NOTARY PUBLIC  
STATE OF KANSAS  
My Appt. Exp. 1-8-2017

**AFFIDAVIT**

STATE OF KANSAS \
- SS.
County of Sedgwick /

Mark Fletchall, of lawful age, being first duly sworn, deposeth and saith: That he is Record Clerk of The Wichita Eagle, a daily newspaper published in the City of Wichita, County of Sedgwick, State of Kansas, and having a general paid circulation on a daily basis in said County, which said newspaper has been continuously and uninterruptedly published in said County for more than one year prior to the first publication of the notice hereinafter mentioned, and which said newspaper has been entered as second class mail matter at the United States Post Office in Wichita, Kansas, and which said newspaper is not a trade, religious or fraternal publication and that a notice of a true copy is hereto attached was published in the regular and entire Morning issue of said The Wichita Eagle for 1 issues, that the first publication of said notice was

made as aforesaid on the 5th

June A.D. 2013, with

subsequent publications being made on the following dates:

And affiant further says that he has personal knowledge of the statements above set forth and that they are true.

*Mark Fletchall*

Subscribed and sworn to before me this

5th day of June, 2013

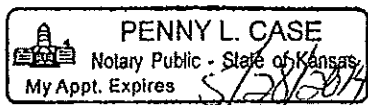

*Penny L. Case*  
Notary Public Sedgwick County, Kansas

Printer's Fee : \$91.60

**LEGAL PUBLICATION**

PUBLISHED IN THE WICHITA EAGLE  
JUNE 5, 2013 (3249299)

**LEGAL NOTICE**

You, and each of you, are hereby notified that Ritchie Exploration, Inc. has filed an application to commence the commingling of production from the Lansing-Kansas City, Fort Scott, Johnson, and Myrick sources of supply for the #2 Sleben 30BC well located approx. E/2 W/2 W/2 of Section 30-13S-31W, Gove County, Kansas. Any persons who object to or protest this application shall be required to file their objections or protests with the Conservation Division of the State Corporation Commission of the State of Kansas within fifteen (15) days from the date of the publication. These protests shall be filed pursuant to Commission regulations and must state specific reasons why the grant of the application may cause waste, violate correlative rights or pollute the natural resources of the state of Kansas. If no protests are received, this application may be granted through a summary proceeding. If valid protests are received, this matter will be set for hearing. All persons interested or concerned shall take notice of the foregoing and shall govern themselves accordingly.

RITCHIE EXPLORATION, INC.  
P.O. Box 783188  
Wichita, KS 67278-3188  
(316) 691-9500

**KANSAS CORPORATION COMMISSION**  
**OIL & GAS CONSERVATION DIVISION**  
**WELL COMPLETION FORM**  
**WELL HISTORY - DESCRIPTION OF WELL & LEASE**

Form ACO-1  
 June 2009  
**Form Must Be Typed**  
**Form must be Signed**  
**All blanks must be Filled**

OPERATOR: License # 4767  
 Name: Ritchie Exploration, Inc.  
 Address 1: P.O. Box 783188  
 Address 2: \_\_\_\_\_  
 City: Wichita State: KS Zip: 67278 + 3188  
 Contact Person: John Niernberger  
 Phone: ( 316 ) 691-9500  
 CONTRACTOR: License # 30606  
 Name: Murfin Drilling Co., Inc.  
 Wellsite Geologist: Tom Funk  
 Purchaser: NCRA

Designate Type of Completion:

New Well     Re-Entry     Workover

Oil     WSW     SWD     SIOW  
 Gas     D&A     ENHR     SIGW  
 OG     GSW     Temp. Abd.  
 CM (Coal Bed Methane)  
 Cathodic     Other (Core, Expl., etc.): \_\_\_\_\_

If Workover/Re-entry: Old Well Info as follows:

Operator: \_\_\_\_\_  
 Well Name: \_\_\_\_\_  
 Original Comp. Date: \_\_\_\_\_ Original Total Depth: \_\_\_\_\_

Deepening     Re-perf.     Conv. to ENHR     Conv. to SWD  
 Conv. to GSW

Plug Back: \_\_\_\_\_ Plug Back Total Depth \_\_\_\_\_  
 Commingled    Permit #: \_\_\_\_\_  
 Dual Completion    Permit #: \_\_\_\_\_  
 SWD    Permit #: \_\_\_\_\_  
 ENHR    Permit #: \_\_\_\_\_  
 GSW    Permit #: \_\_\_\_\_

<u>2/7/11</u>	<u>2/21/11</u>	<u>2/21/11</u>
Spud Date or Recompletion Date	Date Reached TD	Completion Date or Recompletion Date

API No. 15 - 063-21887-00-00  
 Spot Description: 160' N & 110' E of  
E/2\_ W/2\_ W/2\_ Sec. 30 Twp. 13 S. R. 31  East  West  
2,480 Feet from  North /  South Line of Section  
1,100 Feet from  East /  West Line of Section  
 Footages Calculated from Nearest Outside Section Corner:  
 NE  NW  SE  SW  
 County: Gove  
 Lease Name: Stleben 30BC Well #: 2  
 Field Name: \_\_\_\_\_  
 Producing Formation: LKC, Myrick, Fort Scott & Johnson  
 Elevation: Ground: 2906 Kelly Bushing: 2916  
 Total Depth: 4655 Plug Back Total Depth: 4623  
 Amount of Surface Pipe Set and Cemented at: 223 Feet  
 Multiple Stage Cementing Collar Used?  Yes  No  
 If yes, show depth set: 2370 Feet  
 If Alternate II completion, cement circulated from: surface  
 feet depth to: 2370 w/ 300 sx cmt.

**Drilling Fluid Management Plan**  
*(Data must be collected from the Reserve Pit)*

Chloride content: 9800 ppm Fluid volume: 1000 bbls  
 Dewatering method used: evaporation  
 Location of fluid disposal if hauled offsite: \_\_\_\_\_  
 Operator Name: \_\_\_\_\_  
 Lease Name: \_\_\_\_\_ License #: \_\_\_\_\_  
 Quarter \_\_\_\_\_ Sec. \_\_\_\_\_ Twp. \_\_\_\_\_ S. R. \_\_\_\_\_  East  West  
 County: \_\_\_\_\_ Permit #: \_\_\_\_\_

**INSTRUCTIONS:** An original and two copies of this form shall be filed with the Kansas Corporation Commission, 130 S. Market - Room 2078, Wichita, Kansas 67202, within 120 days of the spud date, recompletion, workover or conversion of a well. Rule 82-3-130, 82-3-106 and 82-3-107 apply. Information of side two of this form will be held confidential for a period of 12 months if requested in writing and submitted with the form (see rule 82-3-107 for confidentiality in excess of 12 months). One copy of all wireline logs and geologist well report shall be attached with this form. ALL CEMENTING TICKETS MUST BE ATTACHED. Submit CP-4 form with all plugged wells. Submit CP-111 form with all temporarily abandoned wells.

**AFFIDAVIT**

I am the affiant and hereby certify that all requirements of the statutes, rules and regulations promulgated to regulate the oil and gas industry have been fully complied with and the statements herein are complete and correct to the best of my knowledge.

Signature: [Signature]  
 Title: Production Manager Date: 5/24/11

**KCC Office Use ONLY**

Letter of Confidentiality Received  
 Date: \_\_\_\_\_  
 Confidential Release Date: \_\_\_\_\_  
 Wireline Log Received  
 Geologist Report Received  
 UIC Distribution  
 ALT  I  II  III Approved by: \_\_\_\_\_ Date: \_\_\_\_\_

Operator Name: Ritchie Exploration, Inc. Lease Name: Stieben 30BC Well #: 2  
 Sec. 30 Twp. 13 S. R. 31  East  West County: Gove

**INSTRUCTIONS:** Show important tops and base of formations penetrated. Detail all cores. Report all final copies of drill stems tests giving interval tested, time tool open and closed, flowing and shut-in pressures, whether shut-in pressure reached static level, hydrostatic pressures, bottom hole temperature, fluid recovery, and flow rates if gas to surface test, along with final chart(s). Attach extra sheet if more space is needed. Attach complete copy of all Electric Wire-line Logs surveyed. Attach final geological well site report.

Drill Stem Tests Taken <input checked="" type="checkbox"/> Yes <input type="checkbox"/> No <i>(Attach Additional Sheets)</i>  Samples Sent to Geological Survey <input checked="" type="checkbox"/> Yes <input type="checkbox"/> No  Cores Taken <input type="checkbox"/> Yes <input checked="" type="checkbox"/> No Electric Log Run <input checked="" type="checkbox"/> Yes <input type="checkbox"/> No Electric Log Submitted Electronically <input type="checkbox"/> Yes <input checked="" type="checkbox"/> No <i>(If no, Submit Copy)</i>  List All E. Logs Run: Dual Induction Log Compensated Density/Neutron Log	<input type="checkbox"/> Log Formation (Top), Depth and Datum <input checked="" type="checkbox"/> Sample Name Top Datum  SEE ATTACHED
---------------------------------------------------------------------------------------------------------------------------------------------------------------------------------------------------------------------------------------------------------------------------------------------------------------------------------------------------------------------------------------------------------------------------------------------------------------------------------------------------------------------------------------------------------------------------------------------------------------------------------------------------------------	------------------------------------------------------------------------------------------------------------------------------------------------

CASING RECORD <input checked="" type="checkbox"/> New <input type="checkbox"/> Used							
Report all strings set-conductor, surface, intermediate, production, etc.							
Purpose of String	Size Hole Drilled	Size Casing Set (In O.D.)	Weight Lbs. / Ft.	Setting Depth	Type of Cement	# Sacks Used	Type and Percent Additives
Surface	12-1/4	8-5/8	23	223	common	175	3% cc, 2% gel
Production	7-7/8	5-1/2	15.5	4652	ASC	200	10% sat, 2% gel & 5% tex gilsonite

ADDITIONAL CEMENTING / SQUEEZE RECORD				
Purpose:	Depth Top Bottom	Type of Cement	# Sacks Used	Type and Percent Additives
<input type="checkbox"/> Perforate				
<input type="checkbox"/> Protect Casing				
<input type="checkbox"/> Plug Back TD				
<input type="checkbox"/> Plug Off Zone				

Shots Per Foot	PERFORATION RECORD - Bridge Plugs Set/Type Specify Footage of Each Interval Perforated	Acid, Fracture, Shot, Cement Squeeze Record <i>(Amount and Kind of Material Used)</i>	Depth
4	4516.5' - 4519.5', 4507.5' - 4511.5' (3/7/11)	500 gallons 15% NE (3/10/11)	
4	4436' - 4440', 4420.5' - 4423.5' (3/7/11)	500 gallons 15% NE (3/10/11)	
4	4108.5' - 4113.5', 3996' - 3998.5' (3/7/11)	500 gallons 15% NE (3/10/11)	

TUBING RECORD: Size: <u>2-7/8"</u> Set At: <u>4613'</u> Packer At:		Liner Run: <input type="checkbox"/> Yes <input checked="" type="checkbox"/> No
Date of First, Resumed Production, SWD or ENHR. <u>3/17/11</u>		Producing Method: <input type="checkbox"/> Flowing <input checked="" type="checkbox"/> Pumping <input type="checkbox"/> Gas Lift <input type="checkbox"/> Other (Explain) _____
Estimated Production Per 24 Hours	Oil Bbls. <u>87.27</u>	Gas Mcf <u>          </u> Water Bbls. <u>87.27</u> Gas-Oil Ratio <u>          </u> Gravity <u>36.9</u>

DISPOSITION OF GAS: <input type="checkbox"/> Vented <input type="checkbox"/> Sold <input type="checkbox"/> Used on Lease <i>(If vented, Submit ACO-18.)</i>	METHOD OF COMPLETION: <input type="checkbox"/> Open Hole <input type="checkbox"/> Perf. <input type="checkbox"/> Dually Comp. <input type="checkbox"/> Commingled <i>(Submit ACO-5)</i> <i>(Submit ACO-4)</i> <input type="checkbox"/> Other (Specify) _____	PRODUCTION INTERVAL: _____ _____
-------------------------------------------------------------------------------------------------------------------------------------------------------------------	-----------------------------------------------------------------------------------------------------------------------------------------------------------------------------------------------------------------------------------------------------------------------	----------------------------------------





**#2 Stieben 30BC**

2480' FNL & 1100' FWL

160' N & 110' E of E/2 W/2 W/2 Section 30-13S-31W

Gove County, Kansas

API# 15-063-21887-0000

Elevation: GL: 2906', KB: 2916'

<u>Sample Tops</u>			<u>Ref.</u>	<u>Well</u>
Anhydrite	2400'	+516	-5	
B/Anhydrite	2421'	+495	-4	
Heebner	3901'	-985	-4	
Toronto	3930'	-1014	-5	
Lansing	3946'	-1030	-5	
LKC-D	3995'	-1079	-4	
LKC-E	4016'	-1100	-3	
Muncie Shale	4093'	-1177	-7	
LKC-H	4108'	-1192	-7	
Stark Shale	4179'	-1263	-3	
BKC	4263'	-1347	-3	
Marmaton	4280'	-1364	-1	
Altamont	4330'	-1414	-1	
Pawnee	4379'	-1463	flat	
Myrick Station	4419'	-1503	-2	
Fort Scott	4435'	-1519	flat	
Cherokee Shale	4462'	-1546	-1	
Johnson	4504'	-1588	-1	
B/Johnson	4528'	-1612	-2	
Morrow Sand	Absent			
Mississippian	4550'	-1634	-13	
RTD	4655'	-1739		

Conservation Division  
Finney State Office Building  
130 S. Market, Rm. 2078  
Wichita, KS 67202-3802



Phone: 316-337-6200  
Fax: 316-337-6211  
<http://kcc.ks.gov/>

Mark Sievers, Chairman  
Thomas E. Wright, Commissioner  
Shari Feist Albrecht, Commissioner

Sam Brownback, Governor

June 20, 2013

John Niernberger  
Ritchie Exploration, Inc.  
P.O. Box 783188  
Wichita, KS 67278-3188

RE: Approved Commingling CO061303  
Stieben 30BC 2, Sec.30-T13S-R31W, Gove County  
API No. 15-063-21887-00-00

Dear Mr. Niernberger:

Your Application for Commingling (ACO-4) for the above described well has been reviewed and approved by the Kansas Corporation Commission (KCC) per K.A.R. 82-3-123. Notice was examined and found to be proper per K.A.R. 82-3-135a. No protest had been filed within the 15-day protest period. This application, which was received by the KCC on June 12, 2013, concerns approval to simultaneously produce from the following sources of supply through the same tubing string in the same wellbore:

Source of Supply	Estimated Current Production			Perf Depth
	BOPD	MCFPD	BWPD	
LKC-D/H	3.20	0.00	31.64	3996-4113
Myrick	0.83	0.00	1.67	4420-4423
Ft. Scott	0.83	0.00	1.67	4436-4440
Johnson	8.35	0.00	15.86	4507-4519
Total Estimated Current Production	13.21	0.00	50.84	

Based upon the depth of the Johnson formation perforations, total oil production shall not exceed 200 BOPD and total gas production shall not exceed 50% of the absolute open flow (AOF).

Commingling ID number CO061303 has been assigned to this approved application. Use this number for well completion reports (ACO-1) and other correspondence that may concern this approved commingling.

Sincerely,

Rick Hestermann  
Production Department