



**APPLICATION FOR COMMINGLING OF PRODUCTION (K.A.R. 82-3-123) OR FLUIDS (K.A.R. 82-3-123a)** *Commingling ID # \_\_\_\_\_*

OPERATOR: License # \_\_\_\_\_ API No. 15 - \_\_\_\_\_  
Name: \_\_\_\_\_ Spot Description: \_\_\_\_\_  
Address 1: \_\_\_\_\_ Sec. \_\_\_\_\_ Twp. \_\_\_\_\_ S. R. \_\_\_\_\_  East  West  
Address 2: \_\_\_\_\_ Feet from  North /  South Line of Section  
City: \_\_\_\_\_ State: \_\_\_\_\_ Zip: \_\_\_\_\_ + \_\_\_\_\_ Feet from  East /  West Line of Section  
Contact Person: \_\_\_\_\_ County: \_\_\_\_\_  
Phone: ( \_\_\_\_\_ ) \_\_\_\_\_ Lease Name: \_\_\_\_\_ Well #: \_\_\_\_\_

1. Name and upper and lower limit of each production interval to be commingled:  
Formation: \_\_\_\_\_ (Perfs): \_\_\_\_\_  
Formation: \_\_\_\_\_ (Perfs): \_\_\_\_\_  
Formation: \_\_\_\_\_ (Perfs): \_\_\_\_\_  
Formation: \_\_\_\_\_ (Perfs): \_\_\_\_\_  
Formation: \_\_\_\_\_ (Perfs): \_\_\_\_\_

2. Estimated amount of fluid production to be commingled from each interval:  
Formation: \_\_\_\_\_ BOPD: \_\_\_\_\_ MCFPD: \_\_\_\_\_ BWPD: \_\_\_\_\_  
Formation: \_\_\_\_\_ BOPD: \_\_\_\_\_ MCFPD: \_\_\_\_\_ BWPD: \_\_\_\_\_  
Formation: \_\_\_\_\_ BOPD: \_\_\_\_\_ MCFPD: \_\_\_\_\_ BWPD: \_\_\_\_\_  
Formation: \_\_\_\_\_ BOPD: \_\_\_\_\_ MCFPD: \_\_\_\_\_ BWPD: \_\_\_\_\_  
Formation: \_\_\_\_\_ BOPD: \_\_\_\_\_ MCFPD: \_\_\_\_\_ BWPD: \_\_\_\_\_

3. Plat map showing the location of the subject well, all other wells on the subject lease, and all wells on offsetting leases within a 1/2 mile radius of the subject well, and for each well the names and addresses of the lessee of record or operator.

4. Signed certificate showing service of the application and affidavit of publication as required in K.A.R. 82-3-135a.

**For Commingling of PRODUCTION ONLY, include the following:**

- 5. Wireline log of subject well. Previously Filed with ACO-1:  Yes  No
- 6. Complete Form ACO-1 (*Well Completion form*) for the subject well.

**For Commingling of FLUIDS ONLY, include the following:**

- 7. Well construction diagram of subject well.
- 8. Any available water chemistry data demonstrating the compatibility of the fluids to be commingled.

**AFFIDAVIT:** I am the affiant and hereby certify that to the best of my current information, knowledge and personal belief, this request for commingling is true and proper and I have no information or knowledge, which is inconsistent with the information supplied in this application.

**Submitted Electronically**

**KCC Office Use Only**  
 Denied  Approved  
15-Day Periods Ends: \_\_\_\_\_  
Approved By: \_\_\_\_\_ Date: \_\_\_\_\_

*Protests may be filed by any party having a valid interest in the application. Protests must be in writing and comply with K.A.R. 82-3-135b and must be filed within 15 days of publication of the notice of application.*

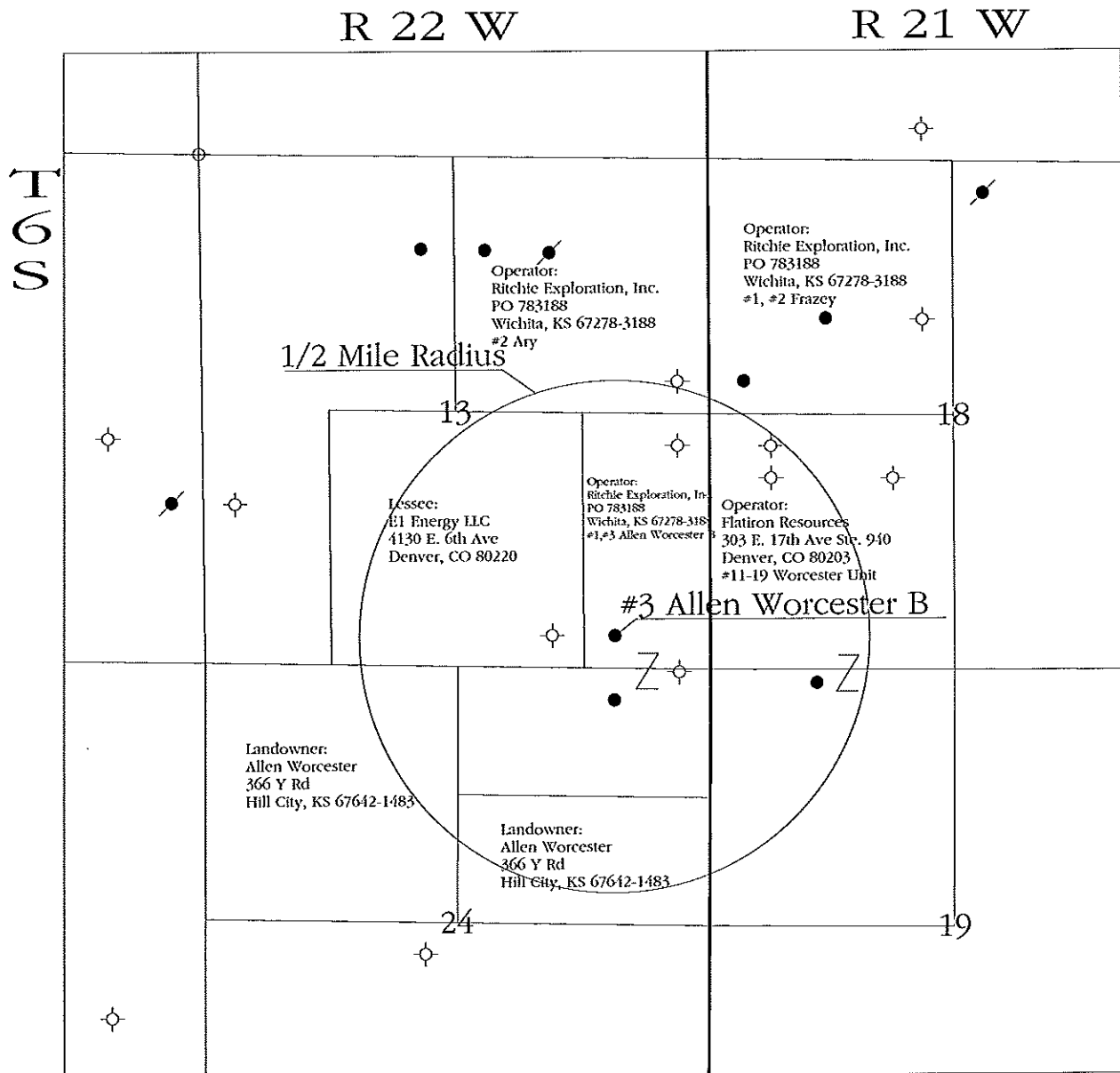

- Legend**
- Oil Well
  - / Abandoned Oil Well
  - ⊕ Dry and Abandoned Well



**RITCHIE**  
EXPLORATION, INC.  
Wichita, Kansas

**Application for  
Commingling of  
Production or Fluids**

**Applicant Well: #3 Allen Worcester B**  
All Wells on Offsetting Leases within 1/2 Mile Radius  
Name and Address of Lessee of Record or Operator  
On Offsetting Leases

<b>Graham County, Kansas</b>		
Prepared By: Justin Clegg	Scale: 1 : 21,120	Date: 5/28/2013

# APPLICATION FOR COMMINGLING OF PRODUCTION OR FLUIDS

Operator, Lessee or Unleased Mineral Owner  
within a ½ mile radius of Ritchie Exploration, Inc.'s

#3 Allen Worcester B  
335' FSL & 985' FEL  
Section 13-6S-22W  
Graham Co., KS

## Township 6 South, Range 21 West

Sec. 18:	NW/4	Ritchie Exploration, Inc. P.O. Box 783188 Wichita, KS 67278-3188	Operator: #1 Frazey, #2 Frazey
	SW/4	Flatirons Resources, LLC 303 E. 17 <sup>th</sup> Ave., Ste. 940 Denver, CO 80203	Operator: Worcester Unit #11-19
Sec. 19:	NW/4	Flatirons Resources, LLC	Operator: Worcester Unit #11-19

## Township 6 South, Range 22 West

Sec. 13:	NE/4	Ritchie Exploration, Inc.	Operator: #2 Ary
	E/2SE/4	Ritchie Exploration, Inc.	Operator: #3 Allen Worcester B
	E/2SW/4, W/2SE/4	E 1 Energy LLC. 4130 E. 6 <sup>th</sup> Ave. Denver, CO 80220	Lessee
Sec. 24:	N/2NE/4	Ritchie Exploration, Inc.	Operator: #1 Allen Worcester B
	S/2NE/4	Allen & Pauline Worcester Irr. Trust; Jessie Lea Williams Est.; Merlyn & Josie Worcester 3166 Y RD Hill City, KS 67642-1483	Landowners
	NW/4	Allen Worcester 3166 Y RD Hill City, KS 67642-1483	Landowner

**LEGAL NOTICE**

You, and each of you, are hereby notified that Ritchie Exploration, Inc. has filed an application to commence the commingling of production from the Lansing-Kansas City, and Toronto sources of supply for the #3 Allen Worcester B well located approx. SW SE SE of Section 13-6S-22W, Graham County, Kansas.

Any persons who object to or protest this application shall be required to file their objections or protests with the Conservation Division of the State Corporation Commission of the State of Kansas within fifteen (15) days from the date of the publication. These protests shall be filed pursuant to Commission regulations and must state specific reasons why the grant of the application may cause waste, violate correlative rights or pollute the natural resources of the state of Kansas. If no protests are received, this application may be granted through a summary proceeding. If valid protests are received, this matter will be set for hearing.

All persons interested or concerned shall take notice of the foregoing and shall govern themselves accordingly.

RITCHIE EXPLORATION, INC.  
P.O. Box 783188  
Wichita, KS 67278-3188  
(316) 691-9500

**AFFIDAVIT OF PUBLICATION**  
State of Kansas, County of Graham, ss:

JIM LOGBACK, of lawful age, being duly sworn, upon oath states that he is publisher of THE HILL CITY TIMES;

THAT said newspaper has been published weekly at least fifty (50) times a year and has been published at least five (5) years in Graham County, Kansas prior to the first publication of the attached notice;

THAT said newspaper has a general PAID circulation in GRAHAM COUNTY, KANSAS, and is NOT a trade, religious or fraternal publication.

THAT said newspaper is PRINTED IN KANSAS and PUBLISHED in GRAHAM COUNTY, KANSAS, and entered as second class mail matter at the post office of its publication in HILL CITY, KANSAS;

THAT, a notice of which the attached is a true and correct copy, was published in a regular issue of said newspaper for 1 consecutive weeks commencing with the issue of JUNE 12 2013.

*[Handwritten Signature]*

Publication Fee ..... \$ 23.10  
\_\_\_\_ Affidavits @ 75¢ .. \$ \_\_\_\_\_  
\_\_\_\_ Extra Copies @ 50¢ \$ \_\_\_\_\_  
TOTAL LEGAL FEE ..... \$ 23.10

SUBSCRIBED and sworn  
to before me this \_\_\_\_\_  
day of \_\_\_\_\_

My commission expires \_\_\_\_\_ Notary Public

**AFFIDAVIT**

STATE OF KANSAS \
- SS.
County of Sedgwick /

Mark Fletchall, of lawful age, being first duly sworn, deposeth and saith: That he is Record Clerk of The Wichita Eagle, a daily newspaper published in the City of Wichita, County of Sedgwick, State of Kansas, and having a general paid circulation on a daily basis in said County, which said newspaper has been continuously and uninterruptedly published in said County for more than one year prior to the first publication of the notice hereinafter mentioned, and which said newspaper has been entered as second class mail matter at the United States Post Office in Wichita, Kansas, and which said newspaper is not a trade, religious or fraternal publication and that a notice of a true copy is hereto attached was published in the regular and entire Morning issue of said The Wichita Eagle for  1  issues, that the first publication of said notice was

made as aforesaid on the  13th  of

June  A.D.  2013 , with

subsequent publications being made on the following dates:

**LEGAL PUBLICATION**  
PUBLISHED IN THE WICHITA EAGLE  
JUNE 13, 2013 (3250779)  
**LEGAL NOTICE**  
You, and each of you, are hereby notified that Ritchie Exploration, Inc. has filed an application to commence the commingling of production from the Lansing-Kansas City and Toronto sources of supply for the #3 Allen Worcester B well located approx. SW SE SE of Section 13-6S-22W, Graham County, Kansas. Any persons who object to or protest this application shall be required to file their objections or protests with the Conservation Division of the State Corporation Commission of the State of Kansas within fifteen (15) days from the date of the publication. These protests shall be filed pursuant to Commission regulations and must state specific reasons why the grant of the application may cause waste, violate correlative rights or pollute the natural resources of the state of Kansas. If no protests are received, this application may be granted through a summary proceeding. If valid protests are received, this matter will be set for hearing. All persons interested or concerned shall take notice of the foregoing and shall govern themselves accordingly.  
RITCHIE EXPLORATION, INC.  
P.O. Box 783188  
Wichita, KS 67278-3188  
(316) 691-9500

And affiant further says that he has personal knowledge of the statements above set forth and that they are true.

*Mark Fletchall*

Subscribed and sworn to before me this

13th day of June, 2013

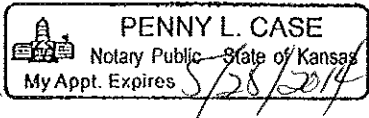

*Penny L. Case*  
Notary Public Sedgwick County, Kansas

**AFFIDAVIT**

STATE OF KANSAS        )  
                                  - SS.  
County of Sedgwick        )

John Niernberger, of lawful age, being first duly sworn, deposeseth and saith: That he is Production Manager of Ritchie Exploration, County of Sedgwick, State of Kansas, and that notice was given to all lessee of record or operator within ½ mile radius of the Allen Worcester B #3 well located in the County of Graham (see attached plat map). This notice included a letter and a copy of the Commingle Application (ACO-4). All notices were mailed on June 7, 2013.

made as aforesaid on the 7<sup>th</sup> of

**June A.D. 2013**

\_\_\_\_\_

And affiant further says that he has personal knowledge of the statements above set forth and that they are true.

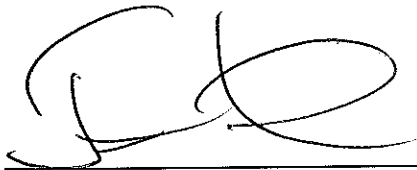
  
\_\_\_\_\_

Subscribed and sworn to before me this

7<sup>th</sup> day of June 2013

**KAREN HOPPER  
NOTARY PUBLIC-STATE OF KANSAS  
MY APPT. EXPIRES 3-8-15**

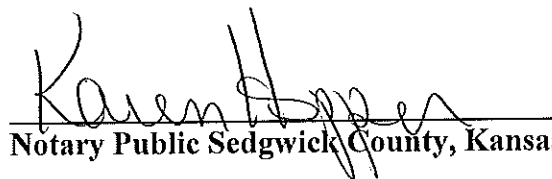
  
\_\_\_\_\_  
Notary Public Sedgwick County, Kansas

KANSAS CORPORATION COMMISSION  
OIL & GAS CONSERVATION DIVISION  
**WELL COMPLETION FORM**  
WELL HISTORY - DESCRIPTION OF WELL & LEASE

Form ACO-1  
June 2009  
Form Must Be Typed  
Form must be Signed  
All blanks must be Filled

OPERATOR: License # 4767  
Name: Ritchie Exploration, Inc.  
Address 1: P.O. Box 783188  
Address 2: \_\_\_\_\_  
City: Wichita State: KS Zip: 67278 + 3188  
Contact Person: John Niernberger  
Phone: ( 316 ) 691-9500  
CONTRACTOR: License # 33575  
Name: WW Drilling, LLC  
Wellsite Geologist: Jeff Christian  
Purchaser: NCRA

Designate Type of Completion:

- New Well       Re-Entry       Workover
- Oil       WSW       SWD       SLOW
- Gas       D&A       ENHR       SIGW
- OG       GSW       Temp. Abd.
- CM (Coal Bed Methane)
- Cathodic     Other (Core, Expl., etc.): \_\_\_\_\_

If Workover/Re-entry: Old Well Info as follows:

Operator: \_\_\_\_\_  
Well Name: \_\_\_\_\_  
Original Comp. Date: \_\_\_\_\_ Original Total Depth: \_\_\_\_\_

Deepening     Re-perf.     Conv. to ENHR     Conv. to SWD

Conv. to GSW

Plug Back: \_\_\_\_\_ Plug Back Total Depth \_\_\_\_\_

Commingled      Permit #: \_\_\_\_\_

Dual Completion    Permit #: \_\_\_\_\_

SWD      Permit #: \_\_\_\_\_

ENHR      Permit #: \_\_\_\_\_

GSW      Permit #: \_\_\_\_\_

<u>2/23/11</u>	<u>3/3/11</u>	<u>3/3/11</u>
Spud Date or Recompletion Date	Date Reached TD	Completion Date or Recompletion Date

API No. 15 - 065-23718-00-00  
Spot Description: 5' N & 5' W of  
SW SE SE Sec. 13 Twp. 6 S. R. 22  East  West  
335 Feet from  North /  South Line of Section  
985 Feet from  East /  West Line of Section

Footages Calculated from Nearest Outside Section Corner:  
 NE     NW     SE     SW

County: Graham  
Lease Name: Allen Worcester B Well #: 3  
Field Name: \_\_\_\_\_  
Producing Formation: Toronto & LKC  
Elevation: Ground: 2302 Kelly Bushing: 2307  
Total Depth: 3860 Plug Back Total Depth: 3834'  
Amount of Surface Pipe Set and Cemented at: 219 Feet  
Multiple Stage Cementing Collar Used?  Yes  No  
If yes, show depth set: 1937 Feet  
If Alternate II completion, cement circulated from: 1937  
feet depth to: surface w/ 300 sx cmt.

**Drilling Fluid Management Plan**

(Data must be collected from the Reserve Pit)

Chloride content: 17000 ppm Fluid volume: 1100 bbls  
Dewatering method used: evaporation  
Location of fluid disposal if hauled offsite: \_\_\_\_\_  
Operator Name: \_\_\_\_\_  
Lease Name: \_\_\_\_\_ License #: \_\_\_\_\_  
Quarter \_\_\_\_\_ Sec. \_\_\_\_\_ Twp. \_\_\_\_\_ S. R. \_\_\_\_\_  East  West  
County: \_\_\_\_\_ Permit #: \_\_\_\_\_

**INSTRUCTIONS:** An original and two copies of this form shall be filed with the Kansas Corporation Commission, 130 S. Market - Room 2078, Wichita, Kansas 67202, within 120 days of the spud date, recompletion, workover or conversion of a well. Rule 82-3-130, 82-3-106 and 82-3-107 apply. Information of side two of this form will be held confidential for a period of 12 months if requested in writing and submitted with the form (see rule 82-3-107 for confidentiality in excess of 12 months). One copy of all wireline logs and geologist well report shall be attached with this form. ALL CEMENTING TICKETS MUST BE ATTACHED. Submit CP-4 form with all plugged wells. Submit CP-111 form with all temporarily abandoned wells.

**AFFIDAVIT**

I am the affiant and I hereby certify that all requirements of the statutes, rules and regulations promulgated to regulate the oil and gas industry have been fully complied with and the statements herein are complete and correct to the best of my knowledge.

Signature: \_\_\_\_\_  
Title: Production Manager Date: 5/26/11

**KCC Office Use ONLY**

- Letter of Confidentiality Received  
Date: \_\_\_\_\_
- Confidential Release Date: \_\_\_\_\_
- Wireline Log Received
- Geologist Report Received
- UIC Distribution
- ALT  I  II  III Approved by: \_\_\_\_\_ Date: \_\_\_\_\_

Operator Name: Ritchie Exploration, Inc. Lease Name: Allen Worcester B Well #: 3  
 Sec. 13 Twp. 6 S. R. 22  East  West County: Graham

**INSTRUCTIONS:** Show important tops and base of formations penetrated. Detail all cores. Report all final copies of drill stems tests giving interval tested, time tool open and closed, flowing and shut-in pressures, whether shut-in pressure reached static level, hydrostatic pressures, bottom hole temperature, fluid recovery, and flow rates if gas to surface test, along with final chart(s). Attach extra sheet if more space is needed. Attach complete copy of all Electric Wireline Logs surveyed. Attach final geological well site report.

Drill Stem Tests Taken <input checked="" type="checkbox"/> Yes <input type="checkbox"/> No <i>(Attach Additional Sheets)</i>  Samples Sent to Geological Survey <input checked="" type="checkbox"/> Yes <input type="checkbox"/> No Cores Taken <input type="checkbox"/> Yes <input checked="" type="checkbox"/> No Electric Log Run <input checked="" type="checkbox"/> Yes <input type="checkbox"/> No Electric Log Submitted Electronically <input type="checkbox"/> Yes <input checked="" type="checkbox"/> No <i>(If no, Submit Copy)</i>  List All E. Logs Run: <b>Radiation Guard Log</b>	<input type="checkbox"/> Log Formation (Top), Depth and Datum <input checked="" type="checkbox"/> Sample Name Top Datum  SEE ATTACHED
--	--

CASING RECORD <input checked="" type="checkbox"/> New <input type="checkbox"/> Used							
Report all strings set-conductor, surface, intermediate, production, etc.							
Purpose of String	Size Hole Drilled	Size Casing Set (In O.D.)	Weight Lbs. / Ft.	Setting Depth	Type of Cement	# Sacks Used	Type and Percent Additives
Surface	12-1/4	8-5/8	23	219	common	150	3% cc, 2% gel
Production	7-7/8	4-1/2	10.5	3858	60/40 Poz	160	10% sal, 2% gel & 3/4% CD31

ADDITIONAL CEMENTING / SQUEEZE RECORD				
Purpose:	Depth Top Bottom	Type of Cement	# Sacks Used	Type and Percent Additives
<input type="checkbox"/> Perforate <input type="checkbox"/> Protect Casing <input type="checkbox"/> Plug Back TD <input type="checkbox"/> Plug Off Zone				

Shots Per Foot	PERFORATION RECORD - Bridge Plugs Set/Type Specify Footage of Each Interval Perforated	Acid, Fracture, Shot, Cement Squeeze Record <i>(Amount and Kind of Material Used)</i>	Depth
4	3708' - 3709.5', 3699' - 3702' (3/29/11)	1000 gallons 15% NE & 15 soluble perf-ball-sealers (3/30/11)	
4	3539' - 3541' (3/29/11)	500 gallons 15% NE (3/30/11)	

TUBING RECORD: Size: <u>2-3/8"</u> Set At: <u>3817'</u> Packer At: _____		Liner Run: <input type="checkbox"/> Yes <input checked="" type="checkbox"/> No
Date of First, Resumed Production, SWD or ENHR. <u>5/2/11</u>		Producing Method: <input type="checkbox"/> Flowing <input checked="" type="checkbox"/> Pumping <input type="checkbox"/> Gas Lift <input type="checkbox"/> Other (Explain) _____
Estimated Production Per 24 Hours	Oil Bbls. <u>8.19</u>	Gas Mcf _____ Water Bbls. <u>2.04</u> Gas-Oil Ratio _____ Gravity <u>34.7</u>

DISPOSITION OF GAS: <input type="checkbox"/> Vented <input type="checkbox"/> Sold <input type="checkbox"/> Used on Lease <i>(If vented, Submit ACO-18.)</i>	METHOD OF COMPLETION: <input type="checkbox"/> Open Hole <input type="checkbox"/> Perf. <input type="checkbox"/> Dually Comp. <input type="checkbox"/> Commingled <i>(Submit ACO-5)</i> <i>(Submit ACO-4)</i> <input type="checkbox"/> Other (Specify) _____	PRODUCTION INTERVAL: _____ _____
---	---	--





**#3 Allen Worcester B**  
335' FSL & 985' FEL  
5' N & 5' W of SW SE SE Section 13-6S-22W  
Graham County, Kansas  
API# 15-065-23718-0000  
Elevation: GL: 2302', KB: 2307'

<u>Sample Tops</u>			<u>Ref.</u>	<u>Well</u>
Anhydrite	1963'	+344	-1	
B/Anhydrite	1995'	+312	flat	
Topeka	3312'	-1005	-3	
Heebner	3511'	-1204	+1	
Toronto	3542'	-1235	-3	
Lansing	3560'	-1253	-3	
Muncie Shale	3666'	-1359	+1	
BKC	3743'	-1436	+4	
Conglomerate	3782'	-1475	+7	
Arbuckle	3836'	-1529	+11	
RTD	3860'	-1553		

July 1, 2013

John Niernberger  
Ritchie Exploration, Inc.  
P.O. Box 783188  
Wichita, KS 67278-3188

RE: Approved Commingling CO061304  
Allen Worcester B 3, Sec.13-T6S-R22W, Graham County  
API No. 15-065-23718-00-00

Dear Mr. Niernberger:

Your Application for Commingling (ACO-4) for the above described well has been reviewed and approved by the Kansas Corporation Commission (KCC) per K.A.R. 82-3-123. Notice was examined and found to be proper per K.A.R. 82-3-135a. No protest had been filed within the 15-day protest period. This application, which was received by the KCC on June 17, 2013, concerns approval to simultaneously produce from the following sources of supply through the same tubing string in the same wellbore:

Source of Supply	Estimated Current Production			Perf Depth
	BOPD	MCFPD	BWPD	
Toronto	0.51	0.00	0.82	3539-3541
LKC-I/J	1.54	0.00	1.22	3699-3709
Total Estimated Current Production	2.05	0.00	2.04	

Based upon the depth of the LKC formation perforations, total oil production shall not exceed 100 BOPD and total gas production shall not exceed 50% of the absolute open flow (AOF).

Commingling ID number CO061304 has been assigned to this approved application. Use this number for well completion reports (ACO-1) and other correspondence that may concern this approved commingling.

Sincerely,

Rick Hestermann  
Production Department