



Confidentiality Requested:

Yes No

KANSAS CORPORATION COMMISSION 1148412
OIL & GAS CONSERVATION DIVISION

Form ACO-1

August 2013

Form must be Typed
Form must be Signed
All blanks must be Filled

WELL COMPLETION FORM
WELL HISTORY - DESCRIPTION OF WELL & LEASE

OPERATOR: License # _____

Name: _____

Address 1: _____

Address 2: _____

City: _____ State: _____ Zip: _____ + _____

Contact Person: _____

Phone: (_____) _____

CONTRACTOR: License # _____

Name: _____

Wellsite Geologist: _____

Purchaser: _____

Designate Type of Completion:

- New Well Re-Entry Workover
- Oil WSW SWD SIOW
- Gas D&A ENHR SIGW
- OG GSW Temp. Abd.
- CM (Coal Bed Methane)
- Cathodic Other (Core, Expl., etc.): _____

If Workover/Re-entry: Old Well Info as follows:

Operator: _____

Well Name: _____

Original Comp. Date: _____ Original Total Depth: _____

- Deepening Re-perf. Conv. to ENHR Conv. to SWD
- Plug Back Conv. to GSW Conv. to Producer
- Commingled Permit #: _____
- Dual Completion Permit #: _____
- SWD Permit #: _____
- ENHR Permit #: _____
- GSW Permit #: _____

Spud Date or Recompletion Date	Date Reached TD	Completion Date or Recompletion Date
-----------------------------------	-----------------	---

API No. 15 - _____

Spot Description: _____

_____ - _____ - _____ Sec. _____ Twp. _____ S. R. _____ East West

_____ Feet from North / South Line of Section

_____ Feet from East / West Line of Section

Footages Calculated from Nearest Outside Section Corner:

- NE NW SE SW

GPS Location: Lat: _____, Long: _____
(e.g. xx.xxxxx) (e.g. -xxx.xxxxx)

Datum: NAD27 NAD83 WGS84

County: _____

Lease Name: _____ Well #: _____

Field Name: _____

Producing Formation: _____

Elevation: Ground: _____ Kelly Bushing: _____

Total Vertical Depth: _____ Plug Back Total Depth: _____

Amount of Surface Pipe Set and Cemented at: _____ Feet

Multiple Stage Cementing Collar Used? Yes No

If yes, show depth set: _____ Feet

If Alternate II completion, cement circulated from: _____

feet depth to: _____ w/ _____ sx cmt.

Drilling Fluid Management Plan

(Data must be collected from the Reserve Pit)

Chloride content: _____ ppm Fluid volume: _____ bbls

Dewatering method used: _____

Location of fluid disposal if hauled offsite:

Operator Name: _____

Lease Name: _____ License #: _____

Quarter _____ Sec. _____ Twp. _____ S. R. _____ East West

County: _____ Permit #: _____

AFFIDAVIT

I am the affiant and I hereby certify that all requirements of the statutes, rules and regulations promulgated to regulate the oil and gas industry have been fully complied with and the statements herein are complete and correct to the best of my knowledge.

Submitted Electronically

KCC Office Use ONLY

- Confidentiality Requested
Date: _____
- Confidential Release Date: _____
- Wireline Log Received
- Geologist Report Received
- UIC Distribution
- ALT I II III Approved by: _____ Date: _____



1148412

Operator Name: _____ Lease Name: _____ Well #: _____

Sec. _____ Twp. _____ S. R. _____ East West County: _____

INSTRUCTIONS: Show important tops of formations penetrated. Detail all cores. Report all final copies of drill stems tests giving interval tested, time tool open and closed, flowing and shut-in pressures, whether shut-in pressure reached static level, hydrostatic pressures, bottom hole temperature, fluid recovery, and flow rates if gas to surface test, along with final chart(s). Attach extra sheet if more space is needed.

Final Radioactivity Log, Final Logs run to obtain Geophysical Data and Final Electric Logs must be emailed to kcc-well-logs@kcc.ks.gov. Digital electronic log files must be submitted in LAS version 2.0 or newer AND an image file (TIFF or PDF).

Drill Stem Tests Taken <i>(Attach Additional Sheets)</i>	<input type="checkbox"/> Yes <input type="checkbox"/> No	<input type="checkbox"/> Log	Formation (Top), Depth and Datum	<input type="checkbox"/> Sample
Samples Sent to Geological Survey	<input type="checkbox"/> Yes <input type="checkbox"/> No	Name	Top	Datum
Cores Taken	<input type="checkbox"/> Yes <input type="checkbox"/> No			
Electric Log Run	<input type="checkbox"/> Yes <input type="checkbox"/> No			
List All E. Logs Run:				

CASING RECORD <input type="checkbox"/> New <input type="checkbox"/> Used							
Report all strings set-conductor, surface, intermediate, production, etc.							
Purpose of String	Size Hole Drilled	Size Casing Set (In O.D.)	Weight Lbs. / Ft.	Setting Depth	Type of Cement	# Sacks Used	Type and Percent Additives

ADDITIONAL CEMENTING / SQUEEZE RECORD				
Purpose:	Depth Top Bottom	Type of Cement	# Sacks Used	Type and Percent Additives
<input type="checkbox"/> Perforate				
<input type="checkbox"/> Protect Casing				
<input type="checkbox"/> Plug Back TD				
<input type="checkbox"/> Plug Off Zone				

Did you perform a hydraulic fracturing treatment on this well? Yes No *(If No, skip questions 2 and 3)*

Does the volume of the total base fluid of the hydraulic fracturing treatment exceed 350,000 gallons? Yes No *(If No, skip question 3)*

Was the hydraulic fracturing treatment information submitted to the chemical disclosure registry? Yes No *(If No, fill out Page Three of the ACO-1)*

Shots Per Foot	PERFORATION RECORD - Bridge Plugs Set/Type Specify Footage of Each Interval Perforated	Acid, Fracture, Shot, Cement Squeeze Record <i>(Amount and Kind of Material Used)</i>	Depth

TUBING RECORD: Size: _____ Set At: _____ Packer At: _____ Liner Run: Yes No

Date of First, Resumed Production, SWD or ENHR. _____ Producing Method:
 Flowing Pumping Gas Lift Other *(Explain)* _____

Estimated Production Per 24 Hours	Oil Bbls.	Gas Mcf	Water Bbls.	Gas-Oil Ratio	Gravity

DISPOSITION OF GAS: <input type="checkbox"/> Vented <input type="checkbox"/> Sold <input type="checkbox"/> Used on Lease <i>(If vented, Submit ACO-18.)</i>	METHOD OF COMPLETION: <input type="checkbox"/> Open Hole <input type="checkbox"/> Perf. <input type="checkbox"/> Dually Comp. <input type="checkbox"/> Commingled <i>(Submit ACO-5)</i> <input type="checkbox"/> Other <i>(Specify)</i> _____ <input type="checkbox"/> Other <i>(Specify)</i> _____	PRODUCTION INTERVAL: _____ _____
--	---	---

Form	ACO1 - Well Completion
Operator	SandRidge Exploration and Production LLC
Well Name	Donna 3304 1-24H
Doc ID	1148412

All Electric Logs Run

Final Boresight
Vertical Final
Prizm Log
Induction
Porosity

Form	ACO1 - Well Completion
Operator	SandRidge Exploration and Production LLC
Well Name	Donna 3304 1-24H
Doc ID	1148412

Tops

Name	Top	Datum
Base Heebner	2800	
Tonkawa	3140	
Cottage Grove	3446	
Oswego Limestone	3796	
Cherokee Group	3908	
Verdigris Limestone	3942	
Mississippi Unconformity	4117	
Mississippi Limestone	4126	

Form	ACO1 - Well Completion
Operator	SandRidge Exploration and Production LLC
Well Name	Donna 3304 1-24H
Doc ID	1148412

Perforations

Shots Per Foot	Perforation Record	Material Record	Depth
5	8590-8815	1500 gals 15% HCL, 4148 bbls Fresh Slickwater, Running TLTR= 4934 bbls	
5	7823-8025	1500 gals 15% HCL, 4103 bbls Fresh Slickwater, Running TLTR= 9222 bbls	
5	7451-7760	1500 gals 15% HCL, 4132 bbls Fresh Slickwater, Running TLTR= 13512 bbls	
5	6868-7058	1500 gals 15% HCL, 4037 bbls Fresh Slickwater, Running TLTR= 17675 bbls	
5	6371-6575	1500 gals 15% HCL, 4061 bbls Fresh Slickwater, Running TLTR= 21772 bbls	
5	6127-6310	1500 gals 15% HCL, 3966 bbls Fresh Slickwater, Running TLTR= 25848 bbls	
5	5248-5545	1500 gals 15% HCL, 3912 bbls Fresh Slickwater, Running TLTR= 29902 bbls	
5	4913-5194	1500 gals 15% HCL, 4081 bbls Fresh Slickwater, Running TLTR= 34019 bbls	

Conservation Division
Finney State Office Building
130 S. Market, Rm. 2078
Wichita, KS 67202-3802



Phone: 316-337-6200
Fax: 316-337-6211
<http://kcc.ks.gov/>

Mark Sievers, Chairman
Thomas E. Wright, Commissioner
Shari Feist Albrecht, Commissioner

Sam Brownback, Governor

June 17, 2013

Tiffany Golay
SandRidge Exploration and Production LLC
123 ROBERT S. KERR AVE
OKLAHOMA CITY, OK 73102-6406

Re: ACO1
API 15-191-22671-01-00
Donna 3304 1-24H
NE/4 Sec.24-33S-04W
Sumner County, Kansas

Dear Production Department:

We are herewith requesting that the Well Completion Form ACO-1 and attached information for the subject well be held confidential for a period of two years.

Should you have any questions or need additional information regarding subject well, please contact our office.

Respectfully,
Tiffany Golay



BASIN SERVICES, LLC
 P O BOX 4268
 ABILENE, TX 79608-4268
 Phone # (325)690-0053
 Fax # (325)698-0055

INVOICE

INVOICE NO.: 206
 INVOICE DATE: 06/24/2013

SANDRIDGE ENERGY
 123 ROBERT S KERR AVE
 OKLAHOMA CITY, OK 73102-6406

YARD: WY WAYNOKA OK
 LEASE: Donna
 WELL#: 3304 1-24H
 RIG #: Lariat 45
 Co/St: SUMNER, KS

Tkt # WY-31-1 (10401) 05/26/2013-05/27/2013

DESCRIPTION	FOOTAGE	QUANTITY	RATE	AMOUNT
5/26-27/2013 DRILLED 30" CONDUCTOR HOLE				
5/26-27/2013 20" CONDUCTOR PIPE (.250 WALL)				
5/26-27/2013 6' X 6' CELLAR TINHORN WITH PROTECTIVE RING				
5/26-27/2013 DRILL & INSTALL 6' X 6' CELLAR TINHORN				
5/26-27/2013 DRILLED 20" MOUSE HOLE (PER FOOT)				
5/26-27/2013 16" CONDUCTOR PIPE (.250 WALL)				
5/26-27/2013 MOBILIZATION OF EQUIPMENT & ROAD PERMITTING FEE				
5/26-27/2013 WELDING SERVICES FOR PIPE & LIDS				
5/26-27/2013 PROVIDED EQUIPMENT & LABOR TO ASSIST IN PUMPING CONCRETE				
5/26-27/2013 PROVIDED METAL LIDS (1 FOR CONDUCTOR & 2 FOR MOUSEHOLE PIPE)				
5/26-27/2013 10 SACK GROUT				
5/26-27/2013 TAXABLE ITEMS				
5/26-27/2013 BID + TAXABLE ITEMS				

Sub Total:
 Tax SUMNER COUNTY (6.8 %):
 PLEASE PAY THIS AMOUNT:

██████████
 ██████████
 ██████████
 ██████████
 ██████████
 ██████████

JOB SUMMARY			PROJECT NUMBER SOK 2730	TICKET DATE 06/01/13
COUNTY Sumner	State Kansas	COMPANY Bridge Exploration & Produc	CUSTOMER REP Bill Torbett	
LEASE NAME Donna 3304	Well No. 1-24H	JOB TYPE Surface	EMPLOYEE NAME Johnny Breeze	

EMP NAME Johnny Breeze									
Dustin Odom									
Flo Helkena									
Roy Morris									

Form. Name _____ Type: _____
Packer Type _____ Set At **0**
Bottom Hole Temp. **80** Pressure _____
Retainer Depth _____ Total Depth **400'**

	Called Out	On Location	Job Started	Job Completed
Date	6/1/2013	6/1/2013	6/1/2013	6/1/2013
Time	0300	0900	0955	1200

Tools and Accessories

Type and Size	Qty	Make
Auto Fill Tube	0	IR
Insert Float Val	0	IR
Centralizers	0	IR
Top Plug	1	IR
HEAD	1	IR
Limit clamp	0	IR
Weld-A	0	IR
Texas Pattern Guide Shoe	0	IR
Cement Basket	0	IR

Well Data

	New/Used	Weight	Size	Grade	From	To	Max. Allow
Casing		54.5#	13 3/4"		Surface	396	1,500
Liner							
Liner							
Tubing			0				
Drill Pipe							
Open Hole			17 1/2"		Surface	400'	Shots/Ft.
Perforations							
Perforations							
Perforations							

Materials

Mud Type	WBM	Density	9	Lb/Gal
Disp. Fluid	Fresh Water	Density	8.33	Lb/Gal
Spacer type	Fresh Water	BBL.	10	8.33
Spacer type	BBL.			
Acid Type	Gal.	%		
Acid Type	Gal.	%		
Surfactant	Gal.	In		
NE Agent	Gal.	In		
Fluid Loss	Gal/Lb	In		
Gelling Agent	Gal/Lb	In		
Fric. Red.	Gal/Lb	In		
MISC.	Gal/Lb	In		

Hours On Location		Operating Hours		Description of Job
Date	Hours	Date	Hours	
6/1	3.0	6/1	4.0	Surface
Total	3.0	Total	4.0	

Perfpac Balls _____ Qty. _____
Other _____
Other _____
Other _____
Other _____

Pressures

MAX	1,500 PSI	AVG	200
Average Rates in BPM			
MAX	6 BPM	AVG	5
Cement Left in Pipe			
Feet	46	Reason	SHOE JOINT

Cement Data

Stage	Sacks	Cement	Additives	W/Rq.	Yield	Lbs/Gal
1	320	TEX Lite Premium Plus 65	(6% Gel) 2% Calcium Chloride - 1/2pps Cello-Flake - .5% C-41P	10.88	1.84	12.70
2	180	Premium Plus (Class C)	2% Calcium Chloride - 1/2pps Cello-Flake	6.32	1.32	14.80
3	0	0		0	0.00	0.00

Summary

Preflush Breakdown	Type: _____	MAXIMUM	1,500 PSI	Preflush: BBI	10.00	Type: Fresh Water
	Lost Returns-N	NO/FULL		Load & Bkdn: Gal - BBI	N/A	Pad:Bbl -Gal N/A
	Actual TOC	SURFACE		Excess /Return BBI	60	Calc. Disp Bbl 54
Average	Bump Plug PSI:	1,000		Calc. TOC:	SURFACE	Actual Disp. 54.13
ISIP	5 Min.	10 Min.	15 Min.	Final Circ. PSI:	300	Disp:Bbl _____
				Cement Slurry: BBI	147.2	
				Total Volume BBI	211.32	

CUSTOMER REPRESENTATIVE Bill Torbett SIGNATURE

JOB SUMMARY			PROJECT NUMBER SOK 2754	TICKET DATE 06/07/13
COUNTY Sumner	State Kansas	COMPANY Sandridge Exploration & Production	CUSTOMER REP Bill Torbett	
LEASE NAME Donna 3304	Well No. 1-24H	JOB TYPE Intermediate	EMPLOYEE NAME ROBERT BURRIS	

EMP NAME	Robert Burris	0				
	Mike Hall					
	Cheryl Newton					
	David Settlemier					

Form. Name _____ Type: _____
Packer Type _____ Set At **0**
Bottom Hole Temp. **155** Pressure _____
Retainer Depth _____ Total Depth **4840**

	Called Out	On Location	Job Started	Job Completed
Date	6/7/2013	6/7/2013	6/7/2013	6/7/2013
Time	24:00	03:15	09:43	11:40

Tools and Accessories		
Type and Size	Qty	Make
Auto Fill Tube	0	IR
Insert Float Val	0	IR
Centralizers	0	IR
Top Plug	0	IR
HEAD	0	IR
Limit clamp	0	IR
Weld-A	0	IR
Texas Pattern Guide Shoe	0	IR
Cement Basket	0	IR

Well Data						
	New/Used	Weight	Size	Grade	From	To
Casing		26#	7"		Surface	4,869
Liner						5,000
Liner						
Tubing			0			
Drill Pipe						
Open Hole			8 3/4"		Surface	4,976
Perforations						Shots/Ft.
Perforations						
Perforations						

Materials			
Mud Type	WBM	Density	9 Lb/Gal
Disp. Fluid	Fresh Water	Density	8.33 Lb/Gal
Spacer type	BARITE	BBL.	15 10.00
Spacer type		BBL.	
Acid Type		Gal.	%
Acid Type		Gal.	%
Surfactant		Gal.	In
NE Agent		Gal.	In
Fluid Loss		Gal/Lb	In
Gelling Agent		Gal/Lb	In
Fric. Red.		Gal/Lb	In
MISC.		Gal/Lb	In
Perfpac Balls		Qty.	
Other			
Other			
Other			
Other			

Hours On Location		Operating Hours		Description of Job
Date	Hours	Date	Hours	
6/7	7.5	6/7	1.0	Intermediate
Total	7.5	Total	1.0	

Pressures			
MAX	5,000 PSI	AVG.	575
Average Rates in BPM			
MAX	8 BPM	AVG	5.5
Cement Left in Pipe			
Feet	46	Reason	SHOE JOINT

Cement Data						
Stage	Sacks	Cement	Additives	W/Rq.	Yield	Lbs/Gal
1	230	50/50 POZ PREMIUM	4% Gel - 0.4% FL-17 - 0.2% C-51 - 0.1% C-20 - 0.1% C-37 - 0.5% C-41P	6.77	1.44	13.60
2	100	Premium	0.4% FL-17 - 0.1% C-51 - 0.1% C-20 - 0.4% C-41P	5.20	1.18	16.60
3	0	0		0	0.00	0.00

Summary					
Preflush	15.00	Type:	10ppg Barite Spacer	Preflush:	BBI
Breakdown	MAXIMUM	5,000 PSI	Load & Bkdn:	Gal - BBI	N/A
	Lost Returns-N	NO/FULL	Excess /Return	BBI	N/A
	Actual TOC	2.811	Calc. TOC:		2.811
Average	Bump Plug PSI:	1.100	Final Circ.	PSI:	650
131P	5 Min.	10 Min.	Cement Slurry:	BBI	80.0
		15 Min.	Total Volume	BBI	277.00

CUSTOMER REPRESENTATIVE _____ SIGNATURE _____



Standard Wellpath Report
Sandridge
Sec 24 - 33S - 4W, Kansas
Sumner County
Wellbore: Donna 3304 1-24H (Actual)

Wellbore

Name	Created	Last Revised
Donna 3304 1-24H (Actual)	8-May-2013	17-Jun-2013

Well

Name	Government ID	Last Revised
Donna 3304 1-24H		8-May-2013

Slot

Name	Grid Northing	Grid Easting	Latitude	Longitude	North	East
Donna 3304 1-24H	181606.0000	2234688.0000	N37 9 45.4982	W97 41 40.8200	2450.95S	614.99W

Installation

Name	Easting	Northing	Coord System Name	North Alignment
Sumner County	2235303.0000	184057.0001	KS-S on NORTH AMERICAN DATUM 1927 datum	Grid

Field

Name	Easting	Northing	Coord System Name	North Alignment
Sec 24 - 33S - 4W	2235303.0000	184057.0001	KS-S on NORTH AMERICAN DATUM 1927 datum	Grid

Created By

--

Comments

FINAL Surveys. MD 8930 is a projection to bit @ TD



Standard Wellpath Report
Sandridge
Sec 24 - 33S - 4W, Kansas
Sumner County
Wellbore: Donna 3304 1-24H (Actual)

Wellpath (Grid) Report

MD[ft]	Inc[deg]	Azi[deg]	TVD[ft]	North[ft]	East[ft]	Dogleg [deg/100ft]	Vertical Section[ft]	Easting	Northing
0.00	0.00	0.000	0.00	0.00N	0.00E		0.00	2234688.00	181606.00
502.00	0.80	113.700	501.98	1.41S	3.21E	0.16	-1.46	2234691.21	181604.59
961.00	0.90	126.200	960.93	4.83S	9.05E	0.05	-4.96	2234697.05	181601.17
1419.00	0.50	143.900	1418.90	8.56S	13.13E	0.10	-8.76	2234701.13	181597.44
1881.00	0.20	295.800	1880.89	9.84S	13.59E	0.15	-10.04	2234701.59	181596.16
2260.00	0.40	345.100	2259.89	8.28S	12.66E	0.08	-8.46	2234700.66	181597.72
2735.00	1.30	51.500	2734.84	3.32S	16.45E	0.25	-3.56	2234704.45	181602.68
3210.00	1.70	45.400	3209.68	4.98N	25.68E	0.09	4.60	2234713.68	181610.98
3427.00	1.30	66.000	3426.60	8.24N	30.22E	0.31	7.80	2234718.22	181614.24
3463.00	1.40	59.600	3462.59	8.63N	30.98E	0.50	8.18	2234718.98	181614.63
3495.00	2.40	20.300	3494.58	9.46N	31.55E	4.96	8.99	2234719.55	181615.46
3527.00	4.50	7.000	3526.52	11.33N	31.93E	6.98	10.86	2234719.93	181617.33
3558.00	6.60	4.200	3557.37	14.32N	32.21E	6.83	13.84	2234720.21	181620.32
3590.00	9.00	3.000	3589.07	18.65N	32.48E	7.52	18.17	2234720.48	181624.65
3621.00	11.10	1.700	3619.59	24.06N	32.69E	6.81	23.57	2234720.69	181630.06
3653.00	13.20	359.900	3650.88	30.79N	32.78E	6.67	30.31	2234720.78	181636.79
3685.00	15.30	359.400	3681.89	38.67N	32.73E	6.57	38.18	2234720.73	181644.67
3716.00	17.30	359.300	3711.64	47.37N	32.63E	6.45	46.88	2234720.63	181653.37
3748.00	19.40	358.200	3742.01	57.44N	32.40E	6.65	56.95	2234720.40	181663.44
3780.00	21.30	356.900	3772.01	68.55N	31.92E	6.10	68.08	2234719.92	181674.55
3811.00	24.00	356.100	3800.62	80.47N	31.19E	8.77	80.00	2234719.19	181686.47
3843.00	26.70	356.700	3829.54	94.14N	30.33E	8.48	93.68	2234718.33	181700.14
3875.00	29.10	356.500	3857.82	109.09N	29.44E	7.51	108.64	2234717.44	181715.09
3906.00	31.50	356.200	3884.58	124.69N	28.44E	7.76	124.26	2234716.44	181730.70
3938.00	34.20	356.100	3911.46	142.01N	27.28E	8.44	141.59	2234715.28	181748.01
3970.00	37.10	356.500	3937.46	160.62N	26.08E	9.09	160.22	2234714.08	181766.62
4001.00	40.30	357.400	3961.65	179.97N	25.05E	10.48	179.59	2234713.05	181785.98
4033.00	42.90	358.500	3985.58	201.20N	24.30E	8.44	200.82	2234712.30	181807.21
4065.00	45.40	359.100	4008.54	223.48N	23.83E	7.92	223.11	2234711.83	181829.49
4096.00	47.50	359.200	4029.89	245.95N	23.50E	6.78	245.58	2234711.50	181851.95
4128.00	50.20	358.800	4050.95	270.04N	23.08E	8.49	269.67	2234711.08	181876.04
4159.00	53.20	358.900	4070.16	294.36N	22.59E	9.68	294.00	2234710.59	181900.36
4191.00	56.30	359.000	4088.63	320.48N	22.11E	9.69	320.13	2234710.11	181926.49
4223.00	59.60	358.700	4105.61	347.60N	21.56E	10.34	347.24	2234709.57	181953.60
4254.00	63.00	358.100	4120.49	374.77N	20.80E	11.10	374.43	2234708.80	181980.78
4286.00	66.40	357.400	4134.16	403.68N	19.67E	10.81	403.35	2234707.67	182009.69
4318.00	69.30	356.700	4146.23	433.27N	18.14E	9.29	432.96	2234706.14	182039.28
4349.00	72.30	356.500	4156.42	462.49N	16.40E	9.70	462.20	2234704.40	182068.50
4381.00	75.50	357.000	4165.29	493.19N	14.66E	10.11	492.92	2234702.66	182099.20
4413.00	78.50	357.500	4172.49	524.33N	13.17E	9.50	524.08	2234701.17	182130.34
4444.00	79.90	357.600	4178.30	554.75N	11.86E	4.53	554.51	2234699.86	182160.76
4476.00	82.20	357.900	4183.28	586.33N	10.62E	7.25	586.11	2234698.62	182192.34
4508.00	84.70	357.900	4186.93	618.10N	9.46E	7.81	617.89	2234697.46	182224.11
4539.00	86.50	357.900	4189.31	648.99N	8.33E	5.81	648.79	2234696.33	182255.00
4571.00	87.70	358.100	4190.93	680.92N	7.21E	3.80	680.75	2234695.21	182286.94
4602.00	88.80	358.400	4191.87	711.90N	6.26E	3.68	711.73	2234694.26	182317.91
4634.00	89.00	358.500	4192.49	743.88N	5.40E	0.70	743.72	2234693.40	182349.89
4666.00	89.20	358.300	4192.99	775.86N	4.51E	0.88	775.71	2234692.51	182381.88
4697.00	89.50	358.300	4193.34	806.85N	3.59E	0.97	806.71	2234691.59	182412.86
4729.00	89.80	358.100	4193.54	838.83N	2.58E	1.13	838.70	2234690.58	182444.85
4760.00	90.00	357.900	4193.59	869.81N	1.50E	0.91	869.69	2234689.50	182475.83
4792.00	88.60	358.300	4193.98	901.79N	0.44E	4.55	901.69	2234688.44	182507.81
4824.00	88.30	358.100	4194.85	933.76N	0.57W	1.13	933.67	2234687.43	182539.78
4855.00	88.30	358.300	4195.77	964.73N	1.54W	0.64	964.65	2234686.46	182570.75
4877.00	88.70	358.500	4196.34	986.72N	2.15W	2.03	986.64	2234685.85	182592.74
4982.00	89.70	358.400	4197.81	1091.67N	4.99W	0.96	1091.62	2234683.01	182697.69
5077.00	91.80	358.400	4196.57	1186.62N	7.65W	2.21	1186.60	2234680.35	182792.64
5171.00	92.00	358.200	4193.45	1280.52N	10.43W	0.30	1280.54	2234677.57	182886.55
5266.00	92.80	358.300	4189.47	1375.39N	13.33W	0.85	1375.44	2234674.67	182981.42
5361.00	92.10	358.800	4185.41	1470.28N	15.73W	0.91	1470.35	2234672.27	183076.31
5456.00	92.10	358.300	4181.93	1565.18N	18.14W	0.53	1565.28	2234669.86	183171.21
5551.00	92.10	358.100	4178.45	1660.07N	21.12W	0.21	1660.20	2234666.88	183266.10
5646.00	90.90	358.700	4175.96	1755.00N	23.77W	1.41	1755.16	2234664.23	183361.03
5741.00	91.40	358.700	4174.05	1849.96N	25.92W	0.53	1850.14	2234662.07	183455.99
5833.00	89.90	358.200	4173.01	1941.91N	28.41W	1.72	1942.12	2234659.59	183547.95
5925.00	89.80	358.300	4173.25	2033.87N	31.22W	0.15	2034.11	2234656.78	183639.91
6016.00	89.70	358.700	4173.65	2124.84N	33.60W	0.45	2125.10	2234654.39	183730.88
6108.00	90.20	359.400	4173.73	2216.82N	35.13W	0.94	2217.10	2234652.87	183822.87
6200.00	88.90	359.100	4174.45	2308.81N	36.33W	1.45	2309.10	2234651.67	183914.86
6291.00	89.50	359.100	4175.72	2399.79N	37.76W	0.66	2400.09	2234650.24	184005.84

All data is in Feet unless otherwise stated
Coordinates are from Slot MD's are from Slot and TVD's are from Slot (Donna 3304 1-24H 0.00ft above Mean Sea Level)
Vertical Section is from 0.00N 0.00E on azimuth 359.160 degrees
Bottom hole distance is 5038.61 Feet on azimuth 359.08 degrees from Wellhead
Calculation method uses Minimum Curvature method
Prepared by
Date Printed: 17-Jun-2013



Standard Wellpath Report
 Sandridge
 Sec 24 - 33S - 4W, Kansas
 Sumner County
 Wellbore: Donna 3304 1-24H (Actual)

Wellpath (Grid) Report

MD[ft]	Inc[deg]	Azi[deg]	TVD[ft]	North[ft]	East[ft]	Dogleg [deg/100ft]	Vertical Section[ft]	Easting	Northing
6383.00	91.10	359.400	4175.24	2491.78N	38.97W	1.77	2492.08	2234649.03	184097.83
6474.00	91.70	359.100	4173.02	2582.74N	40.16W	0.74	2583.05	2234647.84	184188.80
6566.00	90.80	359.200	4171.01	2674.71N	41.52W	0.98	2675.03	2234646.48	184280.76
6658.00	90.60	359.200	4169.89	2766.69N	42.81W	0.22	2767.02	2234645.19	184372.75
6750.00	91.90	359.300	4167.88	2858.66N	44.01W	1.42	2859.00	2234643.99	184464.72
6842.00	92.40	359.300	4164.43	2950.59N	45.13W	0.54	2950.94	2234642.86	184556.65
6933.00	90.20	358.200	4162.36	3041.54N	47.12W	2.70	3041.90	2234640.88	184647.60
7025.00	90.00	358.200	4162.20	3133.49N	50.01W	0.22	3133.89	2234637.99	184739.56
7117.00	90.20	359.900	4162.04	3225.48N	51.53W	1.86	3225.89	2234636.46	184831.54
7209.00	90.20	0.300	4161.72	3317.48N	51.37W	0.43	3317.87	2234636.63	184923.54
7300.00	91.50	0.700	4160.37	3408.46N	50.58W	1.49	3408.84	2234637.42	185014.53
7391.00	91.50	358.400	4157.99	3499.42N	51.29W	2.53	3499.80	2234636.70	185105.49
7483.00	91.40	358.100	4155.66	3591.35N	54.10W	0.34	3591.75	2234633.90	185197.42
7578.00	90.40	358.200	4154.17	3686.29N	57.17W	1.06	3686.73	2234630.83	185292.36
7673.00	89.40	358.800	4154.33	3781.25N	59.66W	1.23	3781.72	2234628.34	185387.33
7768.00	90.70	359.400	4154.25	3876.24N	61.15W	1.51	3876.72	2234626.85	185482.31
7863.00	89.90	359.300	4153.75	3971.23N	62.23W	0.85	3971.71	2234625.77	185577.31
7958.00	89.90	358.900	4153.92	4066.22N	63.72W	0.42	4066.71	2234624.28	185672.30
8053.00	90.50	358.900	4153.59	4161.20N	65.54W	0.63	4161.71	2234622.46	185767.28
8148.00	90.70	359.000	4152.59	4256.18N	67.28W	0.24	4256.71	2234620.72	185862.26
8243.00	90.90	358.400	4151.27	4351.14N	69.44W	0.67	4351.69	2234618.56	185957.23
8338.00	90.50	359.700	4150.11	4446.12N	71.01W	1.43	4446.68	2234616.99	186052.21
8433.00	91.20	359.500	4148.70	4541.11N	71.68W	0.77	4541.67	2234616.32	186147.20
8528.00	91.20	359.100	4146.71	4636.08N	72.84W	0.42	4636.65	2234615.16	186242.17
8623.00	90.20	359.300	4145.55	4731.06N	74.16W	1.07	4731.64	2234613.84	186337.16
8718.00	89.40	358.800	4145.88	4826.05N	75.74W	0.99	4826.64	2234612.26	186432.14
8811.00	91.30	358.500	4144.88	4988.99N	79.58W	1.18	4989.62	2234608.42	186595.09
8930.00	91.30	358.500	4143.77	5037.96N	80.86W	==>	5038.60	2234607.14	186644.06

All data is in Feet unless otherwise stated
 Coordinates are from Slot MD's are from Slot and TVD's are from Slot (Donna 3304 1-24H 0.00ft above Mean Sea Level)
 Vertical Section is from 0.00N 0.00E on azimuth 359.160 degrees
 Bottom hole distance is 5038.61 Feet on azimuth 359.08 degrees from Wellhead
 Calculation method uses Minimum Curvature method
 Prepared by
 Date Printed: 17-Jun-2013



Standard Wellpath Report
Sandridge
Sec 24 - 33S - 4W, Kansas
Sumner County
Wellbore: Donna 3304 1-24H (Actual)

Comments

MD[ft]	TVD[ft]	North[ft]	East[ft]	Comment
8930.00	4143.77	5037.96N	80.86W	Projection to bit @ TD

All data is in Feet unless otherwise stated
Coordinates are from Slot MD's are from Slot and TVD's are from Slot (Donna 3304 1-24H 0.00ft above Mean Sea Level)
Vertical Section is from 0.00N 0.00E on azimuth 359.160 degrees
Bottom hole distance is 5038.61 Feet on azimuth 359.08 degrees from Wellhead
Calculation method uses Minimum Curvature method
Prepared by
Date Printed: 17-Jun-2013

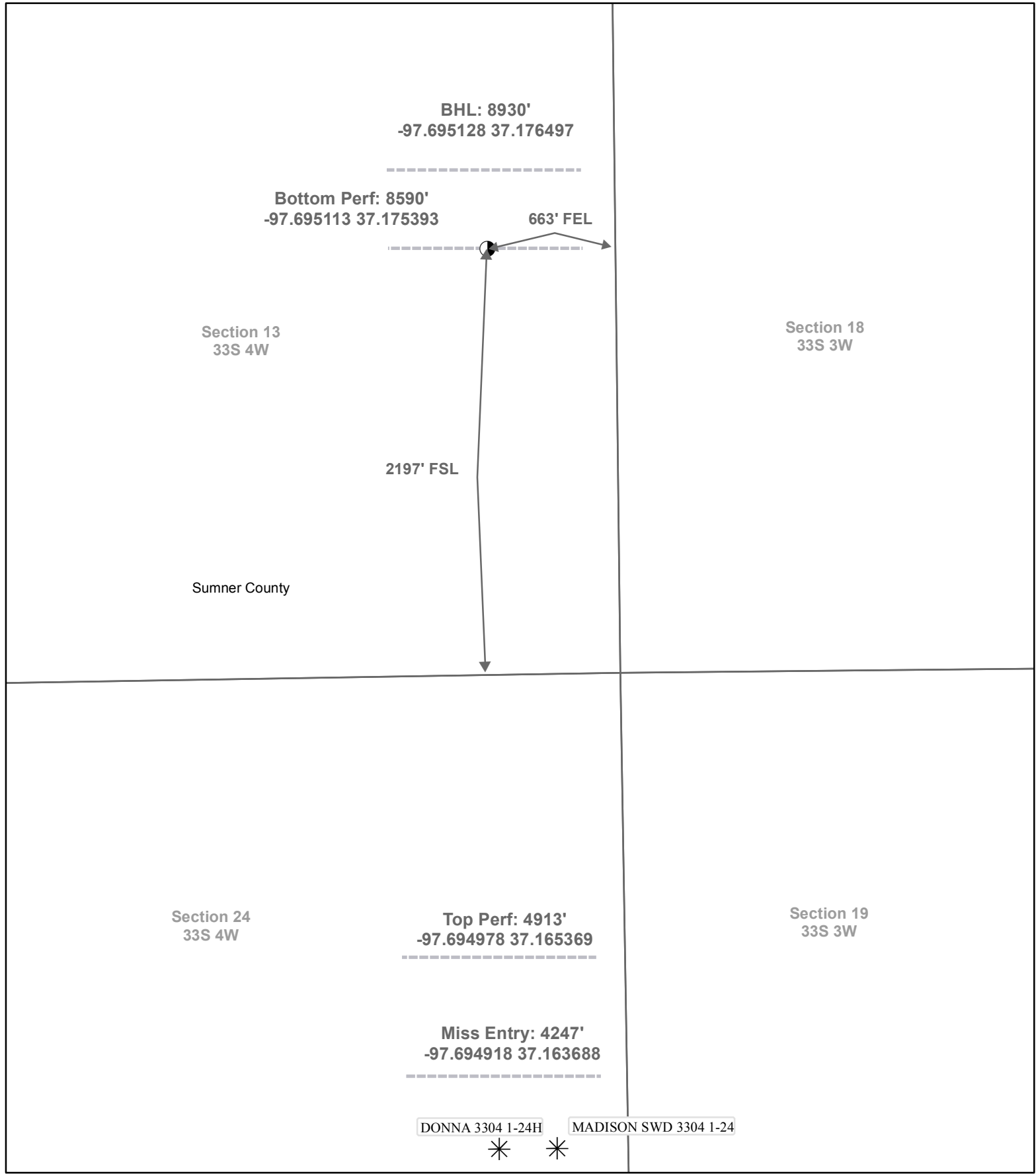

Actual Bottom-Hole Location of Yarnell 3204 1-25H
Summer County, Kansas
T&R: 33S 4W
Section: 13, 663' FEL & 2197' FSL
-97.695128 37.176497

1 in = 653 ft

0 500 1,000 2,000 Feet

Draftsman: Aaron Birk	Draft Date: 9/20/2013
Drawing Name/Number: Addendum_Donna 3304 1-24H.mxd	
Coordinate System: NAD 1927 State Plane Kansas South FIPS: 1502	



● Actual BH Location

* SandRidge Wells

--- Perf

□ Sections

