

Proposed Plan of Construction

Watson D-1
Sec 22 T30S-R32W
Haskell County, KS

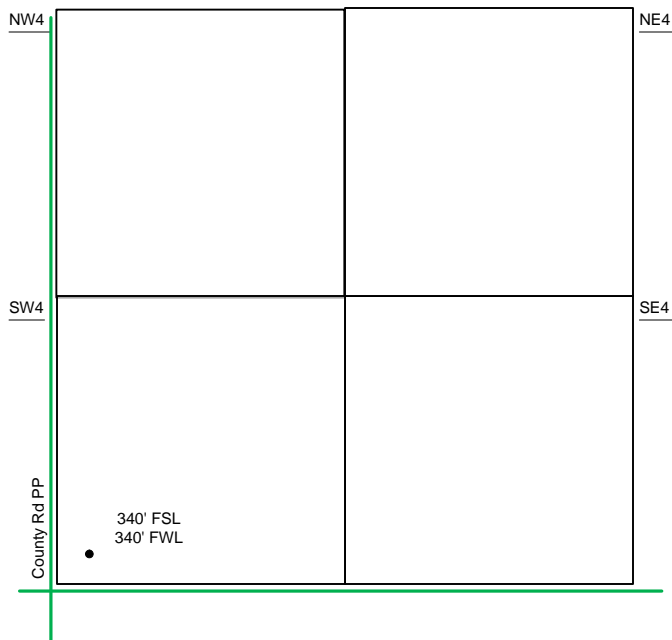

Sec 22 - T30S - R32W

SW/4

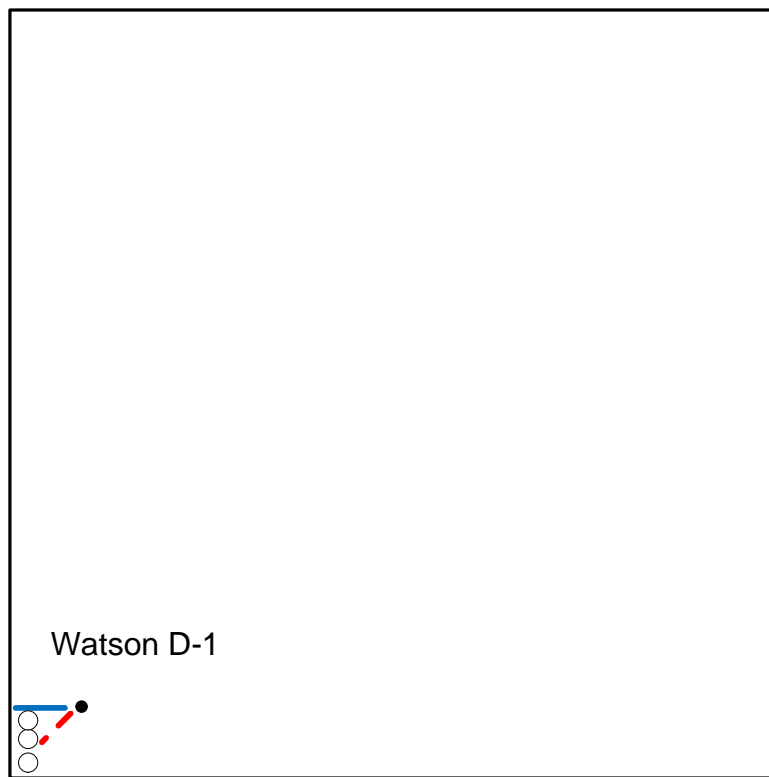

The Proposed Tank Battery for the Watson D-1 is located in the SW of the SW quarter.

- Well Location
- Proposed Lease Roads
- - - Proposed Pipeline
- Proposed Tank Battery
- Proposed Power Lines
- - - Existing Pipeline

Proposed Details of
SW/4 Sec 22 -T30S -R32W

Note-Drawing **Not** to Scale

Proposed Site Diagram
Watson D-1
June 5, 2013

