

1153218

For KCC Use ONLY

API # 15 - _____

IN ALL CASES PLOT THE INTENDED WELL ON THE PLAT BELOW

In all cases, please fully complete this side of the form. Include items 1 through 5 at the bottom of this page.

Operator: _____

Lease: _____

Well Number: _____

Field: _____

Number of Acres attributable to well: _____

QTR/QTR/QTR/QTR of acreage: _____ - _____ - _____ - _____

Location of Well: County: _____

_____ feet from N / S Line of Section

_____ feet from E / W Line of Section

Sec. _____ Twp. _____ S. R. _____ E W

Is Section: Regular or Irregular

If Section is Irregular, locate well from nearest corner boundary.

Section corner used: NE NW SE SW

PLAT

Show location of the well. Show footage to the nearest lease or unit boundary line. Show the predicted locations of lease roads, tank batteries, pipelines and electrical lines, as required by the Kansas Surface Owner Notice Act (House Bill 2032).

You may attach a separate plat if desired.

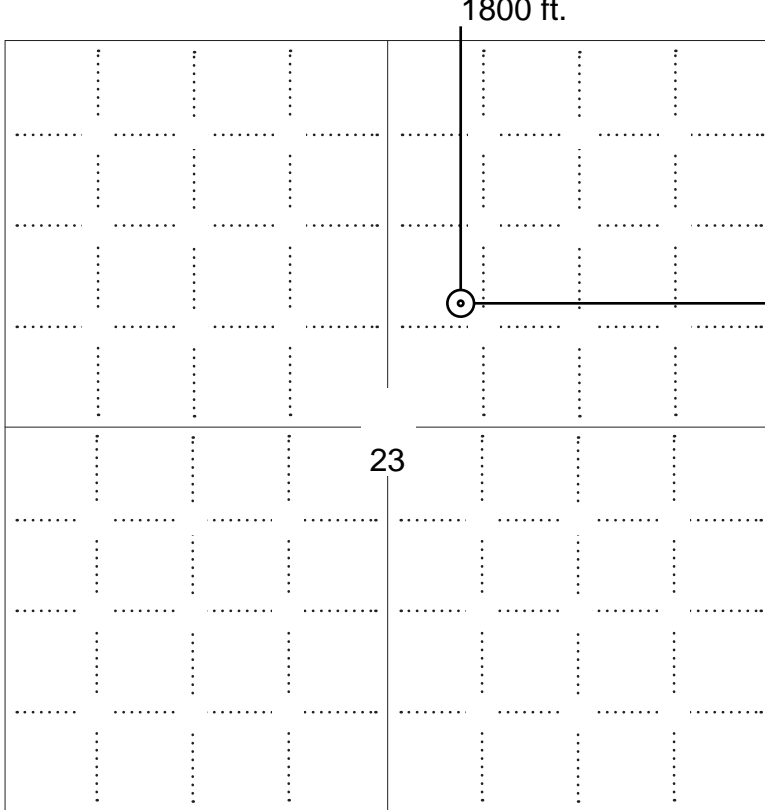

LEGEND

- Well Location
- Tank Battery Location
- Pipeline Location
- Electric Line Location
- Lease Road Location



NOTE: In all cases locate the spot of the proposed drilling locaton.

In plotting the proposed location of the well, you must show:

1. The manner in which you are using the depicted plat by identifying section lines, i.e. 1 section, 1 section with 8 surrounding sections, 4 sections, etc.
2. The distance of the proposed drilling location from the south / north and east / west outside section lines.
3. The distance to the nearest lease or unit boundary line (in footage).
4. If proposed location is located within a prorated or spaced field a certificate of acreage attribution plat must be attached: (C0-7 for oil wells; CG-8 for gas wells).
5. The predicted locations of lease roads, tank batteries, pipelines, and electrical lines.

APPLICATION FOR SURFACE PIT

Submit in Duplicate

Operator Name: _____		License Number: _____	
Operator Address: _____			
Contact Person: _____		Phone Number: _____	
Lease Name & Well No.: _____		Pit Location (QQQQ): _____-_____-_____-_____	
Type of Pit: <input type="checkbox"/> Emergency Pit <input type="checkbox"/> Burn Pit <input type="checkbox"/> Settling Pit <input type="checkbox"/> Drilling Pit <input type="checkbox"/> Workover Pit <input type="checkbox"/> Haul-Off Pit <i>(If WP Supply API No. or Year Drilled)</i>		Pit is: <input type="checkbox"/> Proposed <input type="checkbox"/> Existing If Existing, date constructed: _____ Pit capacity: _____ (bbls)	
Is the pit located in a Sensitive Ground Water Area? <input type="checkbox"/> Yes <input type="checkbox"/> No		Chloride concentration: _____ mg/l <i>(For Emergency Pits and Settling Pits only)</i>	
Is the bottom below ground level? <input type="checkbox"/> Yes <input type="checkbox"/> No		Artificial Liner? <input type="checkbox"/> Yes <input type="checkbox"/> No	
How is the pit lined if a plastic liner is not used? _____			
Pit dimensions (all but working pits): _____ Length (feet) _____ Width (feet) <input type="checkbox"/> N/A: Steel Pits Depth from ground level to deepest point: _____ (feet) <input type="checkbox"/> No Pit			
If the pit is lined give a brief description of the liner material, thickness and installation procedure.		Describe procedures for periodic maintenance and determining liner integrity, including any special monitoring.	
Distance to nearest water well within one-mile of pit: _____ feet Depth of water well _____ feet		Depth to shallowest fresh water _____ feet. Source of information: <input type="checkbox"/> measured <input type="checkbox"/> well owner <input type="checkbox"/> electric log <input type="checkbox"/> KDWR	
Emergency, Settling and Burn Pits ONLY: Producing Formation: _____ Number of producing wells on lease: _____ Barrels of fluid produced daily: _____ Does the slope from the tank battery allow all spilled fluids to flow into the pit? <input type="checkbox"/> Yes <input type="checkbox"/> No		Drilling, Workover and Haul-Off Pits ONLY: Type of material utilized in drilling/workover: _____ Number of working pits to be utilized: _____ Abandonment procedure: _____ _____ Drill pits must be closed within 365 days of spud date.	
Submitted Electronically			

KCC OFFICE USE ONLY			
<input type="checkbox"/> Liner <input type="checkbox"/> Steel Pit <input type="checkbox"/> RFAC <input type="checkbox"/> RFAS			
Date Received: _____ Permit Number: _____ Permit Date: _____ Lease Inspection: <input type="checkbox"/> Yes <input type="checkbox"/> No			



Form Must Be Typed
Form must be Signed
All blanks must be Filled

CERTIFICATION OF COMPLIANCE WITH THE KANSAS SURFACE OWNER NOTIFICATION ACT

This form must be submitted with all Forms C-1 (Notice of Intent to Drill); CB-1 (Cathodic Protection Borehole Intent); T-1 (Request for Change of Operator Transfer of Injection or Surface Pit Permit); and CP-1 (Well Plugging Application). Any such form submitted without an accompanying Form KSONA-1 will be returned.

Select the corresponding form being filed: C-1 (Intent) CB-1 (Cathodic Protection Borehole Intent) T-1 (Transfer) CP-1 (Plugging Application)

OPERATOR: License # _____
Name: _____
Address 1: _____
Address 2: _____
City: _____ State: _____ Zip: _____ + _____
Contact Person: _____
Phone: (_____) _____ Fax: (_____) _____
Email Address: _____

Well Location:
____ - ____ - ____ - ____ Sec. ____ Twp. ____ S. R. ____ East West
County: _____
Lease Name: _____ Well #: _____

If filing a Form T-1 for multiple wells on a lease, enter the legal description of the lease below:

Surface Owner Information:

Name: _____
Address 1: _____
Address 2: _____
City: _____ State: _____ Zip: _____ + _____

When filing a Form T-1 involving multiple surface owners, attach an additional sheet listing all of the information to the left for each surface owner. Surface owner information can be found in the records of the register of deeds for the county, and in the real estate property tax records of the county treasurer.

If this form is being submitted with a Form C-1 (Intent) or CB-1 (Cathodic Protection Borehole Intent), you must supply the surface owners and the KCC with a plat showing the predicted locations of lease roads, tank batteries, pipelines, and electrical lines. The locations shown on the plat are preliminary non-binding estimates. The locations may be entered on the Form C-1 plat, Form CB-1 plat, or a separate plat may be submitted.

Select one of the following:

- I certify that, pursuant to the Kansas Surface Owner Notice Act (House Bill 2032), I have provided the following to the surface owner(s) of the land upon which the subject well is or will be located: 1) a copy of the Form C-1, Form CB-1, Form T-1, or Form CP-1 that I am filing in connection with this form; 2) if the form being filed is a Form C-1 or Form CB-1, the plat(s) required by this form; and 3) my operator name, address, phone number, fax, and email address.

- I have not provided this information to the surface owner(s). I acknowledge that, because I have not provided this information, the KCC will be required to send this information to the surface owner(s). To mitigate the additional cost of the KCC performing this task, I acknowledge that I am being charged a \$30.00 handling fee, payable to the KCC, which is enclosed with this form.

If choosing the second option, submit payment of the \$30.00 handling fee with this form. If the fee is not received with this form, the KSONA-1 form and the associated Form C-1, Form CB-1, Form T-1, or Form CP-1 will be returned.

I Submitted Electronically

For KCC Use ONLY

API # 15 - _____

IN ALL CASES PLOT THE INTENDED WELL ON THE PLAT BELOW

In all cases, please fully complete this side of the form. Include items 1 through 5 at the bottom of this page.

Operator: SLAWSON
 Lease: JAMES AY
 Well Number: 3
 Field: WILDCAT

Location of Well: County: THOMAS
 _____ feet from N / S Line of Section
 _____ 2146 feet from E / W Line of Section
 Sec. 23 Twp. 10 S. R. 34 E W

Number of Acres attributable to well: _____
 QTR/QTR/QTR/QTR of acreage: _____ - NW - SW - NE

Is Section: Regular or Irregular

If Section is Irregular, locate well from nearest corner boundary.

Section corner used: NE NW SE SW

PLAT

Show location of the well. Show footage to the nearest lease or unit boundary line. Show the predicted locations of lease roads, tank batteries, pipelines and electrical lines, as required by the Kansas Surface Owner Notice Act (House Bill 2032). You may attach a separate plat if desired.

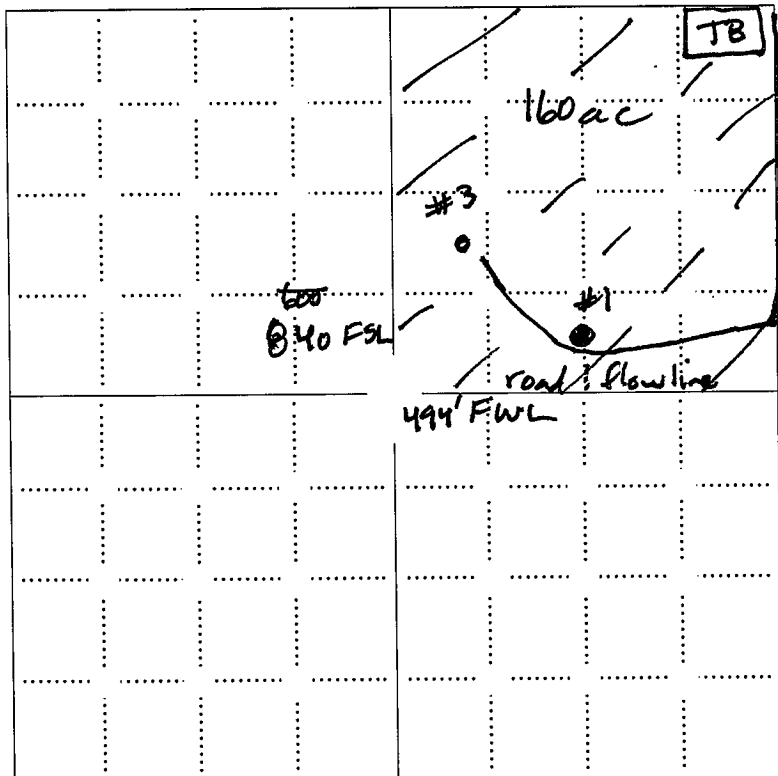

LEGEND

- Well Location
- Tank Battery Location
- Pipeline Location
- Electric Line Location
- Lease Road Location

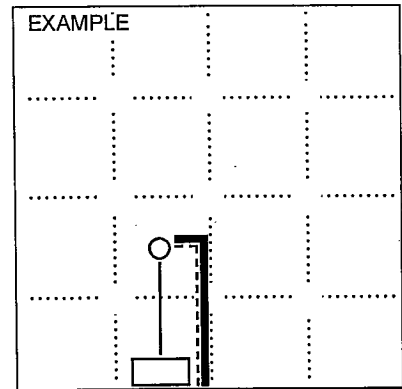

NOTE: In all cases locate the spot of the proposed drilling location.

In plotting the proposed location of the well, you must show:

1. The manner in which you are using the depicted plat by identifying section lines, i.e. 1 section, 1 section with 8 surrounding sections, 4 sections, etc.
2. The distance of the proposed drilling location from the south / north and east / west outside section lines.
3. The distance to the nearest lease or unit boundary line (in footage).
4. If proposed location is located within a prorated or spaced field a certificate of acreage attribution plat must be attached: (CO-7 for oil wells; CG-8 for gas wells).
5. The predicted locations of lease roads, tank batteries, pipelines, and electrical lines.

DECLARATION OF UNITIZATION

STATE OF KANSAS)
)
COUNTY OF THOMAS)

KNOW ALL MEN BY THESE PRESENTS:

WHEREAS, the undersigned (hereafter the "Lessee") is the owner and holder of record of the oil, gas and mineral leases described on Exhibit "A" attached hereto covering land situated in Thomas County, State of Kansas, each of which leases provides that the Lessee, at its option, shall have the right and power to pool or combine the land covered by said lease, or any portion thereof, as to oil leasehold estates (including casinghead gas produced from oil wells), with any other land, lease or leases when in lessee's judgment it is necessary or advisable to do so in order to properly develop and operate said premises, such pooling to be into a unit or units not exceeding 40 acres for oil; and,

WHEREAS, it is the judgement and considered opinion of the parties signatory hereto that the portions of said leases on Exhibit "A" hereto, and specific lands hereafter described, should be pooled, unitized, consolidated and combined, so as to form and establish the consolidated oil leasehold estate hereinafter described, in order to properly develop and operate the land and premises included in said oil leasehold estate for oil purposes.

NOW, THEREFORE, in consideration of the premises, the Lessee does hereby pool, unitize, consolidate and combine portions of the leasehold and oil mineral interest hereafter described so as to form and establish a consolidated oil leasehold estate comprised of the South Half of the Southeast Quarter of the Southeast Quarter (S/2 SE/4 SE/4) of Section 23, Township 10 South, Range 34 West, and the North Half of the Northeast Quarter of the Northeast Quarter (N/2 NE/4 NE/4) of Section 26, Township 10 South, Range 34 West, Thomas County, State of Kansas, and containing 40 acres, more or less, in order that the same may be operated and developed for oil, constituent elements, and associated and non-associated condensate (including casinghead gas produced from oil wells) in the same manner and to the same extent as though said lands were subject to a single oil lease.

By execution of this Declaration of Unitization, Lessee does not exhaust its right to pool, unitize or consolidate the leases and lands hereinabove described with other leases and lands as to any other horizon or strata covered hereby, and Lessee expressly reserves to itself, and to its assignees, and successors in interest, the right and power and authority to pool, unitize or consolidate the above-described leases and lands with any other leases, lands, horizons or strata in the vicinity insofar as the power/right and authority to do so is granted in the subject leases and various agreements and so long as such power and authority is exercised in accordance with applicable rules and regulations of any governmental regulatory body or agency having jurisdiction.

The unit created hereby shall remain in force, insofar as it covers the lands covered hereby, until dissolved by written instruments duly executed and recorded by Lessee or its successors in interest. Lessee expressly reserves the right to amend this Declaration of Unitization at its discretion so long as such amendment does not violate the rules or regulations of any controlling governmental or regulatory body having jurisdiction of leases covering the pooled or unitized area.

The unitized area shall be developed and operated as an entirety with the understanding that all unitized substances produced therefrom shall be allocated among the leaseholds comprising the unitized area in the proportion that the net leasehold acreage contributed to the unitized area under each lease bears to the entire leasehold committed to this agreement.

IN WITNESS WHEREOF, this instrument is executed as of this 12th day of August 2013.

SLAWSON EXPLORATION COMPANY, INC.

STATE OF COLORADO)
) ss.
COUNTY OF DENVER)

By Coni J. Stokes
Coni J Stokes, Vice-President

This instrument was acknowledged before me on August 12, 2013, by Coni J. Stokes, as Vice-President, of Slawson Exploration Company, Inc., on behalf of said corporation.

My commission expires:

8/16/16

AJA EDICK
Notary Public

AJA EDICK
NOTARY PUBLIC
STATE OF COLORADO
NOTARY ID 20124051278
MY COMMISSION EXPIRES 08/16/2016

State: KS County: THOMAS

Exhibit A

PAGE 1

Lease#: KS 13213
Lease Date: 4/28/2006
Lessor: JAMES, JOHN V & JAYNE A, H/W ET AL
Lessee: SLAWSON EXPLORATION CO., INC.
Lands: TOWNSHIP 10 SOUTH, RANGE 34 WEST
SECTION 23: SE/4

Recording: 181 748

Lease#: KS 13220
Lease Date: 4/05/2007
Lessor: JAMES, JOHN V & JAYNE A, H/W ET AL
Lessee: SLAWSON EXPLORATION CO., INC.
Lands: TOWNSHIP 10 SOUTH, RANGE 34 WEST
SECTION 26: NE/4

Recording: 187 122
205 260