

API No. 15 - _____

Operator: F.G. Holl Company, L.L.C. _____

Lease: MCDONALD _____

Well Number: 1-19 _____

Field: Harrison _____

Number of Acres attributable to well: 10 _____

QTR / QTR / QTR of acreage: NW - NW - NE _____

Location of Well: County: Barton _____

380 feet from N / S Line of Section

2310 feet from E / W Line of Section

Sec. 19 Twp. 20 S. R. 13 East West

Is Section: Regular or Irregular

If Section is Irregular, locate well from nearest corner boundary.

Section corner used: NE NW SE SW

PLAT

(Show location of the well and shade attributable acreage for prorated or spaced wells.)

(Show footage to the nearest lease or unit boundary line.)

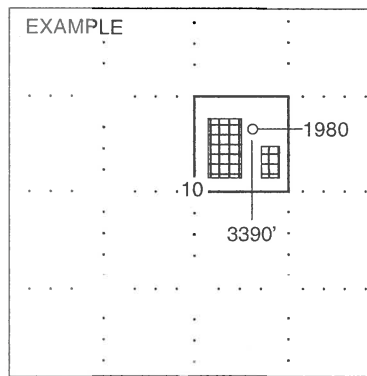
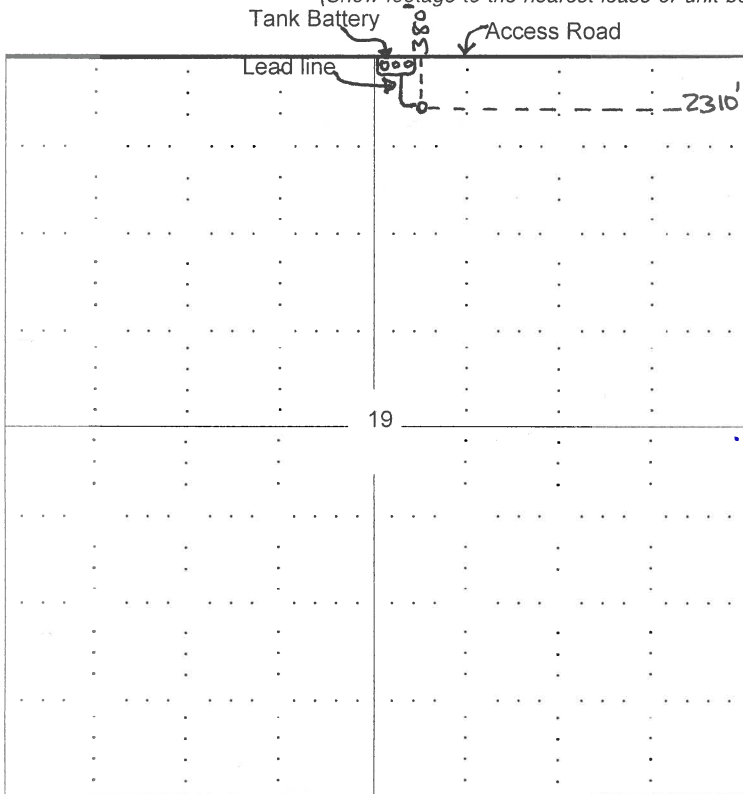

SEWARD CO.

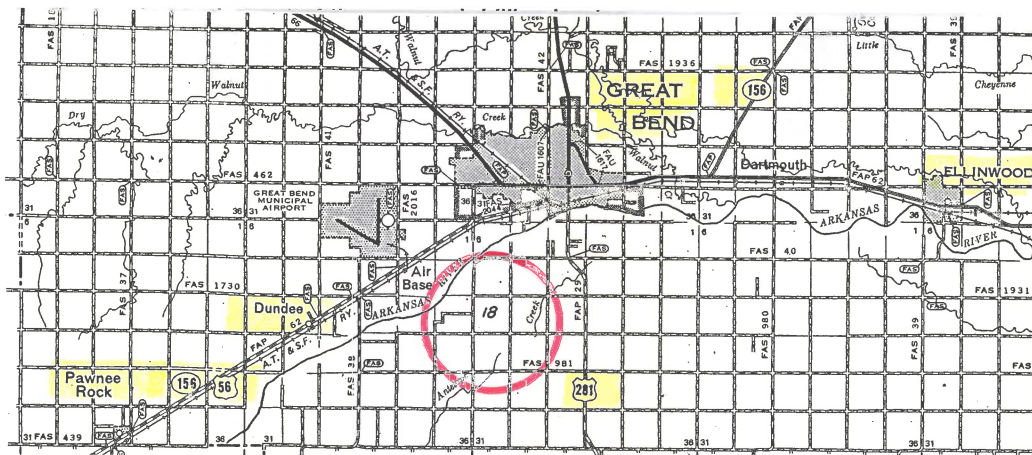

* Controlling data is based upon the best maps and photographs available to us and upon a regular section of land containing 640 acres.

* Approximate section lines were determined using the normal standard of care of oilfield surveyors practicing in the state of Kansas. The section corners, which establish the precise section lines, were not necessarily located, and the exact location of the drillsite location in the section is not guaranteed. Therefore, the operator securing this service and accepting this plat and all other parties relying thereon agree to hold Central Kansas Oilfield Services, Inc., its officers and employees harmless from all losses, costs and expenses and said entities released from any liability from incidental or consequential damages.

* Elevations derived from National Geodetic Vertical Datum.

Date March 28, 2006

CENTRAL KANSAS OILFIELD SERVICES, INC. (620)792-1977