

**VESS OIL CORPORATION
JOHANSEN LEASE
NW. 1/4, SECTION 34, T11S, R17W
ELLIS COUNTY, KANSAS**

Directions:

From the intersection of Highway 183 and Interstate 70 at the north edge of Hays, Kansas go 8.0 miles North on Highway 183, then go 7.0 miles East on a county road, then go 3.0 miles north to the NE. corner of Section 34, then go 0.67 miles West, then go 0.06 miles South to location.

Proposed Road + Power line ROAD

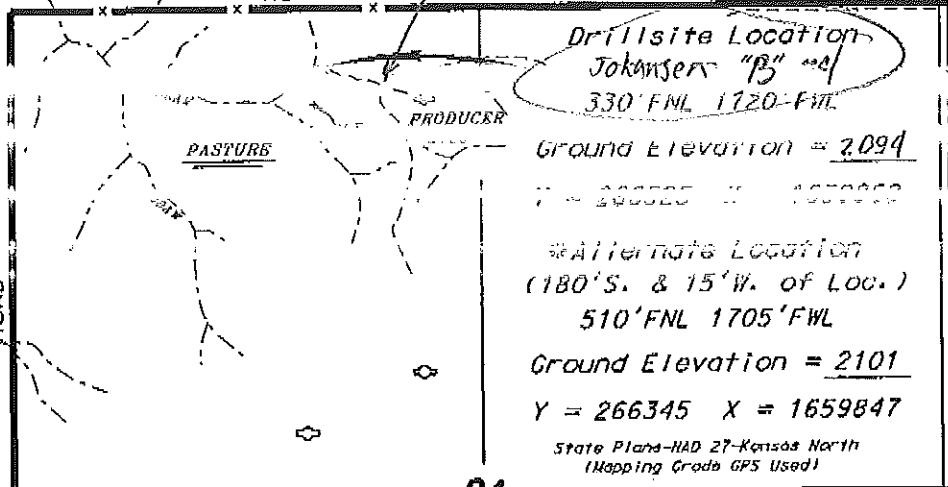

Drillsite Location
Johansen "B" well
330' FNL 1720' FWL

Ground Elevation = 2094

*Alternate Location
(180'S. & 15'W. of Loc.)
510' FNL 1705' FWL

Ground Elevation = 2101

Y = 266345 X = 1659847

State Plans-HAD 27-Kansas North
(Mapping Grade GPS Used)

1820TH AVE
ROAD

SCALE 1" = 100'
C.E.S.

*Ingress and egress to location as shown on this plot is per usage only and may not be legally opened for public use. Contact landowner, tenant and county road department for access.

Notes:

1. Set iron rod at location site.
2. All flagging Red & Yellow.
3. Overhead power available at E. line, Sec. 34.
4. Kansas One Call System Inc. should be notified before excavation (1-800-344-7233).
5. CAUTION: Various pipelines in Sec. 34.
6. Contact landowner for best access.
7. Location fell on the north slope of a draw, set alternate 180' south and 15' west.

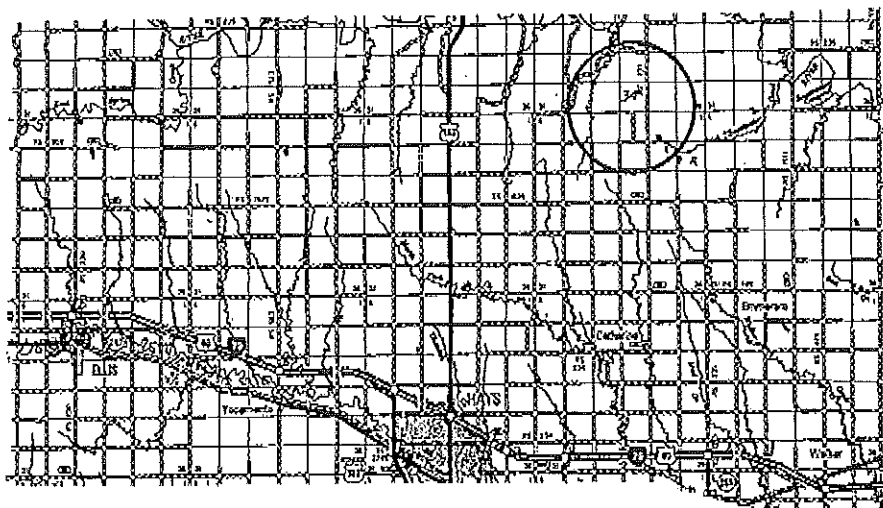

• Contouring data is based upon the best maps and photographs available to us and upon a regular section of land containing 640 acres.
 • Approximate section lines were determined using the normal standard of care of oilfield surveyors practicing in the state of Kansas. The section corners, which establish the precise section lines, were not necessarily located, and the exact location of the drillsite location in the section is not guaranteed. Therefore, the operator assuming this service and accepting this plot and all other parties relying thereon agree to hold Central Kansas Oilfield Services, Inc., its officers and employees harmless from all losses, costs and expenses and said liabilities released from any liability from incidental or consequential damages.
 • Elevations derived from National Geodetic Vertical Datum.

Date June 24, 2013