

Proposed Plan of Construction
 Stansifer A-1
 Sec 4 T27S-R33W
 Haskell County, KS

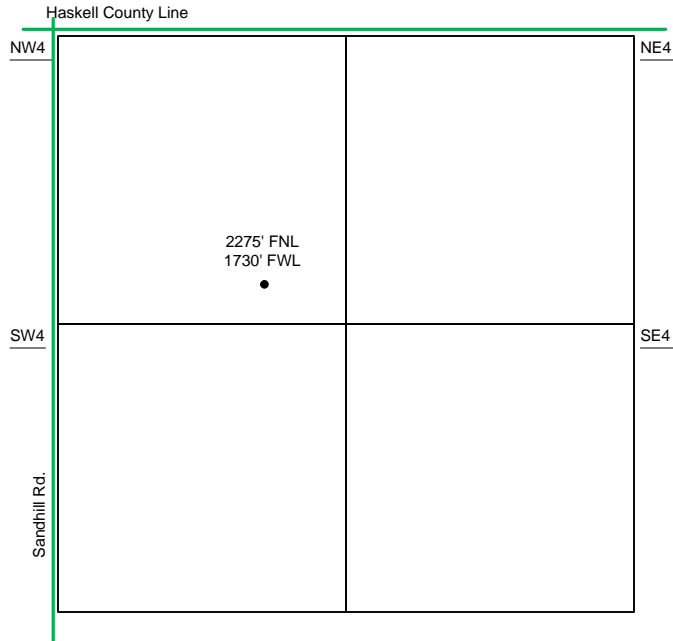

Sec 4 – T27S – R33W

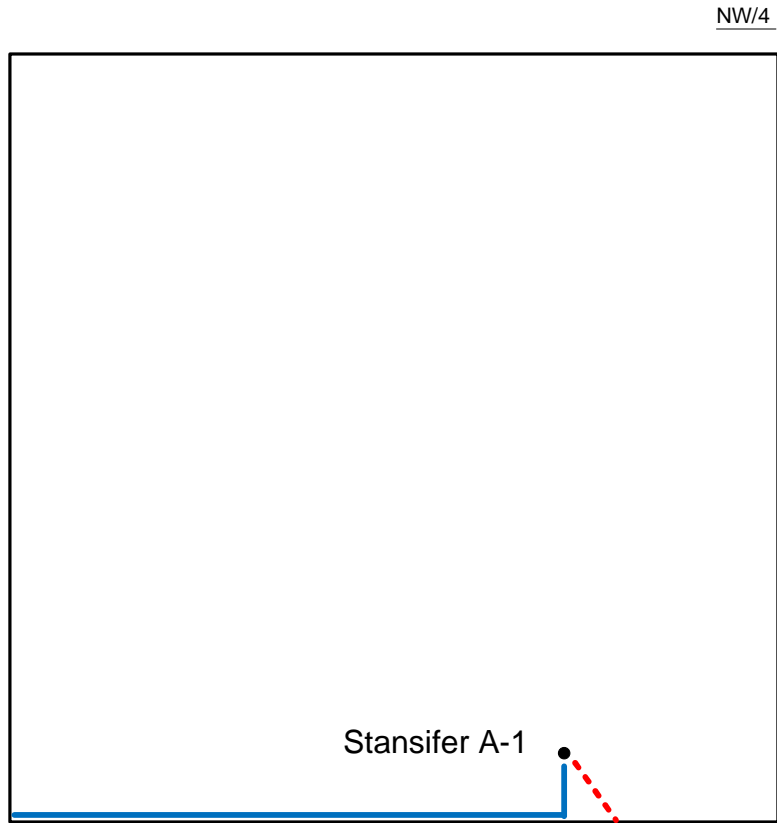

NW/4

- Well Location
- Proposed Lease Roads
- - - Proposed Pipeline
- Proposed Tank Battery
- Proposed Power Lines
- - - Existing Pipeline

The Tank Battery for the Stansifer A-1 is located in the South Central of the SE quarter.

Proposed Details of
NW/4 Sec 4 -T27S - R33W

Note-Drawing **Not** to Scale

Proposed Site Diagram
 Stansifer A-1
 July 17, 2013

