

Proposed Plan of Construction

Lyle Bryan #1
Sec 28 T23S-R37W
Kearney County, KS

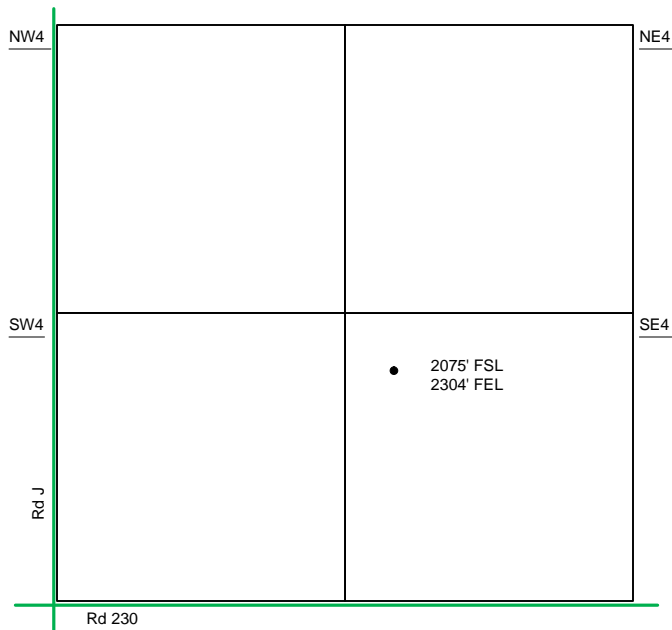

Sec 28 - T23S - R37W

The Proposed Tank Battery for the Lyle Bryan #1 is located in the NW of the SE quarter.

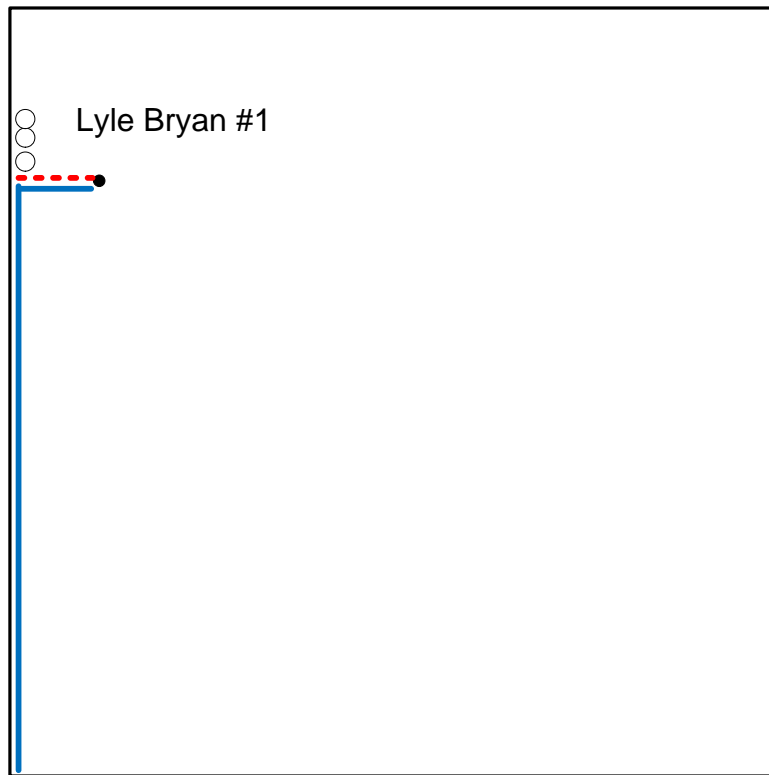

Proposed Details of
SE/4 Sec 28 - T23S - R37W

Note-Drawing **Not** to Scale

Proposed Site Diagram
Lyle Bryan #1
July 18, 2013

