

KANSAS SURFACE OWNER NOTIFICATION ACT

R 35 W

T  
17  
S

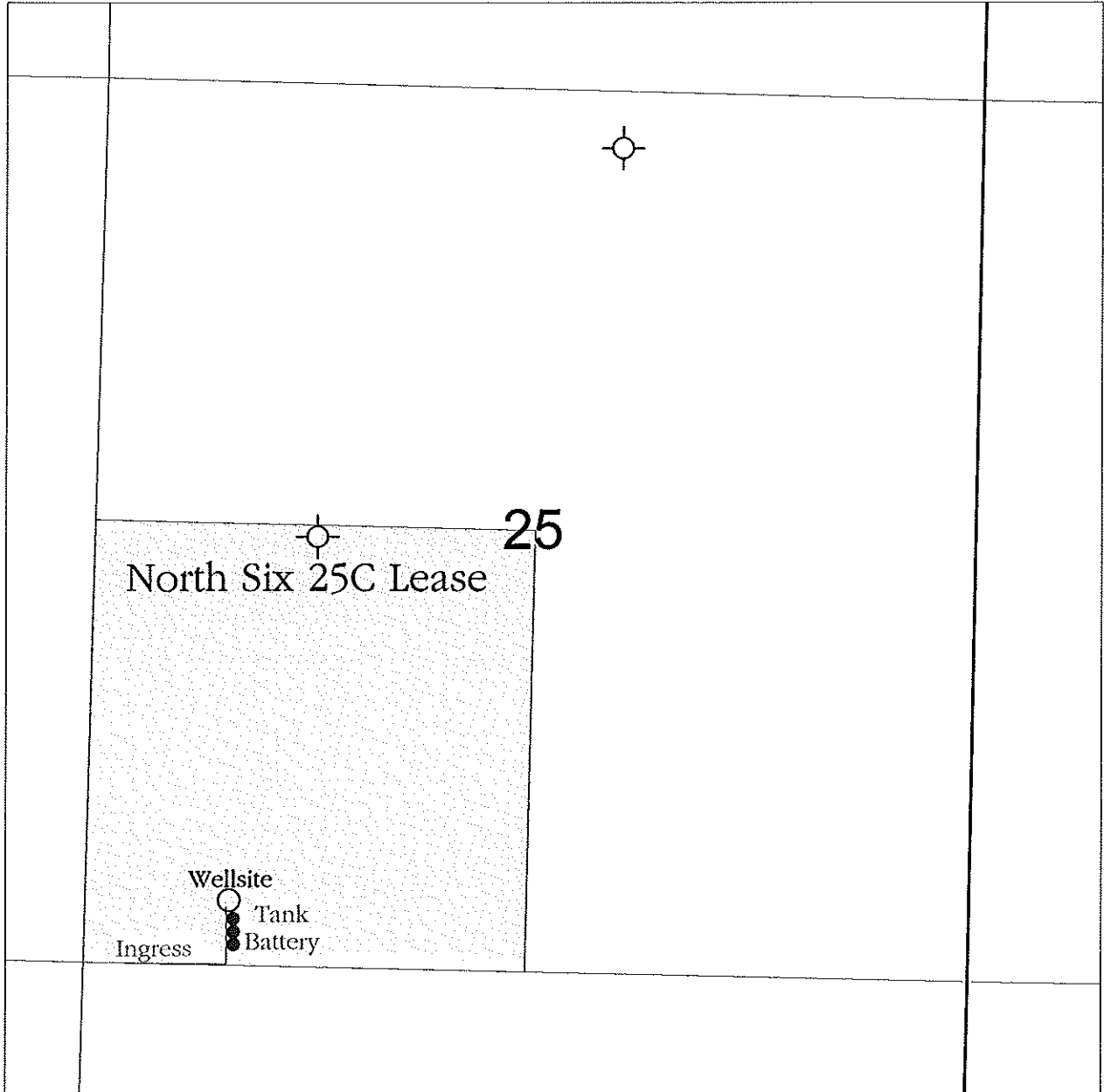

SCALE = 1 : 12,000      WICHITA COUNTY, KANSAS

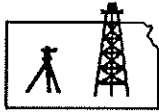

**Pro-Stake LLC**  
 Oil Field & Construction Site Staking  
 P.O. Box 2324  
 Garden City, Kansas 67846  
 Office/Fax: (620) 276-6159  
 Cell: (620) 272-1499

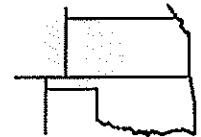

**241735bar**  
 PLAT NO.

**10992**  
 INVOICE NO.

**Ritchie Exploration, Inc.**

**#1 North Six 25C**

OPERATOR

LEASE NAME

**Wichita County, KS**

**25 17s 35w**  
 Sec. Twp. Rng.

**385' FSL - 865' FWL**

COUNTY

LOCATION SPOT

GR. ELEVATION: **3175.4'**

SCALE: **1" = 1000'**  
 DATE: **July 3<sup>rd</sup>, 2013**  
 MEASURED BY: **Luke R.**  
 DRAWN BY: **Drew H.**  
 AUTHORIZED BY: **Justin C.**



**Directions:** From approx. 0.25 mile South of Marienthal Ks at the intersection of Hwy 96 & 167 North - Now go 4.6 mile East on Hwy 96 - Now go 3 miles North on 25 Rd/County Line Rd - Now go 1 mile West on M Rd - Now go 1 mile North on 24 Rd to the SW corner of section 25-17s-35w - Now go 0.2 mile East on trail to ingress stake North - Now go 385' North through worked corn stubble into staked location.

**Final ingress must be verified with land owner or Operator.**

*This drawing does not constitute a monumented survey or a land survey plat.*

*This drawing is for construction purposes only.*

