

# Sandridge Energy

Jones 3506 1-13H (Final)  
 Jones 3506 1-13H SL 200 FSL 1320 FEL  
 Harper County, Kansas (Sandridge Energy) NAD27 / Grid

Foot reference w/ depth is Plan 1		Grid System: NAD27 / Lambert Kansas: SP, Southern Zone (1502), US feet	
True vertical depths are referenced to Unit 310 (RKB)		North Reference: Grid North	
Measured depths are referenced to Unit 310 (RKB)		Scale: True distance	
Unit 310 (RKB) to Mean Sea Level: 1258 feet		Depths are in feet	
Mean Sea Level to Mud line (M Slot: Jones 3506 1-13H SL 200 FSL 1320 FEL): -1240 feet		Created by: adamrc on 28 Jun 2013	
Coordinates are in feet referenced to Slot			
Location Information			
Facility Name	Grid East (US ft)	Grid North (US ft)	Latitude
Jones 3506 1-13H Sec. 13-35S-6W	2170665.000	1216000.000	36°59'56.947"N
Slot	Local N (ft)	Local E (ft)	Longitude
Jones 3506 1-13H SL 200 FSL 1320 FEL	0.00	0.00	97°54'56.339"W
Unit 310 (RKB) to Mud line (M Slot: Jones 3506 1-13H SL 200 FSL 1320 FEL)			
Mean Sea Level to Mud line (M Slot: Jones 3506 1-13H SL 200 FSL 1320 FEL)			
Unit 310 (RKB) to Mean Sea Level			

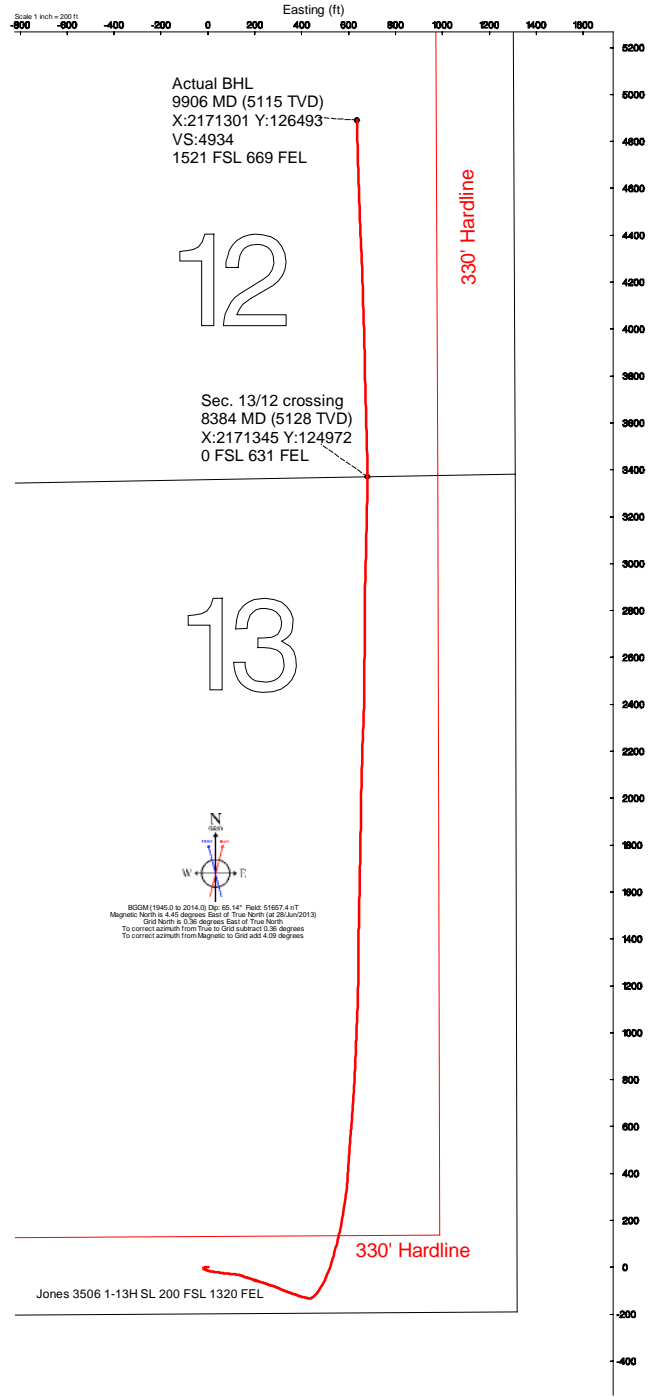

Vertical Section (ft)

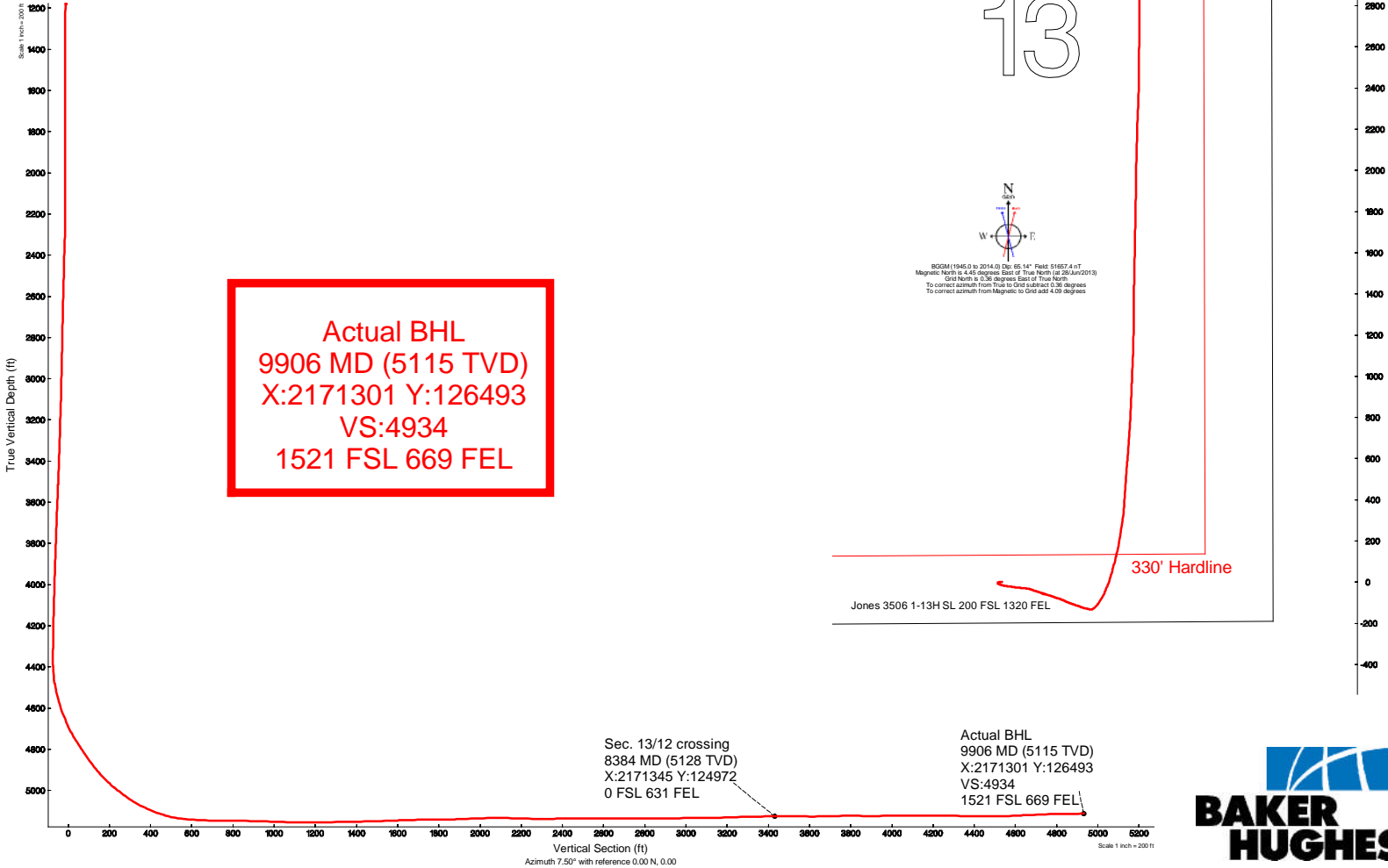



## Actual Wellpath Report

Sandridge Jones 3506 1-13H\_Final Surveys.  
Page n of nn



REFERENCE WELLPATH IDENTIFICATION			
Operator	Sandridge Energy	Slot	Jones 3506 1-13H SL 200 FSL 1320 FEL
Area	Kansas	Well	Subject
Field	Harper County, Kansas (Sandridge Energy) NAD27 / Grid	Wellbore	Jones 3506 1-13H Actual
Facility	Jones 3506 PAD Sec. 13-35S-6W		

REPORT SETUP INFORMATION			
Projection System	NAD27 / Lambert Kansas SP, Southern Zone (1502), US feet		
North Reference	Grid	Software System	WellArchitect™ 3.0.0
Convergence at slot	0.36° East	User	Adammic
Scale	1.00006	Report Generated	22/Jul/2013 at 2:04:18 PM
Wellbore last revised	06-28-2013	Database/Source file	intokcapp01

WELLPATH LOCATION						
	Local coordinates		Grid coordinates		Geographic coordinates	
	North[ft]	East[ft]	Easting[US ft]	Northing[US ft]	Latitude	Longitude
Slot Location	0.00	0.00	2170665.00	121600.00	36°59'56.947"N	97°54'56.339"W
Facility Reference Pt			2170665.00	121600.00	36°59'56.947"N	97°54'56.339"W
Field Reference Pt			2132248.82	161602.28	37°06'34.560"N	98°02'47.460"W

WELLPATH DATUM			
Calculation method	Minimum curvature	Unit 310 (RKB) to Facility Vertical Datum	18.00ft
Horizontal Reference Pt	Slot	Unit 310 (RKB) to Mean Sea Level	1258.00ft
Vertical Reference Pt	Unit 310 (RKB)	Unit 310 (RKB) to Mud Line at Slot (Jones 3506 1-13H SL 200 FSL 1320 FEL)	18.00ft
MD Reference Pt	Unit 310 (RKB)	Section Origin	N 0.00, E 0.00 ft
Field Vertical Reference	Mean Sea Level	Section Azimuth	7.50°



## Actual Wellpath Report

Sandridge Jones 3506 1-13H\_Final Surveys.  
Page n of nn



REFERENCE WELLPATH IDENTIFICATION			
Operator	Sandridge Energy	Slot	Jones 3506 1-13H SL 200 FSL 1320 FEL
Area	Kansas	Well	Subject
Field	Harper County, Kansas (Sandridge Energy) NAD27 / Grid	Wellbore	Jones 3506 1-13H Actual
Facility	Jones 3506 PAD Sec. 13-35S-6W		

WELLPATH DATA (152 stations) † = interpolated/extrapolated station										
MD [ft]	Inclination [°]	Azimuth [°]	TVD [ft]	Vert Sect [ft]	North [ft]	East [ft]	Grid East [US ft]	Grid North [US ft]	DLS [°/100ft]	Comments
0.00†	0.000	255.410	0.00	0.00	0.00	0.00	2170665.00	121600.00	0.00	
18.00	0.000	255.410	18.00	0.00	0.00	0.00	2170665.00	121600.00	0.00	
50.00	0.390	255.410	50.00	-0.04	-0.03	-0.11	2170664.89	121599.97	1.22	
100.00	0.900	257.780	100.00	-0.24	-0.15	-0.65	2170664.35	121599.85	1.02	
150.00	1.110	256.020	149.99	-0.55	-0.35	-1.51	2170663.49	121599.65	0.42	
200.00	1.250	257.010	199.98	-0.92	-0.59	-2.51	2170662.49	121599.41	0.28	
250.00	1.360	258.220	249.97	-1.30	-0.84	-3.62	2170661.38	121599.16	0.23	
300.00	1.560	259.520	299.95	-1.71	-1.08	-4.87	2170660.13	121598.92	0.41	
350.00	1.710	258.100	349.93	-2.17	-1.36	-6.27	2170658.73	121598.64	0.31	
400.00	2.050	258.670	399.90	-2.70	-1.69	-7.88	2170657.12	121598.31	0.68	
450.00	2.230	257.890	449.87	-3.32	-2.07	-9.71	2170655.29	121597.93	0.36	
500.00	2.340	258.280	499.83	-3.98	-2.48	-11.66	2170653.34	121597.52	0.22	
550.00	2.080	255.360	549.79	-4.66	-2.92	-13.53	2170651.47	121597.08	0.57	
600.00	1.160	244.530	599.77	-5.28	-3.36	-14.87	2170650.13	121596.64	1.93	
726.00	2.090	255.600	725.72	-6.83	-4.48	-18.25	2170646.75	121595.52	0.78	
818.00	0.760	223.290	817.69	-7.95	-5.35	-20.29	2170644.71	121594.65	1.63	
849.00	0.690	189.570	848.69	-8.30	-5.68	-20.46	2170644.54	121594.32	1.37	
880.00	0.900	152.320	879.68	-8.69	-6.08	-20.38	2170644.62	121593.92	1.76	
910.00	1.330	140.380	909.68	-9.11	-6.56	-20.05	2170644.95	121593.44	1.62	
941.00	1.730	138.020	940.67	-9.66	-7.18	-19.50	2170645.49	121592.82	1.31	
972.00	2.280	135.140	971.65	-10.34	-7.97	-18.76	2170646.24	121592.03	1.80	
1002.00	2.550	132.040	1001.62	-11.09	-8.84	-17.84	2170647.16	121591.16	1.00	
1033.00	3.250	129.130	1032.58	-11.94	-9.85	-16.65	2170648.35	121590.15	2.31	
1063.00	4.010	123.970	1062.52	-12.85	-10.97	-15.12	2170649.88	121589.03	2.75	
1094.00	4.710	118.560	1093.43	-13.79	-12.19	-13.10	2170651.90	121587.81	2.62	
1124.00	5.350	114.270	1123.31	-14.64	-13.35	-10.74	2170654.26	121586.65	2.47	
1185.00	6.330	108.270	1184.00	-16.09	-15.58	-4.96	2170660.04	121584.42	1.89	
1246.00	7.180	102.700	1244.57	-17.06	-17.47	1.96	2170666.96	121582.53	1.76	
1277.00	7.490	100.610	1275.32	-17.35	-18.27	5.83	2170670.83	121581.73	1.32	
1368.00	7.760	99.450	1365.52	-17.88	-20.37	17.72	2170682.72	121579.63	0.34	
1460.00	8.050	96.440	1456.64	-17.97	-22.11	30.25	2170695.25	121577.89	0.55	
1551.00	6.150	97.100	1546.94	-17.82	-23.43	41.42	2170706.42	121576.57	2.09	
1642.00	6.890	101.150	1637.35	-18.14	-25.08	51.61	2170716.61	121574.91	0.96	
1733.00	8.130	98.560	1727.57	-18.60	-27.10	63.33	2170728.33	121572.90	1.41	
1828.00	8.160	94.610	1821.61	-18.39	-28.64	76.69	2170741.70	121571.36	0.59	
1923.00	8.020	96.190	1915.67	-17.90	-29.90	90.00	2170755.01	121570.10	0.28	
2018.00	7.640	95.790	2009.78	-17.56	-31.25	102.87	2170767.88	121568.75	0.40	
2113.00	7.780	96.120	2103.92	-17.21	-32.57	115.55	2170780.56	121567.43	0.15	
2208.00	8.080	100.200	2198.01	-17.37	-34.44	128.51	2170793.52	121565.56	0.67	
2303.00	8.080	107.620	2292.07	-18.86	-37.64	141.45	2170806.46	121562.36	1.10	
2397.00	8.010	109.840	2385.15	-21.42	-41.86	153.90	2170818.91	121558.13	0.34	
2492.00	7.500	107.720	2479.28	-23.94	-46.00	166.04	2170831.05	121554.00	0.62	
2586.00	7.820	108.480	2572.44	-26.25	-49.89	177.95	2170842.96	121550.11	0.36	
2681.00	6.410	110.700	2666.71	-28.69	-53.81	189.04	2170854.05	121546.18	1.51	
2776.00	5.310	108.040	2761.21	-30.70	-57.05	198.18	2170863.19	121542.95	1.19	



## Actual Wellpath Report

Sandridge Jones 3506 1-13H\_Final Surveys.  
Page n of nn



REFERENCE WELLPATH IDENTIFICATION			
Operator	Sandridge Energy	Slot	Jones 3506 1-13H SL 200 FSL 1320 FEL
Area	Kansas	Well	Subject
Field	Harper County, Kansas (Sandridge Energy) NAD27 / Grid	Wellbore	Jones 3506 1-13H Actual
Facility	Jones 3506 PAD Sec. 13-35S-6W		

WELLPATH DATA (152 stations)										
MD [ft]	Inclination [°]	Azimuth [°]	TVD [ft]	Vert Sect [ft]	North [ft]	East [ft]	Grid East [US ft]	Grid North [US ft]	DLS [°/100ft]	Comments
2871.00	7.910	106.740	2855.57	-32.56	-60.30	208.62	2170873.63	121539.70	2.74	
2966.00	7.730	106.480	2949.69	-34.61	-63.99	221.01	2170886.02	121536.01	0.19	
3061.00	8.900	107.030	3043.69	-36.82	-67.96	234.16	2170899.17	121532.04	1.23	
3156.00	8.630	108.880	3137.58	-39.44	-72.41	247.93	2170912.94	121527.58	0.41	
3251.00	9.210	108.330	3231.43	-42.28	-77.11	261.89	2170926.91	121522.88	0.62	
3346.00	8.410	108.740	3325.31	-45.06	-81.73	275.69	2170940.70	121518.26	0.84	
3441.00	8.730	110.880	3419.25	-48.09	-86.54	289.00	2170954.02	121513.46	0.48	
3535.00	8.980	115.580	3512.13	-52.01	-92.25	302.28	2170967.30	121507.75	0.81	
3630.00	8.330	110.460	3606.05	-55.86	-97.85	315.42	2170980.44	121502.14	1.06	
3725.00	9.290	112.350	3699.92	-59.37	-103.17	328.96	2170993.98	121496.82	1.06	
3820.00	9.520	108.140	3793.65	-62.79	-108.54	343.52	2171008.54	121491.46	0.76	
3915.00	9.240	108.970	3887.38	-65.75	-113.46	358.19	2171023.22	121486.53	0.33	
4010.00	8.820	110.550	3981.20	-68.92	-118.50	372.23	2171037.25	121481.50	0.51	
4105.00	8.700	108.610	4075.09	-71.95	-123.35	385.86	2171050.88	121476.65	0.34	
4200.00	9.020	105.220	4168.96	-74.33	-127.59	399.85	2171064.88	121472.40	0.64	
4295.00	9.120	102.530	4262.77	-75.99	-131.18	414.39	2171079.41	121468.81	0.46	
4358.00	8.710	101.720	4325.01	-76.78	-133.24	423.93	2171088.96	121466.76	0.68	
4390.00	9.260	100.930	4356.62	-77.11	-134.22	428.83	2171093.86	121465.78	1.76	
4421.00	8.800	90.560	4387.24	-76.98	-134.71	433.65	2171098.68	121465.28	5.45	
4453.00	9.500	75.270	4418.83	-75.68	-134.06	438.65	2171103.68	121465.93	7.88	
4484.00	10.860	61.930	4449.35	-73.01	-132.04	443.71	2171108.73	121467.95	8.75	
4516.00	12.890	51.800	4480.67	-68.71	-128.41	449.17	2171114.20	121471.58	9.07	
4548.00	14.780	44.470	4511.74	-62.89	-123.29	454.84	2171119.87	121476.70	8.04	
4579.00	16.640	41.050	4541.58	-56.03	-117.12	460.52	2171125.55	121482.87	6.70	
4611.00	18.560	37.580	4572.08	-47.80	-109.63	466.64	2171131.67	121490.36	6.83	
4642.00	21.160	34.450	4601.24	-38.55	-101.10	472.81	2171137.84	121498.89	9.06	
4674.00	22.510	32.100	4630.94	-27.83	-91.15	479.34	2171144.37	121508.84	5.03	
4705.00	24.360	29.800	4659.38	-16.52	-80.58	485.67	2171150.70	121519.42	6.66	
4737.00	26.400	27.810	4688.29	-3.74	-68.56	492.27	2171157.30	121531.44	6.91	
4769.00	28.640	25.900	4716.67	10.21	-55.36	498.94	2171163.97	121544.63	7.52	
4801.00	31.170	22.960	4744.41	25.47	-40.84	505.52	2171170.55	121559.16	9.14	
4832.00	32.920	21.220	4770.68	41.39	-25.59	511.70	2171176.73	121574.40	6.38	
4864.00	34.080	19.920	4797.37	58.60	-9.06	517.90	2171182.93	121590.94	4.26	
4895.00	35.090	18.810	4822.89	75.82	7.54	523.73	2171188.77	121607.54	3.84	
4927.00	35.640	16.430	4848.99	94.05	25.19	529.34	2171194.37	121625.19	4.63	
4959.00	37.240	15.660	4874.73	112.84	43.46	534.59	2171199.62	121643.46	5.20	
4990.00	39.650	14.890	4899.01	131.94	62.05	539.66	2171204.69	121662.06	7.93	
5021.00	42.480	15.170	4922.38	152.12	81.72	544.94	2171209.98	121681.72	9.15	
5053.00	44.740	14.750	4945.55	174.01	103.04	550.64	2171215.67	121703.05	7.12	
5085.00	47.610	14.340	4967.70	196.92	125.38	556.43	2171221.47	121725.39	9.02	
5117.00	50.010	12.760	4988.78	220.86	148.79	562.07	2171227.10	121748.80	8.37	
5149.00	52.690	10.700	5008.76	245.78	173.26	567.14	2171232.18	121773.27	9.77	
5180.00	54.830	9.770	5027.09	270.75	197.86	571.58	2171236.62	121797.88	7.31	
5212.00	55.900	9.860	5045.27	297.06	223.81	576.07	2171241.10	121823.82	3.35	
5243.00	58.920	8.980	5061.97	323.16	249.57	580.34	2171245.38	121849.59	10.03	



## Actual Wellpath Report

Sandridge Jones 3506 1-13H\_Final Surveys.  
Page n of nn



REFERENCE WELLPATH IDENTIFICATION			
Operator	Sandridge Energy	Slot	Jones 3506 1-13H SL 200 FSL 1320 FEL
Area	Kansas	Well	Subject
Field	Harper County, Kansas (Sandridge Energy) NAD27 / Grid	Wellbore	Jones 3506 1-13H Actual
Facility	Jones 3506 PAD Sec. 13-35S-6W		

WELLPATH DATA (152 stations) † = interpolated/extrapolated station										
MD [ft]	Inclination [°]	Azimuth [°]	TVD [ft]	Vert Sect [ft]	North [ft]	East [ft]	Grid East [US ft]	Grid North [US ft]	DLS [°/100ft]	Comments
5276.00	62.600	8.080	5078.09	351.95	278.04	584.61	2171249.64	121878.06	11.40	
5307.00	65.740	7.750	5091.59	379.84	305.68	588.45	2171253.48	121905.70	10.17	
5339.00	67.880	5.600	5104.19	409.25	334.89	591.86	2171256.90	121934.91	9.10	
5370.00	71.190	4.880	5115.03	438.27	363.81	594.51	2171259.55	121963.83	10.90	
5402.00	74.270	4.550	5124.53	468.79	394.26	597.02	2171262.06	121994.28	9.68	
5433.00	77.950	4.110	5131.97	498.83	424.26	599.29	2171264.33	122024.29	11.95	
5465.00	81.300	3.680	5137.73	530.24	455.66	601.43	2171266.47	122055.69	10.55	
5497.00	84.310	3.600	5141.74	561.91	487.34	603.45	2171268.48	122087.37	9.41	
5544.00	87.070	4.510	5145.27	608.69	534.08	606.76	2171271.80	122134.12	6.18	
5592.00	87.940	4.110	5147.36	656.57	581.90	610.36	2171275.40	122181.94	1.99	
5639.00	88.250	4.150	5148.92	703.46	628.75	613.75	2171278.78	122228.79	0.67	
5687.00	89.080	3.670	5150.04	751.35	676.63	617.02	2171282.06	122276.67	2.00	
5781.00	89.940	4.280	5150.85	845.17	770.40	623.54	2171288.57	122370.45	1.12	
5838.00	89.170	3.040	5151.29	902.04	827.28	627.17	2171292.21	122427.33	2.56	
5881.00	87.810	1.730	5152.42	944.85	870.22	628.96	2171294.00	122470.28	4.39	
5975.00	87.930	2.650	5155.91	1038.38	964.09	632.55	2171297.59	122564.15	0.99	
6070.00	90.030	2.430	5157.61	1133.01	1058.98	636.76	2171301.80	122659.04	2.22	
6165.00	90.370	1.440	5157.27	1227.56	1153.92	639.97	2171305.01	122753.99	1.10	
6259.00	91.290	0.060	5155.91	1320.89	1247.90	641.20	2171306.24	122847.98	1.76	
6354.00	91.080	0.600	5153.95	1415.13	1342.88	641.75	2171306.79	122942.96	0.61	
6449.00	91.940	1.550	5151.44	1509.50	1437.83	643.53	2171308.57	123037.91	1.35	
6544.00	92.030	0.930	5148.15	1603.88	1532.75	645.58	2171310.62	123132.84	0.66	
6639.00	91.850	1.130	5144.94	1698.22	1627.68	647.29	2171312.33	123227.78	0.28	
6734.00	89.380	1.190	5143.92	1792.63	1722.64	649.21	2171314.25	123322.75	2.60	
6829.00	92.280	0.950	5142.54	1887.01	1817.61	650.99	2171316.03	123417.72	3.06	
6924.00	92.370	1.130	5138.69	1981.33	1912.51	652.71	2171317.75	123512.63	0.21	
7018.00	90.340	0.470	5136.47	2074.66	2006.47	654.02	2171319.06	123606.59	2.27	
7113.00	88.090	1.840	5137.77	2169.06	2101.44	655.93	2171320.97	123701.56	2.77	
7209.00	88.830	1.500	5140.35	2264.53	2197.36	658.73	2171323.77	123797.49	0.85	
7303.00	91.450	2.910	5140.12	2358.11	2291.28	662.35	2171327.39	123891.42	3.17	
7398.00	90.430	1.410	5138.56	2452.68	2386.19	665.93	2171330.97	123986.34	1.91	
7493.00	88.890	359.740	5139.12	2546.98	2481.18	666.88	2171331.92	124081.33	2.39	
7588.00	92.000	1.380	5138.38	2641.27	2576.16	667.81	2171332.85	124176.32	3.70	
7683.00	88.890	0.350	5137.65	2735.62	2671.13	669.24	2171334.28	124271.30	3.45	
7777.00	90.180	359.710	5138.41	2828.82	2765.13	669.29	2171334.33	124365.30	1.53	
7872.00	90.150	0.660	5138.14	2923.04	2860.13	669.60	2171334.64	124460.30	1.00	
7904.00	91.140	1.440	5137.78	2954.84	2892.12	670.18	2171335.23	124492.29	3.94	
7967.00	90.920	1.700	5136.64	3017.49	2955.08	671.91	2171336.95	124555.26	0.54	
8062.00	90.460	1.370	5135.50	3111.97	3050.04	674.46	2171339.50	124650.23	0.60	
8156.00	91.880	1.460	5133.58	3205.42	3143.99	676.78	2171341.82	124744.18	1.51	
8252.00	91.700	1.040	5130.58	3300.80	3239.92	678.87	2171343.91	124840.12	0.48	
8347.00	90.590	0.580	5128.68	3395.13	3334.89	680.21	2171345.25	124935.10	1.26	
8384.00†	90.453	0.081	5128.35	3431.84	3371.89	680.43	2171345.47	124972.10	1.40	Sec. 13/12 crossing 8384 MD (5128 TVD) X:2171345 Y:124972 0 FSL 631 FEL
8439.00	90.250	359.340	5128.01	3486.34	3426.89	680.15	2171345.19	125027.10	1.40	
8529.00	88.830	358.050	5128.73	3575.27	3516.86	678.10	2171343.14	125117.07	2.13	



## Actual Wellpath Report

Sandridge Jones 3506 1-13H\_Final Surveys.  
Page n of nn



REFERENCE WELLPATH IDENTIFICATION			
Operator	Sandridge Energy	Slot	Jones 3506 1-13H SL 200 FSL 1320 FEL
Area	Kansas	Well	Subject
Field	Harper County, Kansas (Sandridge Energy) NAD27 / Grid	Wellbore	Jones 3506 1-13H Actual
Facility	Jones 3506 PAD Sec. 13-35S-6W		

WELLPATH DATA (152 stations)										
MD [ft]	Inclination [°]	Azimuth [°]	TVD [ft]	Vert Sect [ft]	North [ft]	East [ft]	Grid East [US ft]	Grid North [US ft]	DLS [°/100ft]	Comments
8624.00	91.450	358.740	5128.50	3669.06	3611.81	675.44	2171340.48	125212.03	2.85	
8656.00	92.160	358.330	5127.49	3700.66	3643.78	674.62	2171339.66	125244.01	2.56	
8751.00	89.690	358.570	5125.96	3794.46	3738.73	672.05	2171337.09	125338.96	2.61	
8846.00	89.630	358.820	5126.52	3888.33	3833.70	669.89	2171334.93	125433.94	0.27	
8923.00	91.330	358.700	5125.88	3964.44	3910.68	668.22	2171333.26	125510.92	2.21	
8973.00	89.540	358.590	5125.50	4013.84	3960.66	667.04	2171332.08	125560.90	3.59	
9036.00	91.050	357.630	5125.17	4075.99	4023.62	664.96	2171330.00	125623.87	2.84	
9131.00	89.630	358.820	5124.61	4169.74	4118.57	662.02	2171327.06	125718.82	1.95	
9226.00	89.290	358.270	5125.50	4263.58	4213.54	659.61	2171324.65	125813.80	0.68	
9321.00	89.200	357.040	5126.76	4357.17	4308.45	655.72	2171320.76	125908.71	1.30	
9415.00	88.860	357.470	5128.35	4449.66	4402.33	651.22	2171316.26	126002.60	0.58	
9510.00	92.220	358.060	5127.45	4543.28	4497.23	647.51	2171312.55	126097.51	3.59	
9604.00	92.550	357.850	5123.54	4635.89	4591.09	644.16	2171309.20	126191.38	0.42	
9699.00	92.740	358.230	5119.16	4729.50	4685.94	640.92	2171305.96	126286.22	0.45	
9794.00	90.250	358.550	5116.68	4823.27	4780.86	638.25	2171303.29	126381.15	2.64	
9858.00	91.050	358.830	5115.95	4886.51	4844.84	636.79	2171301.83	126445.13	1.32	
9906.00	91.050	358.830	5115.07	4933.95	4892.82	635.81	2171300.85	126493.12	0.00	Actual BHL 9906 MD (5115 TVD) X:2171301 Y:126493 VS:4934 1521 FSL 669 FEL

TARGETS									
Name	MD [ft]	TVD [ft]	North [ft]	East [ft]	Grid East [US ft]	Grid North [US ft]	Latitude	Longitude	Shape
PBHL 1530 FSL 660 FEL		5093.72	4900.70	644.96	2171310.00	126501.00	37°00'45.362"N	97°54'48.009"W	point

WELLPATH COMPOSITION - Ref Wellbore: Jones 3506 1-13H Actual Ref Wellpath: AWP (Final)				
Start MD [ft]	End MD [ft]	Positional Uncertainty Model	Log Name/Comment	Wellbore
18.00	600.00	Generic gyro - northseeking (Standard)	Gyros	Jones 3506 1-13H Actual
600.00	9858.00	NaviTrak (Standard)	Inteq MWD	Jones 3506 1-13H Actual
9858.00	9906.00	Blind Drilling (std)	Projection to bit	Jones 3506 1-13H Actual