



**APPLICATION FOR COMMINGLING OF PRODUCTION (K.A.R. 82-3-123) OR FLUIDS (K.A.R. 82-3-123a)** *Commingling ID # \_\_\_\_\_*

OPERATOR: License # \_\_\_\_\_ API No. 15 - \_\_\_\_\_  
Name: \_\_\_\_\_ Spot Description: \_\_\_\_\_  
Address 1: \_\_\_\_\_ - - - - - Sec. \_\_\_\_\_ Twp. \_\_\_\_\_ S. R. \_\_\_\_\_  East  West  
Address 2: \_\_\_\_\_ Feet from  North /  South Line of Section  
City: \_\_\_\_\_ State: \_\_\_\_\_ Zip: \_\_\_\_\_ + \_\_\_\_\_ Feet from  East /  West Line of Section  
Contact Person: \_\_\_\_\_ County: \_\_\_\_\_  
Phone: ( \_\_\_\_\_ ) \_\_\_\_\_ Lease Name: \_\_\_\_\_ Well #: \_\_\_\_\_

1. Name and upper and lower limit of each production interval to be commingled:  
Formation: \_\_\_\_\_ (Perfs): \_\_\_\_\_  
Formation: \_\_\_\_\_ (Perfs): \_\_\_\_\_  
Formation: \_\_\_\_\_ (Perfs): \_\_\_\_\_  
Formation: \_\_\_\_\_ (Perfs): \_\_\_\_\_  
Formation: \_\_\_\_\_ (Perfs): \_\_\_\_\_

2. Estimated amount of fluid production to be commingled from each interval:  
Formation: \_\_\_\_\_ BOPD: \_\_\_\_\_ MCFPD: \_\_\_\_\_ BWPD: \_\_\_\_\_  
Formation: \_\_\_\_\_ BOPD: \_\_\_\_\_ MCFPD: \_\_\_\_\_ BWPD: \_\_\_\_\_  
Formation: \_\_\_\_\_ BOPD: \_\_\_\_\_ MCFPD: \_\_\_\_\_ BWPD: \_\_\_\_\_  
Formation: \_\_\_\_\_ BOPD: \_\_\_\_\_ MCFPD: \_\_\_\_\_ BWPD: \_\_\_\_\_  
Formation: \_\_\_\_\_ BOPD: \_\_\_\_\_ MCFPD: \_\_\_\_\_ BWPD: \_\_\_\_\_

3. Plat map showing the location of the subject well, all other wells on the subject lease, and all wells on offsetting leases within a 1/2 mile radius of the subject well, and for each well the names and addresses of the lessee of record or operator.

4. Signed certificate showing service of the application and affidavit of publication as required in K.A.R. 82-3-135a.

**For Commingling of PRODUCTION ONLY, include the following:**

- 5. Wireline log of subject well. Previously Filed with ACO-1:  Yes  No
- 6. Complete Form ACO-1 (*Well Completion form*) for the subject well.

**For Commingling of FLUIDS ONLY, include the following:**

- 7. Well construction diagram of subject well.
- 8. Any available water chemistry data demonstrating the compatibility of the fluids to be commingled.

**AFFIDAVIT:** I am the affiant and hereby certify that to the best of my current information, knowledge and personal belief, this request for commingling is true and proper and I have no information or knowledge, which is inconsistent with the information supplied in this application.

**Submitted Electronically**

**KCC Office Use Only**  
 Denied  Approved  
15-Day Periods Ends: \_\_\_\_\_  
Approved By: \_\_\_\_\_ Date: \_\_\_\_\_

*Protests may be filed by any party having a valid interest in the application. Protests must be in writing and comply with K.A.R. 82-3-135b and must be filed within 15 days of publication of the notice of application.*

R 22 W

T  
26  
S

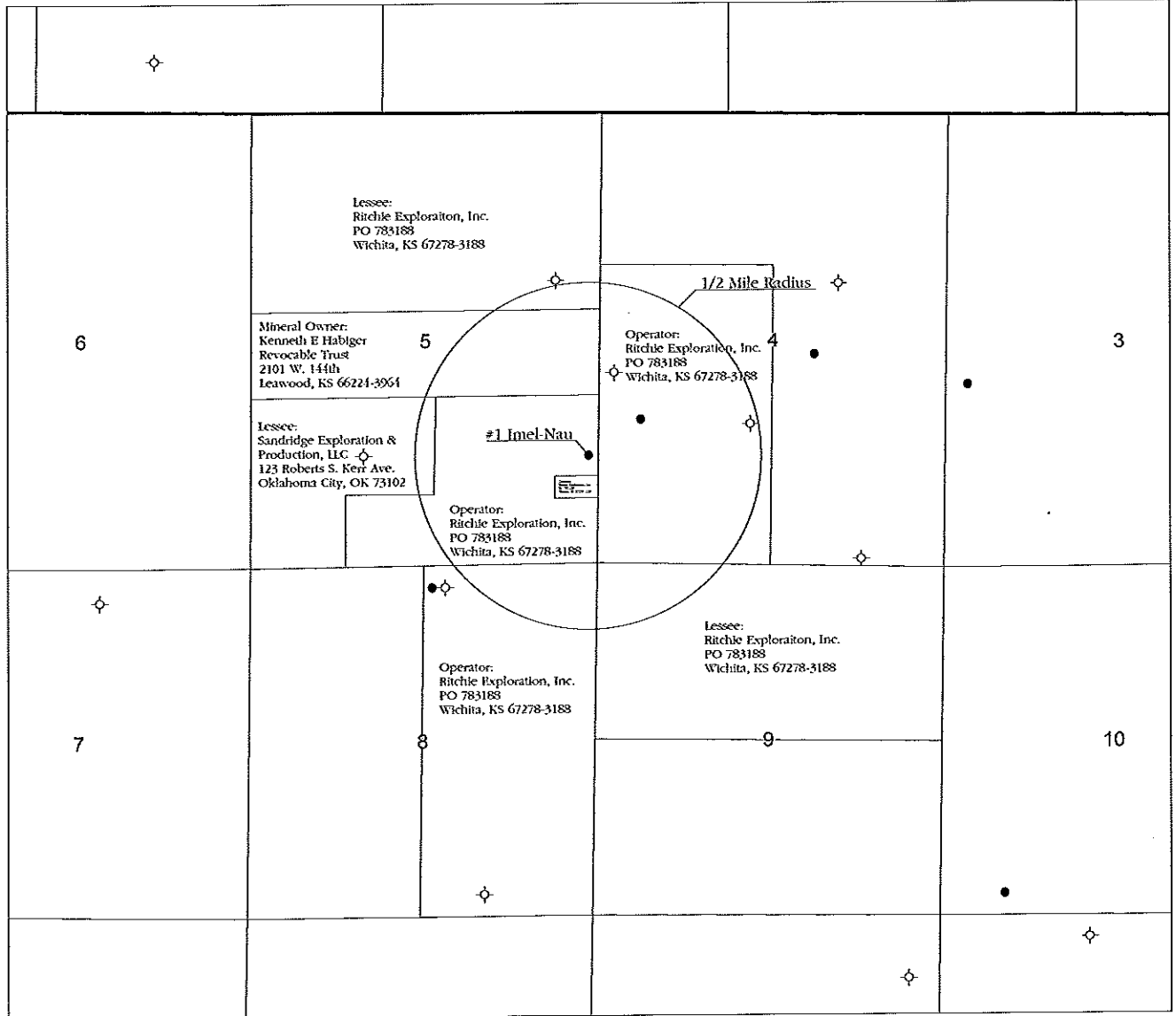

- Legend
- Oil Well
  - ◊ Dry and Abandoned Well



**RITCHIE**  
EXPLORATION, INC.  
Wichita, Kansas

Application for  
Commingle of  
Production or Fluids

**Applicant Well: #1 Imel-Nau**  
All Wells on Offsetting Leases within 1/2 Mile Radius  
Name and Address of Lessee of Record, Mineral Owner  
Or Operator on Offsetting Leases

**Ford County, Kansas**

Prepared By: Justin Clegg	Scale: 1 : 33,000	Date: July 11, 2013
------------------------------	----------------------	------------------------

# APPLICATION FOR COMMINGLING OF PRODUCTION OR FLUIDS

**Operator, Lessee or Unleased Mineral Owner  
within a ½ mile radius of Ritchie Exploration, Inc.'s**

**#1 Imel-Nau  
1635' FSL & 147' FEL  
Section 5-26S-22W  
Ford Co., KS**

## Township 26 South, Range 22 West

Sec. 4:	S. 280 acres of W/2	Ritchie Exploration, Inc. P.O. Box 783188 Wichita, KS 67278-3188	Operator: #1 Imel-Nau, #1 Nau 4BC
Sec. 5:	Lots 1-4	Ritchie Exploration, Inc.	Lessee
	S/2N/2	Kenneth E. Habiger & Cynthia A. Habiger, Co-Trustees of the Kenneth E. Habiger Revocable Living Trust, dated 2/19/99, as restated 3/24/04 2101 W. 144 <sup>th</sup> St. Leawood, KS 66224-3964	Mineral Owners
	SESW, SE, except N/2NESESE	Ritchie Exploration, Inc.	Operator: #1 Imel-Nau
	N/2NESESE	Ritchie Exploration, Inc.	Operator: #1 Imel-Nau
	N/2SW, SWSW	SandRidge Exploration & Production, LLC 123 Robert S. Kerr Ave. Oklahoma City, OK 73102	Lessee
Sec. 8:	E/2	Ritchie Exploration, Inc.	Operator: #1 Imel 8AD-Nau
Sec. 9:	N/2	Ritchie Exploration, Inc.	Lessee

**AFFIDAVIT**

STATE OF KANSAS        \  
                                     - SS.  
County of Sedgwick       /

Mark Fletchall, of lawful age, being first duly sworn, deposeth and saith: That he is Record Clerk of The Wichita Eagle, a daily newspaper published in the City of Wichita, County of Sedgwick, State of Kansas, and having a general paid circulation on a daily basis in said County, which said newspaper has been continuously and uninterruptedly published in said County for more than one year prior to the first publication of the notice hereinafter mentioned, and which said newspaper has been entered as second class mail matter at the United States Post Office in Wichita, Kansas, and which said newspaper is not a trade, religious or fraternal publication and that a notice of a true copy is hereto attached was published in the regular and entire Morning issue of said The Wichita Eagle for   1   issues, that the first publication of said notice was

made as aforesaid on the **19th**

**July** A.D. **2013**, with

subsequent publications being made on the following dates:

And affiant further says that he has personal knowledge of the statements above set forth and that they are true.

*Mark Fletchall*

Subscribed and sworn to before me this

**19th day of July, 2013**

JENNIFER RAE BAILEY  
Notary Public - State of Kansas  
My Appl. Expires 6/4/2017

*Jennifer Bailey*  
Notary Public Sedgwick County, Kansas

Printer's Fee : **\$89.20**

**LEGAL PUBLICATION**  
PUBLISHED IN THE WICHITA EAGLE  
JULY 19, 2013 (3256455)  
**LEGAL NOTICE**  
You, and each of you, are hereby notified that Ritchie Exploration, Inc. has filed an application to commence the commingling of production from the Cherokee and Atoka sources of supply for the #1 Inel-Nau well located approx. NE SE of Section 5-26S-22W, Ford County, Kansas.  
Any persons who object to or protest this application shall be required to file their objections or protests with the Conservation Division of the State Corporation Commission of the State of Kansas within fifteen (15) days from the date of the publication. These protests shall be filed pursuant to Commission regulations and must state specific reasons why the grant of the application may cause waste, violate correlative rights or pollute the natural resources of the state of Kansas.  
If no protests are received, this application may be granted through a summary proceeding. If valid protests are received, this matter will be set for hearing.  
All persons interested or concerned shall take notice of the foregoing and shall govern themselves accordingly.  
RITCHIE EXPLORATION, INC.  
P.O. Box 783188  
Wichita, KS 67278-3188  
(316) 691-9500

Proof of Publication  
State of Kansas, Ford County, SS.

Dodge City Daily Globe

Ritchie Exploration, Inc.  
P.O. Box 783188  
Wichita, KS 67278

Reference: 67100                      Account: 114170

Case No. Application to Commingle

Ed O'Neal of lawful age, being duly sworn upon oath, states that he is the Circulation Manager of the DODGE CITY DAILY GLOBE.

THAT said newspaper has been published at least weekly fifty (50) times a year and has been so published for at least five years prior to the first publication of the attached notice;

THAT said paper was entered as second-class mail matter at the post office of its publication;

THAT said paper has a general paid circulation on a daily, or weekly, or yearly basis in FORD COUNTY KANSAS, and is NOT a trade, religious or fraternal publication and has been PRINTED and published in FORD COUNTY, KANSAS.

THE ATTACHED was published on the following dates in a regular issue of said paper:

(Sign)



PUBLISHED ON:                      07/19/2013

TOTAL COST:                        \$ 32.50

FILED ON:                            07/19/2013

AD SPACE:                          6.25 inches

Witness my hand this 19 day of July, 2013

SUBSCRIBED and Sworn to Before Me This 19 day of July, 2013.

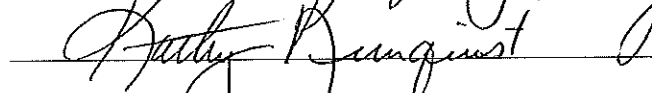

Notary Public, Ford County, Kansas

(Published in the Dodge City Daily Globe Friday, July 19th, 2013)

LEGAL NOTICE

You, and each of you, are hereby notified that Ritchie Exploration, Inc. has filed an application to commence the commingling of production from the Cherokee and Atoka sources of supply for the #1 Imel-Nau well located approx. NE SE of Section 5-26S-22W, Ford County, Kansas.

Any persons who object to or protest this application shall be required to file their objections or protests with the Conservation Division of the State Corporation Commission of the State of Kansas within fifteen (15) days from the date of the publication. These protests shall be filed pursuant to Commission regulations and must state specific reasons why the grant of the application may cause waste, violate correlative rights or pollute the natural resources of the state of Kansas. If no protests are received, this application may be granted through a summary proceeding. If valid protests are received, this matter will be set for hearing.

All persons interested or concerned shall take notice of the foregoing and shall govern themselves accordingly.

RITCHIE EXPLORATION, INC.  
P.O. Box 783188  
Wichita, KS 67278-3188  
(316) 691-9500  
1xFri

 **KATHY RUNQUIST**  
Notary Public - State of Kansas  
My Appt. Expires 11/23/16

**AFFIDAVIT**

STATE OF KANSAS            )  
  - SS.  
County of Sedgwick         )

John Niernberger, of lawful age, being first duly sworn, deposes and saith: That he is Production Manager of Ritchie Exploration, County of Sedgwick, State of Kansas, and that notice was given to all lessee of record or operator within ½ mile radius of the Imel-Nau #1 well located in the County of Ford (see plat map attached). This notice included a letter and a copy of the Commingle Application (ACO-4). All notices were mailed on July 16, 2013.

made as aforesaid on the 16<sup>th</sup> of

July A.D. 2013

\_\_\_\_\_

And affiant further says that he has personal knowledge of the statements above set forth and that they are true.

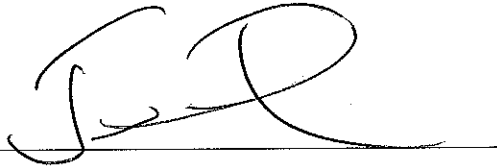

Subscribed and sworn to before me this

16<sup>th</sup> day of July 2013

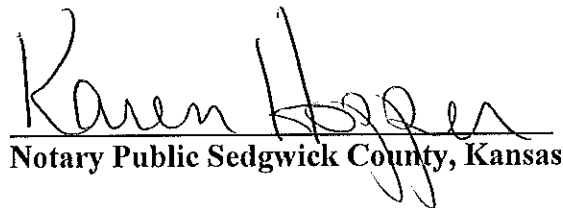

Notary Public Sedgwick County, Kansas

**KAREN HOPPER**  
**NOTARY PUBLIC-STATE OF KANSAS**  
**MY APPT. EXPIRES 3.8.15**

**KANSAS CORPORATION COMMISSION**  
**OIL & GAS CONSERVATION DIVISION**  
**WELL COMPLETION FORM**  
**WELL HISTORY - DESCRIPTION OF WELL & LEASE**

Form ACO-1  
 June 2009  
**Form Must Be Typed**  
**Form must be Signed**  
**All blanks must be Filled**

OPERATOR: License # 4767  
 Name: Ritchie Exploration, Inc.  
 Address 1: P.O. Box 783188  
 Address 2: \_\_\_\_\_  
 City: Wichita State: KS Zip: 67278 + 3188  
 Contact Person: Peter Fiorini  
 Phone: (316) 691-9500  
 CONTRACTOR: License # 5929  
 Name: Duke Drilling Co., Inc.  
 Wellsite Geologist: Adam Eldani  
 Purchaser: NCRA

Designate Type of Completion:

- New Well     Re-Entry     Workover
- Oil     WSW     SWD     SLOW
- Gas     D&A     ENHR     SIGW
- OG     GSW     Temp. Abd.
- CM (Coal Bed Methane)
- Cathodic     Other (Core, Expl., etc.): \_\_\_\_\_

If Workover/Re-entry: Old Well Info as follows:

Operator: \_\_\_\_\_  
 Well Name: \_\_\_\_\_  
 Original Comp. Date: \_\_\_\_\_ Original Total Depth: \_\_\_\_\_  
 Deepening     Re-perf.     Conv. to ENHR     Conv. to SWD  
 Conv. to GSW

Plug Back: \_\_\_\_\_ Plug Back Total Depth \_\_\_\_\_

Commingled    Permit #: \_\_\_\_\_

Dual Completion    Permit #: \_\_\_\_\_

SWD    Permit #: \_\_\_\_\_

ENHR    Permit #: \_\_\_\_\_

GSW    Permit #: \_\_\_\_\_

<u>5/11/11</u>	<u>5/22/11</u>	<u>5/22/11</u>
Spud Date or Recompletion Date	Date Reached TD	Completion Date or Recompletion Date

API No. 15 - 057-20727-00-00  
 Spot Description: irregular section  
 \_\_\_\_\_ Sec. 5 Twp. 26 S. R. 22  East  West  
1,835 Feet from  North /  South Line of Section  
147 Feet from  East /  West Line of Section  
 Footages Calculated from Nearest Outside Section Corner:  
 NE     NW     SE     SW  
 County: Ford  
 Lease Name: Imel-Nau Well #: 1  
 Field Name: \_\_\_\_\_  
 Producing Formation: Cherokee & Atoka  
 Elevation: Ground: 2411 Kelly Bushing: 2423  
 Total Depth: 4967 Plug Back Total Depth: 4937  
 Amount of Surface Pipe Set and Cemented at: 384 Feet  
 Multiple Stage Cementing Collar Used?  Yes  No  
 If yes, show depth set: 1448 Feet  
 If Alternate II completion, cement circulated from: surface  
 feet depth to: 1448 w/ 250 sx cmt.

**Drilling Fluid Management Plan**

(Data must be collected from the Reserve Pit)

Chloride content: 9200 ppm Fluid volume: 1200 bbls  
 Dewatering method used: evaporation  
 Location of fluid disposal if hauled offsite: \_\_\_\_\_  
 Operator Name: \_\_\_\_\_  
 Lease Name: \_\_\_\_\_ License #: \_\_\_\_\_  
 Quarter \_\_\_\_\_ Sec. \_\_\_\_\_ Twp. \_\_\_\_\_ S. R. \_\_\_\_\_  East  West  
 County: \_\_\_\_\_ Permit #: \_\_\_\_\_

**INSTRUCTIONS:** An original and two copies of this form shall be filed with the Kansas Corporation Commission, 130 S. Market - Room 2078, Wichita, Kansas 67202, within 120 days of the spud date, recompletion, workover or conversion of a well. Rule 82-3-130, 82-3-106 and 82-3-107 apply. Information of side two of this form will be held confidential for a period of 12 months if requested in writing and submitted with the form (see rule 82-3-107 for confidentiality in excess of 12 months). One copy of all wireline logs and geologist well report shall be attached with this form. ALL CEMENTING TICKETS MUST BE ATTACHED. Submit CP-4 form with all plugged wells. Submit CP-111 form with all temporarily abandoned wells.

**AFFIDAVIT**

I am the affiant and I hereby certify that all requirements of the statutes, rules and regulations promulgated to regulate the oil and gas industry have been fully complied with and the statements herein are complete and correct to the best of my knowledge.

Signature: \_\_\_\_\_  
 Title: Development/Production Geologist Date: 9/8/11

**KCC Office Use ONLY**

- Letter of Confidentiality Received  
 Date: \_\_\_\_\_
- Confidential Release Date: \_\_\_\_\_
- Wireline Log Received
- Geologist Report Received
- UIC Distribution
- ALT  I  II  III Approved by: \_\_\_\_\_ Date: \_\_\_\_\_

Operator Name: Ritchie Exploration, Inc. Lease Name: Imel-Nau Well #: 1  
 Sec. 5 Twp. 26 S. R. 22  East  West County: Ford

**INSTRUCTIONS:** Show important tops and base of formations penetrated. Detail all cores. Report all final copies of drill stems tests giving interval tested, time tool open and closed, flowing and shut-in pressures, whether shut-in pressure reached static level, hydrostatic pressures, bottom hole temperature, fluid recovery, and flow rates if gas to surface test, along with final chart(s). Attach extra sheet if more space is needed. Attach complete copy of all Electric Wire-line Logs surveyed. Attach final geological well site report.

Drill Stem Tests Taken <input checked="" type="checkbox"/> Yes <input type="checkbox"/> No <i>(Attach Additional Sheets)</i>  Samples Sent to Geological Survey <input checked="" type="checkbox"/> Yes <input type="checkbox"/> No  Cores Taken <input type="checkbox"/> Yes <input checked="" type="checkbox"/> No Electric Log Run <input checked="" type="checkbox"/> Yes <input type="checkbox"/> No Electric Log Submitted Electronically <input checked="" type="checkbox"/> Yes <input type="checkbox"/> No <i>(If no, Submit Copy)</i>  List All E. Logs Run: Dual Induction Log Compensated Density/Neutron Log	<input type="checkbox"/> Log Formation (Top), Depth and Datum <input checked="" type="checkbox"/> Sample Name Top Datum  SEE ATTACHED
---	--

CASING RECORD <input checked="" type="checkbox"/> New <input type="checkbox"/> Used							
Report all strings set-conductor, surface, intermediate, production, etc.							
Purpose of String	Size Hole Drilled	Size Casing Set (in O.D.)	Weight Lbs. / Ft.	Setting Depth	Type of Cement	# Sacks Used	Type and Percent Additives
Surface	12-1/4	8-5/8	23	384	common	250	3% cc, 2% gel
Production	7-7/8	5-1/2	15.5	4962	ASC	210	10% sst, 2% gel & 5/8"st g/2oz/2a

ADDITIONAL CEMENTING / SQUEEZE RECORD				
Purpose:	Depth Top Bottom	Type of Cement	# Sacks Used	Type and Percent Additives
<input type="checkbox"/> Perforate				
<input type="checkbox"/> Protect Casing				
<input type="checkbox"/> Plug Back TD				
<input type="checkbox"/> Plug Off Zone				

Shots Per Foot	PERFORATION RECORD - Bridge Plugs Set/Type Specify Footage of Each Interval Perforated	Acid, Fracture, Shot, Cement Squeeze Record (Amount and Kind of Material Used)	Depth
4	4838.5' - 4843.5', 4846.5' - 4859.5'(Cherokee) 6/3/11	500 gallons 15% NE (6/6/11), 500 gallons 15% NE (6/8/11)	
4	4852' - 4855' (Atoka) 6/7/11	500 gallons 15% NE (6/8/11)	
4	4810' - 4813', 4823.5'-4826.5',4830.5'-4833.5'(Cherokee) 6/9/11		

TUBING RECORD: Size: <u>2-7/8"</u> Set At: <u>4909'</u> Packer At: _____ Liner Run: <input type="checkbox"/> Yes <input checked="" type="checkbox"/> No	
Date of First, Resumed Production, SWD or ENHR. <u>6/16/11</u>	Producing Method: <input type="checkbox"/> Flowing <input checked="" type="checkbox"/> Pumping <input type="checkbox"/> Gas Lift <input type="checkbox"/> Other (Explain) _____
Estimated Production Per 24 Hours	Oil Bbls. <u>47.96</u> Gas Mcf _____ Water Bbls. <u>0</u> Gas-Oil Ratio _____ Gravity <u>30.04</u>

DISPOSITION OF GAS: <input type="checkbox"/> Vented <input type="checkbox"/> Sold <input type="checkbox"/> Used on Lease <i>(If vented, Submit ACO-18.)</i>	METHOD OF COMPLETION: <input type="checkbox"/> Open Hole <input type="checkbox"/> Perf. <input type="checkbox"/> Dually Comp. <input type="checkbox"/> Commingled <i>(Submit ACO-5)</i> <i>(Submit ACO-4)</i> <input type="checkbox"/> Other (Specify) _____	PRODUCTION INTERVAL: _____ _____
---	---	--





#1 Imel-Nau  
1635' FSL & 147' FEL  
Irregular Section 5-26S-22W  
Ford County, Kansas  
API# 15-057-20727-0000  
Elevation: 2411' GL: 2423' KB

<u>Sample Tops</u>			<u>Ref.</u> <u>Well</u>
Anhydrite	1485'	+938	+4
B/Anhydrite	1516'	+907	+2
Stotler	3486'	-1063	+1
Heebner	4104'	-1681	+5
Lansing	4217'	-1794	+2
Muncie Shale	4397'	-1974	+2
Stark Shale	4497'	-2074	flat
BKC	4593'	-2170	+2
Altamont	4642'	-2219	+5
Pawnee	4721'	-2298	+2
Fort Scott	4752'	-2329	+3
Cherokee Shale	4770'	-2347	+5
Atoka Shale	4848'	-2425	+2
Mississippian	4872'	-2449	-3
RTD	4967'	-2544	

Conservation Division  
Finney State Office Building  
130 S. Market, Rm. 2078  
Wichita, KS 67202-3802



Phone: 316-337-6200  
Fax: 316-337-6211  
<http://kcc.ks.gov/>

Mark Sievers, Chairman  
Thomas E. Wright, Commissioner  
Shari Feist Albrecht, Commissioner

Sam Brownback, Governor

August 20, 2013

John Niernberger  
Ritchie Exploration, Inc.  
P.O. Box 783188  
Wichita, KS 67278-3188

RE: Approved Commingling CO081303  
Imel-Nau #1, Sec.5-T26S-R22W, Ford County  
API No. 15-057-20727-00-00

Dear Mr. Niernberger:

Your Application for Commingling (ACO-4) for the above described well has been reviewed and approved by the Kansas Corporation Commission (KCC) per K.A.R. 82-3-123. Notice was examined and found to be proper per K.A.R. 82-3-135a. No protest had been filed within the 15-day protest period. This application, which was received by the KCC on August 20, 2013, concerns approval to simultaneously produce from the following sources of supply through the same tubing string in the same wellbore:

Source of Supply	Estimated Current Production			Perf Depth
	BOPD	MCFPD	BWPD	
Cherokee	8.83	0.00	0.00	4838-4849
Atoka	1.56	0.00	0.00	4852-4855
Total Estimated Current Production	10.39	0.00	0.00	

Based upon the depth of the Atoka formation perforations, total oil production shall not exceed 200 BOPD and total gas production shall not exceed 50% of the absolute open flow (AOF).

Commingling ID number CO081303 has been assigned to this approved application. Use this number for well completion reports (ACO-1) and other correspondence that may concern this approved commingling.

Sincerely,

Rick Hestermann  
Production Department