

Proposed Plan of Construction

Enterprises A-4
Sec 21 T30S-R32W
Haskell County, KS

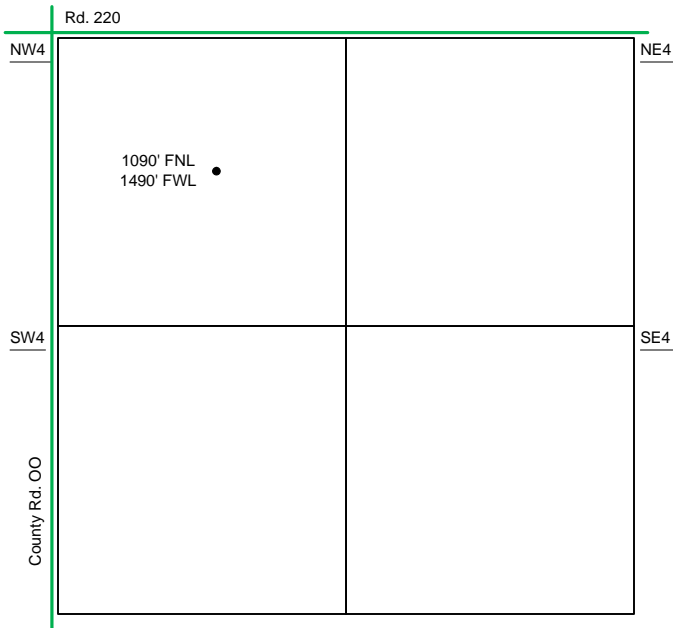

Sec 21 - T30S - R32W

The Tank Battery for the Enterprises A-4 is located in the SW of the adjacent quarter.

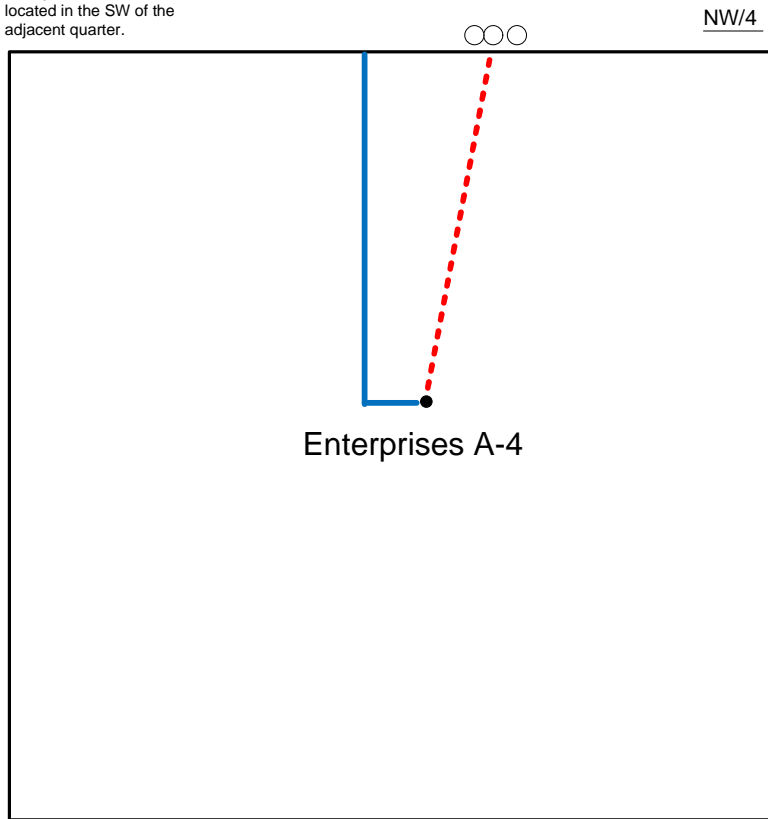

- Well Location
- Proposed Lease Roads
- - - Proposed Pipeline
- Proposed Tank Battery
- Proposed Power Lines
- - - Existing Pipeline

Proposed Details of
NW/4 Sec 21 -T30S -R32W

Note-Drawing **Not** to Scale

Proposed Site Diagram
Enterprises A-4
August 7, 2013

