

**Proposed Plan of Construction**  
 Dewell B-1  
 Sec 17 T29S-R33W  
 Haskell County, KS

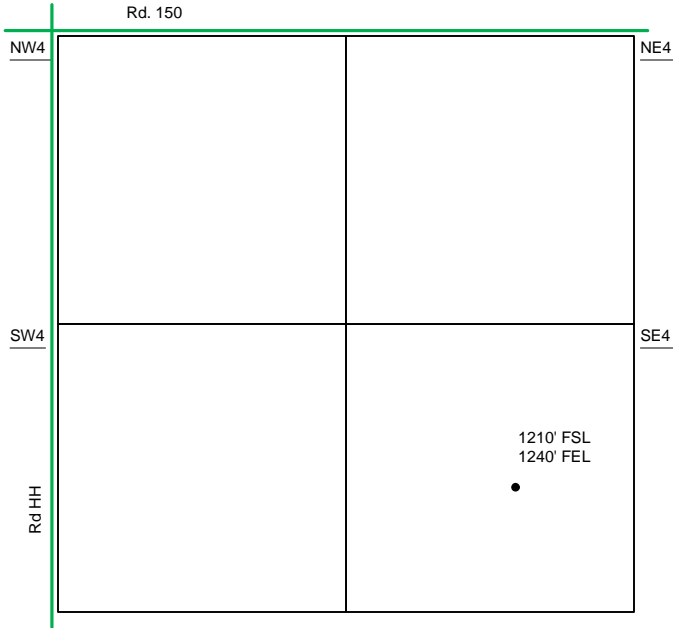

Sec 17 – T29S – R33W

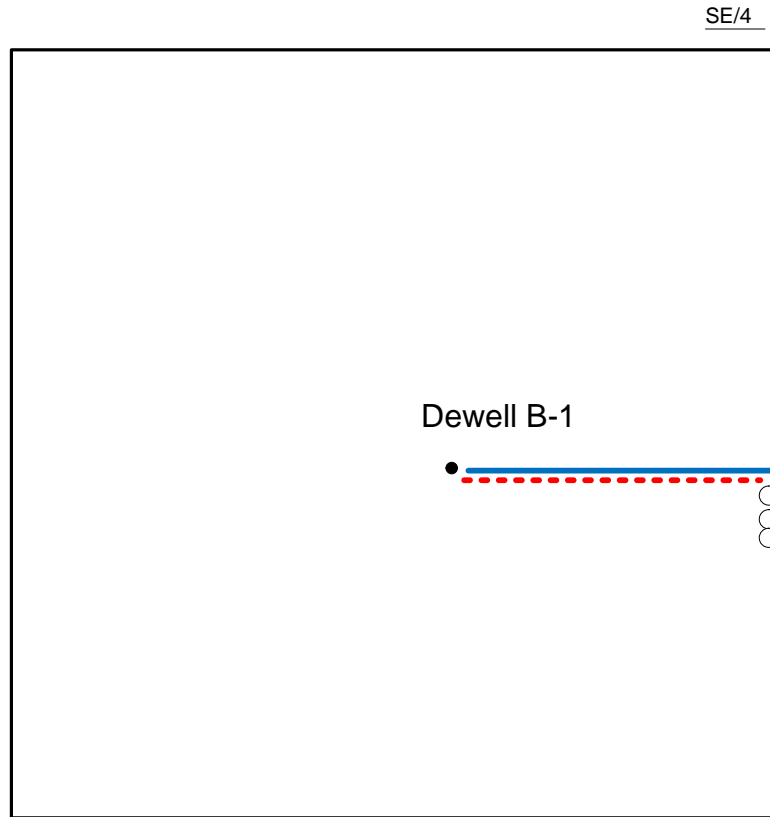

SE/4

- Well Location
- Proposed Lease Roads
- - - Proposed Pipeline
- Proposed Tank Battery
- Proposed Power Lines
- - - Existing Pipeline

The Tank Battery for the Dewell B-1 is located in the SE of the SE quarter

Proposed Details of  
 SE/4 Sec 17 -T29S -R33W

Note-Drawing **Not** to Scale

