

OPERATOR : Samuel Gary Jr & Associates, Inc 1515 Wynkoop Street, Suite 700
Denver, Colorado 80202 office :303-831-4673 ; fax :303-863-7285

WELL NAME : JONAS FAMILY TRUST 1-10

LOCATION : 990 FNL / 330 FWL Sec. 10-17S-13W BARTON COUNTY

SURFACE OWNERS : J.N. RATHBURN INC., A KANSAS CORPORATION
REPRESENTED BY SANDRA LEIGHTON, PRESIDENT
14431 GLEAMING ROSE DRIVE
CYPRESS, TEXAS 77429

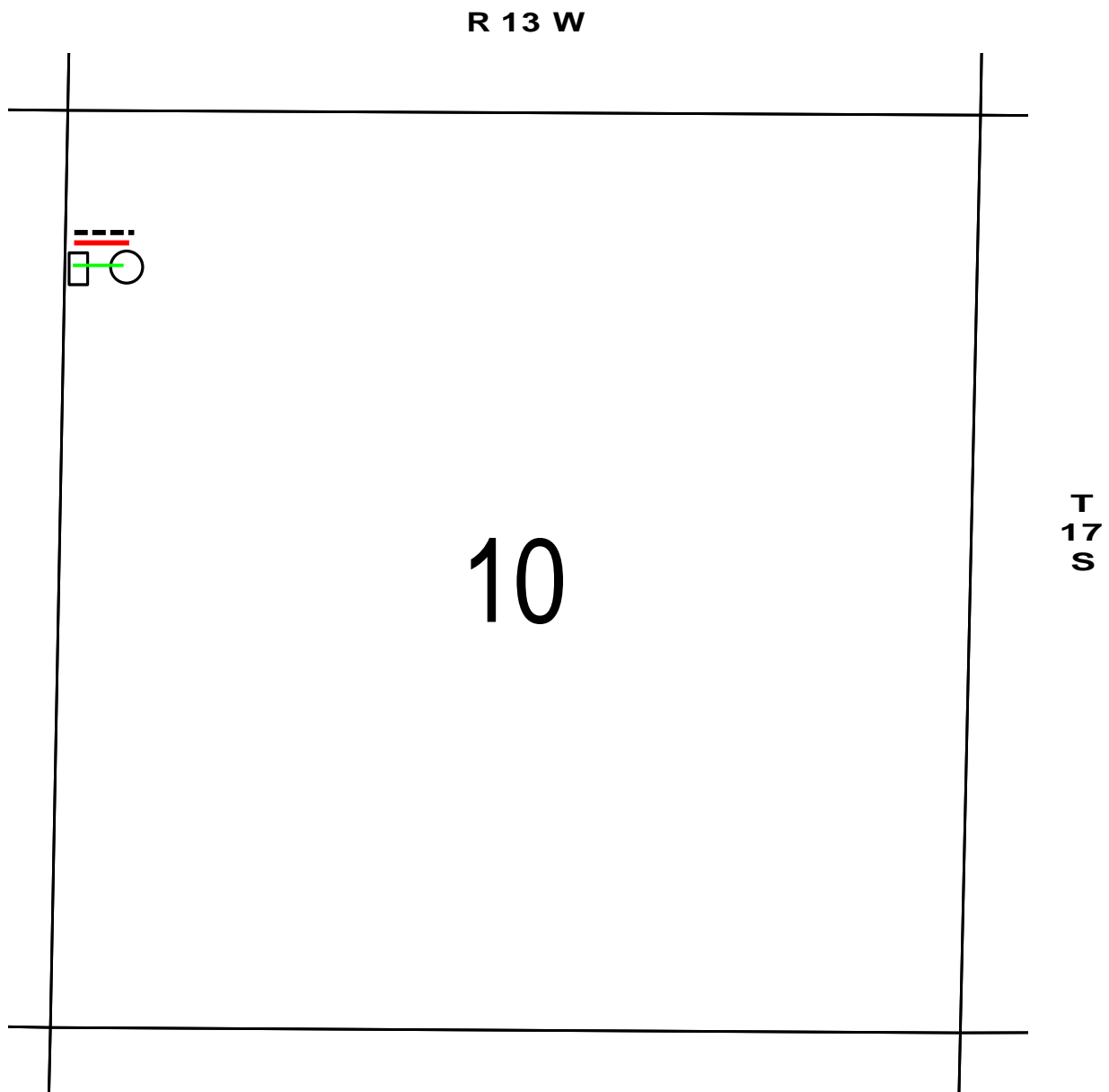

-  PROPOSED WELL LOCATION
-  ESTIMATED LOCATION OF TANK BATTERY
-  ESTIMATED LOCATION OF FLOW LINES
-  ESTIMATED LOCATION OF ELECTRICAL LINES
-  ESTIMATED LEASE ROAD