

IOLA SONIC DRIVE-IN

SONIC CALL IN ADVANCE - NO WAITING *Dan Oswalt*
Manager

301 W. Madison **365-5282** Iola, KS

T-23-24-S ANDERSON CO **CARLYLE** ANDERSON CO **R-18-19-E**

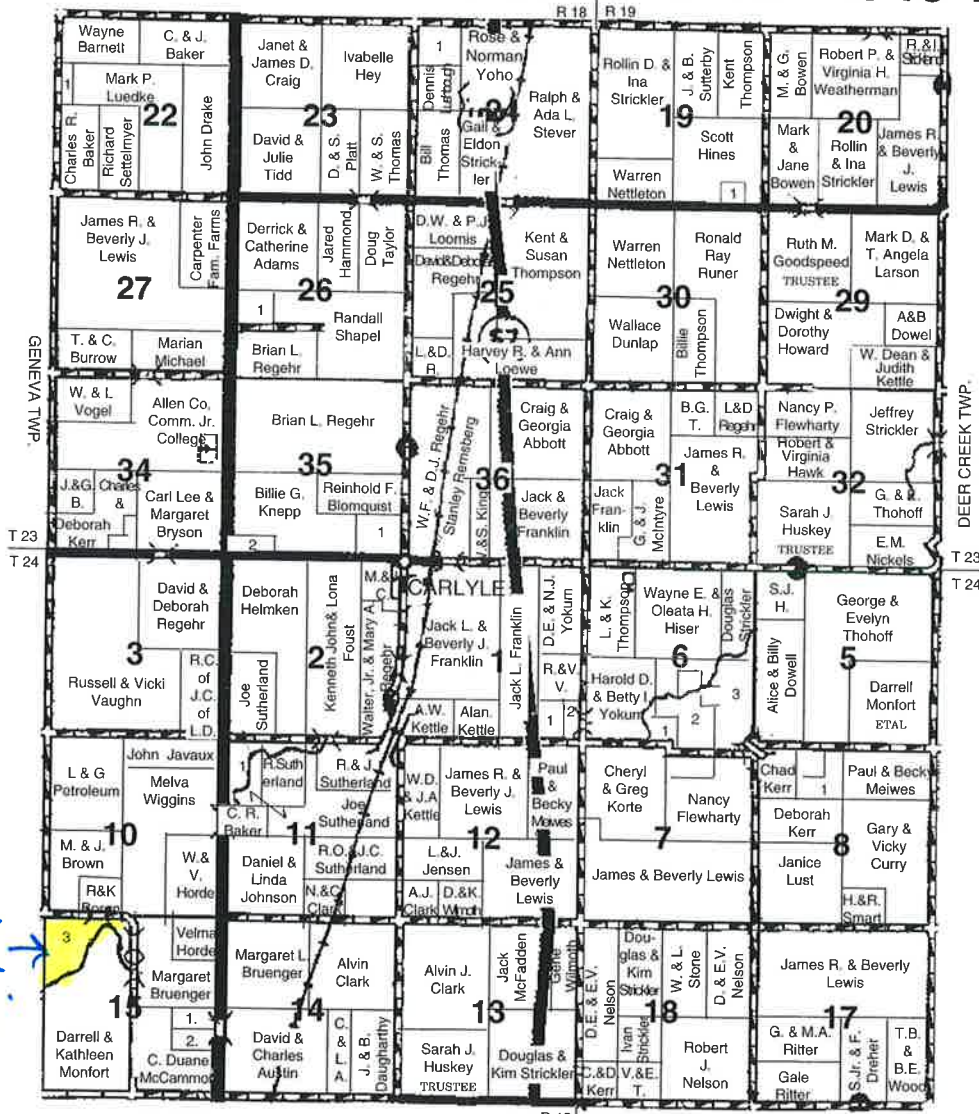

note

- | | | | |
|---|--|--|----------------------------------|
| <p>IOLA TWP</p> <p>Section #1
1. Warren Kettle
2. William Fritsche</p> <p>Section #6
1. David & Nancy Yokum
2. Vera J. Shafer
3. Nancy Flewharty</p> <p>Section #8
1. John W. & Mildred L. Trester</p> <p>Section #11
1. Richard Sutherland</p> | <p>ELM TWP R 18</p> <p>Section #15
1. Fred & Sandra Hermstein
2. Ruth Boyer
3. <u>C. Duane McCammon</u></p> <p>Section #19
1. Russell & Jennis Thomas</p> <p>Section #22
1. Jerome Thompson</p> <p>Section #24
1. Kenneth & Christena Powell</p> | <p>R 19</p> <p>Section #26
1. Carpenter Family Farms LLC</p> <p>Section #35
1. Ronald Stranghoner
2. Edward & Margaret Droessler</p> | <p>ALLEN COUNTY, KANSAS 2009</p> |
|---|--|--|----------------------------------|