



1173310

For KCC Use ONLY

API # 15 - \_\_\_\_\_

### IN ALL CASES PLOT THE INTENDED WELL ON THE PLAT BELOW

In all cases, please fully complete this side of the form. Include items 1 through 5 at the bottom of this page.

Operator: \_\_\_\_\_

Lease: \_\_\_\_\_

Well Number: \_\_\_\_\_

Field: \_\_\_\_\_

Number of Acres attributable to well: \_\_\_\_\_

QTR/QTR/QTR/QTR of acreage: \_\_\_\_\_ - \_\_\_\_\_ - \_\_\_\_\_ - \_\_\_\_\_

Location of Well: County: \_\_\_\_\_

\_\_\_\_\_ feet from  N /  S Line of Section

\_\_\_\_\_ feet from  E /  W Line of Section

Sec. \_\_\_\_\_ Twp. \_\_\_\_\_ S. R. \_\_\_\_\_  E  W

Is Section:  Regular or  Irregular

**If Section is Irregular, locate well from nearest corner boundary.**

Section corner used:  NE  NW  SE  SW

### PLAT

Show location of the well. Show footage to the nearest lease or unit boundary line. Show the predicted locations of lease roads, tank batteries, pipelines and electrical lines, as required by the Kansas Surface Owner Notice Act (House Bill 2032). You may attach a separate plat if desired.

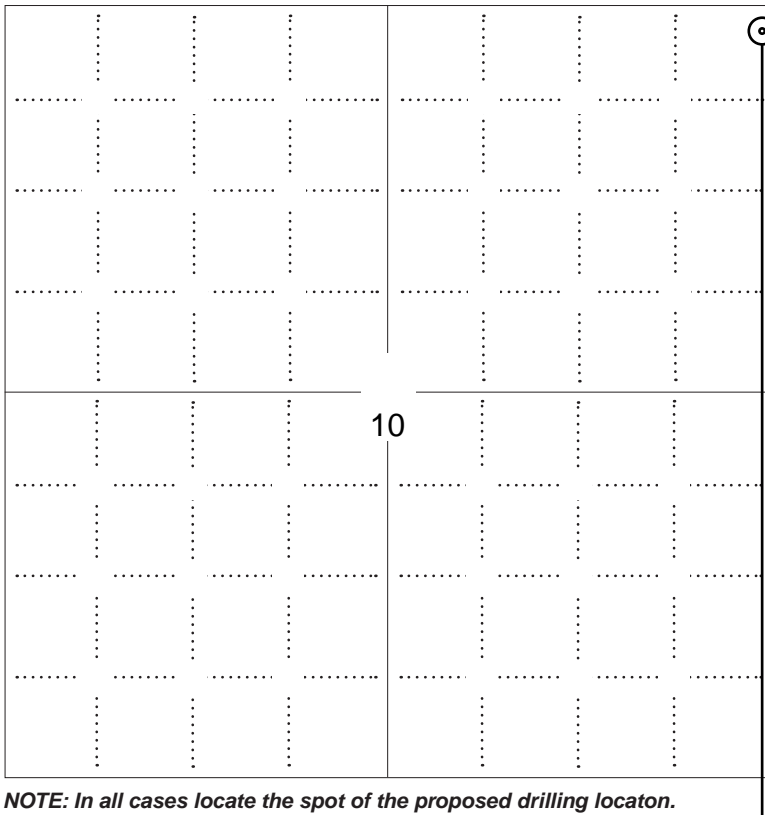

**NOTE: In all cases locate the spot of the proposed drilling locaton.**

70 ft.

### LEGEND

- Well Location
- Tank Battery Location
- Pipeline Location
- Electric Line Location
- Lease Road Location

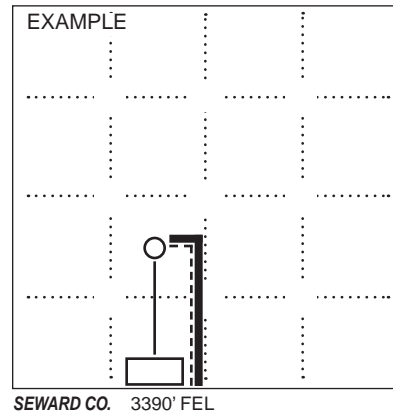

1980' FSL

5100 ft.

### In plotting the proposed location of the well, you must show:

1. The manner in which you are using the depicted plat by identifying section lines, i.e. 1 section, 1 section with 8 surrounding sections, 4 sections, etc.
2. The distance of the proposed drilling location from the south / north and east / west outside section lines.
3. The distance to the nearest lease or unit boundary line (in footage).
4. If proposed location is located within a prorated or spaced field a certificate of acreage attribution plat must be attached: (C0-7 for oil wells; CG-8 for gas wells).
5. The predicted locations of lease roads, tank batteries, pipelines, and electrical lines.

**APPLICATION FOR SURFACE PIT**

*Submit in Duplicate*

Operator Name: _____		License Number: _____	
Operator Address: _____			
Contact Person: _____		Phone Number: _____	
Lease Name & Well No.: _____		Pit Location (QQQQ): _____-_____-_____-_____	
Type of Pit: <input type="checkbox"/> Emergency Pit <input type="checkbox"/> Burn Pit <input type="checkbox"/> Settling Pit <input type="checkbox"/> Drilling Pit <input type="checkbox"/> Workover Pit <input type="checkbox"/> Haul-Off Pit <i>(If WP Supply API No. or Year Drilled)</i>		Pit is: <input type="checkbox"/> Proposed <input type="checkbox"/> Existing If Existing, date constructed: _____ Pit capacity: _____ (bbls)	
Is the pit located in a Sensitive Ground Water Area? <input type="checkbox"/> Yes <input type="checkbox"/> No		Chloride concentration: _____ mg/l <i>(For Emergency Pits and Settling Pits only)</i>	
Is the bottom below ground level? <input type="checkbox"/> Yes <input type="checkbox"/> No		Artificial Liner? <input type="checkbox"/> Yes <input type="checkbox"/> No	
How is the pit lined if a plastic liner is not used? _____			
Pit dimensions (all but working pits): _____ Length (feet)    _____ Width (feet) <input type="checkbox"/> N/A: Steel Pits Depth from ground level to deepest point: _____ (feet) <input type="checkbox"/> No Pit			
If the pit is lined give a brief description of the liner material, thickness and installation procedure.		Describe procedures for periodic maintenance and determining liner integrity, including any special monitoring.	
Distance to nearest water well within one-mile of pit: _____ feet    Depth of water well _____ feet		Depth to shallowest fresh water _____ feet. Source of information: <input type="checkbox"/> measured <input type="checkbox"/> well owner <input type="checkbox"/> electric log <input type="checkbox"/> KDWR	
<b>Emergency, Settling and Burn Pits ONLY:</b> Producing Formation: _____ Number of producing wells on lease: _____ Barrels of fluid produced daily: _____ Does the slope from the tank battery allow all spilled fluids to flow into the pit? <input type="checkbox"/> Yes <input type="checkbox"/> No		<b>Drilling, Workover and Haul-Off Pits ONLY:</b> Type of material utilized in drilling/workover: _____ Number of working pits to be utilized: _____ Abandonment procedure: _____ _____ Drill pits must be closed within 365 days of spud date.	
Submitted Electronically			

<b>KCC OFFICE USE ONLY</b>			
Date Received: _____		Permit Number: _____	
Permit Date: _____		Lease Inspection: <input type="checkbox"/> Yes <input type="checkbox"/> No	
<input type="checkbox"/> Liner		<input type="checkbox"/> Steel Pit <input type="checkbox"/> RFAC <input type="checkbox"/> RFAS	



### CERTIFICATION OF COMPLIANCE WITH THE KANSAS SURFACE OWNER NOTIFICATION ACT

*This form must be submitted with all Forms C-1 (Notice of Intent to Drill); CB-1 (Cathodic Protection Borehole Intent); T-1 (Request for Change of Operator Transfer of Injection or Surface Pit Permit); and CP-1 (Well Plugging Application). Any such form submitted without an accompanying Form KSONA-1 will be returned.*

Select the corresponding form being filed:  C-1 (Intent)  CB-1 (Cathodic Protection Borehole Intent)  T-1 (Transfer)  CP-1 (Plugging Application)

OPERATOR: License # \_\_\_\_\_  
Name: \_\_\_\_\_  
Address 1: \_\_\_\_\_  
Address 2: \_\_\_\_\_  
City: \_\_\_\_\_ State: \_\_\_\_\_ Zip: \_\_\_\_\_ + \_\_\_\_\_  
Contact Person: \_\_\_\_\_  
Phone: ( \_\_\_\_\_ ) \_\_\_\_\_ Fax: ( \_\_\_\_\_ ) \_\_\_\_\_  
Email Address: \_\_\_\_\_

Well Location:  
\_\_\_\_ - \_\_\_\_ - \_\_\_\_ - \_\_\_\_ Sec. \_\_\_\_ Twp. \_\_\_\_ S. R. \_\_\_\_  East  West  
County: \_\_\_\_\_  
Lease Name: \_\_\_\_\_ Well #: \_\_\_\_\_

*If filing a Form T-1 for multiple wells on a lease, enter the legal description of the lease below:*

**Surface Owner Information:**

Name: \_\_\_\_\_  
Address 1: \_\_\_\_\_  
Address 2: \_\_\_\_\_  
City: \_\_\_\_\_ State: \_\_\_\_\_ Zip: \_\_\_\_\_ + \_\_\_\_\_

*When filing a Form T-1 involving multiple surface owners, attach an additional sheet listing all of the information to the left for each surface owner. Surface owner information can be found in the records of the register of deeds for the county, and in the real estate property tax records of the county treasurer.*

*If this form is being submitted with a Form C-1 (Intent) or CB-1 (Cathodic Protection Borehole Intent), you must supply the surface owners and the KCC with a plat showing the predicted locations of lease roads, tank batteries, pipelines, and electrical lines. The locations shown on the plat are preliminary non-binding estimates. The locations may be entered on the Form C-1 plat, Form CB-1 plat, or a separate plat may be submitted.*

**Select one of the following:**

- I certify that, pursuant to the Kansas Surface Owner Notice Act (House Bill 2032), I have provided the following to the surface owner(s) of the land upon which the subject well is or will be located: 1) a copy of the Form C-1, Form CB-1, Form T-1, or Form CP-1 that I am filing in connection with this form; 2) if the form being filed is a Form C-1 or Form CB-1, the plat(s) required by this form; and 3) my operator name, address, phone number, fax, and email address.
- I have not provided this information to the surface owner(s). I acknowledge that, because I have not provided this information, the KCC will be required to send this information to the surface owner(s). To mitigate the additional cost of the KCC performing this task, I acknowledge that I am being charged a \$30.00 handling fee, payable to the KCC, which is enclosed with this form.

*If choosing the second option, submit payment of the \$30.00 handling fee with this form. If the fee is not received with this form, the KSONA-1 form and the associated Form C-1, Form CB-1, Form T-1, or Form CP-1 will be returned.*

I Submitted Electronically

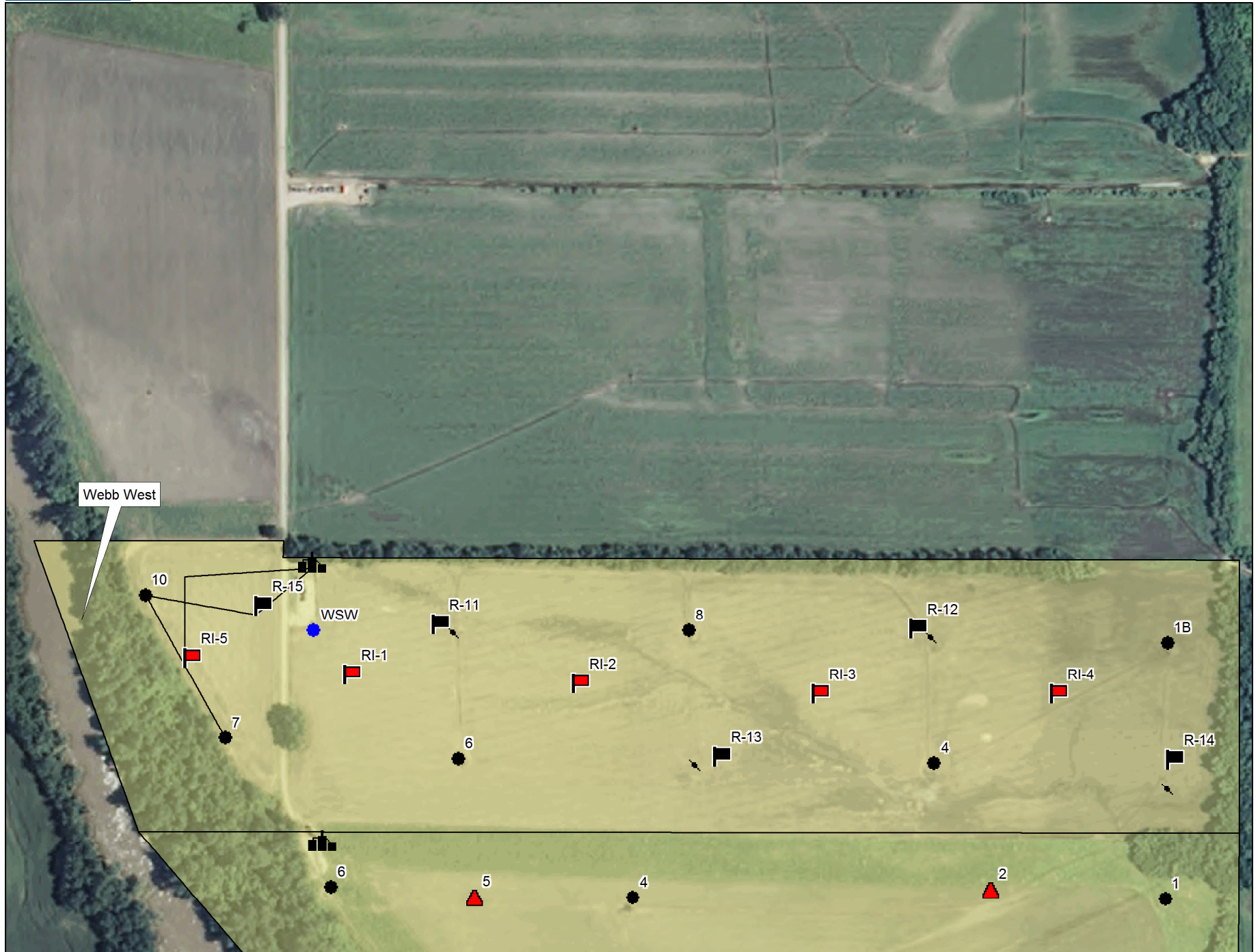

Data use subject to license.

© DeLorme. Topo North America™ 9.

www.delorme.com

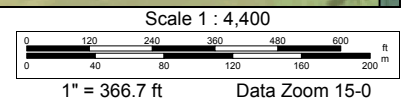

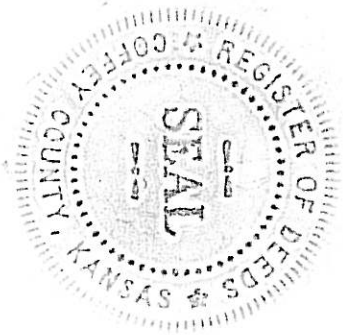

STATE OF KANSAS, COFFEY COUNTY, SS  
Gwen R. Birk, Register of Deeds

Book: 0641 Page: 320

Pages Recorded: 7

Recording Fee: \$32.00

Date Recorded: 2/3/2012 3:15:00 PM

1/1 ✓

## ASSIGNMENT OF OIL AND GAS LEASE

KNOW ALL MEN BY THESE PRESENTS:

That the undersigned, Alpine Resources Corporation, a Missouri corporation, hereinafter called Assignor, for and in consideration of One Dollar (\$1.00) and other valuable consideration, the receipt and sufficiency whereof is acknowledged, does hereby sell, assign, transfer and set over unto D. E. Exploration Inc., a Kansas corporation, hereinafter called Assignee, an undivided one-half (1/2) Working Interest in and to the following oil and gas leases located in Coffey County, Kansas:

SEE EXHIBIT A

together with the rights incident thereto and the personal property thereon, appurtenant thereto, or used or obtained in connection therewith.

TO HAVE AND TO HOLD the rights, titles and interests hereby conveyed and assigned, together with all and singular the rights, privileges and appurtenances thereto in any way belonging to the said Assignors, their personal representatives, successors and assigns, forever.

THIS ASSIGNMENT is made without warranties, either express or implied.

EXECUTED this 2<sup>nd</sup> day of January, 2012.

THIS ASSIGNMENT is effective January 1, 2012, regardless of the day of execution.

ALPINE RESOURCES CORPORATION

By: Paul J. Dewees  
Paul J. Dewees, President

STATE OF Kansas )  
 )ss:  
COUNTY OF Franklin )

ACKNOWLEDGMENT

BE IT REMEMBERED that on this 2<sup>nd</sup> day of January, 2012, before me a Notary Public, duly appointed in the state aforesaid, came Paul J. Dewees, President of Alpine Resources Corporation, a Missouri corporation, personally known to me to be such officer and to be the same person who executed as such officer the foregoing instrument of writing in behalf of said corporation and he duly acknowledged the execution of the same for himself and for said corporation for the uses and purposes therein set forth.

IN WITNESS WHEREOF, I have hereunto set my hand and official seal on the day and year last above written.

Stacy J. Thyer Notary Public

Appointment/Commission Expires:

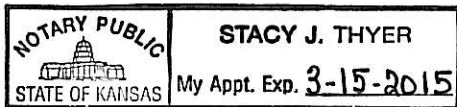

## EXHIBIT A

### STROUD A LEASE

Dated: November 22, 1976  
Filed: February 26, 1981  
Recorded: Book 25 O&G, Pages 537-538  
Lessor: L. E. Stroud and Katherine E. Stroud, his wife  
Lessee: Betty L. Winn  
Legal Description: The Northwest Quarter (NW/4) and the Northwest Quarter of the Southwest Quarter (NW/4 SW/4), Section 27, Township 22S, Range 16E, Coffey County, Kansas

### STROUD B LEASE

Dated: June 26, 1992  
Filed: June 30, 1992  
Recorded: Book 31 O&G, Pages 509-510  
Lessor: L. E. Stroud  
Lessee: J. R. Enterprises  
Legal Description: East Half of the Southwest Quarter (E/2 SW/4), Section 27, Township 22S, Range 16E, Coffey County, Kansas

### NELSON MOTORS LEASE

Dated: October 18, 1982  
Filed: November 8, 1982  
Recorded: Book 27 O&G, Pages 565-566  
Lessor: Nelson Motors, Inc.  
Lessee: Lincoln 77, a partnership composed of Jack E. Bock and Roland L. Meyer  
Legal Description: Northeast Quarter (NE/4) less the South two (2) rods thereof of Section 33, Township 22S, Range 16E, Coffey County, Kansas

### POHLENZ LEASE

Dated: May 17, 1982  
Filed: May 17, 1982  
Recorded: Book 27 O&G, Pages 386-387  
Lessor: Dale F. Pohlenz and Laina E. Pohlenz, his wife  
Lessee: Dale L. Reinker and Kenneth R. Winn  
Legal Description: The Southeast Quarter (SE/4) of Section 27, Township 22S, Range 16E, Coffey County, Kansas

### STRAWDER LEASE

Dated: October 26, 1981  
Filed: November 9, 1981  
Recorded: Book 27 O&G, Pages 66-67  
Lessor: Edward Strawder and Joy Strawder, husband and wife  
Lessee: Elmer Gleue, John R. Folk and James L. Folk d/b/a Triangle Oil Co.  
Legal Description: The North Half of the Northeast Quarter (N/2 NE/4) of Section 1, Township 23S, Range 16E, Coffey County, Kansas



ELMER GLEUE LEASE

Dated: October 1, 1978  
Filed: October 13, 1978  
Recorded: Book 22 O&G, Pages 246-247  
Lessor: Elmer A. Gleue and Illa Rhue Gleue, husband and wife  
Lessee: Elmer A. Gleue and John R. Folk d/b/a G&F Oil Co.  
Legal Description: The Southwest Quarter (SW/4) and the West 85 acres of the South 115 acres of the Southeast Quarter (SE/4) of Section 36, Township 22S, Range 16E, Coffey County, Kansas

GLEUE-JET LEASE

Dated: July 1, 1980  
Filed: August 13, 1980  
Recorded: Book 24 O&G, Pages 346-347  
Lessor: Elmer A. Gleue and Illa Rhue Gleue, husband and wife  
Lessee: James L. Folk, John R. Folk and Elmer Gleue d/b/a Jet Oil Co.  
Legal Description: The North Half of the Southwest Quarter (N/2 SW/4) of Section 18, Township 23S, Range 17E, Coffey County, Kansas

J. WRIGHT LEASE

Dated: February 24, 1977  
Filed: February 24, 1977  
Recorded: Book 21 O&G, Pages 28-29  
Lessor: Juanita M. Wright, a widow and now not married  
Lessee: D. J. Schmidt  
Legal Description: The South Half of the Northeast Quarter (S/2 NE/4) of Section 21, Township 22S, Range 16E, Coffey County, Kansas

FREEMAN LEASE

Dated: October 15, 1986  
Filed: October 17, 1986  
Recorded: Book 29 O&G, Pages 639-641  
Lessor: Bill Freeman and Joan Freeman, husband and wife  
Lessee: Petro 85 - Bill Freeman LTD.  
Legal Description: A tract commencing 50 rods South of the Northwest corner of the NW/4 of Section 11-23S-16E; thence running East 160 rods; thence South 36 rods; thence West to the center of the Neosho River; thence up the center of the Neosho River to a point 50 rods South of the North line of the NE/4 of Section 10-23S-16E, thence East to the place of beginning, containing 40 acres, more or less, and a tract of land beginning at a stake in the center of Crooked Creek at the point where the line between the Northwest Quarter (NW/4) and the Northeast Quarter (NE/4) of Section 11, Township 23S, Range 16E crosses said Creek; thence North Twenty and Sixteen Twenty-fifths (20 & 16/25) rods; thence West 143 rods to the center of the Neosho River; thence Southeasterly along the center of said river 52 rods to a point in line with the center of Crooked Creek where it empties into the Neosho River; thence in an Easterly direction along the center of said Crooked Creek to the place of beginning, containing Twenty-nine and one-tenths (29 & 1/10) acres, more or less

FLAKE LEASE

Dated: February 27, 1976  
Filed: May 7, 1976  
Recorded: Book 20 O&G, Pages 156-158  
Lessor: Erven L. Flake, Jr., and his wife Betty Flake; Eloise Hamman, a widow; Vivian Henkle and her husband, Max A. Henkle  
Lessee: Quaker Drilling Co., Inc.  
Legal Description: The Northeast Quarter (NE/4) of Section 28, Township 22S, Range 16E, Coffey County, Kansas

GLEUE #2 (GLEUE NORTH) LEASE

Dated: June 3, 1976  
Filed: June 8, 1976  
Recorded: Book 20 O&G, Pages 196-197  
Lessor: Helmuth A. Gleue and Louise R. Gleue  
Lessee: D. J. Schmidt  
Legal Description: The Southeast Quarter of Section 21, Township 22S, Range 16E, Coffey County, Kansas

MCGINNIS LEASE

Dated: July 9, 1953  
Filed: September 1, 1953  
Recorded: Book 8, Page 406  
Lessor: Ruth McGinnis  
Lessee: Harold G. Kramer  
Legal Description: The East Half of the Southwest Quarter (E/2 SW/4) and the Southwest Quarter of the Northeast Quarter (SW/4 NE/4) of Section 1, Township 23S, Range 16E, Coffey County, Kansas

MEATS LEASE

Dated: July 2, 1953  
Filed: September 10, 1953  
Recorded: Book 8, Page 410  
Lessor: W. D. Meats and May Meats, his wife  
Lessee: Harold Kramer  
Legal Description: The West Half of the Southwest Quarter (W/2 SW/4) of Section 1, Township 23S, Range 16E, containing 80 acres, more or less; and a tract commencing at the southwest corner of the Northwest Quarter of Section 1, Township 23S, Range 16E, thence running north 12 ½ rods, thence east 25 rods, thence southe 12 ½ rods, thence west to place of beginning, containing 2 acres, more or less; all of the above containing 82 acres, more or less, Coffey County, Kansas

WEBB WEST LEASE

Dated: January 10, 1980  
Filed: January 31, 1980  
Recorded: Book 22 O&G, Pages 612-613  
Lessor: Nelson Webb  
Lessee: Lincoln 77, a partnership composed of Jack E. Bock and Roland L. Meyer  
Legal Description: A tract commencing at the Northwest corner of the Northwest Quarter (NW/4) of Section 11, Township 23S, Range 16E, thence South 3 ½ Rods, thence East 160 Rods, thence South 46 ½ Rods, thence West to Center of the Neosho River, thence up Center of the Channel of said River to the North Section line of Section 10, Township 23S, Range 16E, thence East to place of beginning, Coffey County, Kansas

WINN (KENNETH) LEASE

Dated: May 31, 1985  
Filed: June 10, 1985  
Recorded: Book 29 O&G, Pages 322-323  
Lessor: Kenneth B. Winn and Betty L. Winn  
Lessee: Winn Oil Company  
Legal Description: The North Half of the Northwest Quarter (N/2 NW/4) of Section 12, Township 23S, Range 16E, Coffey County, Kansas

JOHNSON LEASE (3 LEASES)

Lease 1

Dated: April 20, 1976  
Filed: March 11, 1980  
Recorded: Book 22 O&G, Pages 658-660  
Lessor: Roy D. Johnson and Theresa Johnson, his wife; Donald R. Johnson and Virginia Johnson, his wife; and Eugene F. Johnson and Mildred Johnson, his wife  
Lessee: Howard E. Vanderman  
Legal Description: A tract of land in the Southeast Quarter of Section 33, Township 22S, Range 16E described as follows: Beginning at a point 377 ½ feet West and 30 feet North of The Southeast corner of said Section 33; thence running North 1505 feet to the South line of the right-of-way of the Missouri Pacific Railroad; thence running in a Southwesterly direction along said right-of-way 1470 feet; thence South 1187 feet; thence East 1445 feet to the place of beginning and containing 45 acres more or less.

Lease 2

Dated: October 1, 1978  
Filed: August 2, 1979  
Recorded: Book 22 O&G, Pages 503-505  
Lessor: Roy D. Johnson and Theresa Johnson, his wife; Donald R. Johnson and Virginia Johnson, his wife; and Eugene F. Johnson and Mildred Johnson, his wife  
Lessee: Howard E. Vanderman  
Legal Description: A tract of land beginning at the Southwest corner of the Southeast Quarter (SE/4) of Section 33, Township 22S, Range 16E; thence running East 12 ½ chains; thence North to the South line of the Missouri Pacific Railway right-of-way; thence in a Southwesterly direction along the South line of said right-of-way to the West line of the Southeast Quarter (SE/4) of said Section 33 to the place of beginning, containing 20 acres more or less.

Lease 3

Dated: June 9, 1980

Filed: June 9, 1980

Recorded: Book 23 O&G, pages 521-523

Lessor: Martin D. Luther and Shirley A. Luther

Lessee: Robert S. Vanderman

Legal Description: A tract of land in the Southeast Quarter (SE/4) of Section 33, Township 22S, Range 16E, described as follows: Beginning at a point 30 feet North of the Southeast corner of said Section 33; thence running West 377 ½ feet; thence North 1505 feet to the South line of the right-of-way of the Missouri Pacific Railroad; thence Northeast along the South line of said right-of-way to the section line; thence South to the place of beginning.

Conservation Division  
Finney State Office Building  
130 S. Market, Rm. 2078  
Wichita, KS 67202-3802



Phone: 316-337-6200  
Fax: 316-337-6211  
<http://kcc.ks.gov/>

Mark Sievers, Chairman  
Thomas E. Wright, Commissioner  
Shari Feist Albrecht, Commissioner

Sam Brownback, Governor

December 17, 2013

Phil Frick  
D. E. Exploration, Inc.  
PO BOX 128  
WELLSVILLE, KS 66092-0128

Re: Drilling Pit Application  
API 15-031-23784-00-00  
Webb R-15  
NE/4 Sec.10-23S-16E  
Coffey County, Kansas

Dear Phil Frick:

District staff has inspected the above referenced location and has determined that the reserve pit shall be constructed **without slots**, the bottom shall be flat and reasonably level, and the free fluids must be removed. The fluids are to be removed from the reserve pit as soon as practical after drilling operations have ceased.

**If production casing is set all completion fluids shall be removed from the working pits daily. NO completion fluids or non-exempt wastes shall be placed in the reserve pit.**

The fluids should be taken to an authorized disposal well. Please file form CDP-5, Exploration and Production Waste Transfer, through KOLAR within 30 days of fluid removal.

**A copy of this letter should be posted in the doghouse along with the approved Intent to Drill.** If you have any questions or concerns please feel free to contact the District Office at (620) 432-2300.