

Proposed Plan of Construction
 Hicks H-1
 Sec 17 T25S-R32W
 Finney County, KS

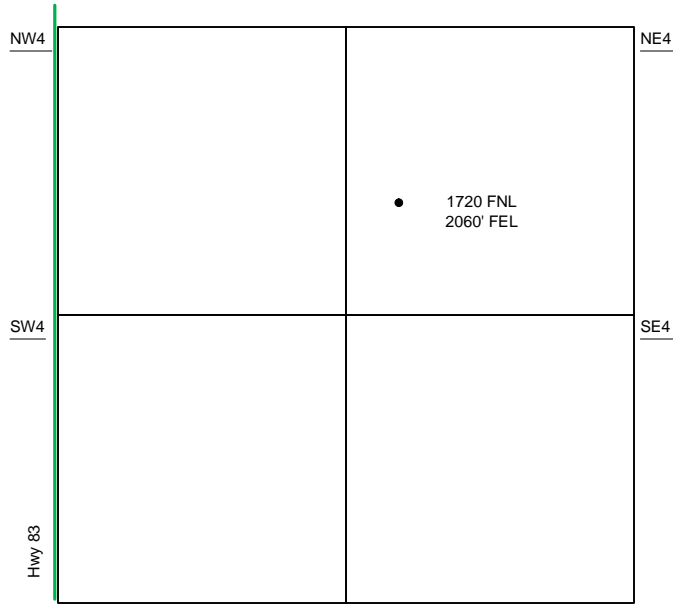

Sec 17 – T25S – R32W

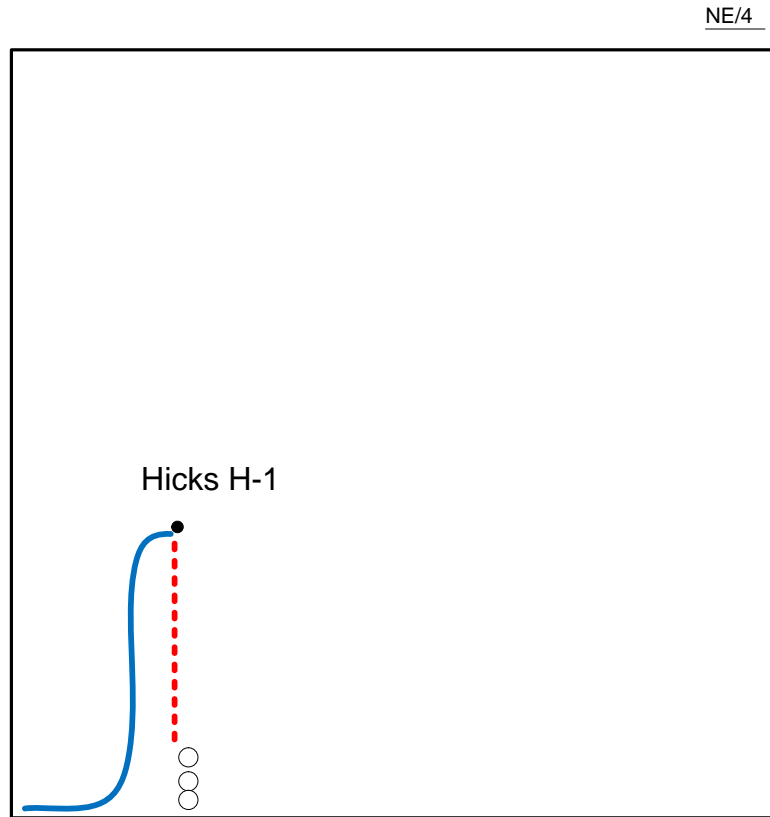

The Tank Battery for the Hicks H-1 is located in the SW of the NE quarter

Proposed Details of
 NE/4 Sec 17-T25S -R32W

Note-Drawing **Not** to Scale

Proposed Site Diagram
 Hicks H-1
 December 9, 2013

