

C & K OIL COMPANY
BARCLAY LEASE
SW.1/4, SECTION 6, T16S, R10W
ELLSWORTH COUNTY, KANSAS

ND ROAD

Notes:

1. Set (2) wood stakes at location site.
2. All flagging Red & Yellow.
3. Overhead power available at S. & E. lines, Sec.6.
4. Kansas One Call System Inc. should be notified before excavation (1-800-344-7233).
5. CAUTION; Various pipelines in Sec.6.
6. Section 6 is irregular N-S.
7. Contact landowner for best access.
8. Location fell approximately 95' east of a N-S overhead electric line and 80' east of a N-S lease road, no alternate set per instructions.

ROAD (1ST ROAD)

PAVED

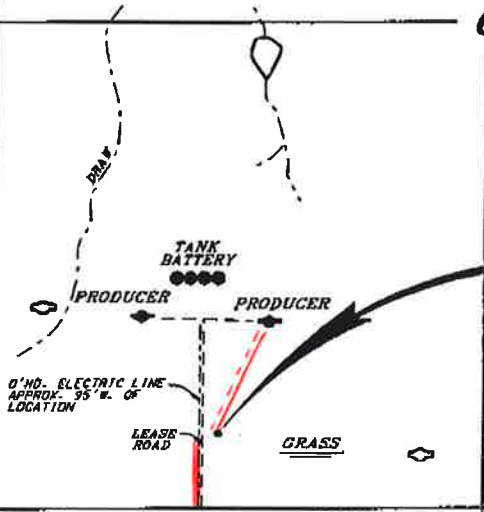

Drillsite Location
Barclay #4
450'FSL 1250'FWL
Ground Elevation = 1864
Y = 127618 X = 1864344
State Plane-NAD 27-Kansas North
(Mapping Grade GPS Used)

GRAVEL (AVENUE N) ROAD

ROAD (2ND ROAD)

GRAVEL

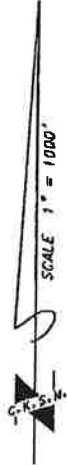

*Ingress and egress to location as shown on this plot is per usage only and may not be legally opened for public use. Contact landowner, tenant and county road department for access.

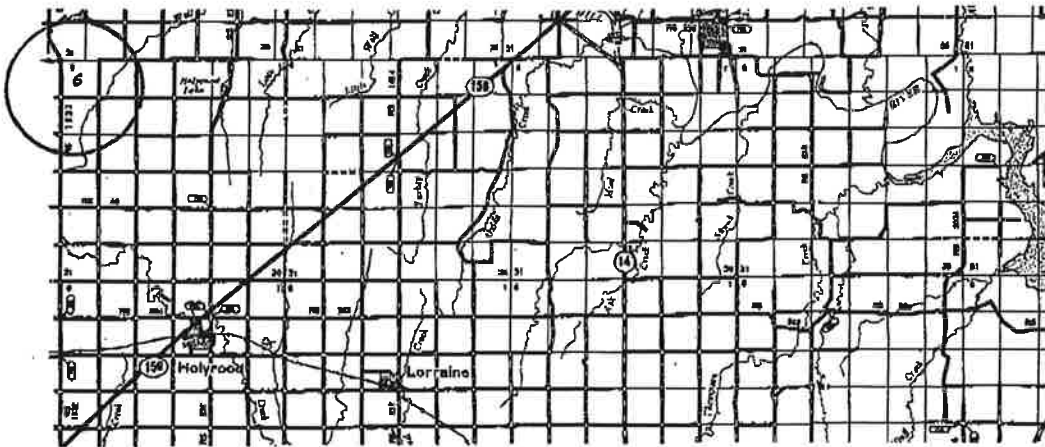

- Controlling data is based upon the best maps and photographs available to us and upon a regular section of land containing 640 acres.
- Approximate section lines were determined using the normal standard of care of oilfield surveyors practicing in the state of Kansas. The section corners, which establish the precise section lines, were not necessarily located, and the exact location of the drillsite location in the section is not guaranteed. Therefore, the operator securing this service and occupying this plot and all other parties relying thereon agree to hold Central Kansas Oilfield Services, Inc., its officers and employees harmless from all losses, costs and expenses and said entities released from any liability from incidental or consequential damages.
- Elevations derived from National Geodetic Vertical Datum.

Date November 27, 2013