

LAVETA OIL & GAS
 GATTON LEASE
 NW. 1/4, SECTION 29, T22S, R11W
 STAFFORD COUNTY, KANSAS

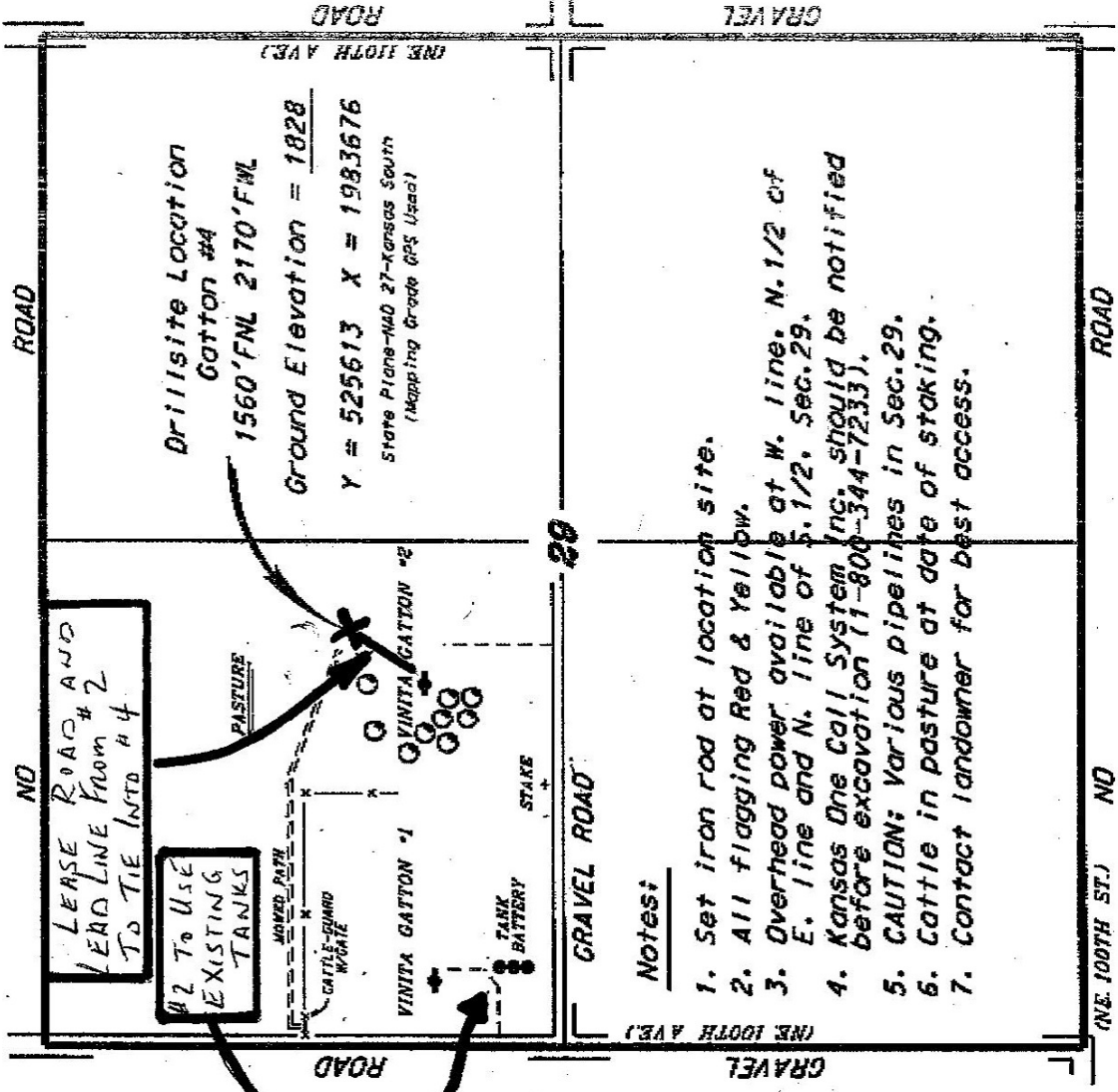

Drill site Location
 Gotton #4
 1560' FNL 2170' FNL
 Ground Elevation = 1828
 Y = 525613 X = 1983676
 State Plane-NAD 27-Kansas South
 (Mapping Grade GPS Used)

Notes:

1. Set iron rod at location site.
2. All flagging Red & Yellow.
3. Overhead power available at W. line, N. 1/2 of E. line and N. line of S. 1/2, Sec. 29.
4. Kansas One Call System Inc. should be notified before excavation (1-800-344-7233).
5. CAUTION: Various pipelines in Sec. 29.
6. Cattle in pasture at date of staking.
7. Contact landowner for best access.

*Ingress and egress to location as shown on this plat is per usage only and may not be legally opened for public use. Contact landowner, tenant and county road department for access.

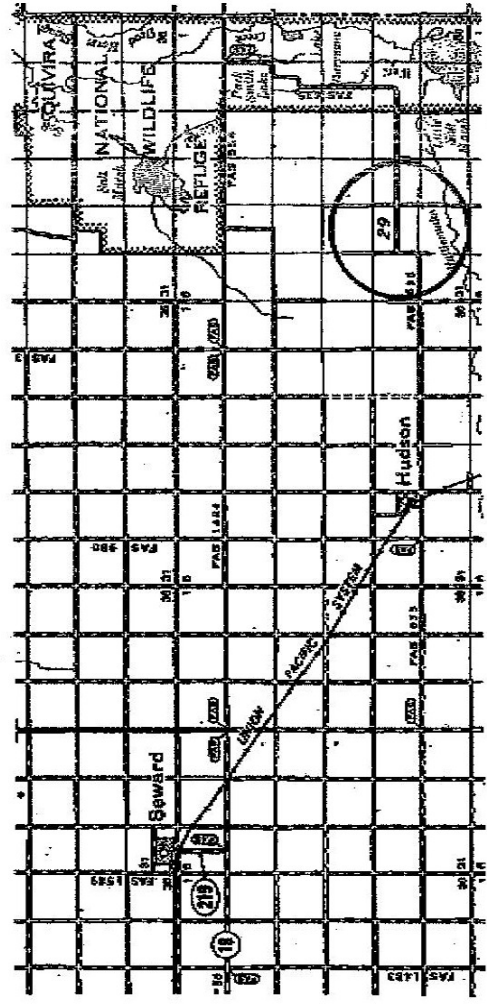

* Controlling data is based upon the best maps and photographs available to us and used a regular section of land containing 360 acres.
 * Survey/lease section lines were determined using the normal standard of care of oilfield surveyors practicing in the state of Kansas. The section corners, which establish the precise section lines, were not located. The location of the section corners was determined using the best available aerial photography and existing maps and other information available to us. The location of the section corners was determined using the best available aerial photography and other information available to us. The location of the section corners was determined using the best available aerial photography and other information available to us.
 * Classifications derived from horizontal geodetic vertical datum.