

R 31 W

T
16
S

19

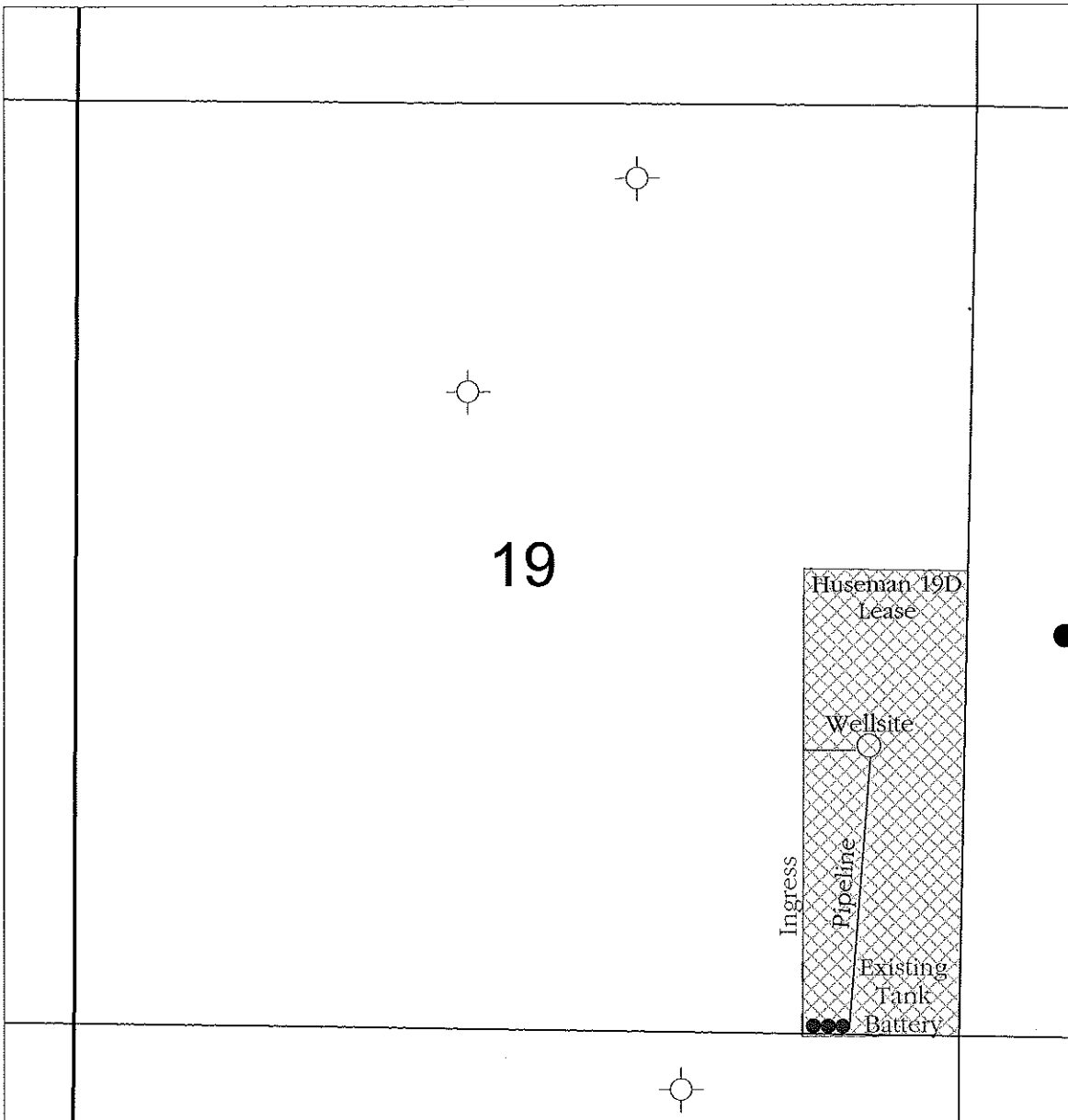

SCALE = 1 :12,000

SCOTT COUNTY, KANSAS

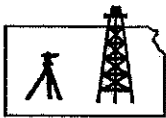

Pro-Stake LLC
 Oil Field & Construction Site Staking
 P.O. Box 2324
 Garden City, Kansas 67846
 Office/Fax: (620) 276-6159
 Cell: (620) 272-1499
 burt@pro-stakelle.kscocxmail.com

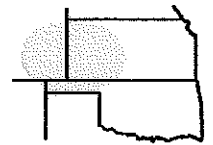

351532
 PLAT NO.

11505
 INVOICE NO.

Ritchie Exploration, Inc.

#1 Huseman 19D

OPERATOR

LEASE NAME

Scott County, KS
 COUNTY

19 16s 31w
 Sec. Twp. Rng.

1635' FSL - 540' FEL
 LOCATION SPOT

SCALE: 1" = 1000'
 DATE STAKED: Jan 28th, 2014
 MEASURED BY: Kent C.
 DRAWN BY: Norby S.
 AUTHORIZED BY: Justin C.

GR. ELEVATION: 2946.8'



Directions: From the East side of Healy, KS at the intersection of Hwy 4 and Cottonwood St. - Now go West 10 miles on Hwy 4 - Now go North 3 miles on Rodeo Rd. to the SW section corner of 19-16s-31w - Now go 0.9 miles East on Rd. 260 to ingress stake North into - Now go North 1635' through wheat stubble into staked location
Final ingress must be verified with land owner or Operator

This drawing does not constitute a monumented survey or a land survey plat This drawing is for construction purposes only

