

# ADVANTAGE ELEVATIONS

OIL FIELD SURVEYORS

BOX 8604 - PRATT, KS 67124  
(620) 672-6491

1125132  
INVOICE NO.

R & B OIL & GAS  
OPERATOR

1 /  
NO.

DOHM B  
FARM

Barber COUNTY      23 S      32s T      10w R

990' FSL & 2310' FEL of Sec.  
LOCATION

ELEVATION: 1438' GR



R & B OIL & GAS  
PO BOX 195  
Attica, KS 67009-0195

AUTHORIZED BY: Jane

SCALE: 1" = 1000'

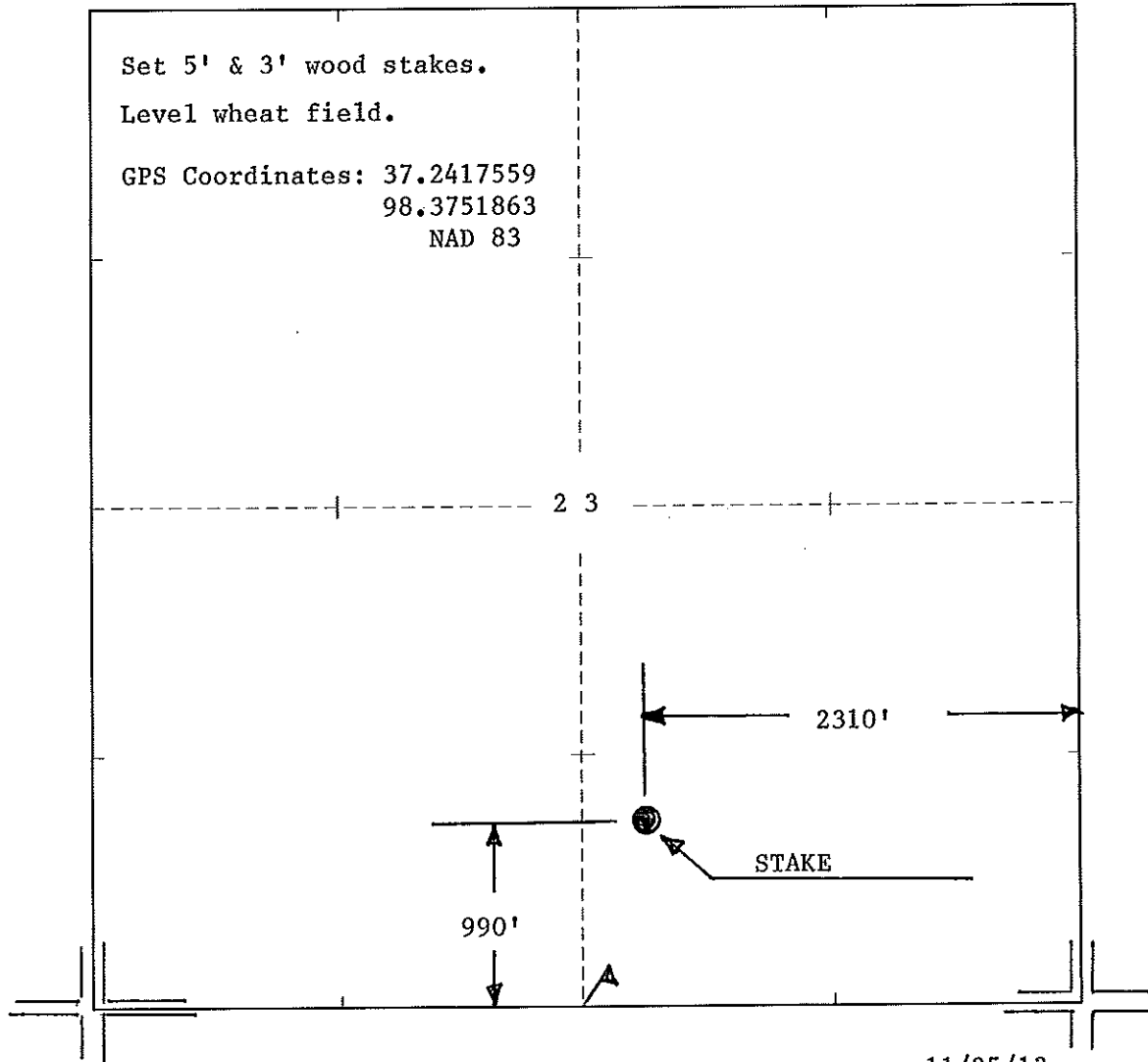

DATE STAKED: 11/25/13