



KANSAS CORPORATION COMMISSION
OIL & GAS CONSERVATION DIVISION

1181301

Form C-1

March 2010

Form must be Typed
Form must be Signed
All blanks must be Filled

For KCC Use:

Effective Date: _____

District #: _____

SGA? ☐ Yes ☐ No

NOTICE OF INTENT TO DRILL

Must be approved by KCC five (5) days prior to commencing well

Form KSONA-1, Certification of Compliance with the Kansas Surface Owner Notification Act, MUST be submitted with this form.

Expected Spud Date: _____
month day year

OPERATOR: License# _____

Name: _____

Address 1: _____

Address 2: _____

City: _____ State: _____ Zip: _____ + _ _ _

Contact Person: _____

Phone: _____

CONTRACTOR: License# _____

Name: _____

Well Drilled For:

Well Class:

Type Equipment:

<input type="checkbox"/> Oil	<input type="checkbox"/> Enh Rec	<input type="checkbox"/> Infield	<input type="checkbox"/> Mud Rotary
<input type="checkbox"/> Gas	<input type="checkbox"/> Storage	<input type="checkbox"/> Pool Ext.	<input type="checkbox"/> Air Rotary
	<input type="checkbox"/> Disposal	<input type="checkbox"/> Wildcat	<input type="checkbox"/> Cable

☐ Seismic ; _____ # of Holes☐ Other: _____☐ If OWWO: old well information as follows:

Operator: _____

Well Name: _____

Original Completion Date: _____ Original Total Depth: _____

Directional, Deviated or Horizontal wellbore? ☐ Yes ☐ No

If Yes, true vertical depth: _____

Bottom Hole Location: _____

KCC DKT #: _____

Spot Description: _____

_____ - _____ - _____ Sec. _____ Twp. _____ S. R. _____ ☐ E ☐ W
(Q/Q/Q/Q)_____ feet from ☐ N / ☐ S Line of Section_____ feet from ☐ E / ☐ W Line of SectionIs SECTION: ☐ Regular ☐ Irregular?

(Note: Locate well on the Section Plat on reverse side)

County: _____

Lease Name: _____ Well #: _____

Field Name: _____

Is this a Prorated / Spaced Field? ☐ Yes ☐ No

Target Formation(s): _____

Nearest Lease or unit boundary line (in footage): _____

Ground Surface Elevation: _____ feet MSL

Water well within one-quarter mile: ☐ Yes ☐ NoPublic water supply well within one mile: ☐ Yes ☐ No

Depth to bottom of fresh water: _____

Depth to bottom of usable water: _____

Surface Pipe by Alternate: ☐ I ☐ II

Length of Surface Pipe Planned to be set: _____

Length of Conductor Pipe (if any): _____

Projected Total Depth: _____

Formation at Total Depth: _____

Water Source for Drilling Operations:

☐ Well ☐ Farm Pond ☐ Other: _____

DWR Permit #: _____

(Note: Apply for Permit with DWR ☐)Will Cores be taken? ☐ Yes ☐ No

If Yes, proposed zone: _____

AFFIDAVIT

The undersigned hereby affirms that the drilling, completion and eventual plugging of this well will comply with K.S.A. 55 et. seq.

It is agreed that the following minimum requirements will be met:

1. Notify the appropriate district office **prior** to spudding of well;
2. A copy of the approved notice of intent to drill **shall be** posted on each drilling rig;
3. The minimum amount of surface pipe as specified below **shall be set** by circulating cement to the top; in all cases surface pipe **shall be set** through all unconsolidated materials plus a minimum of 20 feet into the underlying formation.
4. If the well is dry hole, an agreement between the operator and the district office on plug length and placement is necessary **prior to plugging**;
5. The appropriate district office will be notified before well is either plugged or production casing is cemented in;
6. If an ALTERNATE II COMPLETION, production pipe shall be cemented from below any usable water to surface within **120 DAYS** of spud date. Or pursuant to Appendix "B" - Eastern Kansas surface casing order #133,891-C, which applies to the KCC District 3 area, alternate II cementing must be completed within 30 days of the spud date or the well shall be plugged. **In all cases, NOTIFY district office** prior to any cementing.

Submitted Electronically

For KCC Use ONLY

API # 15 - _____

Conductor pipe required _____ feet

Minimum surface pipe required _____ feet per ALT. ☐ I ☐ II

Approved by: _____

This authorization expires: _____

(This authorization void if drilling not started within 12 months of approval date.)

Spud date: _____ Agent: _____

Remember to:

- File Certification of Compliance with the Kansas Surface Owner Notification Act (KSONA-1) with Intent to Drill;
- File Drill Pit Application (form CDP-1) with Intent to Drill;
- File Completion Form ACO-1 within 120 days of spud date;
- File acreage attribution plat according to field proration orders;
- Notify appropriate district office 48 hours prior to workover or re-entry;
- Submit plugging report (CP-4) after plugging is completed (within 60 days);
- Obtain written approval before disposing or injecting salt water.
- If well will not be drilled or permit has expired (See: authorized expiration date) please check the box below and return to the address below.

☐ Well will not be drilled or Permit Expired Date: _____

Signature of Operator or Agent: _____

Mail to: KCC - Conservation Division,
130 S. Market - Room 2078, Wichita, Kansas 67202

☐ E
☐ W

For KCC Use ONLY

API # 15 - _____

IN ALL CASES PLOT THE INTENDED WELL ON THE PLAT BELOW

In all cases, please fully complete this side of the form. Include items 1 through 5 at the bottom of this page.

Operator: _____

Lease: _____

Well Number: _____

Field: _____

Number of Acres attributable to well: _____

QTR/QTR/QTR/QTR of acreage: _____ - _____ - _____ - _____

Location of Well: County: _____

_____ feet from ☐ N / ☐ S Line of Section_____ feet from ☐ E / ☐ W Line of SectionSec. _____ Twp. _____ S. R. _____ ☐ E ☐ WIs Section: ☐ Regular or ☐ Irregular**If Section is Irregular, locate well from nearest corner boundary.**Section corner used: ☐ NE ☐ NW ☐ SE ☐ SW**PLAT**

Show location of the well. Show footage to the nearest lease or unit boundary line. Show the predicted locations of lease roads, tank batteries, pipelines and electrical lines, as required by the Kansas Surface Owner Notice Act (House Bill 2032). You may attach a separate plat if desired.

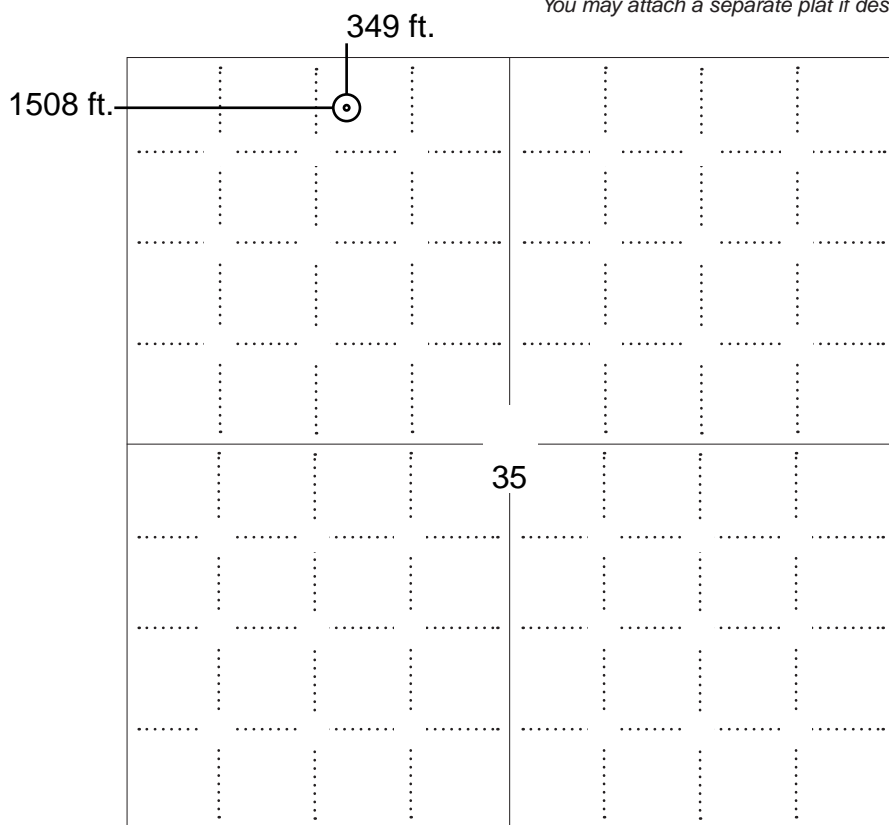
**LEGEND**

- ☐ Well Location
- ☐ Tank Battery Location
- ☐ Pipeline Location
- ☐ Electric Line Location
- ☐ Lease Road Location

**NOTE: In all cases locate the spot of the proposed drilling location.****In plotting the proposed location of the well, you must show:**

1. The manner in which you are using the depicted plat by identifying section lines, i.e. 1 section, 1 section with 8 surrounding sections, 4 sections, etc.
2. The distance of the proposed drilling location from the south / north and east / west outside section lines.
3. The distance to the nearest lease or unit boundary line (in footage).
4. If proposed location is located within a prorated or spaced field a certificate of acreage attribution plat must be attached: (C0-7 for oil wells; CG-8 for gas wells).
5. The predicted locations of lease roads, tank batteries, pipelines, and electrical lines.

**APPLICATION FOR SURFACE PIT***Submit in Duplicate*

Operator Name:		License Number:	
Operator Address:			
Contact Person:		Phone Number:	
Lease Name & Well No.:		Pit Location (QQQQ): ____ - ____ - ____ - ____ Sec. ____ Twp. ____ R. ____ <input type="checkbox"/> East <input type="checkbox"/> West ____ Feet from <input type="checkbox"/> North / <input type="checkbox"/> South Line of Section ____ Feet from <input type="checkbox"/> East / <input type="checkbox"/> West Line of Section ____ County	
Type of Pit: <input type="checkbox"/> Emergency Pit <input type="checkbox"/> Burn Pit <input type="checkbox"/> Settling Pit <input type="checkbox"/> Drilling Pit <input type="checkbox"/> Workover Pit <input type="checkbox"/> Haul-Off Pit <i>(If WP Supply API No. or Year Drilled)</i>	Pit is: <input type="checkbox"/> Proposed <input type="checkbox"/> Existing If Existing, date constructed: _____ Pit capacity: _____ (bbls)		
Is the pit located in a Sensitive Ground Water Area? <input type="checkbox"/> Yes <input type="checkbox"/> No		Chloride concentration: _____ mg/l <i>(For Emergency Pits and Settling Pits only)</i>	
Is the bottom below ground level? <input type="checkbox"/> Yes <input type="checkbox"/> No	Artificial Liner? <input type="checkbox"/> Yes <input type="checkbox"/> No	How is the pit lined if a plastic liner is not used?	
Pit dimensions (all but working pits): _____ Length (feet) _____ Width (feet) <input type="checkbox"/> N/A: Steel Pits Depth from ground level to deepest point: _____ (feet) <input type="checkbox"/> No Pit			
If the pit is lined give a brief description of the liner material, thickness and installation procedure.		Describe procedures for periodic maintenance and determining liner integrity, including any special monitoring.	
Distance to nearest water well within one-mile of pit: _____ feet Depth of water well _____ feet		Depth to shallowest fresh water _____ feet. Source of information: <input type="checkbox"/> measured <input type="checkbox"/> well owner <input type="checkbox"/> electric log <input type="checkbox"/> KDWR	
Emergency, Settling and Burn Pits ONLY: Producing Formation: _____ Number of producing wells on lease: _____ Barrels of fluid produced daily: _____ Does the slope from the tank battery allow all spilled fluids to flow into the pit? <input type="checkbox"/> Yes <input type="checkbox"/> No		Drilling, Workover and Haul-Off Pits ONLY: Type of material utilized in drilling/workover: _____ Number of working pits to be utilized: _____ Abandonment procedure: _____ Drill pits must be closed within 365 days of spud date.	
Submitted Electronically			

KCC OFFICE USE ONLY
☐ Liner ☐ Steel Pit ☐ RFAC ☐ RFAS

 Date Received: _____ Permit Number: _____ Permit Date: _____ Lease Inspection: ☐ Yes ☐ No

**CERTIFICATION OF COMPLIANCE WITH THE
KANSAS SURFACE OWNER NOTIFICATION ACT**

This form must be submitted with all Forms C-1 (Notice of Intent to Drill); CB-1 (Cathodic Protection Borehole Intent); T-1 (Request for Change of Operator Transfer of Injection or Surface Pit Permit); and CP-1 (Well Plugging Application). Any such form submitted without an accompanying Form KSONA-1 will be returned.

Select the corresponding form being filed: ☐ **C-1** (Intent) ☐ **CB-1** (Cathodic Protection Borehole Intent) ☐ **T-1** (Transfer) ☐ **CP-1** (Plugging Application)

OPERATOR: License # _____

Name: _____

Address 1: _____

Address 2: _____

City: _____ State: _____ Zip: _____ + _____

Contact Person: _____

Phone: (_____) _____ Fax: (_____) _____

Email Address: _____

Well Location:

____ - ____ - ____ Sec. ____ Twp. ____ S. R. ____ ☐ East ☐ West

County: _____

Lease Name: _____ Well #: _____

If filing a Form T-1 for multiple wells on a lease, enter the legal description of the lease below:

Surface Owner Information:

Name: _____

Address 1: _____

Address 2: _____

City: _____ State: _____ Zip: _____ + _____

When filing a Form T-1 involving multiple surface owners, attach an additional sheet listing all of the information to the left for each surface owner. Surface owner information can be found in the records of the register of deeds for the county, and in the real estate property tax records of the county treasurer.

If this form is being submitted with a Form C-1 (Intent) or CB-1 (Cathodic Protection Borehole Intent), you must supply the surface owners and the KCC with a plat showing the predicted locations of lease roads, tank batteries, pipelines, and electrical lines. The locations shown on the plat are preliminary non-binding estimates. The locations may be entered on the Form C-1 plat, Form CB-1 plat, or a separate plat may be submitted.

Select one of the following:

☐ I certify that, pursuant to the Kansas Surface Owner Notice Act (House Bill 2032), I have provided the following to the surface owner(s) of the land upon which the subject well is or will be located: 1) a copy of the Form C-1, Form CB-1, Form T-1, or Form CP-1 that I am filing in connection with this form; 2) if the form being filed is a Form C-1 or Form CB-1, the plat(s) required by this form; and 3) my operator name, address, phone number, fax, and email address.

☐ I have not provided this information to the surface owner(s). I acknowledge that, because I have not provided this information, the KCC will be required to send this information to the surface owner(s). To mitigate the additional cost of the KCC performing this task, I acknowledge that I am being charged a \$30.00 handling fee, payable to the KCC, which is enclosed with this form.

If choosing the second option, submit payment of the \$30.00 handling fee with this form. If the fee is not received with this form, the KSONA-1 form and the associated Form C-1, Form CB-1, Form T-1, or Form CP-1 will be returned.

Submitted Electronically

TOPOGRAPHIC LAND SURVEYORS

6709 NORTH CLASSEN BLVD., OKLA. CITY, OKLA. 73116 * LOCAL (405) 843-4847 * OUT OF STATE (800) 654-3219
Certificate of Authorization No. LS-99, Exp. Dec. 31, 2015

HARPER

County, Kansas

349'FNL - 1508'FWL Section 35 Township 33S Range 6W P.M.

155' NE TO PROPOSED
HOOPES 3306 1-26H

162' NE TO PROPOSED
MASON 3306 2-35H

X= 2161031
Y= 172194

X= 2166296
Y= 172254

A boundary survey of the said section(s)
shown hereon was not performed per the
request of the operator shown hereon.

BOTTOM HOLE
330'FSL-400'FWL
NAD-27 (US Feet)
37°07'29.2" N
97°56'46.5" W
37.124778360° N
97.946251600° W
X=2161455
Y=167287

X= 2161057
Y= 166950

X= 2166347
Y= 167047



GRID
NAD-27
KS SOUTH
US Feet
Note:
3,280,833 Ft. = 1 Meter
Scale:
1" = 1000'
0' 500' 1000'

Distances shown in (parenthesis) are calculated based
upon the Quarter Section being 2640 feet, those shown
in [brackets] are based on GLO (General Land Office)
distances and have NOT been measured on the ground.

Operator: SANDRIDGE EXPLORATION & PRODUCTION, LLC

Lease Name: MASON 3306

Well No.: 1-35H

ELEVATION:

1298' Gr. at level pad

Topography & Vegetation Loc. fell at level pad, ±20' East to Dilbert 1-35 SWD conductor pipe

Good Drill Site? Yes

Reference Stakes or Alternate Location
Stakes Set None

Best Accessibility to Location From North off county road

Distance & Direction

from Hwy Jct or Town From Anthony, KS, go ±5.0 mi. East on St. Hwy. 44, then ±1.0 mi. South
to the NW Cor. of Sec. 35-T33S-R6W

Date of Drawing: Jan. 16, 2014

Invoice # 214632 Date Staked: Jan. 16, 2014

AC

CERTIFICATE:

I, T. Wayne Fisch a Kansas Licensed Land
Surveyor and an authorized agent of Topographic Land
Surveyors, do hereby certify to the information
shown herein

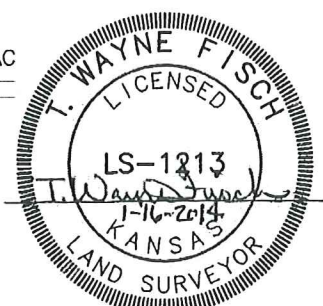

(This information was
gathered with a GPS receiver
with ±1 foot Horiz./Vert. accuracy.)
DATUM: NAD-27
LAT: 37°08'14.4"N
LONG: 97°56'32.8"W
LAT: 37.137326963° N
LONG: 97.942432065° W
STATE PLANE
COORDINATES: (US Feet)
ZONE: KS SOUTH
X: 2162542
Y: 171863

Summary of Changes

Lease Name and Number: Mason 3306 1-35H

API/Permit #: 15-077-22003-01-00

Doc ID: 1181301

Correction Number: 1

Approved By: Rick Hestermann 01/17/2014

Field Name	Previous Value	New Value
Abandonment Procedure	remove free fluid, let dry and backfill	
Artificial Liner?	No	
Depth Of Water Well	62	
Depth to Shallowest Fresh Water	22	
ElevationPDF	1302 Estimated	1300 Estimated
Feet to Nearest Water Well Within One-Mile of Pit	3228	
Fresh Water Information Source: KDWR	Yes	No
Ground Surface Elevation	1302	1300
How Pit is Lined if Plastic Liner Not Used	bentonite or native clay	
Is Bottom Below Ground Level?	Yes	

Summary of changes for correction 1 continued

Field Name	Previous Value	New Value
Is Pit Proposed or Existing	Proposed	
KCC Only - Approved By	Steve Bond 12/27/2013	Rick Hestermann 01/17/2014
KCC Only - Approved Date	12/27/2013	01/17/2014
KCC Only - Date Received	12/18/2013	01/17/2014
KCC Only - Lease Inspection	Yes	No
KCC Only - Regular Section Quarter Calls	NW NW NE NW	SW NW NE NW
LocationInfoLink	https://solar.kgs.ku.edu/kcc/detail/locationInformation.cfm?section=35&t	https://solar.kgs.ku.edu/kcc/detail/locationInformation.cfm?section=35&t
No Pit	No	Yes
Number of Feet East or West From Section Line	1530	1508
Number of Feet East or West From Section Line	1530	1508
Number of Feet North or South From Section Line	200	349
Number of Feet North or South From Section Line	200	349
Number of Working Pits to be Used	1	

Summary of changes for correction 1 continued

Field Name	Previous Value	New Value
Pit Capacity BBLS	10685	
Pit Deepest Depth	4	
Pit Length	100	
Pit Type	Drilling	
Pit Width	150	
Quarter Call 4 - Smallest	NW	SW
Quarter Call 4 - Smallest	NW	SW
RFAC	Yes	No
RFAS	Yes	No
Save Link	../../../../kcc/detail/operatorEditDetail.cfm?docID=1173373	../../../../kcc/detail/operatorEditDetail.cfm?docID=1181301
Type of Material Used in Drilling / Workover	cuttings	

Summary of Attachments

Lease Name and Number: Mason 3306 1-35H

API: 15-077-22003-01-00

Doc ID: 1181301

Correction Number: 1

Approved By: Rick Hestermann 01/17/2014

Attachment Name

Plat