



Confidentiality Requested:

Yes No

KANSAS CORPORATION COMMISSION 1179118
OIL & GAS CONSERVATION DIVISION

Form ACO-1

August 2013

Form must be Typed
Form must be Signed
All blanks must be Filled

WELL COMPLETION FORM
WELL HISTORY - DESCRIPTION OF WELL & LEASE

OPERATOR: License # _____

Name: _____

Address 1: _____

Address 2: _____

City: _____ State: _____ Zip: _____ + _____

Contact Person: _____

Phone: (_____) _____

CONTRACTOR: License # _____

Name: _____

Wellsite Geologist: _____

Purchaser: _____

Designate Type of Completion:

- New Well Re-Entry Workover
- Oil WSW SWD SIOW
- Gas D&A ENHR SIGW
- OG GSW Temp. Abd.
- CM (Coal Bed Methane)
- Cathodic Other (Core, Expl., etc.): _____

If Workover/Re-entry: Old Well Info as follows:

Operator: _____

Well Name: _____

Original Comp. Date: _____ Original Total Depth: _____

- Deepening Re-perf. Conv. to ENHR Conv. to SWD
- Plug Back Conv. to GSW Conv. to Producer
- Commingled Permit #: _____
- Dual Completion Permit #: _____
- SWD Permit #: _____
- ENHR Permit #: _____
- GSW Permit #: _____

Spud Date or Recompletion Date	Date Reached TD	Completion Date or Recompletion Date
-----------------------------------	-----------------	---

API No. 15 - _____

Spot Description: _____

_____ - _____ - _____ Sec. _____ Twp. _____ S. R. _____ East West

_____ Feet from North / South Line of Section

_____ Feet from East / West Line of Section

Footages Calculated from Nearest Outside Section Corner:

- NE NW SE SW

GPS Location: Lat: _____, Long: _____
(e.g. xx.xxxxx) (e.g. -xxx.xxxxx)

Datum: NAD27 NAD83 WGS84

County: _____

Lease Name: _____ Well #: _____

Field Name: _____

Producing Formation: _____

Elevation: Ground: _____ Kelly Bushing: _____

Total Vertical Depth: _____ Plug Back Total Depth: _____

Amount of Surface Pipe Set and Cemented at: _____ Feet

Multiple Stage Cementing Collar Used? Yes No

If yes, show depth set: _____ Feet

If Alternate II completion, cement circulated from: _____

feet depth to: _____ w/ _____ sx cmt.

Drilling Fluid Management Plan

(Data must be collected from the Reserve Pit)

Chloride content: _____ ppm Fluid volume: _____ bbls

Dewatering method used: _____

Location of fluid disposal if hauled offsite:

Operator Name: _____

Lease Name: _____ License #: _____

Quarter _____ Sec. _____ Twp. _____ S. R. _____ East West

County: _____ Permit #: _____

AFFIDAVIT

I am the affiant and I hereby certify that all requirements of the statutes, rules and regulations promulgated to regulate the oil and gas industry have been fully complied with and the statements herein are complete and correct to the best of my knowledge.

Submitted Electronically

KCC Office Use ONLY

- Confidentiality Requested
Date: _____
- Confidential Release Date: _____
- Wireline Log Received
- Geologist Report Received
- UIC Distribution
- ALT I II III Approved by: _____ Date: _____

1179118

Operator Name: _____ Lease Name: _____ Well #: _____

Sec. _____ Twp. _____ S. R. _____ East West County: _____

INSTRUCTIONS: Show important tops of formations penetrated. Detail all cores. Report all final copies of drill stems tests giving interval tested, time tool open and closed, flowing and shut-in pressures, whether shut-in pressure reached static level, hydrostatic pressures, bottom hole temperature, fluid recovery, and flow rates if gas to surface test, along with final chart(s). Attach extra sheet if more space is needed.

Final Radioactivity Log, Final Logs run to obtain Geophysical Data and Final Electric Logs must be emailed to kcc-well-logs@kcc.ks.gov. Digital electronic log files must be submitted in LAS version 2.0 or newer AND an image file (TIFF or PDF).

Drill Stem Tests Taken <i>(Attach Additional Sheets)</i>	<input type="checkbox"/> Yes <input type="checkbox"/> No	<input type="checkbox"/> Log	Formation (Top), Depth and Datum	<input type="checkbox"/> Sample
Samples Sent to Geological Survey	<input type="checkbox"/> Yes <input type="checkbox"/> No	Name	Top	Datum
Cores Taken	<input type="checkbox"/> Yes <input type="checkbox"/> No			
Electric Log Run	<input type="checkbox"/> Yes <input type="checkbox"/> No			
List All E. Logs Run:				

CASING RECORD <input type="checkbox"/> New <input type="checkbox"/> Used							
Report all strings set-conductor, surface, intermediate, production, etc.							
Purpose of String	Size Hole Drilled	Size Casing Set (In O.D.)	Weight Lbs. / Ft.	Setting Depth	Type of Cement	# Sacks Used	Type and Percent Additives

ADDITIONAL CEMENTING / SQUEEZE RECORD				
Purpose:	Depth Top Bottom	Type of Cement	# Sacks Used	Type and Percent Additives
<input type="checkbox"/> Perforate				
<input type="checkbox"/> Protect Casing				
<input type="checkbox"/> Plug Back TD				
<input type="checkbox"/> Plug Off Zone				

Did you perform a hydraulic fracturing treatment on this well? Yes No *(If No, skip questions 2 and 3)*

Does the volume of the total base fluid of the hydraulic fracturing treatment exceed 350,000 gallons? Yes No *(If No, skip question 3)*

Was the hydraulic fracturing treatment information submitted to the chemical disclosure registry? Yes No *(If No, fill out Page Three of the ACO-1)*

Shots Per Foot	PERFORATION RECORD - Bridge Plugs Set/Type Specify Footage of Each Interval Perforated	Acid, Fracture, Shot, Cement Squeeze Record <i>(Amount and Kind of Material Used)</i>	Depth

TUBING RECORD: Size: _____ Set At: _____ Packer At: _____ Liner Run: Yes No

Date of First, Resumed Production, SWD or ENHR. _____ Producing Method:
 Flowing Pumping Gas Lift Other *(Explain)* _____

Estimated Production Per 24 Hours	Oil Bbls.	Gas Mcf	Water Bbls.	Gas-Oil Ratio	Gravity

DISPOSITION OF GAS: <input type="checkbox"/> Vented <input type="checkbox"/> Sold <input type="checkbox"/> Used on Lease <i>(If vented, Submit ACO-18.)</i>	METHOD OF COMPLETION: <input type="checkbox"/> Open Hole <input type="checkbox"/> Perf. <input type="checkbox"/> Dually Comp. <input type="checkbox"/> Commingled <i>(Submit ACO-5)</i> <i>(Submit ACO-4)</i> <input type="checkbox"/> Other <i>(Specify)</i> _____	PRODUCTION INTERVAL: _____ _____
--	---	---

Form	ACO1 - Well Completion
Operator	SandRidge Exploration and Production LLC
Well Name	Bryant 3508 6-10H
Doc ID	1179118

Perforations

Shots Per Foot	Perforation Record	Material Record	Depth
5	5382-5384	Frac 5697-7312	7312
5	5450-5452		
5	5516-5518		
5	5697-5700		
5	5768-5771		
5	5885-5888		
5	5815-5818		
5	5945-5948		
5	5997-6000		
5	6097-6100		
5	6159-6162		
5	6222-6225		
5	6287-6290		
5	6372-6375		
5	6460-6463		
5	6547-6555		
5	6601-6604		
5	6672-6675		
5	6759-6762		
5	6869-6842		
5	6897-6900		
5	6955-7312		

Sandridge

Location Kansas
Field Sec 15 - 35S - 8W
Installation Harper County
Well Bryant 3508 6-10H

Installation Data

Name	Latitude	Longitude	Northing	Easting
Harper County	N36 59 52.77'	W99 9 50.08'	120820.00	2098111.00

Slot Data

Name	North [ft]	East [ft]	Latitude	Longitude	Northing	Easting
Bryant 3508 6-10H	190.99 N	-1340.92 E	N36 59 54.71'	W99 10 7.20'	121011.00	2096770.00

Elevation Data

Slot - Mean Sea Level [ft]	Mean Sea Level - Mudline/Ground level [ft]	Slot - Mudline/Ground level [ft]
0.00	0.00	0.00

WELL PROFILE DATA

Point	MD	Inc	Azi	TVD	North	East	deg/100ft	V. Sect
Tie on	0.00	0.00	0.00	0.00	0.00	0.00	0.00	0.00
KOP	3000.00	0.00	0.00	3000.00	0.00	0.00	0.00	0.00
End of Build	3286.41	21.31	270.30	3286.31	0.26	-48.99	8.00	1.1, 60
End of Hold	4258.22	21.31	270.30	4184.29	2.15	-409.46	0.00	96.93
Target Bryant 3508 6-1	5358.57	88.00	0.00	4853.07	695.00	-650.96	8.00	829.20
Target Bryant 3508 6-1	5558.57	88.00	0.00	4860.05	894.88	-650.96	0.00	1023.64
Target Bryant 3508 6-1	5603.57	91.60	0.00	4850.21	939.87	-650.96	8.00	1067.41
T.D. & Target Bryant 35	7440.24	91.60	0.00	4808.90	2775.83	-650.96	0.00	2853.44

TARGET DATA

Name	Position
Bryant 3508 6-10H - BHL	2096109.00 East; 123787.00 North
Bryant 3508 6-10H - 88°	2096109.00 East; 121706.04 North
Bryant 3508 6-10H - End 88°	2096109.00 East; 121905.94 North
Bryant 3508 6-10H - LP	2096109.00 East; 121980.93 North

Sandridge ENERGY
9630 Pale Rd.
Oklahoma City, OK 73160
Tel: (405) 604-2969

DrillRight
TECHNOLOGY, INC.

Target Line: 9-18-13
Target: 4890 KB TVD @ 0 VS
91.6° @ 346.61 Azimuth Plane

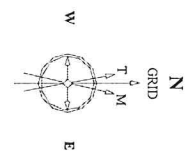

18-Sep-2013
ICRF Model [1990-0-2015.0] Dip: 65.09 deg Field: 516573 nT
Magnetic North is 4.32 deg East of True North
GRID North is 0.21 deg East of True North
To convert azimuth from True to GRID subtract 0.21 deg
To convert azimuth from Magnetic to GRID add 4.31 deg

Created by admin
Date plotted 14-Oct-2013
Pole reference is Bryant 3508 6-10H (Plan).
Ref. depths is Bryant 3508 6-10H (PWPPI).
Coordinates are in feet reference Bryant 3508 6-10H.
True Vertical Depths are reference Bryant 3508 6-10H.
Measured Depths are reference Slot.
Pole North is aligned to GRID North.

Landing Point:
MD 5604 TVD 4860
N 940 W 661
91.6° @ 0.00 Azi
VS = 1067'

Projected BHL:
314 FNL 1988 FEL
X = 2096101 Y = 123771
N 2760 W 669
MD 7405 TVD 4810
VS = 2840'

7.0in Intermediate Casing 5558.57 md, 88.00 inc, 0.00 dir

Bryant 3508 6-10H - 88° 5358.57 md, 88.00 inc, 0.00 dir
Bryant 3508 6-10H - End 88° 5558.57 md, 88.00 inc, 0.00 dir

Scale 1 inch = 1000 ft

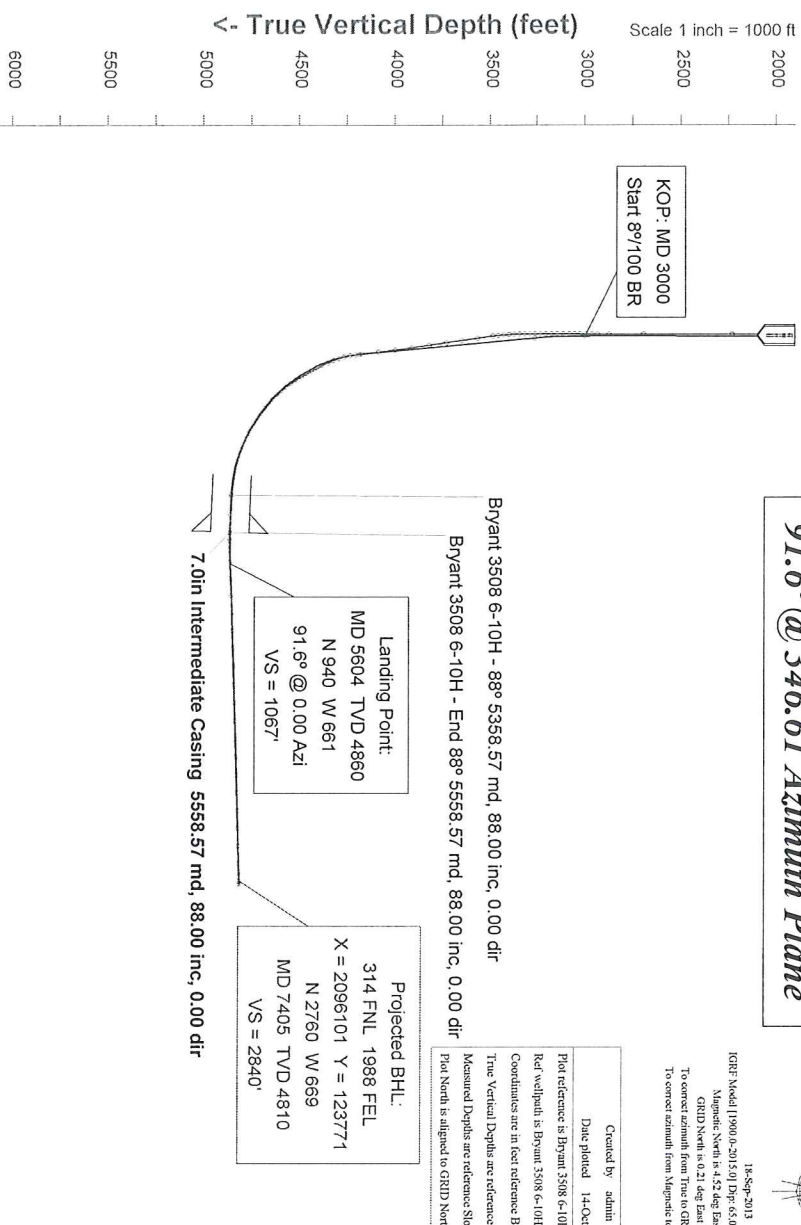

East (feet) ->
Scale 1 inch = 800 ft

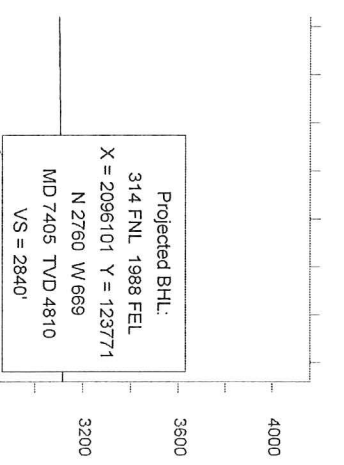

Scale 1 inch = 800 ft

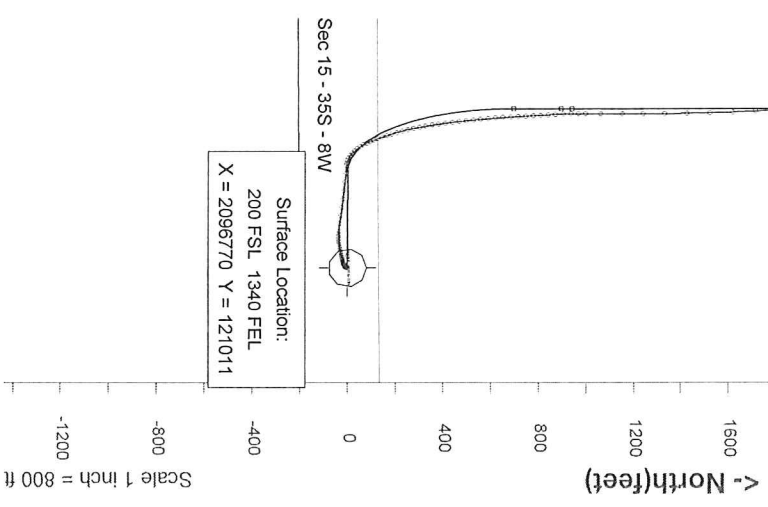

Sec 15 - 35S - 8W

Surface Location:
200 FSL 1340 FEL
X = 2096770 Y = 121011

Scale 1 inch = 1000 ft

Vertical Section (feet) ->
Azimuth 346.61 with reference 0.00 N, 0.00 E from Bryant 3508 6-10H

Standard Wellpath Report
 Sandridge
 Sec 15 - 35S - 8W, Kansas
 Harper County
 Wellbore: Bryant 3508 6-10H (Actual)

Wellbore

Name	Created	Last Revised
Bryant 3508 6-10H (Actual)	18-Sep-2013	14-Oct-2013

Well

Name	Government ID	Last Revised
Bryant 3508 6-10H		18-Sep-2013

Slot

Name	Grid Northing	Grid Easting	Latitude	Longitude	North	East
Bryant 3508 6-10H	121011.0000	2096770.0000	N36 59 54.7108	W98 10 7.2031	190.99N	1340.92W

Installation

Name	Easting	Northing	Coord System Name	North Alignment
Harper County	2098111.0000	120820.0001	KS-S on NORTH AMERICAN DATUM 1927 datum	Grid

Field

Name	Easting	Northing	Coord System Name	North Alignment
Sec 15 - 35S - 8W	2098111.0000	120820.0001	KS-S on NORTH AMERICAN DATUM 1927 datum	Grid

Created By

Comments
FINAL SURVEYS: MD 7405 is a projection to bit @ TD

Standard Wellpath Report
Sandridge
Sec 15 - 35S - 8W, Kansas
Harper County
Wellbore: Bryant 3508 6-10H (Actual)

Wellpath (Grid) Report

MD[ft]	Inc[deg]	Azi[deg]	TVD[ft]	North[ft]	East[ft]	Dogleg [deg/100ft]	Vertical Section[ft]	Easting	Northing
0.00	0.00	0.000	0.00	0.00N	0.00E		0.00	2096770.00	121011.00
897.00	0.50	212.100	896.99	3.32S	2.08W	0.06	-2.74	2096767.92	121007.68
992.00	0.70	199.500	991.98	4.21S	2.49W	0.25	-3.52	2096767.51	121006.79
1087.00	0.60	200.600	1086.98	5.23S	2.86W	0.11	-4.42	2096767.14	121005.77
1183.00	0.80	193.600	1182.97	6.35S	3.20W	0.23	-5.44	2096766.80	121004.65
1277.00	0.60	184.800	1276.96	7.48S	3.39W	0.24	-6.49	2096766.61	121003.52
1754.00	0.50	243.200	1753.94	10.90S	5.46W	0.11	-9.34	2096764.54	121000.10
2230.00	0.50	273.900	2229.93	11.70S	9.39W	0.06	-9.21	2096760.61	120999.30
2693.00	0.20	206.100	2692.92	12.29S	11.76W	0.10	-9.23	2096758.24	120998.71
2874.00	0.20	225.400	2873.92	12.79S	12.12W	0.04	-9.64	2096757.88	120998.21
2934.00	1.00	237.200	2933.91	13.15S	12.63W	1.34	-9.87	2096757.36	120997.85
2964.00	2.70	238.200	2963.90	13.66S	13.46W	5.67	-10.18	2096756.54	120997.34
2994.00	4.40	237.100	2993.84	14.66S	15.02W	5.67	-10.78	2096754.98	120996.34
3024.00	5.80	244.500	3023.72	15.94S	17.36W	5.15	-11.49	2096752.64	120995.06
3054.00	7.10	253.100	3053.53	17.13S	20.50W	5.39	-11.92	2096749.50	120993.87
3083.00	8.60	259.700	3082.26	18.04S	24.35W	6.03	-11.91	2096745.65	120992.96
3114.00	10.50	258.200	3112.83	19.03S	29.39W	6.18	-11.71	2096740.60	120991.97
3144.00	12.20	256.900	3142.24	20.31S	35.16W	5.73	-11.61	2096734.84	120990.69
3174.00	14.00	257.600	3171.46	21.81S	41.79W	6.02	-11.53	2096728.21	120989.19
3205.00	16.20	256.600	3201.39	23.61S	49.66W	7.15	-11.47	2096720.34	120987.38
3235.00	18.20	256.300	3230.04	25.69S	58.28W	6.67	-11.50	2096711.71	120985.30
3264.00	19.20	256.400	3257.51	27.89S	67.32W	3.45	-11.54	2096702.68	120983.11
3295.00	19.60	257.400	3286.75	30.22S	77.35W	1.68	-11.48	2096692.65	120980.78
3325.00	20.60	260.700	3314.92	32.17S	87.47W	5.04	-11.04	2096682.53	120978.83
3356.00	21.60	262.400	3343.85	33.81S	98.50W	3.78	-10.07	2096671.49	120977.19
3387.00	21.80	263.100	3372.65	35.25S	109.87W	1.06	-8.84	2096660.12	120975.74
3416.00	21.10	264.600	3399.64	36.39S	120.42W	3.07	-7.51	2096649.58	120974.61
3445.00	20.50	270.200	3426.75	36.87S	130.69W	7.16	-5.59	2096639.30	120974.13
3476.00	20.90	274.600	3455.75	36.40S	141.63W	5.18	-2.61	2096628.36	120974.59
3506.00	22.00	276.600	3483.68	35.33S	152.55W	4.40	0.97	2096617.44	120975.67
3594.00	21.40	276.600	3565.44	31.59S	184.87W	0.68	12.09	2096585.12	120979.41
3683.00	23.40	278.800	3647.72	27.02S	218.47W	2.44	24.32	2096551.52	120983.98
3772.00	21.40	276.800	3730.00	22.39S	252.06W	2.40	36.60	2096517.92	120988.61
3868.00	23.00	278.100	3818.88	17.67S	288.02W	1.74	49.52	2096481.96	120993.32
3963.00	20.60	275.300	3907.09	13.52S	323.05W	2.75	61.68	2096446.94	120997.48
4058.00	22.90	277.800	3995.32	9.46S	358.00W	2.61	73.72	2096411.97	121001.54
4153.00	20.90	273.300	4083.46	5.98S	393.24W	2.75	85.27	2096376.74	121005.02
4248.00	20.10	273.200	4172.45	4.09S	426.46W	0.84	94.80	2096343.52	121006.91
4280.00	19.10	280.500	4202.60	2.83S	437.09W	8.26	98.49	2096332.88	121008.17
4312.00	20.10	289.000	4232.75	0.08S	447.44W	9.43	103.56	2096322.53	121010.92
4344.00	22.30	297.400	4262.59	4.50N	458.04W	11.70	110.48	2096311.93	121015.50
4375.00	23.80	308.200	4291.13	11.08N	468.18W	14.45	119.23	2096301.79	121022.08
4407.00	24.80	314.100	4320.30	19.74N	478.07W	8.20	129.95	2096291.90	121030.75
4439.00	25.70	319.700	4349.24	29.71N	487.38W	7.97	141.80	2096282.59	121040.71
4471.00	26.60	323.700	4377.97	40.77N	496.11W	6.18	154.58	2096273.86	121051.78
4502.00	28.00	326.700	4405.52	52.45N	504.22W	6.33	167.82	2096265.75	121063.45
4534.00	28.70	330.500	4433.68	65.42N	512.13W	6.05	182.27	2096257.84	121076.42
4566.00	29.10	335.300	4461.70	79.18N	519.16W	7.35	197.28	2096250.81	121090.18
4598.00	30.70	338.000	4489.44	93.82N	525.47W	6.53	212.99	2096244.49	121104.83
4629.00	33.30	339.600	4515.73	109.14N	531.41W	8.82	229.26	2096238.56	121120.14
4661.00	35.20	340.900	4542.18	126.09N	537.49W	6.36	247.16	2096232.48	121137.10
4693.00	38.10	342.400	4567.85	144.22N	543.49W	9.48	266.19	2096226.47	121155.23
4725.00	40.50	342.900	4592.61	163.56N	549.53W	7.56	286.41	2096220.43	121174.57
4756.00	43.50	343.100	4615.64	183.40N	555.60W	9.69	307.11	2096214.37	121194.41
4788.00	46.60	343.700	4638.25	205.10N	562.06W	9.78	329.72	2096207.90	121216.11
4820.00	49.70	345.600	4659.60	228.08N	568.36W	10.65	353.53	2096201.60	121239.10
4851.00	51.60	346.600	4679.25	251.35N	574.12W	6.62	377.50	2096195.85	121262.37
4883.00	53.70	348.500	4698.67	276.19N	579.59W	8.08	402.93	2096190.37	121287.21
4915.00	55.30	349.200	4717.25	301.75N	584.63W	5.31	428.96	2096185.33	121312.77
4946.00	57.90	349.200	4734.31	327.17N	589.48W	8.39	454.82	2096180.48	121338.19
4978.00	60.20	351.400	4750.77	354.22N	594.10W	9.30	482.20	2096175.87	121365.24
5010.00	62.80	353.200	4766.04	382.08N	597.86W	9.51	510.18	2096172.10	121393.11
5041.00	64.10	352.400	4779.90	409.59N	601.34W	4.79	537.74	2096168.63	121420.62
5073.00	66.50	352.800	4793.27	438.42N	605.08W	7.59	566.66	2096164.88	121449.45
5104.00	69.90	353.700	4804.78	467.00N	608.46W	11.29	595.24	2096161.50	121478.03
5136.00	72.60	354.000	4815.06	497.13N	611.70W	8.48	625.30	2096158.26	121508.16
5168.00	75.20	354.900	4823.94	527.72N	614.68W	8.56	655.75	2096155.29	121538.76
5199.00	77.30	354.800	4831.30	557.71N	617.38W	6.78	685.55	2096152.58	121568.75
5231.00	79.70	355.000	4837.68	588.94N	620.17W	7.52	716.58	2096149.80	121599.98
5263.00	81.60	355.700	4842.88	620.41N	622.72W	6.32	747.78	2096147.24	121631.45
5294.00	83.50	356.100	4846.90	651.07N	624.92W	6.26	778.12	2096145.04	121662.11
5326.00	86.10	356.900	4849.80	682.88N	626.87W	8.50	809.51	2096143.09	121693.92

All data is in Feet unless otherwise stated
Coordinates are from Slot MD's are from Slot and TVD's are from Slot (Bryant 3508 6-10H 0.00ft above Mean Sea Level)
Vertical Section is from 0.00N 0.00E on azimuth 346.610 degrees
Bottom hole distance is 2839.76 Feet on azimuth 346.38 degrees from Wellhead
Calculation method uses Minimum Curvature method
Prepared by
Date Printed: 14-Oct-2013

Standard Wellpath Report
 Sandridge
 Sec 15 - 35S - 8W, Kansas
 Harper County
 Wellbore: Bryant 3508 6-10H (Actual)

Wellpath (Grid) Report

MD[ft]	Inc[deg]	Azi[deg]	TVD[ft]	North[ft]	East[ft]	Dogleg [deg/100ft]	Vertical Section[ft]	Easting	Northing
5357.00	87.40	357.300	4851.56	713.79N	628.43W	4.39	839.94	2096141.53	121724.83
5389.00	87.40	357.200	4853.01	745.72N	629.97W	0.31	871.36	2096139.99	121756.76
5421.00	87.50	356.800	4854.43	777.64N	631.64W	1.29	902.80	2096138.32	121788.69
5452.00	87.60	356.300	4855.76	808.56N	633.50W	1.64	933.31	2096136.46	121819.61
5484.00	87.30	356.500	4857.18	840.46N	635.51W	1.13	964.81	2096134.45	121851.51
5515.00	87.10	356.300	4858.70	871.36N	637.45W	0.91	995.32	2096132.51	121882.42
5547.00	87.30	356.700	4860.26	903.27N	639.41W	1.40	1026.81	2096130.55	121914.32
5579.00	89.20	359.000	4861.24	935.22N	640.61W	9.32	1058.18	2096129.36	121946.28
5610.00	90.70	0.600	4861.26	966.22N	640.71W	7.07	1088.36	2096129.25	121977.28
5639.00	91.00	0.600	4860.83	995.22N	640.41W	1.03	1116.49	2096129.55	122006.28
5704.00	92.10	0.100	4859.08	1060.19N	640.01W	1.86	1179.61	2096129.95	122071.26
5794.00	92.60	359.900	4855.39	1150.12N	640.01W	0.60	1267.09	2096129.95	122161.19
5883.00	91.80	359.800	4851.97	1239.05N	640.25W	0.91	1353.65	2096129.71	122250.13
5974.00	92.20	0.000	4848.79	1329.99N	640.40W	0.49	1442.16	2096129.56	122341.07
6070.00	91.70	358.700	4845.53	1425.93N	641.49W	1.45	1535.74	2096128.47	122437.02
6165.00	91.60	358.600	4842.79	1520.86N	643.73W	0.15	1628.61	2096126.23	122531.96
6261.00	92.30	358.100	4839.52	1616.77N	646.49W	0.90	1722.55	2096123.47	122627.87
6356.00	92.00	357.100	4835.96	1711.62N	650.47W	1.10	1815.74	2096119.49	122722.72
6452.00	90.40	357.800	4833.95	1807.50N	654.74W	1.82	1910.00	2096115.22	122818.61
6547.00	91.10	357.900	4832.71	1902.42N	658.30W	0.74	2003.17	2096111.66	122913.54
6643.00	91.20	357.600	4830.78	1998.33N	662.07W	0.33	2097.34	2096107.89	123009.45
6738.00	92.40	357.500	4827.80	2093.19N	666.13W	1.27	2190.56	2096103.83	123104.32
6834.00	91.80	359.100	4824.28	2189.08N	668.97W	1.78	2284.50	2096100.98	123200.22
6930.00	92.30	0.100	4820.84	2285.02N	669.64W	1.16	2377.98	2096100.31	123296.16
7025.00	90.30	0.600	4818.69	2379.98N	669.06W	2.17	2470.23	2096100.89	123391.13
7121.00	91.70	1.100	4817.01	2475.96N	667.64W	1.55	2563.27	2096102.32	123487.11
7216.00	91.00	359.900	4814.77	2570.92N	666.81W	1.46	2655.46	2096103.15	123582.08
7311.00	91.30	359.600	4812.87	2665.90N	667.23W	0.45	2747.95	2096102.73	123677.07
7356.00	91.50	358.800	4811.77	2710.89N	667.85W	1.83	2791.86	2096102.10	123722.05
7405.00	91.50	358.800	4810.49	2759.86N	668.88W	==>	2839.73	2096101.08	123771.03

All data is in Feet unless otherwise stated
 Coordinates are from Slot MD's are from Slot and TVD's are from Slot (Bryant 3508 6-10H 0.00ft above Mean Sea Level)
 Vertical Section is from 0.00N 0.00E on azimuth 346.610 degrees
 Bottom hole distance is 2839.76 Feet on azimuth 346.38 degrees from Wellhead
 Calculation method uses Minimum Curvature method
 Prepared by
 Date Printed: 14-Oct-2013

Hydraulic Fracturing Fluid Product Component Information Disclosure

Job Start Date:	11/30/2013
Job End Date:	12/1/2013
State:	Kansas
County:	Harper
API Number:	15-077-21968-00-00
Operator Name:	SandRidge Energy
Well Name and Number:	Bryant 3508 6-10H
Longitude:	-98.16866731
Latitude:	36.99852908
Datum:	NAD27
Federal/Tribal Well:	NO
True Vertical Depth:	4,810
Total Base Water Volume (gal):	1,713,368
Total Base Non Water Volume:	0



Hydraulic Fracturing Fluid Composition:

Trade Name	Supplier	Purpose	Ingredients	Chemical Abstract Service Number (CAS #)	Maximum Ingredient Concentration in Additive (% by mass)**	Maximum Ingredient Concentration in HF Fluid (% by mass)**	Comments
Water	Company 1	Carrier/Base Fluid	Water	7732-18-5	100.00000	95.03644	None
Sand (Proppant)	Company 2	Proppant	Silica Substrate	NA	100.00000	3.99035	None
Hydrochloric Acid (15%)	Company 2	Acidizing	Hydrochloric Acid	7647-01-0	15.00000	0.12376	None
			NONYL PHENOL, 4 MOL	104-40-5	10.00000	0.00464	None
			Methyl Alcohol	67-56-1	80.00000	0.00099	None
			thiourea-formaldehyde copolymer	68527-49-1	15.00000	0.00019	None
Chemiflush	Archer	Enviro-Friendly Chemical Flush	Acrylamide modified copolymer	NA	60.00000	0.00691	None
			Aliphatic hydrocarbon	64742-47-8	30.00000	0.00345	None
			Hydrotreated Petroleum Distillate	64742-47-8	99.00000	0.00286	None
			Oxyalkylated Alcohol	NA	5.00000	0.00058	None
			Ammonium chloride	12125-02-9	5.00000	0.00058	None
			Alcohol Ethoxylate Surfactants	NA	10.00000	0.00029	None
AIC	Archer	Liquid Acid Iron Control					

			Acetic Acid	64-19-7	50.00000	0.00223	None
			Citric Acid	77-92-9	30.00000	0.00134	None
Ingredients shown above are subject to 29 CFR 1910.1200(j) and appear on Material Safety Data Sheets (MSDS). Ingredients shown below are Non-MSDS.							
			Other Chemicals				
			Water	7732-18-5		0.04900	
			WATER	7732-18-5		0.02782	
			Aliphatic Hydrocarbon	64742-47-8		0.02450	
			Anionic Polymer	N/A		0.02450	
			TRADE SECRET	N/A		0.01855	
			Water	7732-18-5		0.01036	
			ISOPROPANOL	67-63-0		0.00464	
			METHANOL	67-56-1		0.00464	
			Polyol Ester	N/A		0.00408	
			Oxyalkylated Alcohol	68002-97-1		0.00408	
			Water	7732-18-5		0.00345	
			Sodium Salt of Phosphate Ester	68131-72-6		0.00173	
			Acrylic Polymer	28205-96-1		0.00173	
			Water	7732-18-5		0.00156	
			Polyglycol Ester	N/A		0.00082	
			Polyol Ester	N/A		0.00058	
			Alkanolamide	N/A		0.00058	
			Alcohol Ethoxylate Surfactants	N/A		0.00019	
			Surfactant	N/A		0.00012	
			Ammonium salt	7783-18-8		0.00012	
			Oxyalkylated fatty Acid Derivative	N/A		0.00012	
			Alkanolamine	111-42-2		0.00012	
			n-olefins	N/A		0.00010	
			Tetrasodium Ethylenediaminetetraacetate	64-02-8		0.00008	
			Propargyl Alcohol	107-19-7		0.00007	
			Surfactant	N/A			
			Buffer	N/A			

* Total Water Volume sources may include fresh water, produced water, and/or recycled water

** Information is based on the maximum potential for concentration and thus the total may be over 100%

Note: For Field Development Products (products that begin with FDP), MSDS level only information has been provided. Ingredient information for chemicals subject to 29 CFR 1910.1200(i) and Appendix D are obtained from suppliers Material Safety Data Sheets (MSDS)



BASIN SERVICES, LLC
 P O BOX 4268
 ABILENE, TX 79608-4268
 Phone # (325)690-0053
 Fax # (325)698-0055

TICKET

TICKET NUMBER: WY-118-1
 TICKET DATE: 09/18/2013

ELECTRONIC

SANDRIDGE ENERGY
 ***** DO NOT MAIL!!! *****
 123 ROBERT S KERR AVE
 OKLAHOMA CITY, OK 73102-6406

YARD: WY WAYNOKA OK
 LEASE: Bryant 3508
 WELL#: 6-10H
 RIG #: Lariat 20
 Co/St: HARPER, KS

DESCRIPTION	QUANTITY	RATE	AMOUNT
9/18/2013 DRILLED 30" CONDUCTOR HOLE			
9/18/2013 20" CONDUCTOR PIPE (.250 WALL)			
9/18/2013 6' X 6' CELLAR TINHORN WITH PROTECTIVE RING			
9/18/2013 DRILL & INSTALL 6' X 6' CELLAR TINHORN			
9/18/2013 DRILLED 20" MOUSE HOLE (PER FOOT)			
9/18/2013 16" CONDUCTOR PIPE (.250 WALL)			
9/18/2013 MOBILIZATION OF EQUIPMENT & ROAD PERMITTING FEE			
9/18/2013 WELDING SERVICES FOR PIPE & LIDS			
9/18/2013 PROVIDED EQUIPMENT & LABOR TO ASSIST IN PUMPING CONCRETE			
9/18/2013 PROVIDED METAL LIDS (1 FOR CONDUCTOR & 2 FOR MOUSEHOLE PIPE)			
9/18/2013 16 YDS OF 10 SACK GROUT			
9/18/2013 TAXABLE ITEMS			5,520.00
9/18/2013 BID - TAXABLE ITEMS			11,430.00

Sub Total: 16,950.00
 Tax HARPER COUNTY (6.3 %): 347.76
TICKET TOTAL: \$ 17,297.76

I, the undersigned, acknowledge the acceptance of the above listed goods and/or services.

Approved Signature _____

ALLIED OIL & GAS SERVICES, LLC 059977

Federal Tax I.D.# 20-5975804

REMIT TO P.O. BOX 93999
SOUTHLAKE, TEXAS 76092

SERVICE POINT:
Medicine Lodge, KS

DATE <u>9-24-2013</u>	SEC <u>15</u>	TWP <u>35S</u>	RANGE <u>8W</u>	CALLED OUT <u>12:30 PM</u>	ON LOCATION	JOB START	JOB FINISH <u>3:00 PM</u>
LEASE <u>Bryant</u>	WELL # <u>3508 6-1014</u>	LOCATION <u>Sharon, KS South to Hwy 2</u>			COUNTY <u>Harper</u>	STATE <u>KS</u>	
OLD OR (NEW) (Circle one)		esst to W. Sharon Rd, Sturdt 1001 essst			S & W in rd		

CONTRACTOR L Grig + #20
 TYPE OF JOB SURFCE
 HOLE SIZE 12 1/4 T.D. 780'
 CASING SIZE 9 5/8 36 # DEPTH 780'
 TUBING SIZE DEPTH
 DRILL PIPE DEPTH
 TOOL DEPTH
 PRES. MAX MINIMUM
 MEAS. LINE SHOE JOINT 43'
 CEMENT LEFT IN CSG.
 PERFS.
 DISPLACEMENT 57 bbls of Freshwater

OWNER Sqnaridge
 CEMENT
 AMOUNT ORDERED 255 sk 65: 35: 6% Ge1
2% cc + 1/4 # Plosec1, 150 sk c1s ss n
2% cc + 1/4 # Plosec1
 COMMON A 150 sk @ 17.90 2685.00
 POZMIX @
 GEL @
 CHLORIDE 10 sk @ 24.00 240.00
 ASC @
Alc 255 sk @ 16.50 4207.50
Plosecal 102 # @ 2.97 302.94
 AFE Number DC 13300
 Well Name Bryant # 3508 6-1014
 Code: 832 4360 @
 Amount: 9764.00 @
 Co. Man: Bill Tomlinson 1111.80
 HANDLING Bill Tomlinson @ 1999.04
 MILEAGE
 Notes:
 TOTAL 10946.28

EQUIPMENT
 PUMP TRUCK CEMENTER Darin F. Scott P.
 # 558-555 HELPER Scott P.
 BULK TRUCK
 # 561-553 DRIVER CJ
 BULK TRUCK
 # DRIVER

REMARKS:

See Cement + log
Cement did Circulate
Circulated 60 bbls to P17

CHARGE TO: Sqnaridge
 STREET
 CITY STATE ZIP

SERVICE

DEPTH OF JOB 780'
 PUMP TRUCK CHARGE 2058.50
 EXTRA FOOTAGE @
 MILEAGE 40 @ 7.70 308.00
 MANIFOLD Hess 40 @ 275.00
LU 40 @ 440 176.00
 TOTAL 2817.50

PLUG & FLOAT EQUIPMENT

9 5/8
 1-Rubber Plug @ 184.86
 @
 @
 @
 @
 TOTAL 184.86

To: Allied Oil & Gas Services, LLC.
 You are hereby requested to rent cementing equipment and furnish cementer and helper(s) to assist owner or contractor to do work as is listed. The above work was done to satisfaction and supervision of owner agent or contractor. I have read and understand the "GENERAL TERMS AND CONDITIONS" listed on the reverse side.

PRINTED NAME x Bill Tomlinson

SIGNATURE x Bill Tomlinson

Thank you!!!

SALES TAX (if Any)
 TOTAL CHARGES 13,948.64
 DISCOUNT IF PAID IN 30 DAYS

\$ 9,764.05

ALLIED OIL & GAS SERVICES, LLC 059981

Federal Tax I.D.# 20-5975804

REMIT TO P.O. BOX 93999
SOUTHLAKE, TEXAS 76092

SERVICE POINT:
Medicine Lodge, KS

DATE <u>10-3-2013</u>	SEC. <u>15</u>	TWP. <u>35S</u>	RANGE <u>8W</u>	CALLED OUT <u>8:00 pm</u>	ON LOCATION <u>11:00 am</u>	JOB START <u>8:00 pm</u>	JOB FINISH <u>9:15 pm</u>
LEASE <u>Bryana 8503</u>	WELL # <u>6-10H</u>		LOCATION <u>Adrian, KS South to Hwy 2</u>		COUNTY <u>Harper</u>	STATE <u>KS</u>	
OLD OR <u>NEW</u> (Circle one)			ESSE to W. 1/2 Sec 15, South to R. 1/2 Sec 15, S. 1/2 W. 1/4, R. 10				

CONTRACTOR Lgrist #20 OWNER Sonabrise Energy

TYPE OF JOB Intermediate

HOLE SIZE 8 3/4 T.D. 5702'

CASING SIZE 7" 26# DEPTH 5683'

TUBING SIZE _____ DEPTH _____

DRILL PIPE _____ DEPTH _____

TOOL _____ DEPTH _____

PRES. MAX 1200 MINIMUM _____

MEAS. LINE _____ SHOE JOINT 88'

CEMENT LEFT IN CSG. _____

PERFS. _____

DISPLACEMENT 214 Fresh water

EQUIPMENT _____

CEMENT

AMOUNT ORDERED 240s x 50' 50 Class A Flyash, 2% Gel + 4% FL160 + 1% SAS

100s x Class A + 8% FL160 + 2% Dispersion Co.

50.50 Blend 240 sk @ 14.40 3456.00

COMMON Super Flash 30 @ 58.70 1761.00

POZMIX FL160 157 @ 18.90 2967.30

GEL SA-SI 21 @ 17.55 368.55

CHLORIDE A 100 sk @ 17.90 1790.00

ASC CD-31 19 @ 10.30 195.70

AFE Number: 1013990

Well Name: Bryana 2586-10H

Code: 820670

Amount: 11,899.92

Co. Man: Bill Tamplin

Co. Man Sig: Bill Tamplin

Notes: _____

PUMP TRUCK CEMENTER Derin E, Scott P

558-555 HELPER Scott P

BULK TRUCK

381-252 DRIVER Decker

BULK TRUCK

_____ DRIVER _____

HANDLING .351.84 @ 2.48 872.56

MILEAGE 603.16 @ 2.60 1568.22

TOTAL 12,979.33

REMARKS:

Pipe on bottom & break circulation pump 30 hrs water, mix 240s lead cement, loose tail cement, shut down, BFRt displacement lift pressure 9 + 190 bbls, slow rate to 3 bpm at 204 bbls, bump plus 9 + 214 bbls 700-1200 psi, float & hold

SERVICE

DEPTH OF JOB 5683'

PUMP TRUCK CHARGE 3099.25

EXTRA FOOTAGE @ _____

MILEAGE 40 @ 7.70 308.00

MANIFOLD Harper KS @ 275.00

40 @ 4.40 176.00

Additional hours 4 @ 440.00 1760.00

TOTAL 5618.25

CHARGE TO: Sonabrise Energy

STREET _____

CITY _____ STATE _____ ZIP _____

PLUG & FLOAT EQUIPMENT

7"

1- Rubber Plug @ 99.45

_____ @ _____

_____ @ _____

_____ @ _____

_____ @ _____

TOTAL 99.45

SALES TAX (If Any) _____

TOTAL CHARGES 18,697.03

DISCOUNT _____ IF PAID IN 30 DAYS

PRINTED NAME X Bill Tamplin

SIGNATURE X Bill Tamplin

Thank you!!!

\$ 13087.92