

CASTELLI EXPLORATION, INC.
DUNN LEASE
SE. 1/4, SECTION 24, T33S, R17W
COMANCHE COUNTY, KANSAS

Notes:

1. Set iron rod at location site.
2. All flogging Red & Yellow.
3. No overhead power available at Sec. 24.
4. Kansas One Call System Inc. should be notified before excavation (1-800-344-7233).
5. CAUTION: Various pipelines in Sec. 24.
6. Section 24 is irregular.
7. Contact landowner for best access.
8. Location fell in a rough area, set alternate per representative.

EINSEL "A" '02

Ingress and egress to location as shown on this plat is per usage only and may not be legally opened for public use. Contact landowner, tenant and county road department for access.

ROAD

ROAD

ROAD

SCALE 1" = 1000'

Drillsite Location
Dunn #1-24
150'N. & 50'W. NE SE
2130'FSL 710'FEL
Ground Elevation = 1798
Y = 178941 X = 1821715

*Alternate Location
(125' east of Loc.)
2130'FSL 585'FEL
Ground Elevation = 1818
Y = 178941 X = 1821840

3078 Plane-NAD 27-Kansas South
Mapping GPOs-CPS-Used

THOMAS GRAVEL ROAD

NO ROAD

24

NO

NO

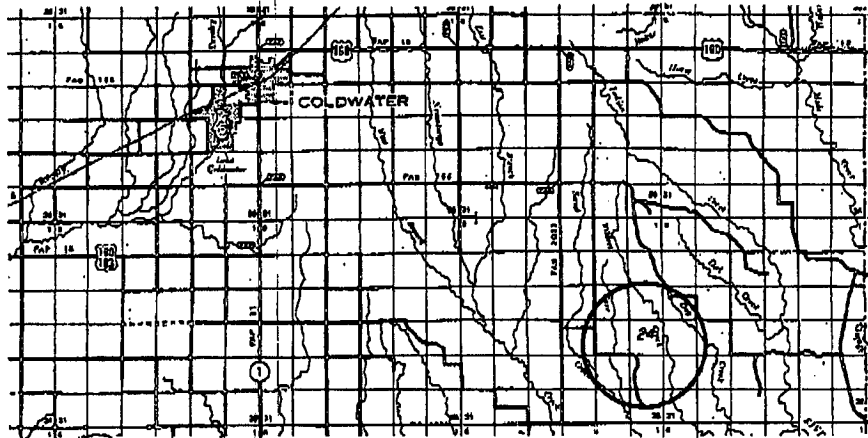

• Controlling data is based upon the best maps and photographs available to us and upon a regular section of land containing 640 acres.
 • Approximate section lines were determined using the normal standards of care of oilfield surveyors practicing in the state of Kansas. The section corners, which establish the precise section lines, were not necessarily located, and the exact location of the drilling location in the section is not guaranteed. Therefore, the operator securing this service and accepting this plat and all other parties relying thereon agree to hold Central Kansas Oilfield Services, Inc., its officers and employees harmless from all losses, costs and expenses and said entities released from any liability from incidental or consequential damages.
 • Elevations derived from National Geodetic Vertical Datum.

Date January 3, 2014