

Proposed Plan of Construction

Hall #10  
Sec 16 T30S-R32W  
Haskell County, KS

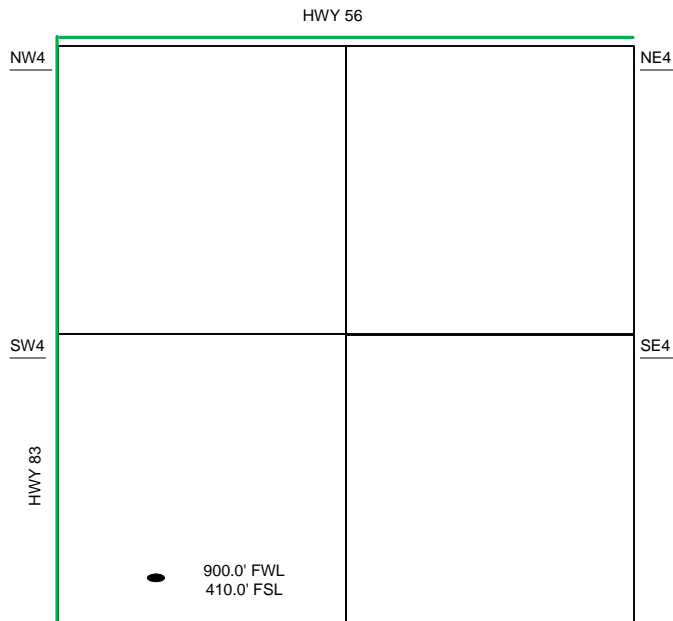

Sec 16 - T30S - R32W

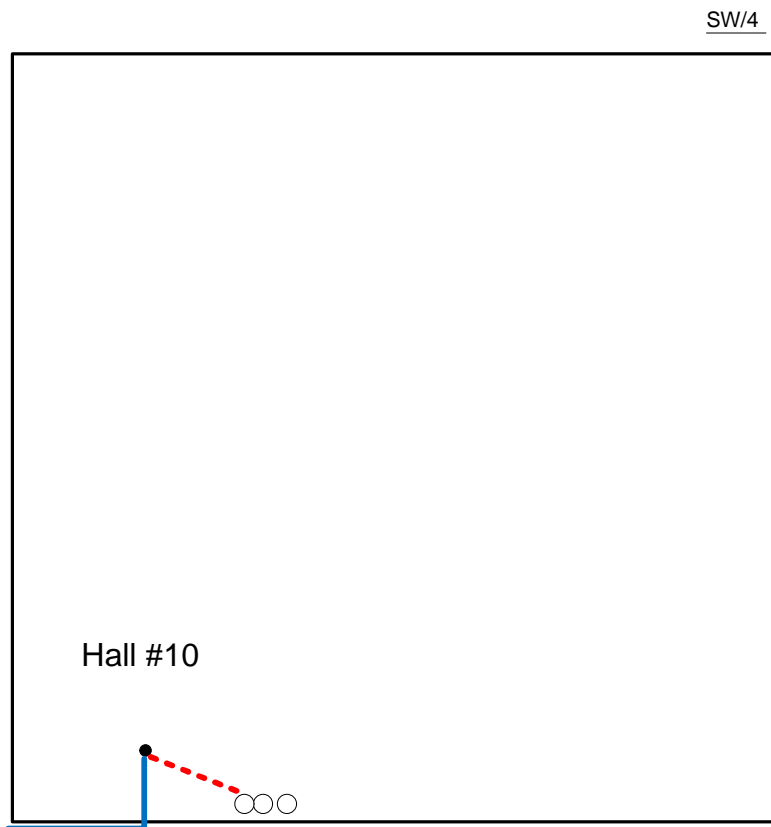

SW/4

- Well Location
- Proposed Lease Roads
- - - Proposed Pipeline
- Proposed Tank Battery
- Proposed Power Lines
- - - Existing Pipeline

Hall #10

The Tank Battery for the Hall #10 is located in the SW of the SW quarter

Proposed Details of SW/4 Sec 16 - T30S - R32W

Note-Drawing **Not** to Scale

Proposed Site Diagram  
Hall #10  
January 16, 2014

