

Mull Drilling Company, Inc.
Proposed Location of Roads, Lines and Tank Battery

Well Name:	Rufenacht #1-11
Well Location:	1966' FNL & 1642' FEL
	Section 11-T17S-R24W
	Ness County, KS

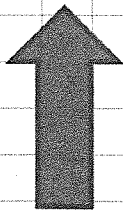

North

NE/4 of Section 11, Township 17 South, Range 24 West

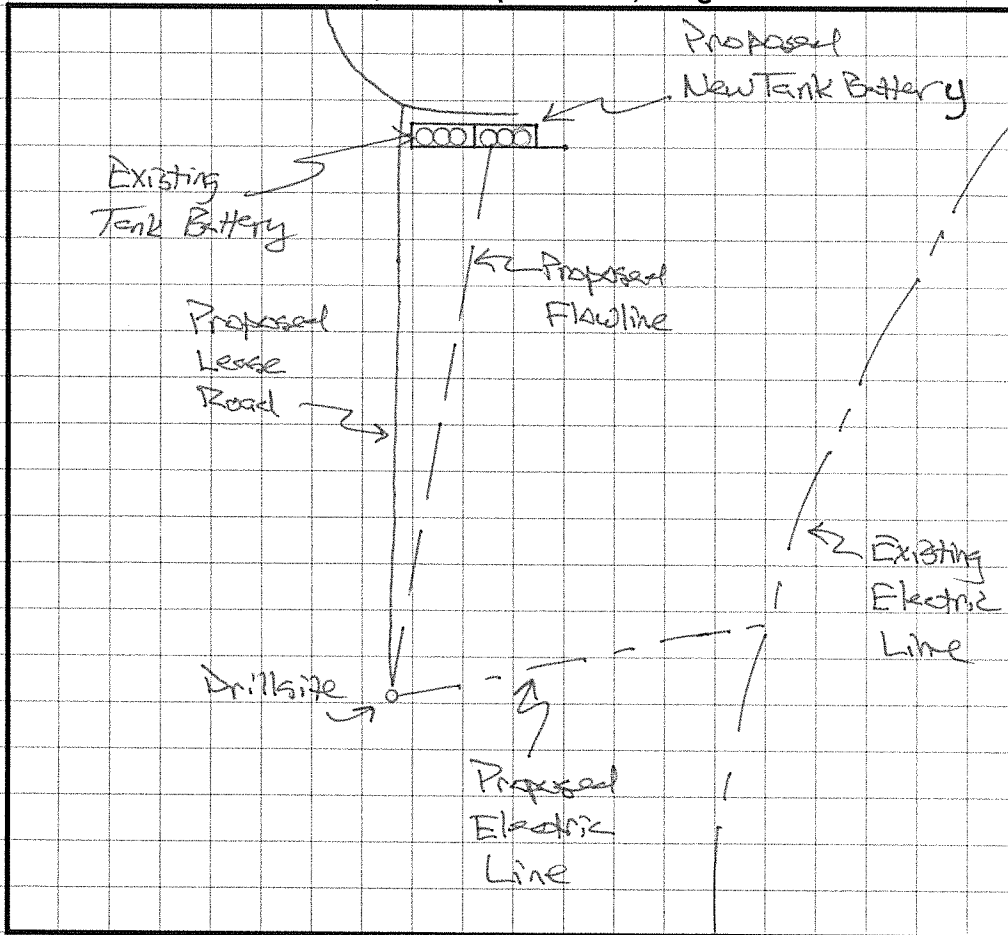

Scale

