

**TOPOGRAPHIC LAND SURVEYORS**

6709 NORTH CLASSEN BLVD., OKLA. CITY, OKLA. 73116 \* LOCAL (405) 843-4847 \* OUT OF STATE (800) 654-3219  
 Certificate of Authorization No. LS-99, Exp. Dec. 31, 2013

HARPER

County, Kansas

220'FNL-1700'FEL Section 11 Township 34S Range 5W P.M.

151' NORTHEAST TO PROPOSED WILSON 3405 4-2H

IRON PIPE  
 X= 2193055  
 Y= 162215

IRON ROD  
 X= 2198444  
 Y= 162269

20' NORTH TO PROPOSED WILSON 3405 2-2H

150' EAST TO PROPOSED WILSON 3405 3-11H



GRID  
 NAD-27  
 Kansas South  
 US Feet

Note:  
 3.280833 Ft.=1 Meter  
 Scale:  
 1" = 1000'  
 0' 500' 1000'

IRON ROD  
 X= 2193133  
 Y= 156937

Bottom Hole  
 330'FSL-1980'FEL  
 NAD-27 (US Feet)  
 37°05'48.2"N  
 97°49'35.1"W  
 37.096731533°N  
 97.826418196°W  
 X= 2196468  
 Y= 157305

IRON ROD  
 X= 2198449  
 Y= 156998

Bottom Hole information provided by operator listed, NOT Surveyed; Corner Coordinates are taken from points surveyed in the field.

Distances shown in (parenthesis) are calculated based upon the Quarter Section being 2640 feet, those shown in [brackets] are based on GLO (General Land Office) distances and have NOT been measured on the ground.

A boundary survey of the said section(s) shown hereon was not performed per the request of the operator shown hereon.

Operator: SANDRIDGE EXPLORATION & PRODUCTION, LLC

Lease Name: WILSON 3405

Well No.: 1-11H

**ELEVATION:**

1255' Gr. at Stake

Topography & Vegetation Loc. fell in level wheat field over 500' SW of church

Good Drill Site? Yes Reference Stakes or Alternate Location Stakes Set None

Best Accessibility to Location From North off county road

Distance & Direction from Hwy Jct or Town From Bluff City, KS., go East ±3.0 mi., then North ±2.0 mi. to the NE corner of Section 11-T34S-R5W

Revision  A Date of Drawing: Dec. 18, 2013

Invoice #211671A Date Staked: Nov. 20, 2013

JAL

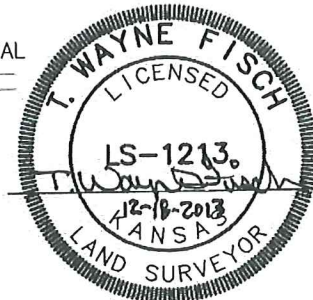

This information was gathered with a GPS receiver with ±1 foot Horiz./Vert. accuracy.

DATUM: NAD-27  
 LAT: 37°06'34.9"N  
 LONG: 97°49'31.3"W  
 LAT: 37.109706170°N  
 LONG: 97.825356411°W  
 STATE PLANE  
 COORDINATES: (US Feet)  
 ZONE: KS SOUTH  
 X: 2196744  
 Y: 162032

**CERTIFICATE:**

I, T. Wayne Fisch a Kansas Licensed Land Surveyor and an authorized agent of Topographic Land Surveyors, do hereby certify that the above described well location was surveyed and staked on the ground as shown herein.

# Wilson 3405 1-11H

## Harper County

### Unit Description:

E/2 of 2-34S-5W and E/2 of 11-34S-5W

### Surface Owners:

Andrew M. Jelinek, Life Estate

3236 E. Navajo Lane

Wichita, KS 67216

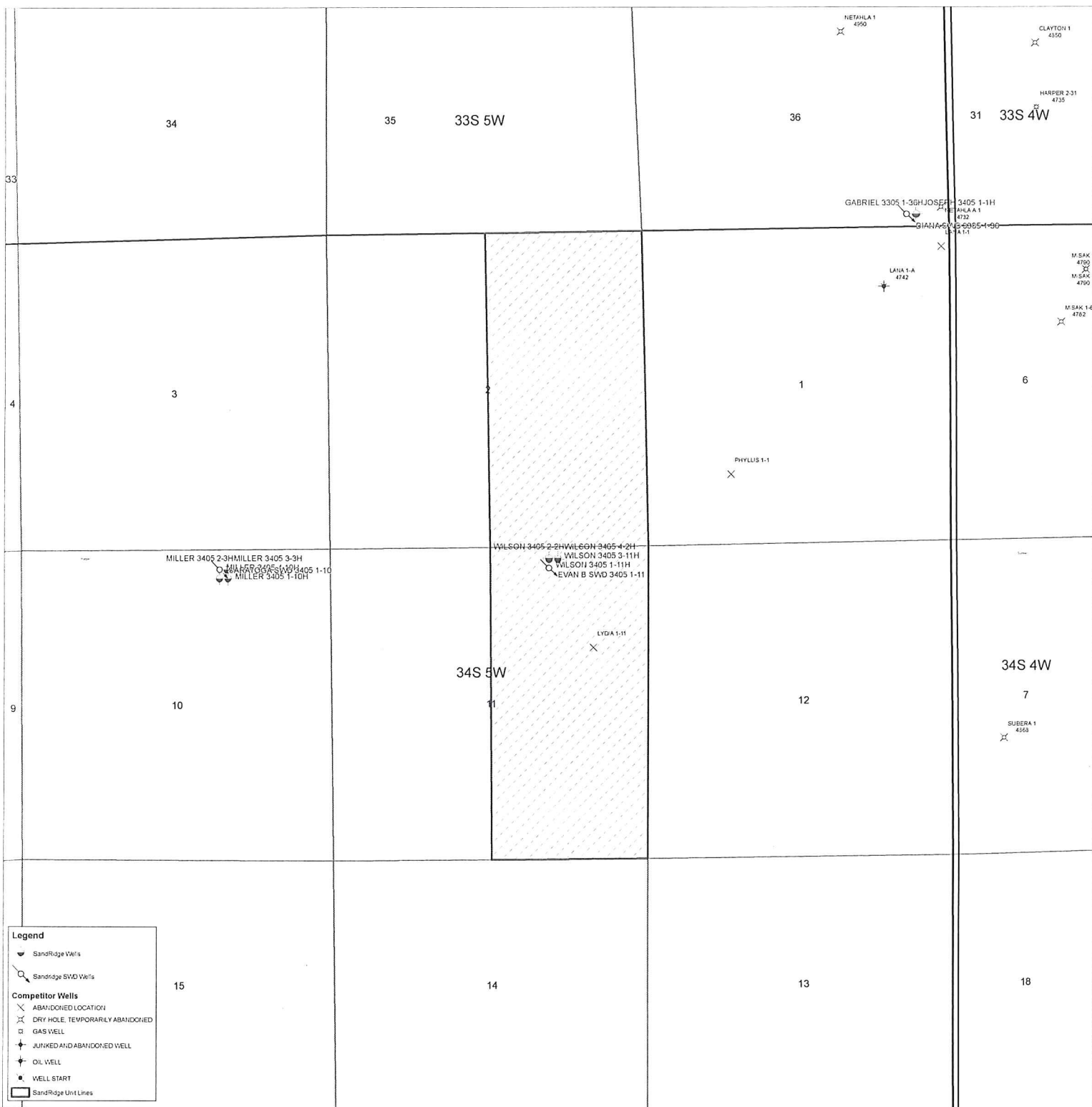

**Legend**

- ▼ SandRidge Wells
- SandRidge SWD Wells
- Competitor Wells**
- ✕ ABANDONED LOCATION
- ✕ DRY HOLE, TEMPORARILY ABANDONED
- GAS WELL
- ✕ JUNKED AND ABANDONED WELL
- ✕ OIL WELL
- WELL START
- ▭ SandRidge Unit Lines

Proposed Entrance

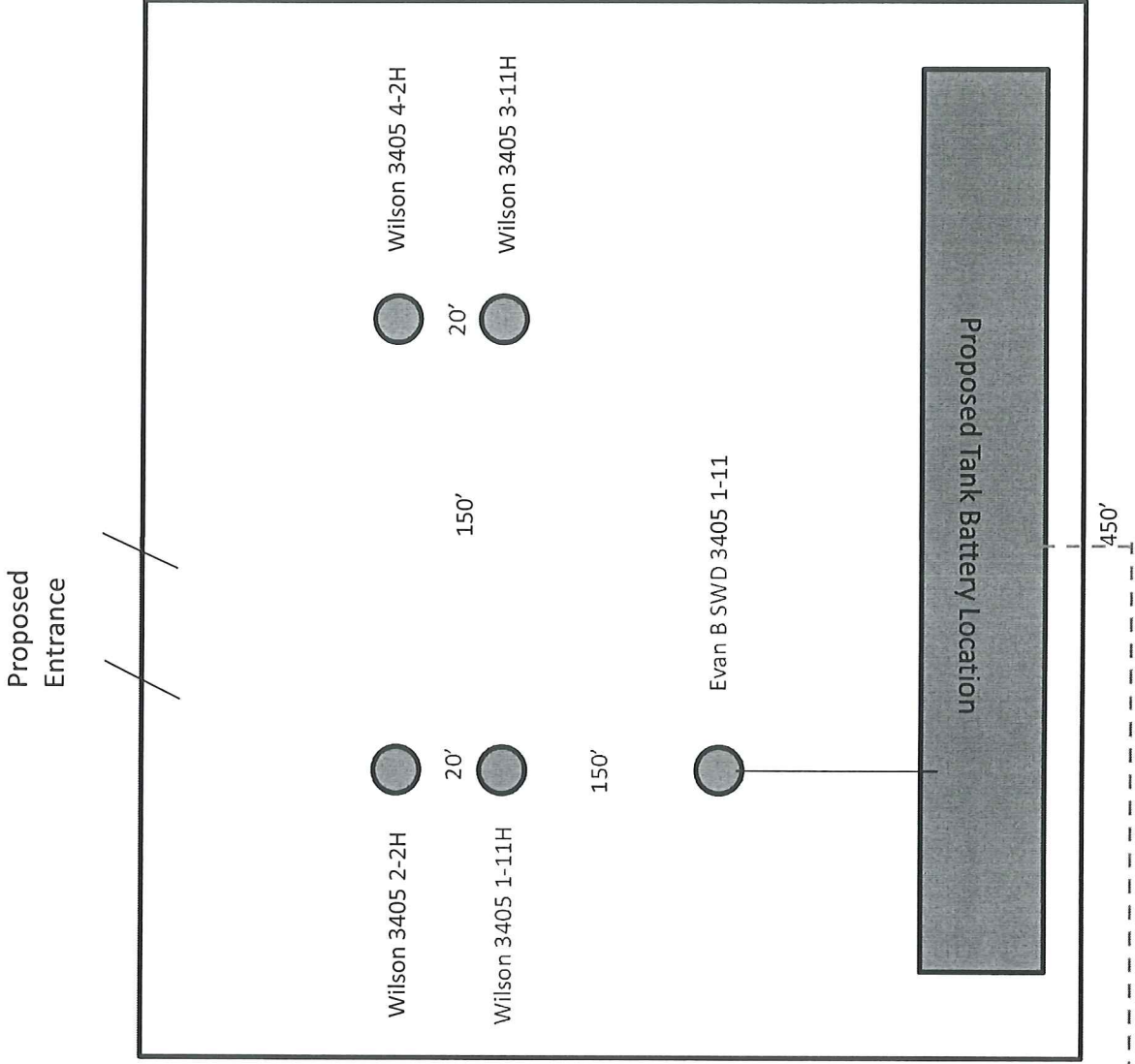

Proposed Electric Line

450'

450'