

# KSONA - Potential Tank Battery Location and Lease Road

## PLOT OF THE INTENDED WELL

Operator: McCoy Petroleum Corporation  
 Lease: SCHWAB "A" #1-7  
 Well Number: #1-7  
 Field: Wildcat  
 Number of Acres attributable to well: 160  
 QTR/QTR/QTR/QTR of acreage: \_\_\_\_\_ SE

Location of Well: County: E2 NE SE Meade Co., KS  
 \_\_\_\_\_ 1980 feet from  N /  S Line of Section  
 \_\_\_\_\_ 330 feet from  E /  W Line of Section  
 Sec 7 Twp. 30 S Rng. 30  E  W  
 Is Section  Regular or  Irregular

**If Section is Irregular, locate well from nearest corner boundary.**  
 Section corner used:  NE  NW  SE  SW

### PLAT

*Show the predicted locations of lease roads, tank batteries, pipelines and electrical lines,  
 as required by the Kansas Surface Owner Notice Act (House Bill 2032).*

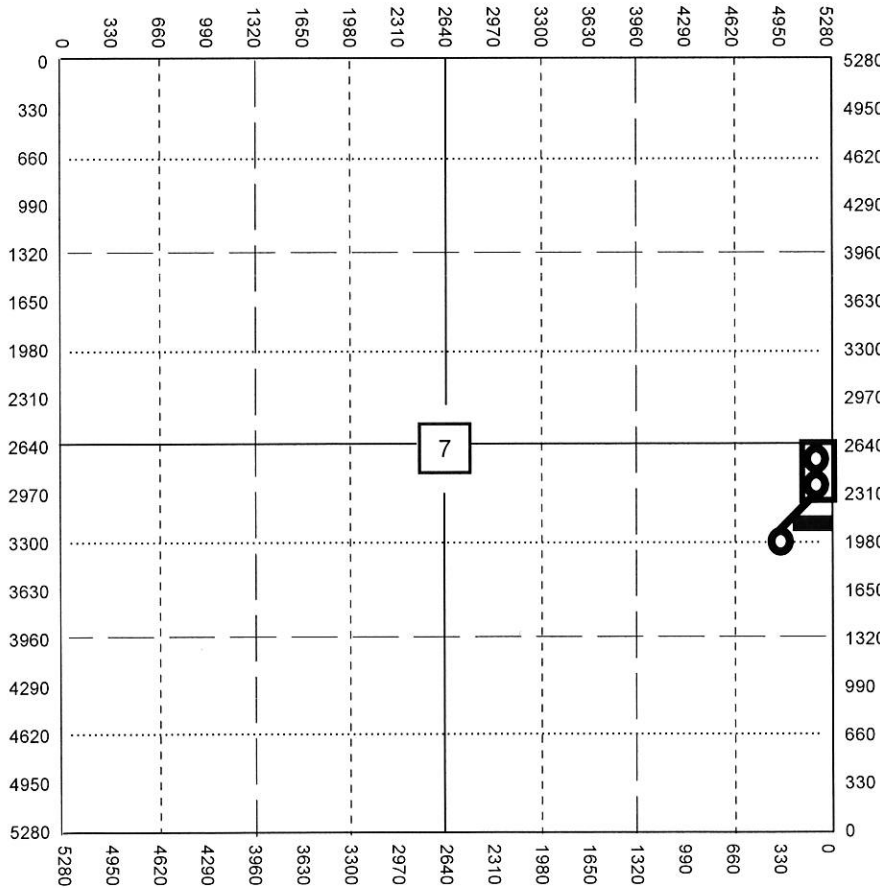

- LEGEND**
- Well Location
  - Tank Battery Location
  - Pipeline Location
  - Electric Line Location
  - Lease Road Location

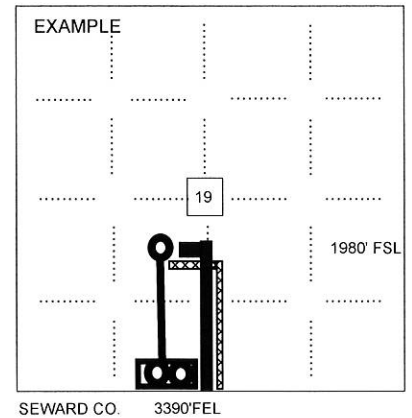

**NOTE: Spot of the proposed drilling location.**