



Confidentiality Requested:

Yes  No

KANSAS CORPORATION COMMISSION 1194986  
OIL & GAS CONSERVATION DIVISION

Form ACO-1

August 2013

Form must be Typed  
Form must be Signed  
All blanks must be Filled

WELL COMPLETION FORM  
WELL HISTORY - DESCRIPTION OF WELL & LEASE

OPERATOR: License # \_\_\_\_\_

Name: \_\_\_\_\_

Address 1: \_\_\_\_\_

Address 2: \_\_\_\_\_

City: \_\_\_\_\_ State: \_\_\_\_\_ Zip: \_\_\_\_\_ + \_\_\_\_\_

Contact Person: \_\_\_\_\_

Phone: ( \_\_\_\_\_ ) \_\_\_\_\_

CONTRACTOR: License # \_\_\_\_\_

Name: \_\_\_\_\_

Wellsite Geologist: \_\_\_\_\_

Purchaser: \_\_\_\_\_

Designate Type of Completion:

- New Well       Re-Entry       Workover
- Oil       WSW       SWD       SIOW
- Gas       D&A       ENHR       SIGW
- OG       GSW       Temp. Abd.
- CM (Coal Bed Methane)
- Cathodic       Other (Core, Expl., etc.): \_\_\_\_\_

If Workover/Re-entry: Old Well Info as follows:

Operator: \_\_\_\_\_

Well Name: \_\_\_\_\_

Original Comp. Date: \_\_\_\_\_ Original Total Depth: \_\_\_\_\_

- Deepening       Re-perf.       Conv. to ENHR       Conv. to SWD
- Plug Back       Conv. to GSW       Conv. to Producer
- Commingled      Permit #: \_\_\_\_\_
- Dual Completion      Permit #: \_\_\_\_\_
- SWD      Permit #: \_\_\_\_\_
- ENHR      Permit #: \_\_\_\_\_
- GSW      Permit #: \_\_\_\_\_

Spud Date or Recompletion Date	Date Reached TD	Completion Date or Recompletion Date
-----------------------------------	-----------------	---

API No. 15 - \_\_\_\_\_

Spot Description: \_\_\_\_\_

\_\_\_\_\_ - \_\_\_\_\_ - \_\_\_\_\_ Sec. \_\_\_\_\_ Twp. \_\_\_\_\_ S. R. \_\_\_\_\_  East  West

\_\_\_\_\_ Feet from  North /  South Line of Section

\_\_\_\_\_ Feet from  East /  West Line of Section

Footages Calculated from Nearest Outside Section Corner:

- NE       NW       SE       SW

GPS Location: Lat: \_\_\_\_\_, Long: \_\_\_\_\_  
(e.g. xx.xxxxx) (e.g. -xxx.xxxxx)

Datum:  NAD27       NAD83       WGS84

County: \_\_\_\_\_

Lease Name: \_\_\_\_\_ Well #: \_\_\_\_\_

Field Name: \_\_\_\_\_

Producing Formation: \_\_\_\_\_

Elevation: Ground: \_\_\_\_\_ Kelly Bushing: \_\_\_\_\_

Total Vertical Depth: \_\_\_\_\_ Plug Back Total Depth: \_\_\_\_\_

Amount of Surface Pipe Set and Cemented at: \_\_\_\_\_ Feet

Multiple Stage Cementing Collar Used?  Yes  No

If yes, show depth set: \_\_\_\_\_ Feet

If Alternate II completion, cement circulated from: \_\_\_\_\_

feet depth to: \_\_\_\_\_ w/ \_\_\_\_\_ sx cmt.

Drilling Fluid Management Plan

(Data must be collected from the Reserve Pit)

Chloride content: \_\_\_\_\_ ppm Fluid volume: \_\_\_\_\_ bbls

Dewatering method used: \_\_\_\_\_

Location of fluid disposal if hauled offsite:

Operator Name: \_\_\_\_\_

Lease Name: \_\_\_\_\_ License #: \_\_\_\_\_

Quarter \_\_\_\_\_ Sec. \_\_\_\_\_ Twp. \_\_\_\_\_ S. R. \_\_\_\_\_  East  West

County: \_\_\_\_\_ Permit #: \_\_\_\_\_

AFFIDAVIT

I am the affiant and I hereby certify that all requirements of the statutes, rules and regulations promulgated to regulate the oil and gas industry have been fully complied with and the statements herein are complete and correct to the best of my knowledge.

Submitted Electronically

KCC Office Use ONLY

- Confidentiality Requested  
Date: \_\_\_\_\_
- Confidential Release Date: \_\_\_\_\_
- Wireline Log Received
- Geologist Report Received
- UIC Distribution
- ALT  I  II  III Approved by: \_\_\_\_\_ Date: \_\_\_\_\_

1194986

Operator Name: \_\_\_\_\_ Lease Name: \_\_\_\_\_ Well #: \_\_\_\_\_

Sec. \_\_\_\_\_ Twp. \_\_\_\_\_ S. R. \_\_\_\_\_  East  West County: \_\_\_\_\_

**INSTRUCTIONS:** Show important tops of formations penetrated. Detail all cores. Report all final copies of drill stems tests giving interval tested, time tool open and closed, flowing and shut-in pressures, whether shut-in pressure reached static level, hydrostatic pressures, bottom hole temperature, fluid recovery, and flow rates if gas to surface test, along with final chart(s). Attach extra sheet if more space is needed.

Final Radioactivity Log, Final Logs run to obtain Geophysical Data and Final Electric Logs must be emailed to kcc-well-logs@kcc.ks.gov. Digital electronic log files must be submitted in LAS version 2.0 or newer AND an image file (TIFF or PDF).

Drill Stem Tests Taken <input type="checkbox"/> Yes <input type="checkbox"/> No <i>(Attach Additional Sheets)</i>  Samples Sent to Geological Survey <input type="checkbox"/> Yes <input type="checkbox"/> No  Cores Taken <input type="checkbox"/> Yes <input type="checkbox"/> No Electric Log Run <input type="checkbox"/> Yes <input type="checkbox"/> No  List All E. Logs Run: _____	<input type="checkbox"/> Log Formation (Top), Depth and Datum <input type="checkbox"/> Sample  Name Top Datum
--	---

CASING RECORD <input type="checkbox"/> New <input type="checkbox"/> Used							
Report all strings set-conductor, surface, intermediate, production, etc.							
Purpose of String	Size Hole Drilled	Size Casing Set (In O.D.)	Weight Lbs. / Ft.	Setting Depth	Type of Cement	# Sacks Used	Type and Percent Additives

ADDITIONAL CEMENTING / SQUEEZE RECORD				
Purpose:	Depth Top Bottom	Type of Cement	# Sacks Used	Type and Percent Additives
<input type="checkbox"/> Perforate <input type="checkbox"/> Protect Casing <input type="checkbox"/> Plug Back TD <input type="checkbox"/> Plug Off Zone				

Did you perform a hydraulic fracturing treatment on this well?  Yes  No *(If No, skip questions 2 and 3)*

Does the volume of the total base fluid of the hydraulic fracturing treatment exceed 350,000 gallons?  Yes  No *(If No, skip question 3)*

Was the hydraulic fracturing treatment information submitted to the chemical disclosure registry?  Yes  No *(If No, fill out Page Three of the ACO-1)*

Shots Per Foot	PERFORATION RECORD - Bridge Plugs Set/Type Specify Footage of Each Interval Perforated	Acid, Fracture, Shot, Cement Squeeze Record <i>(Amount and Kind of Material Used)</i>	Depth

TUBING RECORD:	Size:	Set At:	Packer At:	Liner Run: <input type="checkbox"/> Yes <input type="checkbox"/> No
----------------	-------	---------	------------	---

Date of First, Resumed Production, SWD or ENHR.	Producing Method: <input type="checkbox"/> Flowing <input type="checkbox"/> Pumping <input type="checkbox"/> Gas Lift <input type="checkbox"/> Other <i>(Explain)</i> _____
---	--

Estimated Production Per 24 Hours	Oil Bbls.	Gas Mcf	Water Bbls.	Gas-Oil Ratio	Gravity

<b>DISPOSITION OF GAS:</b> <input type="checkbox"/> Vented <input type="checkbox"/> Sold <input type="checkbox"/> Used on Lease <i>(If vented, Submit ACO-18.)</i>	<b>METHOD OF COMPLETION:</b> <input type="checkbox"/> Open Hole <input type="checkbox"/> Perf. <input type="checkbox"/> Dually Comp. <input type="checkbox"/> Commingled <i>(Submit ACO-5)</i> <input type="checkbox"/> Other <i>(Specify)</i> _____	<b>PRODUCTION INTERVAL:</b> _____ _____
--	--	---



# ALLIED OIL & GAS SERVICES, LLC 061074

Federal Tax I.D. # 20-8651475

SHIP TO P.O. BOX 93999  
SOUTHLAKE, TEXAS 76092

SERVICE POINT:  
Great Bend, KS

DATE	SEC.	TWP.	RANGE	CALLED OUT	ON LOCATION	JOB START	JOB FINISH
12-11-13						12:00 PM	1:00 PM
LEASE	J. Foulston	36-32-25-32H	WELL #	LOCATION F-135 & 254 E Robert Rd 5N		COUNTY	STATE
OLD OR NEW (Circle one)				NE 3N 1/2 E 1/2 N E into		Butler	KS

CONTRACTOR Nabors #113  
 TYPE OF JOB Surf Casing  
 HOLE SIZE \_\_\_\_\_ T.D. \_\_\_\_\_  
 CASING SIZE 9 5/8 DEPTH 344.69  
 TUBING SIZE \_\_\_\_\_ DEPTH \_\_\_\_\_  
 DRILL PIPE \_\_\_\_\_ DEPTH \_\_\_\_\_  
 TOOL \_\_\_\_\_ DEPTH \_\_\_\_\_  
 PRES. MAX \_\_\_\_\_ MINIMUM \_\_\_\_\_  
 MEAS. LINE \_\_\_\_\_ SHOE JOINT \_\_\_\_\_  
 CEMENT LEFT IN CSG. Load plug at shoe  
 PERFS. \_\_\_\_\_  
 DISPLACEMENT 26.95 bbls Displacement

OWNER \_\_\_\_\_  
 CEMENT AMOUNT ORDERED 2605 Ks Class A  
34" cc  
 COMMON 260 @ 17.90 4654.00  
 POZMIX \_\_\_\_\_ @ \_\_\_\_\_  
 GEL \_\_\_\_\_ @ \_\_\_\_\_  
 CHLORIDE 733 # @ .80 586.40  
 ASC \_\_\_\_\_ @ \_\_\_\_\_  
 HANDLING 272.99 x 2.43 @ ~~11.00~~ 677.01  
 MILEAGE 12.58 x 50 x 2.60 1635.40  
 TOTAL 7552.81

**EQUIPMENT**

PUMP TRUCK CEMENTER Dustin Chambers  
 # 398 HELPER Mike Southorn  
 BULK TRUCK  
 # 544-198 DRIVER Tommy Tijerina  
 BULK TRUCK  
 # \_\_\_\_\_ DRIVER \_\_\_\_\_

**REMARKS:**

pump 10 bbls fresh water ahead  
mix 2605 Ks Class A 34" cc  
shut down & release plug  
Displace 26.95 bbls fresh water  
bit pressure - 200 #  
load plug pressure - 900 #  
plug down - 12:10 pm  
put down cement in circulation 28 bbls  
top it

**SERVICE**

DEPTH OF JOB \_\_\_\_\_  
 PUMP TRUCK CHARGE 1512.25  
 EXTRA FOOTAGE \_\_\_\_\_ @ \_\_\_\_\_  
 MILEAGE \_\_\_\_\_ @ \_\_\_\_\_  
 MANIFOLD \_\_\_\_\_ @ \_\_\_\_\_  
 HV M -50 @ 7.70 385.00  
 LV M -50 @ 4.40 220.00  
 TOTAL 2117.25

CHARGE TO: Source Energy  
 WELL NAME J. Foulston  
 STREET 10003D  
 CITY 830100 STATE ARIZ # 7928.75  
 OL AOCY \_\_\_\_\_ FAIR \_\_\_\_\_ POOR \_\_\_\_\_  
 EXCELLENT \_\_\_\_\_ GOOD \_\_\_\_\_  
 DESCRIPTION CMT. 9.56" csg.

**PLUG & FLOAT EQUIPMENT**

2 9 5/8 floor shoe @ 668.03 668.03  
2 9 5/8 S.P. Ring @ 66.69 66.69  
4 9 5/8 centralizers @ 87.75 351.00  
1 9 5/8 Rubber Plug @ 184.96 184.96  
2 Thread Lock @ 83.07 166.14  
 TOTAL 1656.72

To: Supernova J.O. B.K.  
 Allied Oil & Gas Services, LLC.  
 You are hereby requested to rent cementing equipment and furnish cementer and helper(s) to assist owner or contractor to do work as is listed. The above work was done to satisfaction and supervision of owner agent or contractor. I have read and understand the "GENERAL TERMS AND CONDITIONS" listed on the reverse side.

SALES TAX (If Any) \_\_\_\_\_  
 TOTAL CHARGES 11326.78  
 DISCOUNT 30% = 3398.03 IF PAID IN 30 DAYS

PRINTED NAME X

SIGNATURE X

#7928.75

Thank you!!

# ALLIED OIL & GAS SERVICES, LLC 061049

Federal Tax I.D. # 20-8651475

REMIT TO P.O. BOX 93999  
SOUTHLAKE, TEXAS 76092

SERVICE POINT: East End K

DATE <u>12-14-13</u>	SEC. <u>36-32-25-</u>	TWP. <u>32H</u>	RANGE <u>254 &amp; Butler Rd, 5N, 4E,</u>	CALLED OUT <u>12:00 PM</u>	ON LOCATION <u>5:00 PM</u>	JOB START <u>9:00 PM</u>	JOB FINISH <u>10:30 PM</u>
LEASE <u>Foolston</u>	WELL # <u>32H</u>	LOCATION <u>254 &amp; Butler Rd, 5N, 4E,</u>			COUNTY <u>Butler</u>	STATE <u>Tx</u>	
OLD OR NEW (Circle one)			<u>3N, 1/2 E, 2N, East into</u>				

CONTRACTOR Nehors  
 TYPE OF JOB Intermediate  
 HOLE SIZE 8 3/4 T.D.  
 CASING SIZE 7" DEPTH 3148.56  
 TUBING SIZE DEPTH  
 DRILL PIPE DEPTH  
 TOOL DEPTH  
 PRES. MAX 1600 # MINIMUM 700 #  
 MEAS. LINE SHOE JOINT 46.48'  
 CEMENT LEFT IN CSG. 46.48'  
 PERFS.  
 DISPLACEMENT 123.5

OWNER Some  
 CEMENT  
 AMOUNT ORDERED 230 lb Class A  
0.650 Fl 1160, 0.1550 SA45, 350 Salt  
5# Admix per sack, 500 gal DU-1100  
 COMMON 230 @ 4112.00 4112.00  
 POZMIX @ \_\_\_\_\_  
 GEL @ \_\_\_\_\_  
 CHLORIDE @ \_\_\_\_\_  
 ASC @ \_\_\_\_\_  
 Fl-1160 130 # @ 18.90 2457.00  
 SA45 34 # @ 3.97 117.98  
 Salt 7 @ 26.35 184.45  
 Admix 1150 # @ .98 1127.00  
 @ \_\_\_\_\_  
 @ \_\_\_\_\_  
 @ \_\_\_\_\_  
 @ \_\_\_\_\_  
 HANDLING 2169.33 @ 2.48 662.94  
 MILEAGE 536.62 @ 2.60 1395.21  
 TOTAL 10,116.58

EQUIPMENT  
 PUMP TRUCK CEMENTER Wayne Down  
 # 597 HELPER Tom Nehors  
 BULK TRUCK  
 # 659-198 DRIVER Tom Tijerina TWS  
 BULK TRUCK  
 # DRIVER

REMARKS:  
Don 3145.56' of 2" org. Brake Circ.  
Pumped 5 bbls H<sub>2</sub>O, 500 gal DU 1100,  
5 bbls H<sub>2</sub>O, Mixed 130 lb weighing at  
14.8 & 100 lb weighing at 15.7# Released  
Plug. Displaced with H<sub>2</sub>O. Loaded Plug  
at #1 Released & Reset Hole.  
Unit atm Hook to RO P & Pressured  
to 3000# - Hold. Fumbled 100 AM  
12-15-13

CHARGE TO 5 L Foolston 36-32-25-32H  
 Well/AFE# 10083-D  
 STREET CT 832.100 AMT \$ 12,019.18  
 GL ACCT AMT \$  
 CITY EXCELLENT: X3000 FAIR ZIP POOR  
 DESCRIPTION CEMENT 7" Intermediate  
TPST Casing + Park DFE  
 SIGNATURE By Rob DATE 12-15-13  
 SUPERVISOR B.K.

To: Allied Oil & Gas Services, LLC.  
 You are hereby requested to rent cementing equipment and furnish cementer and helper(s) to assist owner or contractor to do work as is listed. The above work was done to satisfaction and supervision of owner agent or contractor. I have read and understand the "GENERAL TERMS AND CONDITIONS" listed on the reverse side.

PRINTED NAME X Barry Bristow  
 SIGNATURE X Barry Bristow

SERVICE  
 DEPTH OF JOB 3148.56  
 PUMP TRUCK CHARGE 2558.75  
 EXTRA FOOTAGE @ \_\_\_\_\_  
 MILEAGE 40 @ 7.70 308.00  
 MANIFOLD Hard Pipe @ 275.00 275.00  
 LVM 40 @ 4.40 176.00  
 Misc. Pump charge @ 2915.00 2915.00  
 TOTAL 6232.75

PLUG & FLOAT EQUIPMENT  
 Mould Sheet @ 171.50 171.50  
 Sun Hill Float collar @ 450.00 450.00  
 Rudolph Plug @ 58.75 58.75  
 Thread Loc 1 @ 39.40 39.40  
 @ \_\_\_\_\_  
 TOTAL 719.85

SALES TAX (If Any) \_\_\_\_\_  
 TOTAL CHARGES 12,019.18  
 DISCOUNT \$ 459.29 IF PAID IN 30 DAYS  
\$ 12,427.89

# Source Energy MidCon, LLC Horiz Completion (NAD27) J. Foulston 36-32-25-32H

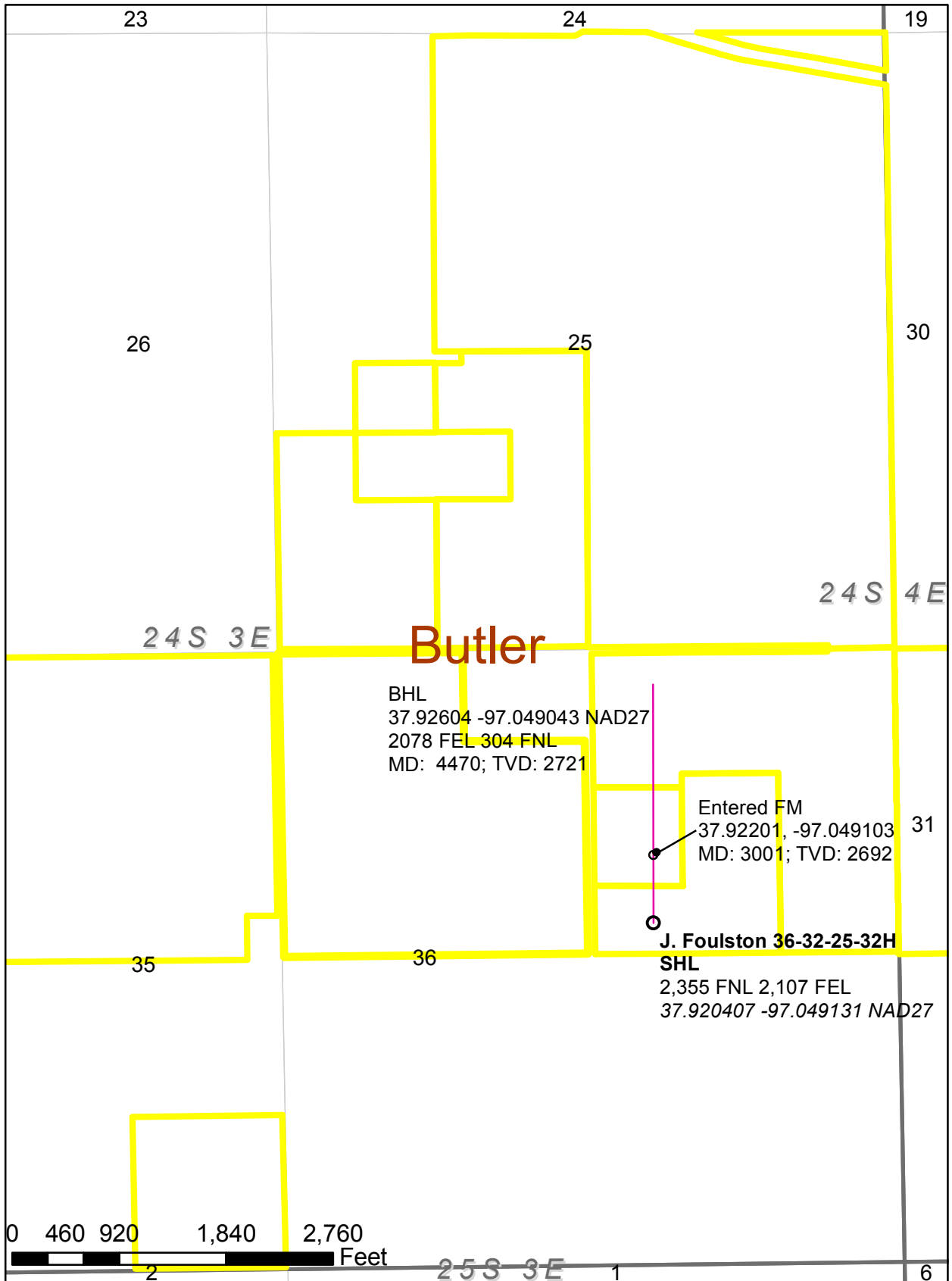

MD	INC	AZM	TVD	NS (Ft)	EW (Ft)	VS (Ft)	DLS
0.00	0.00	0.00	0.00	0.00	0.00	0.00	0.00
414.00	0.40	188.70	414.00	-1.43	-0.22	-1.42	0.10
507.00	0.30	196.90	506.99	-1.98	-0.34	-1.98	0.12
600.00	0.20	205.00	599.99	-2.36	-0.48	-2.35	0.11
693.00	0.20	191.70	692.99	-2.67	-0.58	-2.66	0.05
785.00	0.20	189.20	784.99	-2.98	-0.64	-2.97	0.01
877.00	0.30	182.00	876.99	-3.38	-0.67	-3.37	0.11
970.00	0.30	173.90	969.99	-3.87	-0.65	-3.86	0.05
1062.00	0.30	160.50	1061.99	-4.34	-0.55	-4.33	0.08
1156.00	0.20	100.40	1155.99	-4.60	-0.30	-4.59	0.28
1249.00	0.20	94.30	1248.99	-4.64	0.02	-4.64	0.02
1342.00	0.40	71.60	1341.99	-4.55	0.49	-4.56	0.25
1434.00	0.30	112.00	1433.99	-4.54	1.01	-4.55	0.28
1525.00	0.30	101.00	1524.98	-4.67	1.47	-4.70	0.06
1618.00	0.10	122.90	1617.98	-4.76	1.78	-4.79	0.23
1711.00	0.20	86.50	1710.98	-4.80	2.01	-4.83	0.14
1803.00	0.20	118.90	1802.98	-4.86	2.31	-4.90	0.12
1896.00	0.30	103.80	1895.98	-5.00	2.69	-5.05	0.13
1991.00	0.40	92.30	1990.98	-5.07	3.26	-5.13	0.13
2053.00	0.40	66.30	2052.98	-5.00	3.67	-5.06	0.29
2085.00	1.10	340.00	2084.98	-4.66	3.67	-4.72	3.58
2116.00	5.20	355.10	2115.92	-2.98	3.45	-3.04	13.38
2148.00	10.60	356.20	2147.61	1.40	3.13	1.35	16.88
2180.00	14.60	356.40	2178.83	8.37	2.68	8.32	12.50
2211.00	17.20	359.00	2208.64	16.85	2.36	16.81	8.69
2243.00	18.20	359.70	2239.13	26.58	2.25	26.54	3.19
2274.00	19.40	359.00	2268.47	36.57	2.13	36.53	3.94
2306.00	23.30	357.40	2298.27	48.21	1.75	48.17	12.32
2337.00	28.00	356.50	2326.21	61.61	1.03	61.58	15.21
2369.00	31.00	357.20	2354.06	77.34	0.17	77.32	9.44
2401.00	33.40	357.80	2381.13	94.37	-0.57	94.37	7.57
2433.00	35.00	357.80	2407.60	112.34	-1.26	112.35	5.00
2464.00	37.10	0.10	2432.66	130.58	-1.59	130.59	8.06
2496.00	38.80	0.60	2457.90	150.26	-1.47	150.26	5.40
2527.00	40.40	1.10	2481.78	170.02	-1.17	170.01	5.26
2559.00	43.90	0.60	2505.50	191.48	-0.86	191.47	10.99
2590.00	47.80	2.20	2527.09	213.72	-0.30	213.69	13.11
2622.00	50.30	1.80	2548.06	237.87	0.54	237.82	7.87
2654.00	52.10	1.80	2568.11	262.79	1.32	262.73	5.62
2685.00	56.30	1.80	2586.24	287.92	2.11	287.84	13.55
2717.00	61.40	0.10	2602.79	315.29	2.55	315.20	16.57
2748.00	66.10	359.20	2616.50	343.08	2.38	342.99	15.38
2780.00	70.20	359.40	2628.40	372.78	2.02	372.68	12.83
2811.00	70.30	359.70	2638.88	401.95	1.79	401.86	0.97
2843.00	70.20	359.50	2649.69	432.07	1.58	431.98	0.67
2875.00	70.30	359.50	2660.51	462.19	1.32	462.09	0.31
2906.00	72.50	359.50	2670.39	491.56	1.06	491.47	7.10
2938.00	75.60	358.80	2679.19	522.32	0.60	522.23	9.91
2970.00	78.50	357.90	2686.36	553.49	-0.30	553.41	9.47
3001.00	79.00	358.10	2692.40	583.88	-1.36	583.81	1.73
3032.00	80.30	357.90	2697.97	614.36	-2.42	614.30	4.24
3064.00	82.80	358.30	2702.68	645.99	-3.47	645.95	7.91
3164.00	89.70	0.40	2709.21	745.70	-4.60	745.67	7.21
3257.00	88.20	0.20	2710.92	838.68	-4.11	838.63	1.63

3349.00	90.90	359.70	2711.64	930.67	-4.19	930.60	2.98
3442.00	89.70	358.70	2711.15	1023.66	-5.49	1023.60	1.68
3534.00	88.80	357.90	2712.36	1115.61	-8.22	1115.58	1.31
3627.00	90.10	0.40	2713.25	1208.58	-9.60	1208.57	3.03
3719.00	91.60	1.30	2711.89	1300.56	-8.23	1300.51	1.90
3812.00	91.10	0.90	2709.69	1393.52	-6.45	1393.42	0.69
3906.00	89.80	0.20	2708.96	1487.51	-5.54	1487.38	1.57
3999.00	89.10	359.50	2709.85	1580.50	-5.79	1580.36	1.06
4091.00	88.80	0.10	2711.53	1672.48	-6.11	1672.34	0.73
4182.00	88.30	0.40	2713.84	1763.45	-5.71	1763.28	0.64
4275.00	89.00	0.20	2716.03	1856.43	-5.23	1856.23	0.78
4368.00	88.60	359.40	2717.98	1949.40	-5.55	1949.20	0.96
4470.00	88.60	359.40	2720.47	2051.37	-6.62	2051.17	0.00



# J Fouston 36-32-25-32H



## As Drilled Wellbore Diagram - NOT TO SCALE

Updated: 1/8/2014  
Location: Section 36 Township 25S Range 3E, Butler County, Kansas  
Field: Reloaded  
API Number: 15-015-24007 Elevations: GL 1287  
Target Zone: Mississippian Lime KB 1307.5  
SPUD Date: # KB 20.5

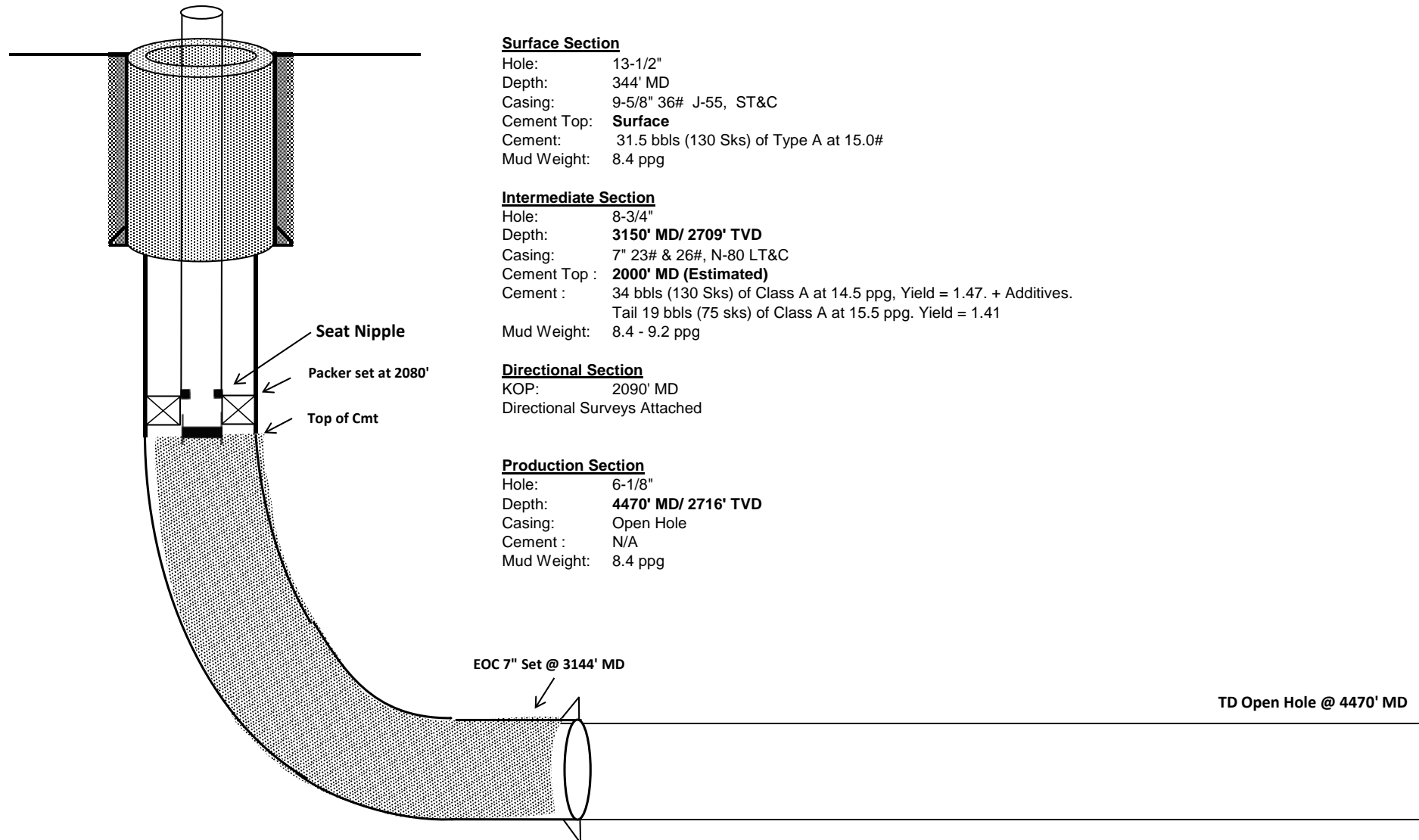

### Surface Section

Hole: 13-1/2"  
Depth: 344' MD  
Casing: 9-5/8" 36# J-55, ST&C  
Cement Top: **Surface**  
Cement: 31.5 bbls (130 Sks) of Type A at 15.0#  
Mud Weight: 8.4 ppg

### Intermediate Section

Hole: 8-3/4"  
Depth: **3150' MD/ 2709' TVD**  
Casing: 7" 23# & 26#, N-80 LT&C  
Cement Top : **2000' MD (Estimated)**  
Cement : 34 bbls (130 Sks) of Class A at 14.5 ppg, Yield = 1.47. + Additives.  
Tail 19 bbls (75 sks) of Class A at 15.5 ppg. Yield = 1.41  
Mud Weight: 8.4 - 9.2 ppg

### Directional Section

KOP: 2090' MD  
Directional Surveys Attached

### Production Section

Hole: 6-1/8"  
Depth: **4470' MD/ 2716' TVD**  
Casing: Open Hole  
Cement : N/A  
Mud Weight: 8.4 ppg

EOC 7" Set @ 3144' MD

TD Open Hole @ 4470' MD