

Mull Drilling Company, Inc.  
Proposed Location of Roads, Lines and Tank Battery

Well Name:	Curtis Unit #2-31
Well Location:	1512' FNL & 2582' FEL
	Section 31-T15S-R26W
	Gove County, KS

NE/4 of Section 31-T15S-R26W

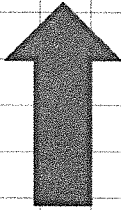

North

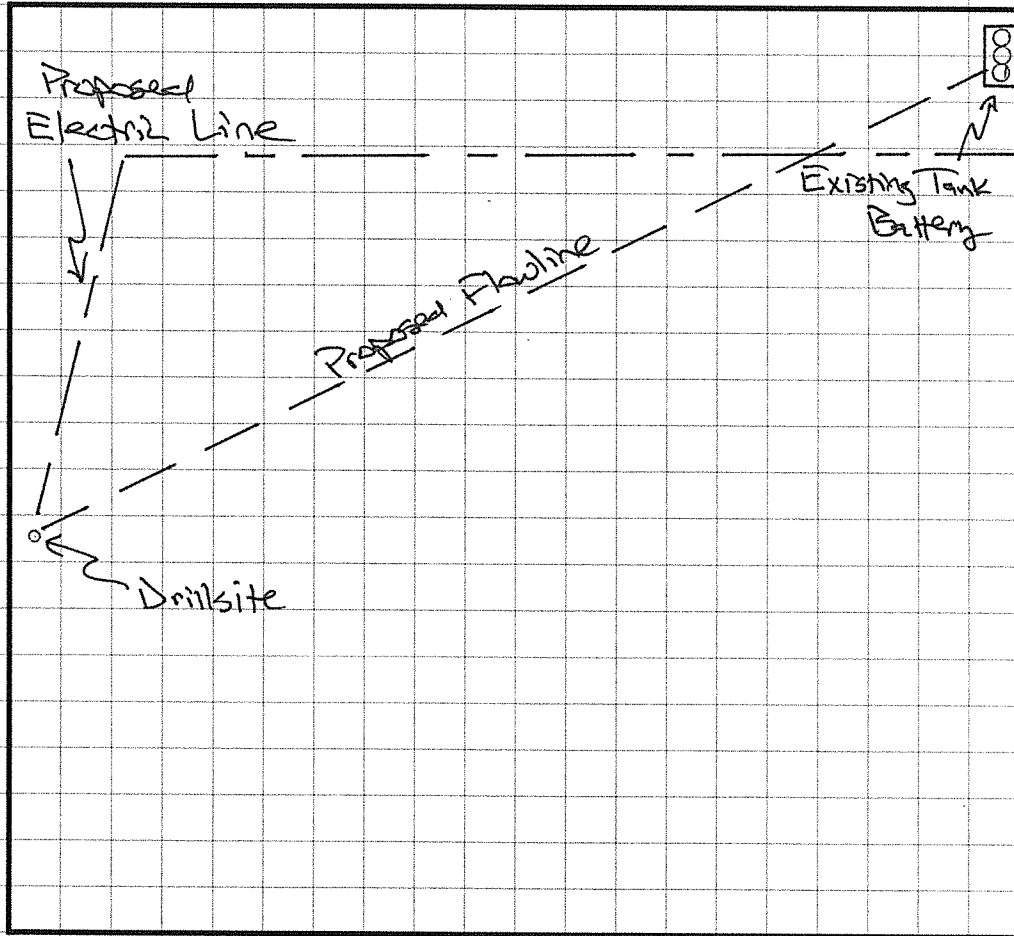

Scale

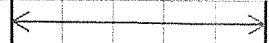

660'