

**OPERATOR :** Samuel Gary Jr & Associates, Inc 1515 Wynkoop Street, Suite 700  
Denver, Colorado 80202 office :303-831-4673 ; fax :303-863-7285

**WELL NAME :** HOFFMAN RANCHES 1-28

**LOCATION :** 1525 FNL / 330 FWL Sec. 28-17S-12W BARTON COUNTY

**SURFACE OWNER :** Hoffman Ranches, Inc.  
Victor Hoffman, President  
122 N. 130th Road  
Hoisington, KS 67544

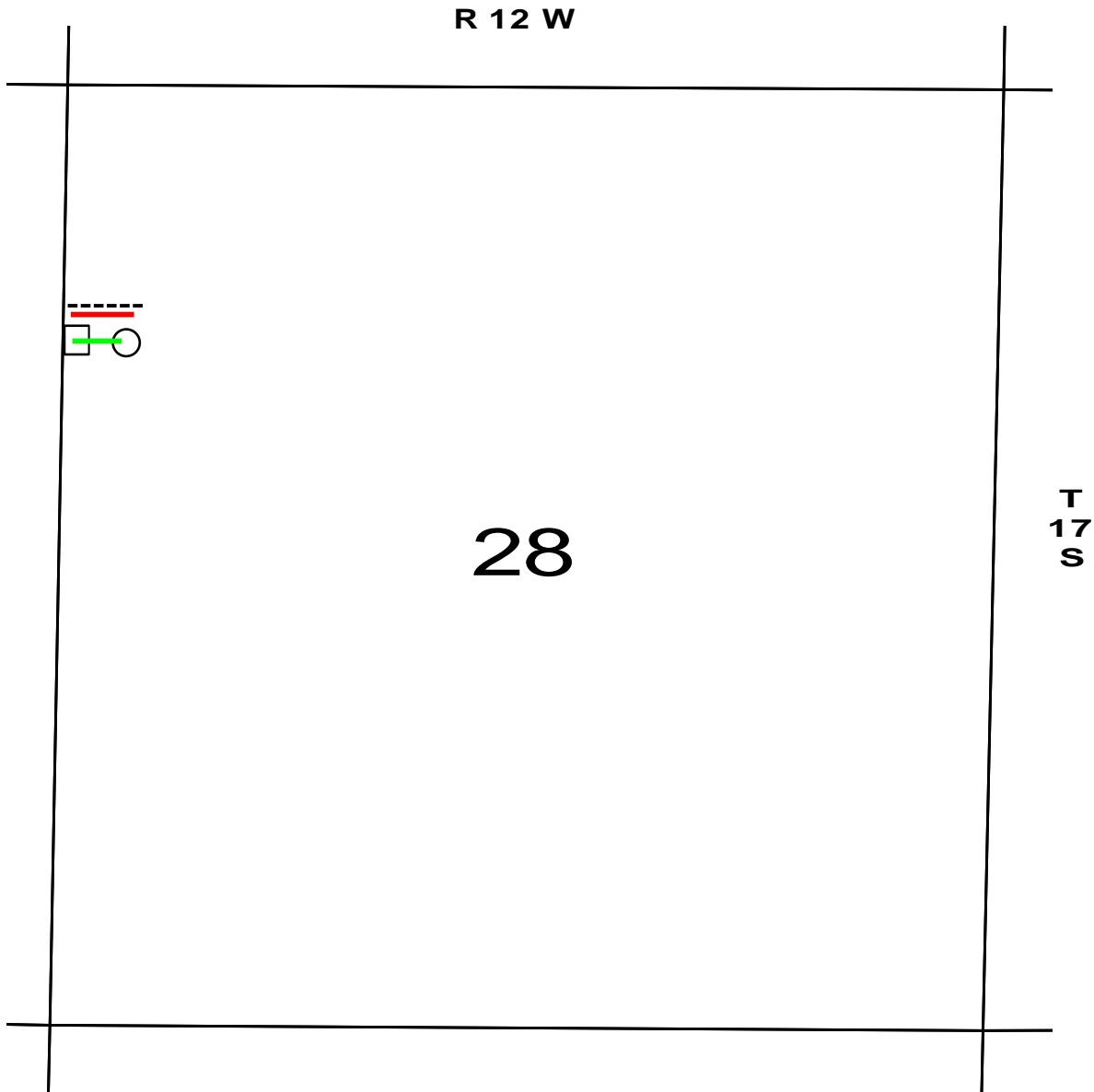

○ PROPOSED WELL LOCATION

□ ESTIMATED LOCATION OF TANK BATTERY

--- ESTIMATED LOCATION OF FLOW LINES

— ESTIMATED LOCATION OF ELECTRICAL LINES

--- ESTIMATED LOCATION OF LEASE ROAD