

ADVANTAGE ELEVATIONS

OIL FIELD SURVEYORS

BOX 8604 - PRATT, KS 67124
(620) 672-6491

424142
INVOICE NO.

MURFIN DRILLING CO INC 1-3 POUND
OPERATOR NO. FARM

Stafford 3 23s 12w 660' FNL & 330' FEL of Sec.
COUNTY S T R LOCATION

ELEVATION: 1830' GR



■ MURFIN DRILLING CO INC
250 N Water St., Ste 300
Wichita, KS 67202

AUTHORIZED BY: Shauna Gunzelman

One mile north,
two miles west
to SEc of Hudson,
KS.

SCALE: 1" = 1000'

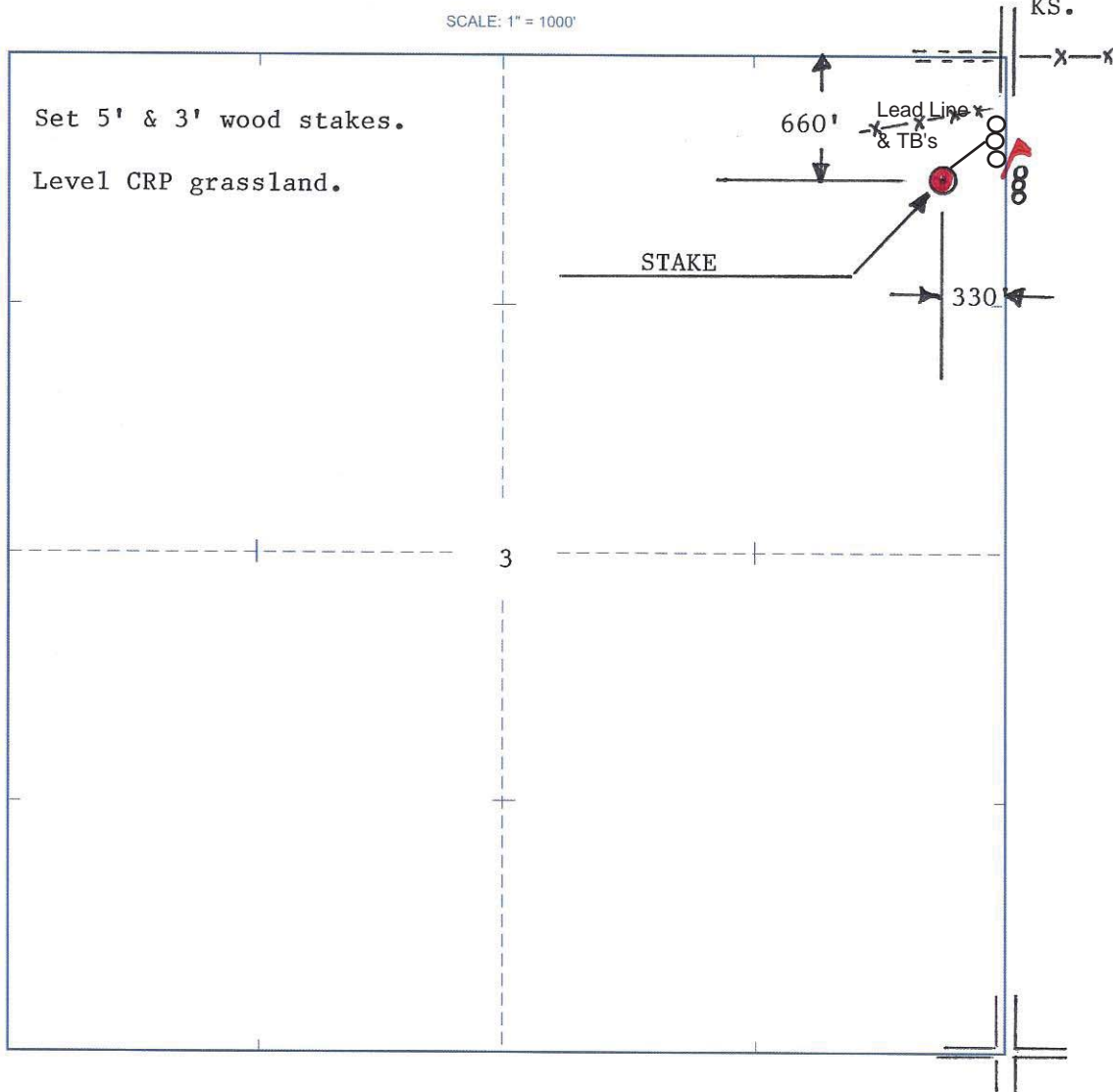

DATE STAKED: 4/24/14