

**TOPOGRAPHIC LAND SURVEYORS**

6709 NORTH CLASSEN BLVD., OKLA. CITY, OKLA. 73116 \* LOCAL (405) 843-4847 \* OUT OF STATE (800) 654-3219  
 Certificate of Authorization No. LS-99, Exp. Dec. 31, 2013

HARPER

County, Kansas

350' FNL-550' FWL Section 27 Township 34S Range 6W P.M.

IRON ROD  
 X= 2156022  
 Y= 145842

IRON ROD  
 X= 2181248  
 Y= 145911

20' NORTH TO THE PROPOSED  
 RUTH 3406 1-22H  
 151' NW TO THE PROPOSED  
 MOHR 3406 1-21H  
 150' WEST TO THE PROPOSED  
 YOUNG 3406 1-28H



GRID  
 NAD-27  
 Kansas South  
 US Feet

Note:  
 3.280833 Ft.=1 Meter  
 Scale:  
 1"= 1000'

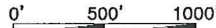

GLO STONE  
 X= 2181269  
 Y= 140632

Bottom Hole  
 330' FSL-1320' FWL  
 NAD-27 (US Feet)  
 37°03'08.7"N  
 97°57'38.5"W  
 37.052428032°N  
 97.960691338°W  
 X=2157398  
 Y=140919

IRON ROD  
 X= 2156081  
 Y= 140575

Bottom Hole Information Provided  
 by Operator Listed, NOT Surveyed.  
 Corner Coordinates are Taken  
 from Points Surveyed in the Field.

Distances shown in (parenthesis) are calculated based  
 upon the Quarter Section being 2640 feet, those shown  
 in [brackets] are based on GLO (General Land Office)  
 distances and have NOT been measured on the ground.

A boundary survey of the said section(s)  
 shown hereon was NOT performed per the  
 request of the operator shown hereon.

Operator: SANDRIDGE EXPLORATION & PRODUCTION, LLC

Lease Name: JOYCE 3406

Well No.: 1-27H

**ELEVATION:**

1320' Gr. at Stake

Topography & Vegetation: Loc. fell in sloped terraced wheat field South & East of SWD pipeline

Good Drill Site? Yes Reference Stakes or Alternate Location  
 Stakes Set None

Best Accessibility to Location: From North off county road

Distance & Direction from Hwy Jct or Town: From Anthony, KS, go ±6 miles South, then ±4 miles East to the

NW Cor. of Sec. 27-T34S-R6W

Revision  A Date of Drawing: Dec. 16, 2013  
 Invoice #211979C Date Staked: Nov. 22, 2013

LC

This information was gathered with a GPS receiver with ±1 foot Horiz./Vert. accuracy

DATUM: NAD-27  
 LAT: 37°03'54.1"N  
 LONG: 97°57'48.3"W  
 LAT: 37.065017627° N  
 LONG: 97.963416634° W  
 STATE PLANE  
 COORDINATES: (US Feet)  
 ZONE: KS SOUTH  
 X: 2156576  
 Y: 145499

**CERTIFICATE:**

I, T. Wayne Fisch a Kansas Licensed Land Surveyor and an authorized agent of Topographic Land Surveyors, do hereby certify that the above described well location was surveyed and staked on the ground as shown herein.

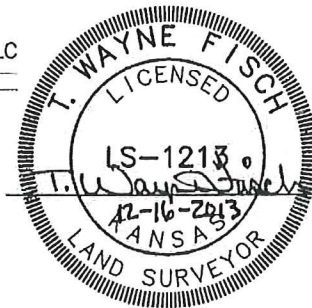

**Joyce 3406 1-27H**  
**Lease Information Sheet**

**Unit Description:**

W2 of Section 27, T34S-R06W  
Harper County

**Surface Owner:**

**William H Walker Trust No. 1 dated 10/1/1997**

Joyce E Walker; Joyce Frazier & John Walker as Trustees

**Joyce E Walker Trust No1 dated 10/1/1997**

Joyce E Walker, Joyce Frazier & John Walker as Trustees

420 N 5<sup>th</sup> Avenue, Apt. 8

Anthony, KS 67003

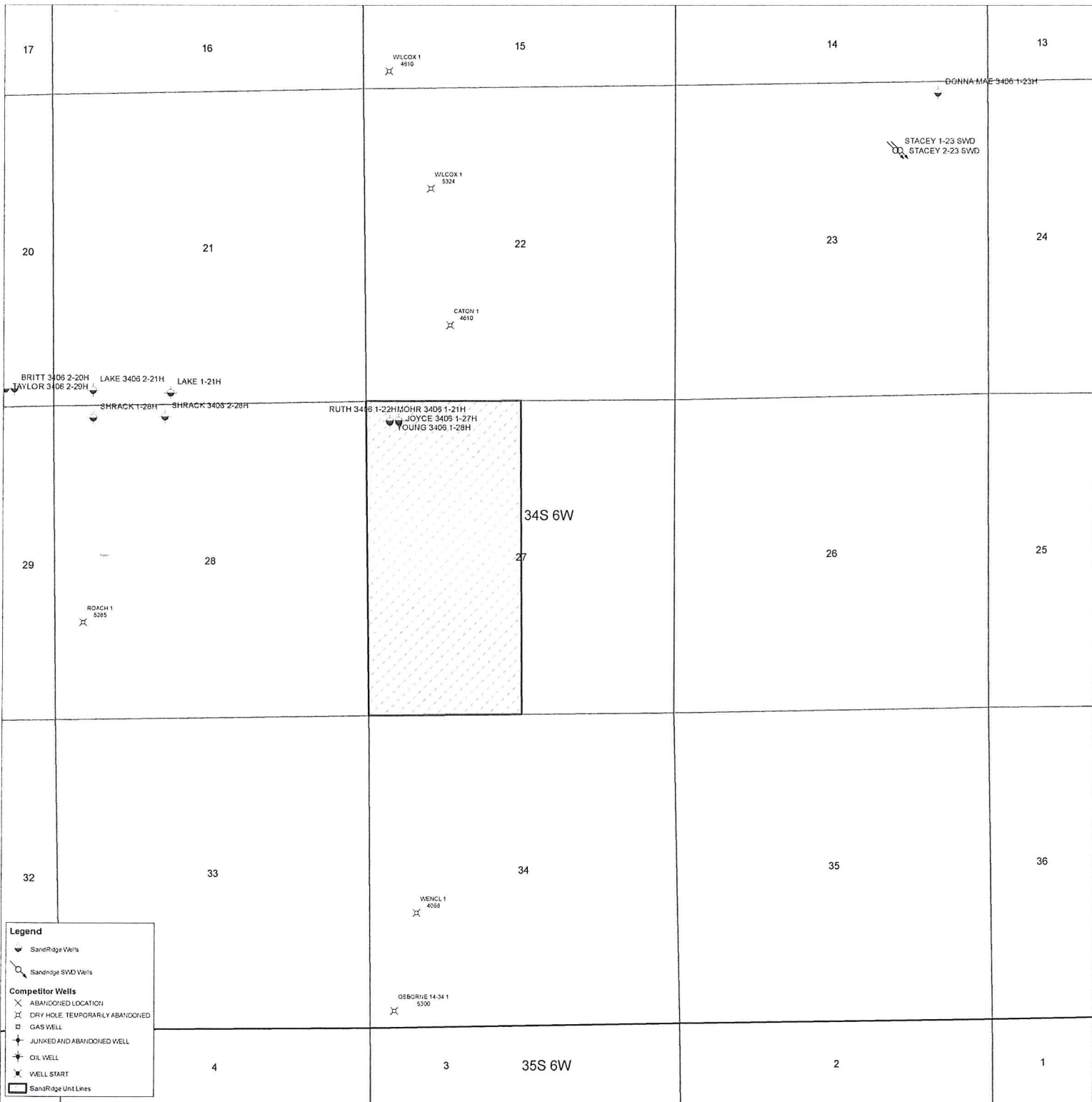

Young 3406 1-28H, Mohr 3406 1-21H, Ruth 3406 1-22H & Joyce 3406 1-27H

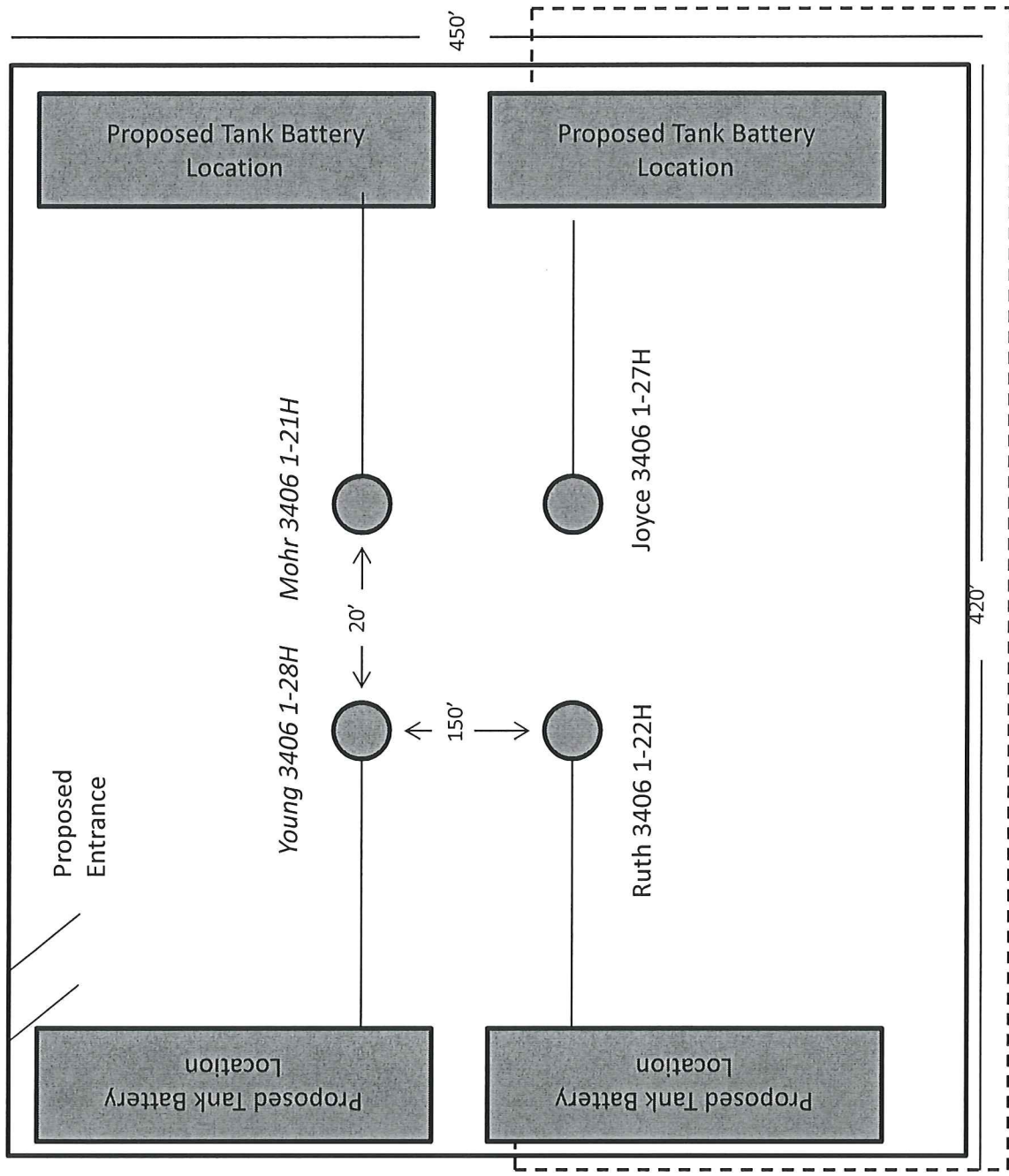

Proposed Electric Line