

ADVANTAGE ELEVATIONS

OIL FIELD SURVEYORS

BOX 8604 - PRATT, KS 67124
(620) 672-6491

424145
INVOICE NO.

MURFIN DRILLING CO INC 1-35 KLS
OPERATOR NO. FARM

Stafford 35 22s 12w 330' FSL & 330' FWL of Sec.
COUNTY S T R LOCATION

ELEVATION: 1831' GR



MURFIN DRILLING CO INC
250 N Water St. Ste 300
Wichita, KS 67202

AUTHORIZED BY: Shauna Gunzelman

2 miles west to
Hudson, KS

SCALE: 1" = 1000'

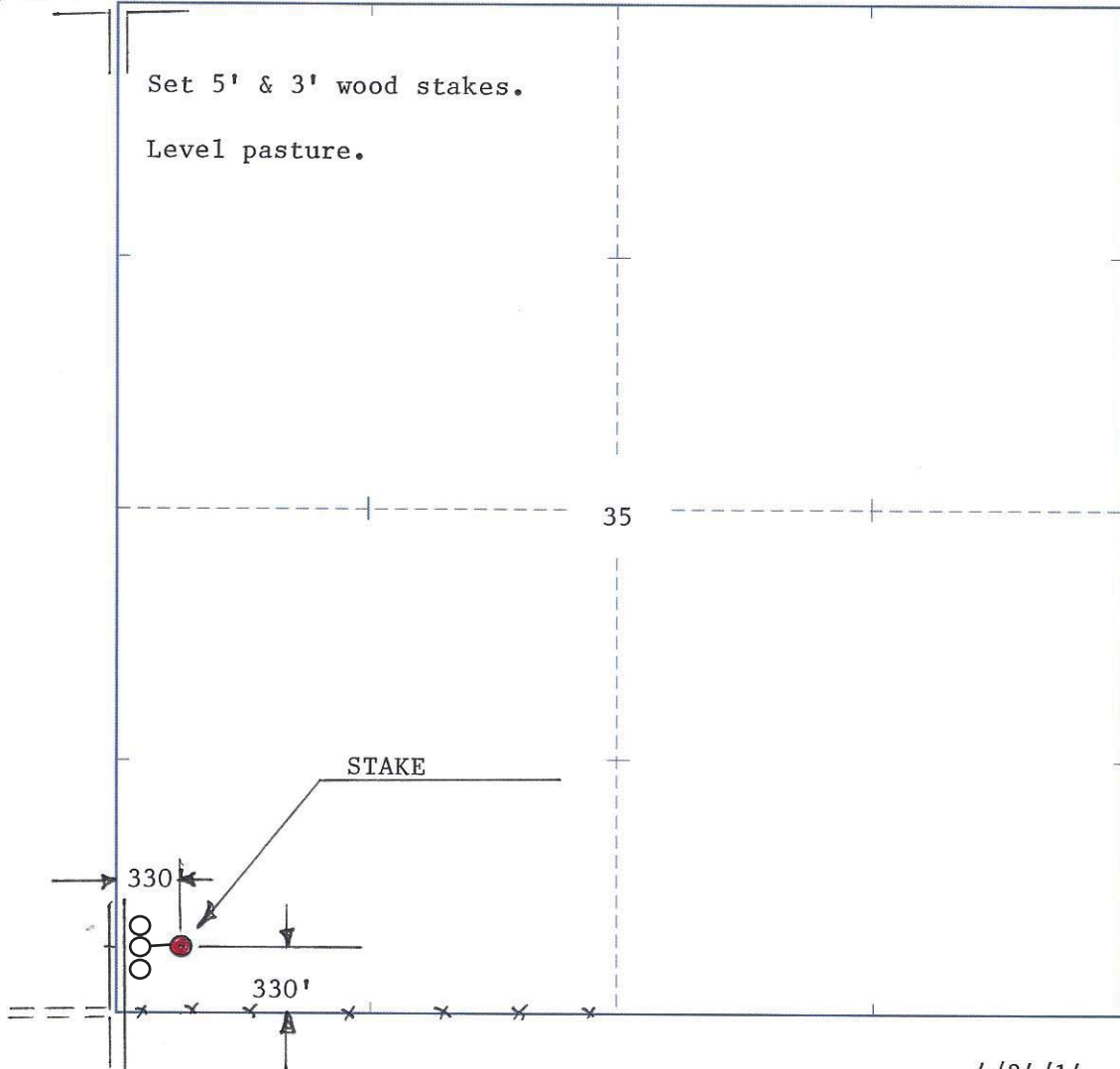

DATE STAKED: 4/24/14