

Plat and Certificate of Injection Well Location and Surrounding Acreages

Operator: MHW Enterprises Inc Location of Well: SW/4

Lease: Geifer 2014 PLAT MAP feet from  N /  S Line of Section

Well Number: \_\_\_\_\_ feet from  E /  W Line of Section

County: CRAWFORD Sec. 34 Twp. 28 S. R. 22  East  West

**Plat**  
Show the following information: applicant injection well, all producing wells, inactive wells, plugged wells, and other wells within a one-half mile radius, all lease boundaries, lease operators, unleased mineral rights owners, well numbers, and producing wells producing formation tops.

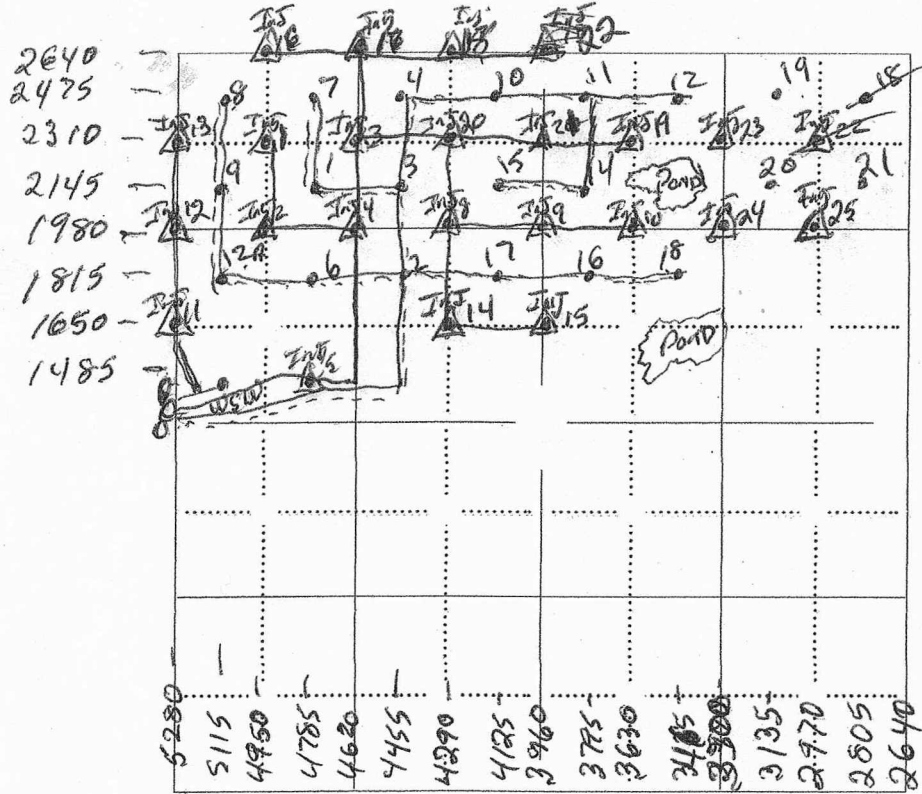

- applicant well
- D & A well
- plugged producer
- producing well
- other injection well
- water supply well
- plugged injection well
- temporary abandoned well

The undersigned hereby certifies that he / she is a duly authorized agent for \_\_\_\_\_, and that all of the information shown herein is true, complete and correct to the best of his / her knowledge.

\_\_\_\_\_  
Applicant or Duly Authorized Agent

Subscribed and sworn before me this \_\_\_\_\_ day of \_\_\_\_\_

\_\_\_\_\_  
Notary Public

My Commission Expires: \_\_\_\_\_