

KANSAS SURFACE OWNER NOTIFICATION ACT

R 37 W

T
17
S

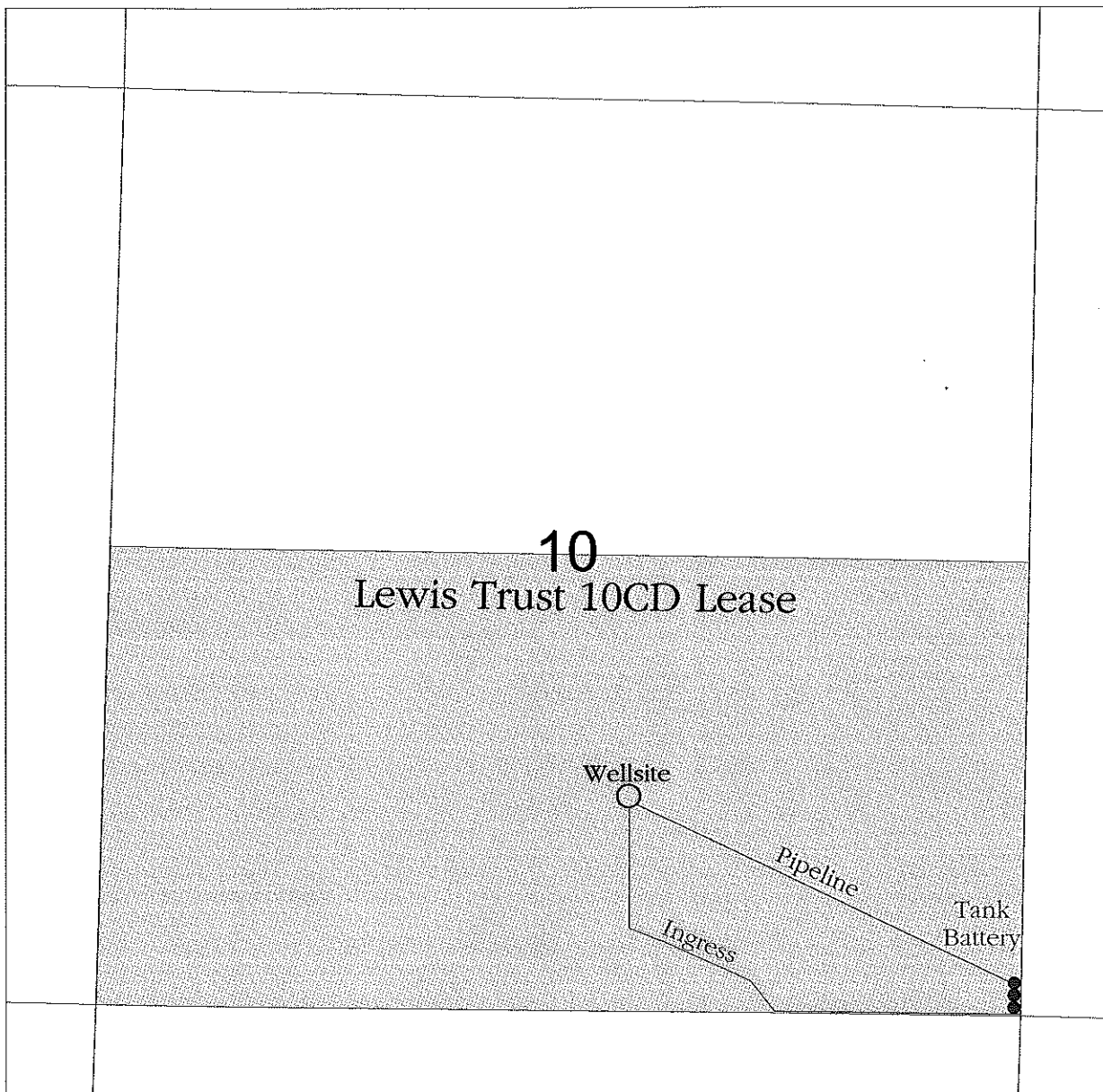

SCALE = 1 : 12,000

WICHITA COUNTY, KANSAS

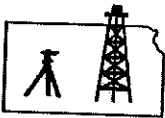

Pro-Stake LLC
 Oil Field & Construction Site Staking
 P.O. Box 2324
 Garden City, Kansas 67846
 Office/Fax: (620) 276-6159
 Cell: (620) 272-1499
 burt@pro-stakellc.kscoxmail.com

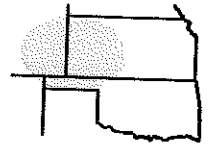

001737
 PLAT NO.

11869
 INVOICE NO.

Ritchie Exploration, Inc.

OPERATOR

Wichita County, KS

COUNTY

10 17s 37w
 Sec. Twp. Rng.

#1 Lewis Trust 10CD

LEASE NAME

1245' FSL - 2290' FEL

LOCATION SPOT

SCALE: **1" = 1000'**

DATE STAKED: **June 12th, 2014**

MEASURED BY: **Kent C.**

DRAWN BY: **Norby S.**

AUTHORIZED BY: **Justin C.**



GR. ELEVATION: **3327.7'**

Directions: From the center of Leoti, KS at the intersection of Hwy 96 and Hwy 25 – Now go 6.1 miles North on Hwy 25 – Now go 1 mile West on J Rd. – Now go 1 mile North on 11 Rd to the SE corner of section 10-17s-37w & ingress stake West into – Now go approx. 1000' West through pasture with cattle to ingress stake North & West into – Now go approx. 2250' North & West through pasture with cattle, into staked location.
Final ingress must be verified with land owner or Operator.

This drawing does not constitute a monumented survey or a land survey plat. This drawing is for construction purposes only.

